

DIY No-Sew Mask For 18" Dolls



Children everywhere are dealing with complex emotions. Playing with and relating to their doll offers a safe environment and a great way to express their feelings. If your child is uneasy about wearing a mask, putting one on their doll may help.

What you will need:

- ♥ A square of fabric measuring 6 in x 6 in. This can be from an old t-shirt, bandana, handkerchief, or cloth napkin.
- ♥ Scissors
- ♥ Ruler
- ♥ 2 Rubber bands or hair ties



Instructions

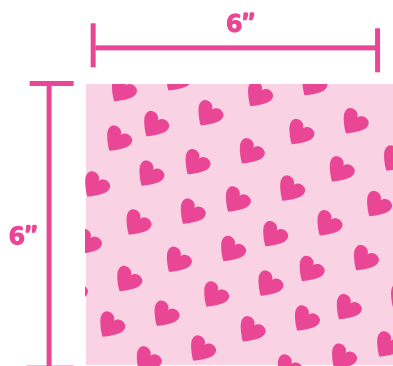

Step 1

Measure and cut your fabric so that it is a 6 inch by 6 inch square.

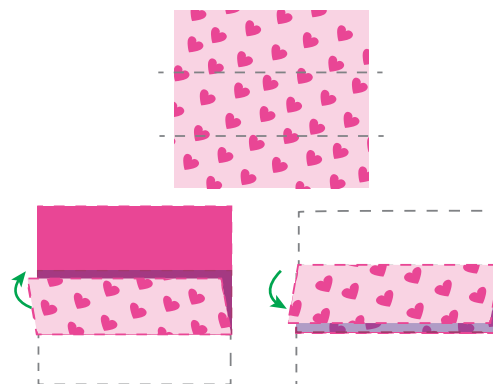

Step 2

Flip the fabric so the back of it is facing up. Start with the bottom and fold it up a third of the way. Then fold the top third down on top of the last fold. It should be a rectangular shape.

(Continued on next page)

Instructions



Step 3

Take a rubber band and slide the left side of the fabric 1/3 of the way through. Repeat, but on the right side with another rubber band. These bands will be the elastic that is placed around the doll's ears.

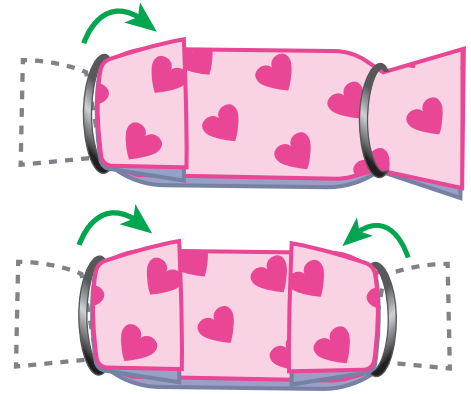

Step 4

Leaving the rubber bands in place, fold the left and right sides of the fabric toward the center and press flat.

How to use

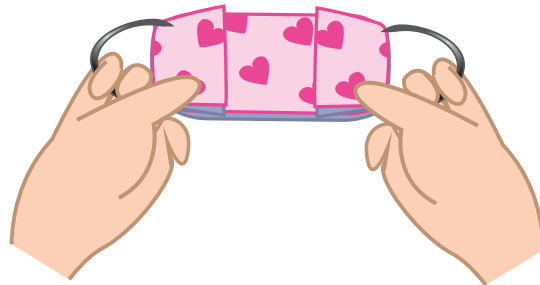

Hook your fingers on the rubber bands, using your thumbs to push the flaps down so it doesn't fall apart.

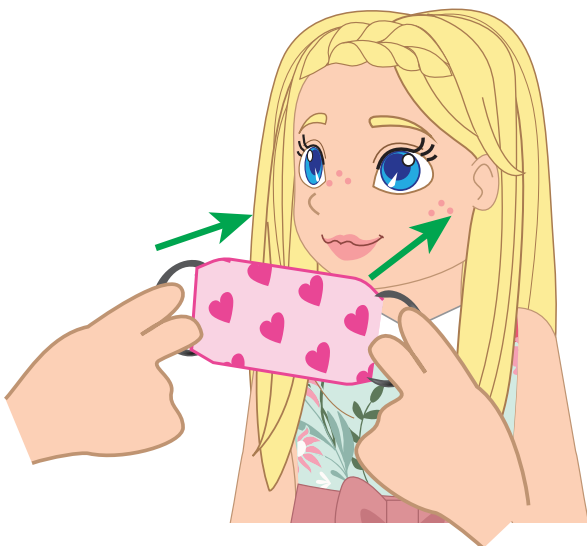

Place in front of the doll's face.



Tuck the elastic behind the doll's ears.
Note: if the mask is too loose, use smaller rubber bands