

From CONTAINER to LANDSCAPE

Plant and enjoy the beauty of container gardens now. **Then refresh!**

After a season, remove the plants from the containers and plant the tree, shrubs and perennials in the landscape and fill the container gardens with summer color!

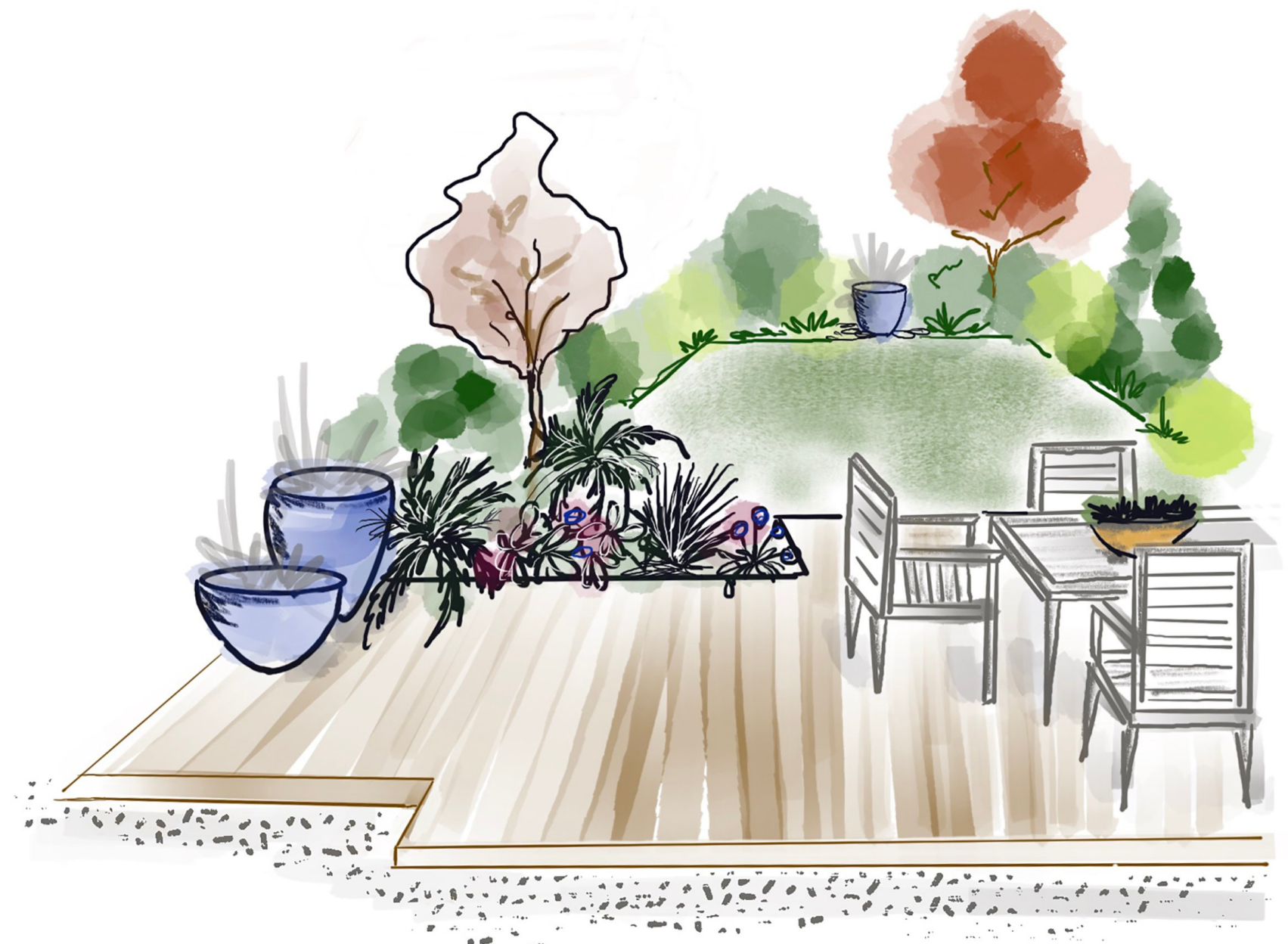

Container Gardens

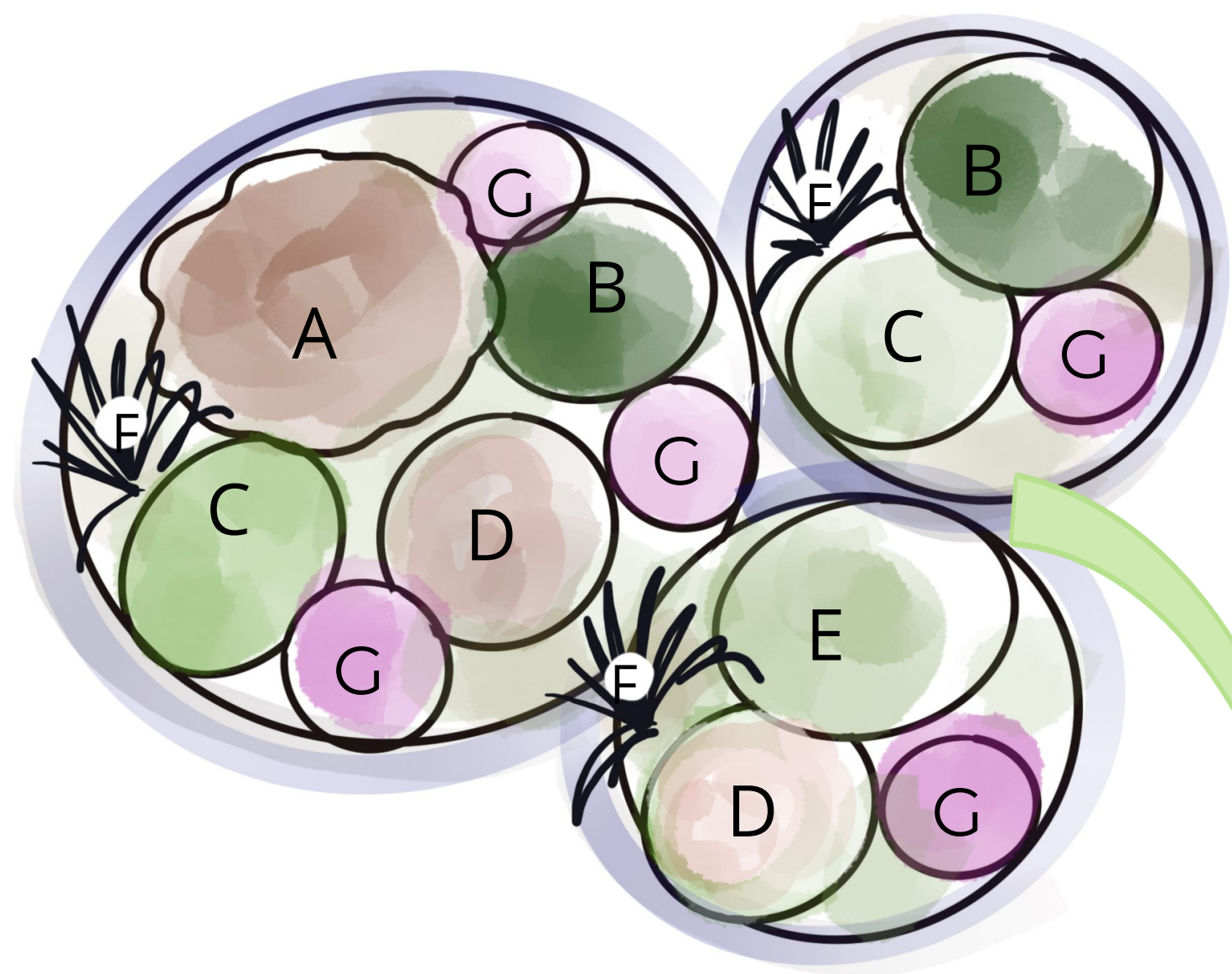

Landscape Plan

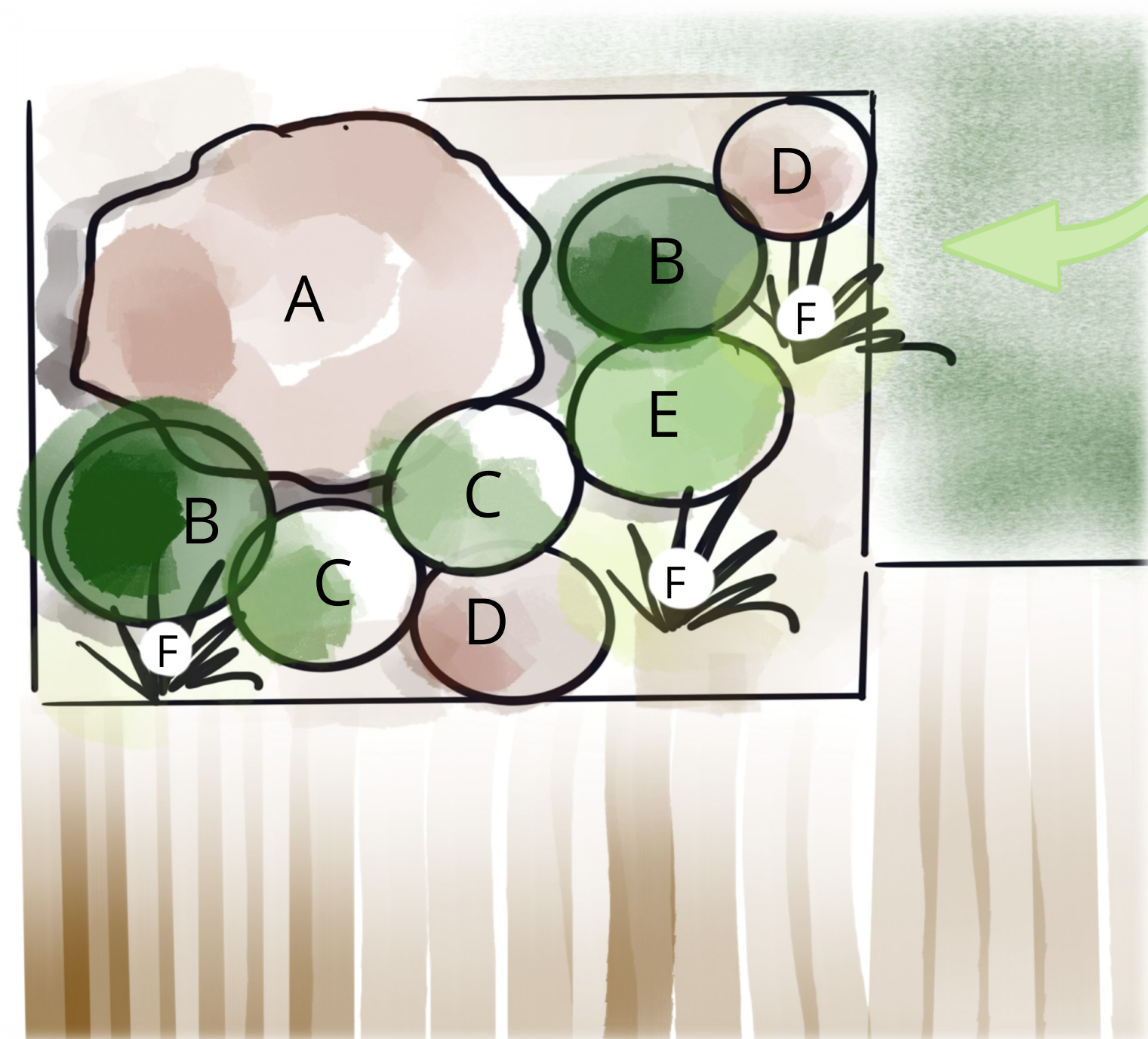

A) Small Tree

(Choose one variety, 2-gallon size or smaller- to easily fit root ball in pot)
Japanese Maple (*Acer palmatum*) 'Shaina' or 'Twombly's Red Sentinel'
Baby Grand® Magnolia (*Magnolia grandiflora*)

B) Perennials with attractive evergreen foliage

(choose 2 of the same variety)
Ferns- *Dryopteris* 'Jurassic Gold' or Rochford Fern (*Cyrtomium*)
or similar evergreen fern
Euphorbia- 'Miner's Merlot' or similar

C) Hellebore (*Helleborus*) (Choose 2 of the same variety)

'Merlin' or 'Snow Fever' or similar

D) Coral Bells (*Heuchera*) (Choose 2 of the same variety)

'Forever Purple', 'Spellbound' or similar

E) Dwarf Shrub

(Choose 1 variety, for container plant a 4-inch pot or 1-gallon-sized plant)
Heather (*Erica* or *Calluna*)
Dwarf Pieris (*Pieris japonica*) 'Little Heath' or 'Cavatine'
dwarf conifer: Mr. Bowling Ball® Arborvitae
Abies koreana 'Kohout's Ice Breaker'
Kinpo White Pine (*Pinus parviflora* 'Kinpo')

F) Ornamental Grass

(Choose 3 of the same variety)
Carex 'Feather Falls' or other similar varieties
Acorus 'Ogon'
Mondo Grass (*Ophiopogon*)
Lily Turf (*Liriope*)

G) Color

(Choose any combination of annual color or bulbs to pop into the container)
Primroses- Bellarina series or similar
Pansies
Hardy Cyclamen