

ASSEMBLY

a. Attach the wooden base panel to the side panels by inserting 2 screws into the slots on each side of the base.

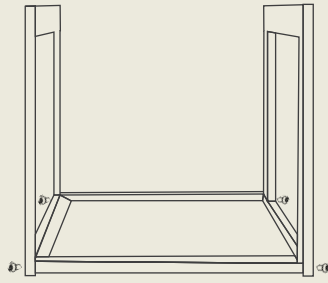

b. Attach the top light panel to the 2 sides frames with the light facing downwards by inserting 2 screws into the slots on each side of the light panel.

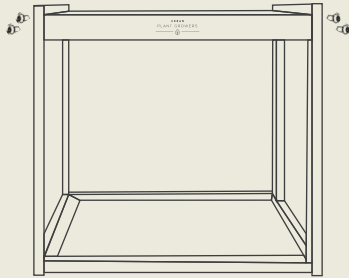

c. Ensure the pump is stuck down securely to the base of the basin.

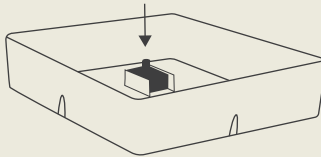

d. Place the lid back on the basin.

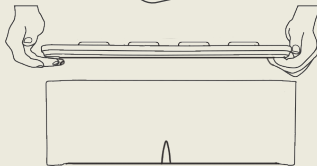

e. Slot the basin into the frame and connect the white cable from the pump to the light panel (PUMP).

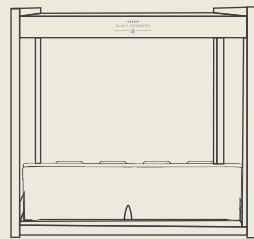

g. Connect the power adapter to the back of the unit (POWER) and use the red switch to turn it on; this activates the light and pump on an automatic timer.

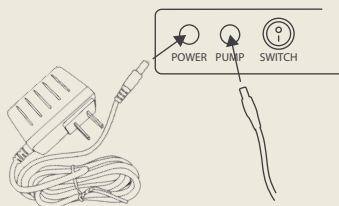

h. Attach white adhesive clips to frame to keep cords tidy.

TOP TIP!

PLANTING

a. Cut the rockwool cubes into individual pieces and place each one into a plastic net cup.

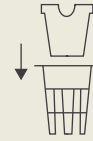

b. Place each net cup (now containing rockwool cube) into the holes in the basin lid, making sure that the rockwool cubes and net cups are level with the surface of the basin lid.

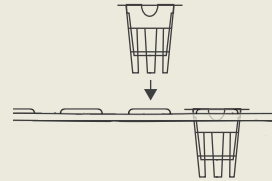

c. Use tweezers to place 2-4 seeds into each rockwool cube. (Plant extra incase some don't germinate.) **Note:** some seeds have specific soaking or preparation requirements.

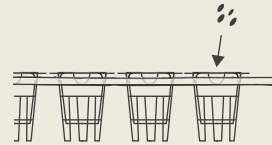

d. Fill basin with 6 Litres of water so that the water reaches the net cups and soaks the rockwool completely.

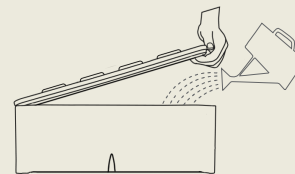

e. Sprinkle a few drops of water directly onto the seeds to make sure they've been activated.

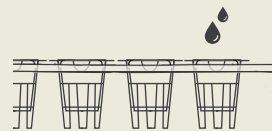

TOP TIP!

WARNING!

! Keep the basin clean.

! Trim any roots that begin to wind around the water pump.

! Keep plant branches & leaves away from the fan.

! Keep water away from power cords and connection points. Note that the pump is submersible.

! Keep water away from light panel & power switch.

REPLANTING

When your plants have grown and you've harvested a bumper crop, it may be time to reset your EcoKitchen and get a new set of seeds growing! Here are some tips for replanting which will help you keep your system in tip top condition:

 **A few weeks before you expect your plant to reach its end of life, plant some seeds in a new set of rockwool cubes.** You can place the block inside a takeaway container or a bowl and place it near the EcoKitchen. By the time your old plants have been fully harvested - you'll have a new set of seedlings ready to be planted into your EcoKitchen!

 **At the end of each growing cycle, disconnect your EcoKitchen from power, remove the pump from the basin, and give your basin a good wash** with soap and water. This will help clean out any old residue from your last crop.

 **Growing root cuttings** can be an awesome way to shave weeks off your growing schedule - see the note below for more info!

 We offer **replant packs** on our website that have everything you need to get your new crop growing. It comes at a discounted rate and can be bought in **subscriptions** so that you never have to worry about running out of supplies again!

ROOT CUTTINGS

Cuttings can be rooted in rockwool too! They're an awesome way to save time (growing from cuttings can trim around 4 to 6 weeks off your growing schedule!), and use up any spare cuttings that you may have.

Prepare by soaking the rockwool cube in water, then simply cut the parent plant as you normally would (usually just below a "node" on the plant stem and at a 45° degree angle), and then trim some of the unnecessary leaves back (this will increase the likelihood of the cutting surviving). Dip the cutting in rooting hormone (optional) and embed the cutting slightly in the hole at the top of the rockwool cube. Keep the cutting in bright indirect light and it should grow roots within a few weeks!

INCLUDED

- Users manual
- AC to 24V DC Power adapter
- Wooden Frame Side Panels x 2
- Wooden Frame Base Panel
- Full Spectrum LED Light Panel
- Lid & Basin
- Pump & cord
- Hydroponic Nutrients
- Net cups x12
- Rockwool cubes x12
- Adhesive Clips

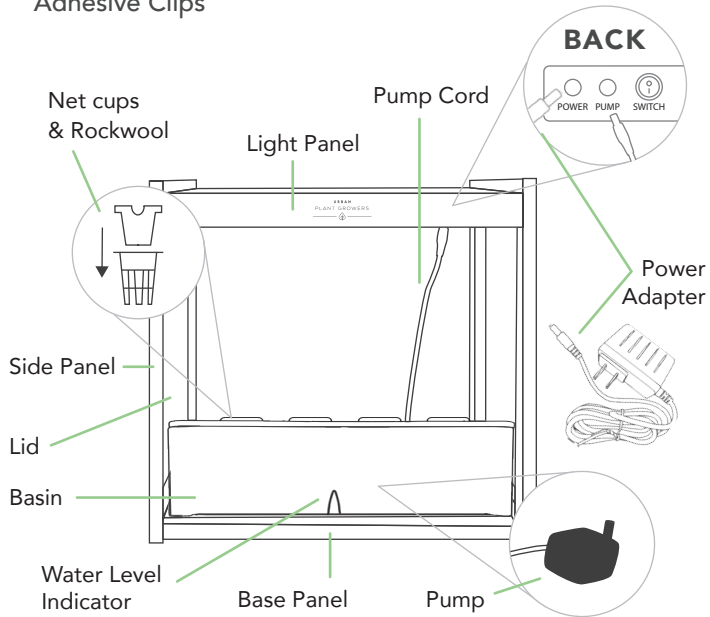

Note: The adhesive clips can be used to keep the power cords tidy and out of sight.

SPECIFICATIONS

Amperage (A): 3	Annual power consumption (kWh): 236
Voltage (V): 12	Max. Grow Height (cm): 27
Wattage (W): 36	

CONTROLS

Turning the power ON will commence the light sequence of 14hrs ON / 10hrs OFF.

The automatic pump runs on a sequence of 5 minutes ON / 25 minutes OFF while the power is on.

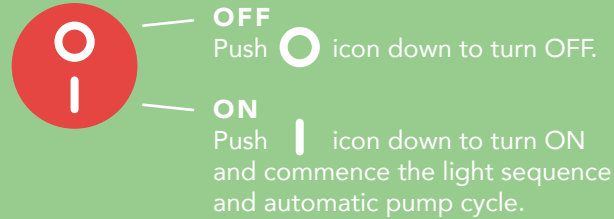

WATER & NUTRIENTS

Refill the basin as needed, making sure to keep the roots of your plant submerged.

Our nutrients are packed with all the macro and micronutrients that are required for plant growth. Please refer to nutrient instructions for suggested mixing ratios.

If you want to get the most out of your EcoKitchen, we recommend using a nutrient meter. Nutrient meters allow you to test the concentration of nutrients in your solution leading to accurate nutrient dosage and faster, healthier plant growth. We estimate that accurate dosing can boost growth by around 30%. We have nutrient meters available on our website.

WHAT YOU CAN GROW:

Herbs	try... Basil
Leafy greens	Kale, Lettuce
Flowers	Nasturtium
Small fruiting plants	Dwarf varieties of Tomato

URBAN
PLANT
GROWERS

ECOKITCHEN SMART GARDEN



USERS MANUAL

Scan the QR code to view our helpful set up videos, links & resources!

