

Instructions for YELLOW 20 Second Talking Tin

How to record a message

1. Pull the tab on the rear side to activate the battery power. Hold the product in both hands with your thumbs over the two record buttons. See diagrams below.
2. Press down with your thumbs and the red light will illuminate to indicate that recording has begun. Ensure that both your thumbs remain pressed down so that the red light remains on whilst you are recording. Speak clearly at a distance of approximately 6 inches and release your thumbs when you have finished recording.
3. Press the PLAY button once to hear your message.

NOTE: This product will allow you to record one single 20 second message. You can re-record as many times as you wish. New recorded messages will replace the previous. Your recorded message can NOT be protected, the LOCK feature is only available on our new RED 40 second model. Please visit our web site for more details.

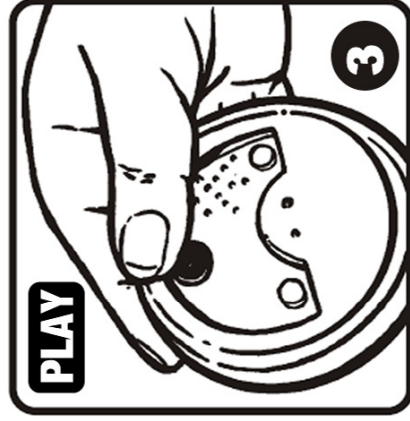

**PLAY
Button**

Mic

**Red Light
(Recording
Indicator)**

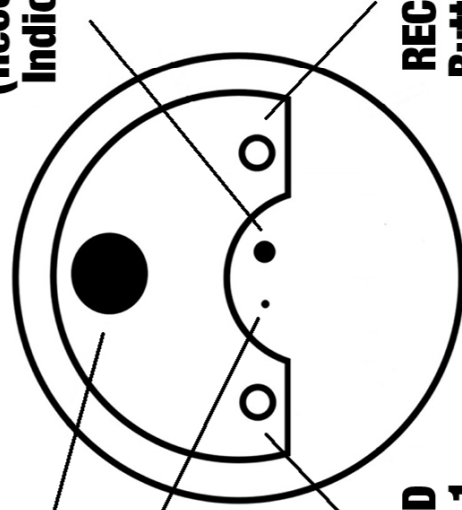

**RECORD
Button 1**

**RECORD
Button 2**

**Built-in
Magnets**

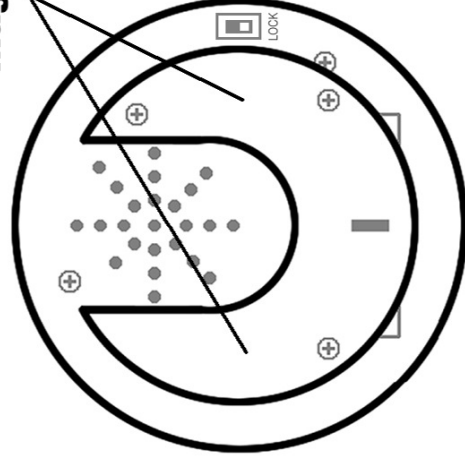

Part Code: TPD-20-YEL

www.TalkingProducts.com

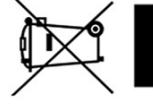

How to remove and insert batteries

Please see diagrams below. Each Talking Tin requires three AG13, (LR44), Button Cell Batteries. One free set of batteries is supplied and fitted in each unit.

1. Remove the U shaped section by loosening the 3 screws.
2. Remove the screw holding the battery compartment cover.
3. Replace all three of the batteries with careful attention to the polarity.
4. Re-assemble in the reverse order.
5. Do NOT charge non-rechargeable batteries.
6. Rechargeable batteries must be removed from this product before being charged.
7. Rechargeable batteries must only be charged under adult supervision.
8. Different types of batteries or new and used batteries must not be mixed.
9. Old exhausted batteries must be removed from this product.
10. The power supply terminals must not be short-circuited.

NOTE: You can purchase spare batteries from our web site, www.TalkingProducts.com

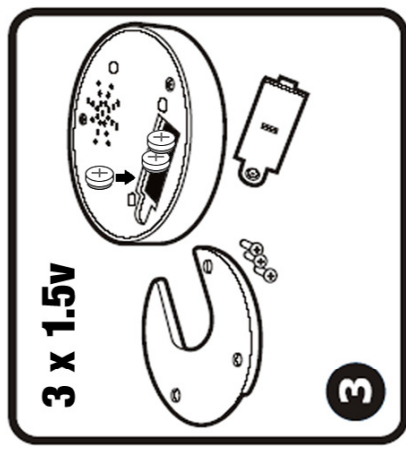
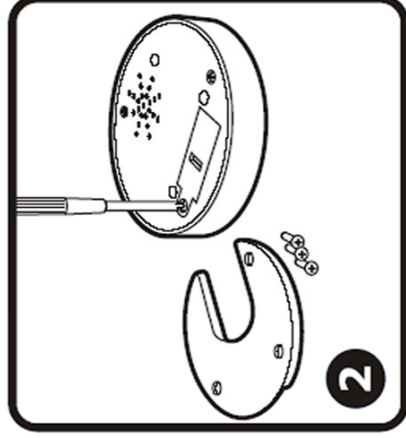
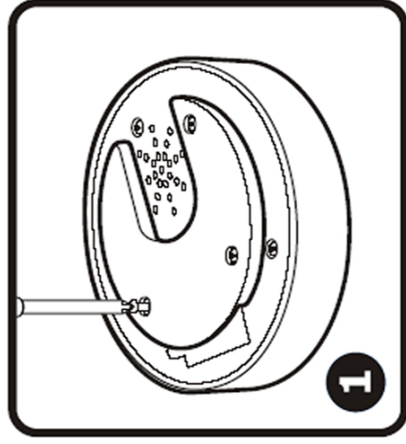

Accessories

Elastic Straps and Self-Adhesive Metal Adapters are available to purchase separately. These accessories will allow you to attach your Talking Tin to many other household items such as Bottles, Sprays and Storage Containers. More information about these accessories can be found on our web site.

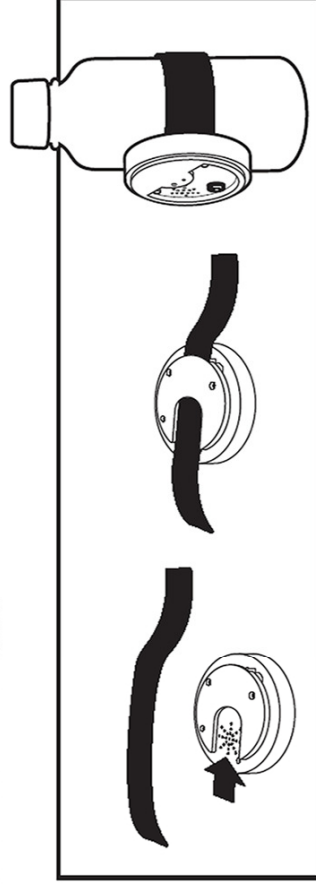

Elastic Strap

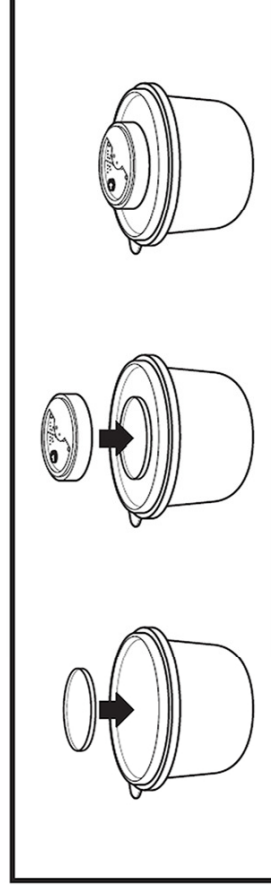

Self-Adhesive Adapter

NOTE: This document contains important information, please retain for future reference.