

ALL INFORMATION CONTAINED OR DISCLOSED BY THIS DOCUMENT IS CONSIDERED CONFIDENTIAL AND PROPRIETARY BY ANDU ELECTRONICS CO.,LTD. ALL DESIGN, MANUFACTURING, USE, REPRODUCTION, AND ALL SALING RIGHTS, ARE EXPRESSLY RESERVED BY AND TO ANDU ELECTRONICS CO.,LTD.

DRAWING REVISIONS				
REV	S/N	DESCRIPTION	APPROVED	DATE
A	20080210-011	ORIGINAL RELEASE		

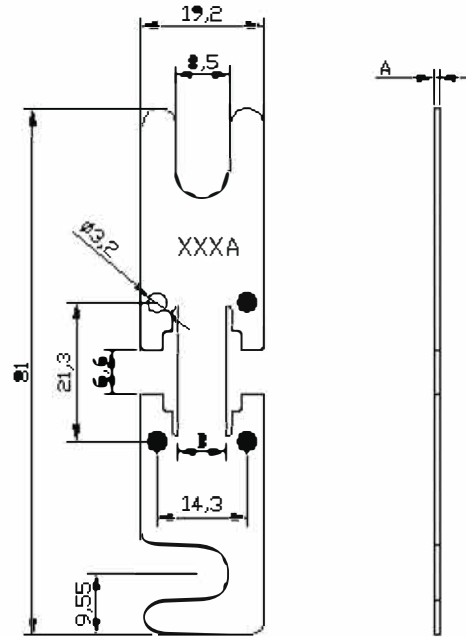

The maximum current of the test equipment is 1620a and the test time is 34S

220V Max(S) 60S Time-Current	250V Max(S) 0.8*10S Time-Current	DIM(A)	DIM(B)	DIM(C)	ASSEMBLY P/N
--	--	0.8	zincl.0	6.8	ANL-B-35
7.1S	3.5S	0.8	zincl.25	6.8	ANL-B-40
8.8S	2.5S	0.8	zincl.74	6.8	ANL-B-50
--	--	0.8	zinc2.3	6.8	ANL-B-60
--	--	0.8	zinc3.0	6.8	ANL-B-80
7.1S	3.3S	0.8	brass2.3	6.8	ANL-B-100
4.2S	2.4S	0.8	brass2.7	6.8	ANL-B-125
7S	2S	0.8	brass3.4	6.8	ANL-B-150
--	--	0.8	R copper1.95	6.8	ANL-B-200
--	--	0.8	R copper2.3	6.8	ANL-B-250
--	--	0.8	R copper2.6	6.8	ANL-B-300
--	--	0.8	R copper5.1	6.8	ANL-B-350
8.03S	5S	0.8	R copper5.5	6.8	ANL-B-400
--	--	0.8	R copper6.5	6.8	ANL-B-500
--	--	0.8	R copper7.5	6.8	ANL-B-600

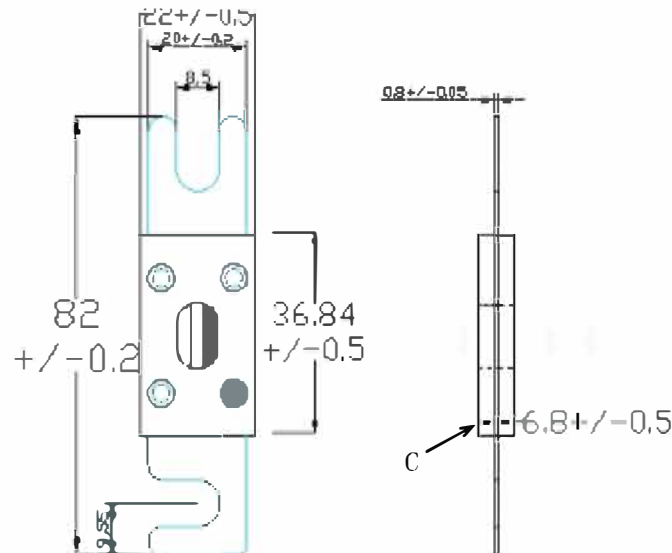

东莞安都电子有限公司

UNLESS OTHERWISE STATED		Fasten Fuse		CUSTOMER	
WALL THICKNESS		FOR ANL			
LINEAR	.XX	± 0.15	MM	DSGN	07-12-08
ANGULAR	.XXX	± 0.05	MM	DFTS	07-12-08
DRAFT ANGLE/SIDE		0.5 ° MAX		SCALE	free
BURR & FLASH		0.10 MAX		SHEET	2 OF 2
BREAK CORNERS		0.20 R.MAX		CHKD	
PARTING LINE MISMATCH		0.05 MAX		APPD	
				PART NO.	REV
				SEE THE LIST	A