

1 2 3 4 5 6 7 8

A

B

C

D

E

F

A

B

C

D

E

F

CODE DATE IDENTIFICATION AREA

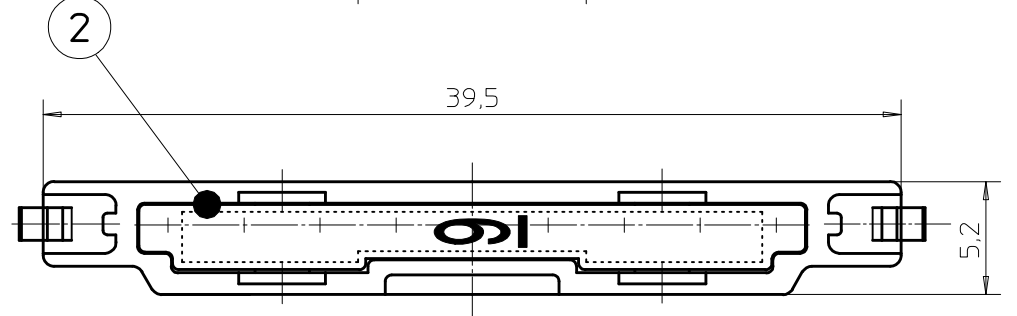
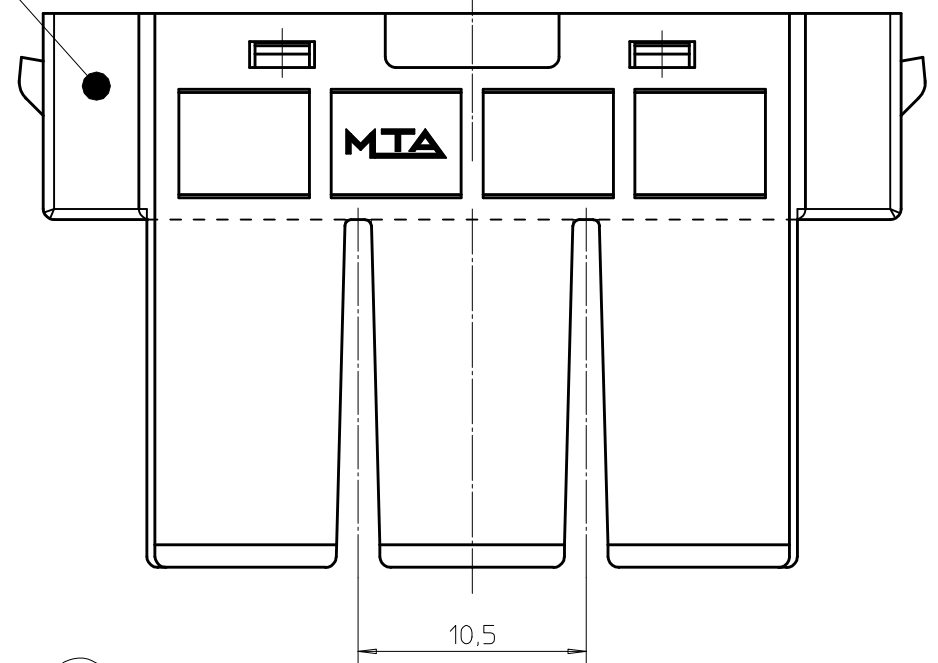
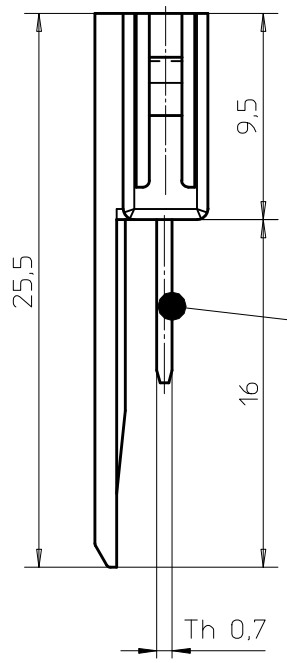
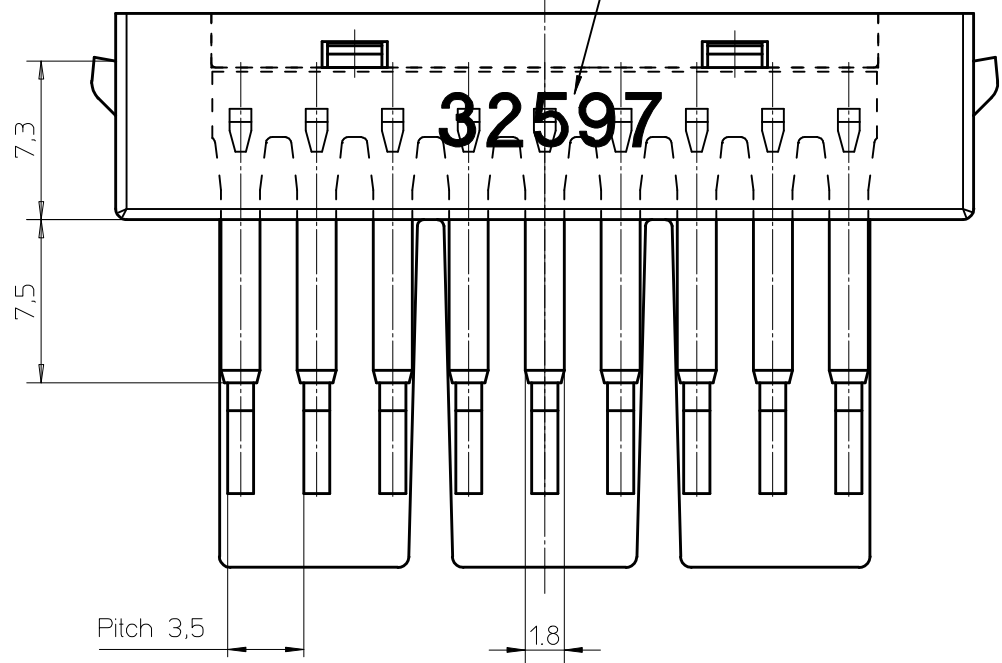

OPERATING FEATURES		
FEATURE	UNIT	VALUE
Flamability	UL 94	HB
IP	IEC 529	40
V max	V	42
T.min - T.max	°C	-40° / +120°
Rated current	A	-

45.51609	WHITE	3 + 6	
45.51610	BLUE	9	
45.51611	YELLOW	6 + 3	
45.51612	RED	5 + 4	
45.51613	GREEN	3 + 3 + 3	
45.51616	BEIGE	2 + 3 + 2 + 2	
MTA P/N	COVERS COLOR	TERMINAL COMBINATION	COVER Scale 2:1

3		MULTIPLE TERMINAL	Cu ETP Tinned 3 micron	
2	1	COVER	PBT GF20 Color as in table	
1	1	MULTIPLE TERMINAL HOLDER	PA66 GF13 - BLACK COLOR	
Pos.	Q.ty	DENOMINATION	MATERIAL	
		<b>MTA</b> auto electric systems	MTA P/N 45.51610	Denom. JOINT CONNECTOR 9 WAYS
			Draw No. B0-011.007A	Used for
Rel. Level	APPROVED	Draw for CLIENT	Family CONNECTORS	JOINT
Draft.	11/01/96 L.BASSI	Scale 3:1	Weight(g)	Lin.Tol.+ 0.5
Chk.	11/01/96 L.BASSI	App.	Dimensions in mm	Sheet
7		MATERIAL MODIFIED FOR POS. 1	Material SEE TABLE	Thick. Width
No.	Reason for Revision	Date 10/06/02	Name S. BEDUSCHI	

All proprietary rights reserved by MECCANOTECNICA CODOGNESE S.p.A. - This drawing shall not be reproduced or in any way utilized, for the manufacture of the component or unit herein illustrated and must not be released to other parties, without written consent. Any infringement will be legally pursued.