

REV.	ECN NO OR DESCRIPTION	REVISED	DATE
P1	PDR NO:A180824-2A	JTT	2018.08.28

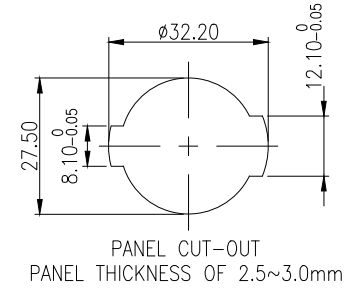
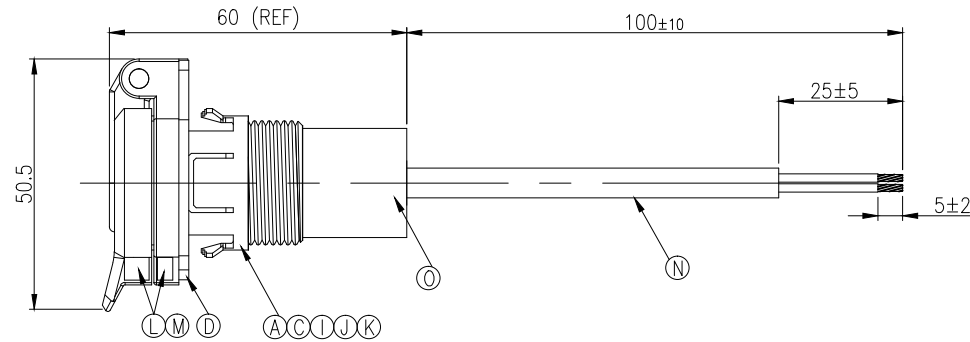
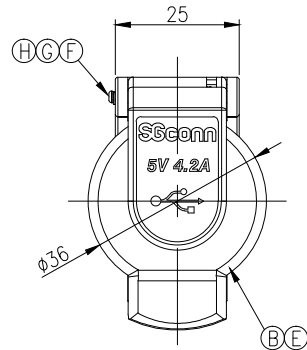

O	ROUND TUBE	1	PC	BLACK
N	CABLE	1	2464 AWM 16AWG 2C UV OD:6.0mm BLACK	4CM3004-W02604
M	STOPPER	2	PVC	BLACK
L	MAGNET	2	NdFeB	NICKEL
K	GLUE	1	N/A	BLACK
J	USB2.0	1	N/A	4UB3005-W0510J
I	PCBA	1	FR-4	N/A
H	AXIS	1	SUS	NATURAL
G	SPRING	1	SUS	NATURAL
F	E-RING	1	SUS	NATURAL
E	CAP GASKET	1	SILICONE	RED
D	GASKET	1	SILICONE	RED
C	COVER	1	ABS	NATURAL
B	CAP	1	PC	BLACK
A	BODY	1	PC	BLACK
NO	DESCRIPTION	QTY	MATERIAL	PLATING & COLOR

UNLESS OTHERWISE SPECIFIED TOLERANCES		Singatron Enterprise Co., Ltd. 信音企業股份有限公司	
DECIMALS:	ANGLES:	TITLE	WATERPROOF USB CAR CHARGER 12V 4.2A NORMALLY CLOSED SPRING CAP
X :±0.5	X :±2°	DWN	JTT PART NO. 2CH3001-W05410H
X.X :±0.3	X.X :±1°	CHKD	Cerry SCALE 1:1 UNIT: mm
X.XX :±0.2		APVD	William SIZE: A3 SHEET: 1 OF 1 REV: P1
CUSTOMER COPY			

WIRE	PORT 1	PORT 2
RED +	1	5
BLACK -	4	8

SPECIFICATIONS:

- ELECTRICAL CHARACTERISTICS:**
 - 1-1. INPUT VOLTAGE: 9V~16V
 - 1-2. OUTPUT VOLTAGE: 4.55V~5.25V
 - 1-3. MAXIMUM OUTPUT CURRENT: 4.2A(2.1A+2.1A)
 - 1-4. OPERATING TEMPERATURE: -20°C~+50°C
- LIFE TEST: 5,000 CYCLES.
- GP PASS COMPLIANT
- NORMALLY CLOSED SPRING CAP

