



# Smart

Mood Light  
Model # 142800-003



**IMPORTANT:  
RETAIN FOR FUTURE REFERENCE,  
READ CAREFULLY**

## **Congratulations** on your purchase of the **SMART** “Mood Light”

This product has been designed and developed with safety, comfort and functionality in mind. Please take the time to read this manual carefully before using this product and keep it in a safe place for future reference.

### **Contents**

Assembly contents list

Operating instructions



Due to variations in the style and design of our products, the photographs and illustrations shown in this instruction manual are generic, therefore product fabrics, colour and design may vary from images shown. CNP Brands reserves the right to alter product specifications without notice as a result of our ongoing policy of product improvement.

## Check what you have received...

You have received **1 box**. Please check the contents of the box against the list below. If anything is missing, please contact Customer Service.

In Australia, contact **CNP Brands** on **1300 667 137**.

## Supplied loose in box:

Mood Light  
Body



x 1

USB Power Lead



x 1

You will need  
a USB Power  
Adapter  
to Plug Lead  
Mains  
(not supplied)



x 1

## **⚠ WARNING ⚠**

**STRANGULATION HAZARD:**  
**CHILDREN HAVE STRANGLED IN CORDS. KEEP THIS CORD OUT**  
**OF THE REACH OF CHILDREN (MORE THAN 3FT (0.9M) AWAY)**  
**NEVER USE EXTENSION CORDS WITH AC ADAPTERS.**



## Overview...

### Wi-Fi Indicator

Network configuration mode: Blinks Quickly  
Wi-Fi Connection is available: Red Light

### Power Colour Switch

Short Press to turn on the lamp  
Short Press again to change the scene/  
colour  
Long press to turn off the lamp



### WI-FI BUTTON

Hold and press this button for 5 seconds  
to enter network configuration mode.

## Getting started...

1

Download the **SMART LIFE App**, from the Google Play or the Apple Store. You can scan the QR code below or look up Smart Life App, from Google Play or the Apple Store.



2

Once you have downloaded the App, open the App and register an account to log in.

## Connect the device to the internet

1

Option 1:

Turn the Smart Mood Light 'on' by pressing the power button.  
Ensure all Wi-Fi device(s) are connected to your home Wi-Fi network.

**IMPORTANT: 2.4 GHz b/g/n network's are compatible.  
5GHz networks are not compatible.**

2

Tap the add icon "+" on the top right and select "Light Source (BLE + Wi-Fi)" from the device type list.

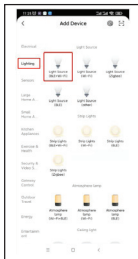
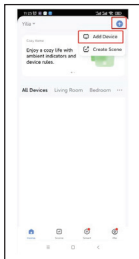

3

To enable Wi-Fi configuration mode: hold the Wi-Fi button for 5 seconds. Release when the indicator light is flashing.

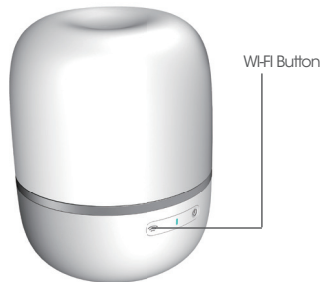

4

Follow the steps on the App.

Enter the password of the Wi-Fi Network that is connected to your device.

Once complete it will start to register the device on the cloud.

Once the light is successfully added to the device you can control it within the App.

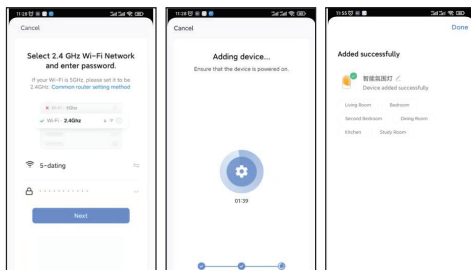

5

Once the light is connected you can control it with the App. or using Amazon Alexa and Google Assistant.

The App. allows you to change the lamp colour, brightness, changing the scene, set a schedule and set a timer. You can also share it with your family and rename it.

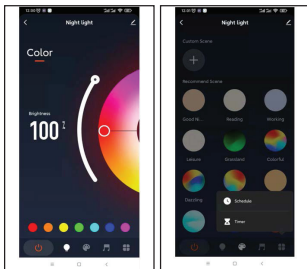

## Connecting the device to the internet

1

Option 2:

Turn the Smart Mood Light 'ON' by pressing the power button.

Ensure all Wi-Fi device(s) are connected to your home Wi-Fi network.

**IMPORTANT; 2.4 GHz b/g/n network's are compatible.**

**5GHz networks are not compatible.**

2

Tap the add icon '+' on the top right and then turn on the Bluetooth.

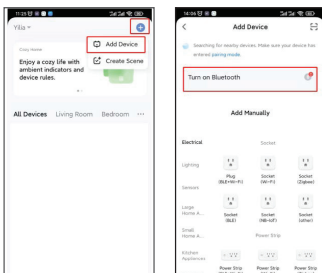

3

To enable Wi-Fi configuration mode: hold the wi-fi button for 5 seconds. Release when the indicator light is flashing.

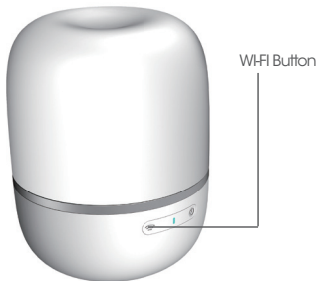

4

Follow the steps on the App.  
Enter the password of the Wi-Fi Network that is connected to your device.  
Once complete it will start to register the device on the cloud.  
Once the light is successfully added to the device you can control it within the App.

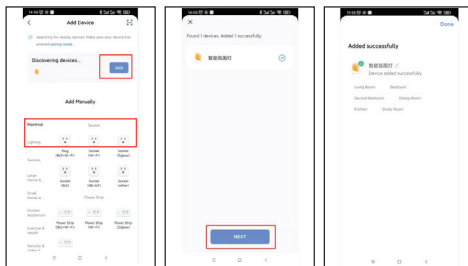



5

Once the light is connected you can control it with the App. or using Amazon Alexa and Google Assistant.

The App. allows you to change the lamp colour, brightness, changing the scene, set a schedule and set a timer. You can also share it with your family and rename it.



6

The light also includes a feature where the light will pulse to the rhythm of music that is playing nearby.

Select and control this feature through the music tab in the App.

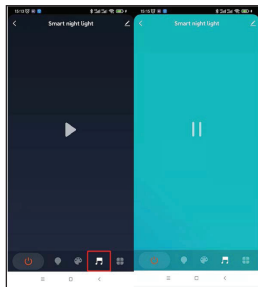

## Connecting the device to Amazon Alexa

1

Open Amazon Alexa App.  
Tap Skill on the menu to go to the Amazon Skill Store.

2

Search the skill name "Smart Life" in the search bar.

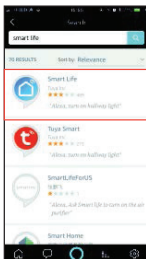
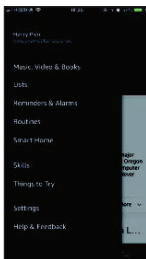

3

Enable the skill and type in your login information from the App. account to link the account.

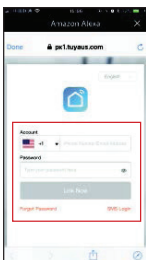
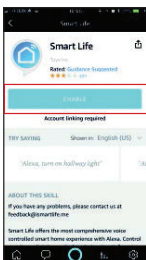

4

Tap "Discover Devices" to sync your devices to Alexa.

After 20 seconds, the device will be discovered (connected) and Alexa will tell you "I found xxx devices", then you control your device using your voice through Amazon Alexa devices.

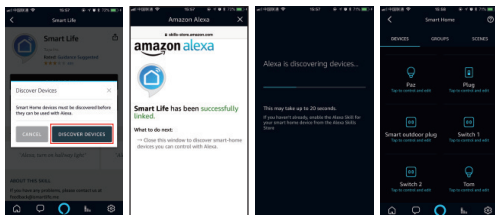

The following voice commands are supported:

Alexa, turn on/off "xxx".

Alexa, set the "xxx" to [colour].

Alexa, set the "xxx" to [percentage].

Alexa, set the brightness of "xxx" [percentage].

## Connecting the device to Google Assistant

1

Open the Google Home App, and tap "Home Control" on the menu.

Tap the add icon "+" on the bottom right corner.

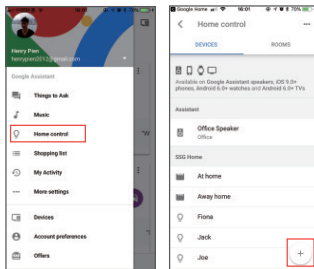

2

Find "Smart Life" from the list.

3

Type in your account information from the App, account to link the account.

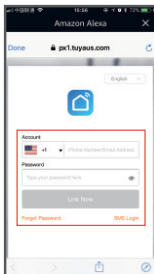
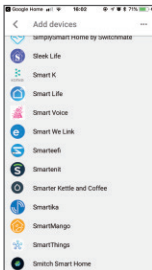

4

Once the device is linked successfully, you can assign the devices to rooms, then your devices will be listed in the Home Control list.

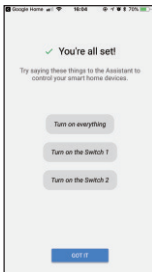
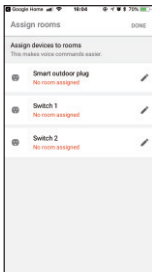

The following voice commands are supported:

Hey, Google, turn on/off "xxx".

Hey, Google, set the "xxx" to [colour].

Hey Google, set the "xxx" to [percentage].

Hey Google, set the brightness of "xxx" [percentage].



# CNP BRANDS<sup>®</sup>

CHILDCARE NURSERY PRODUCTS

## About CNP Brands

Currently, **CNP Brands** boasts one of the most diverse brand portfolios with a combination of company owned brands and distribution agreements.

Our own brands, including **Childcare**, have gone from strength to strength in recent years. **Childcare**, and our premium brand **bebe care**, demonstrate our commitment to quality and continuing investment in product development.



Distributed in Australia by CNP Brands  
82 Maribyrnong Street, Footscray, VIC, 3011  
Customer Service 1300 667 137

W: [www.cnpbrands.com.au](http://www.cnpbrands.com.au)  
E: [info@cnpbrands.com.au](mailto:info@cnpbrands.com.au)  
F: [www.facebook.com/CNPBrands](https://www.facebook.com/CNPBrands)  
I: @cnp\_baby

