



Assisted Auto Close GATE EXTENSION

Model # 089361-003

IMPORTANT: READ INSTRUCTIONS CAREFULLY BEFORE USE AND RETAIN FOR FUTURE REFERENCE

Safety Precautions

This gate is designed for children from 6 months to 24 months. Since each child's skill develop at different ages, these parameters should be monitored against your child's own development.

Read all instructions before assembly and use of the safety gates.

Keep instructions for future use.

WARNING

- **INTENDED FOR USE WITH CHILDREN FROM 6 MONTHS THROUGH 24 MONTHS.**
- **CHECK THE STABILITY OF THE GATE AND TIGHTEN ALL HARDWARE AND MOUNTINGS REGULARLY.**
- **TO PREVENT SERIOUS INJURY OR DEATH, SECURELY INSTALL GATE OR ENCLOSURE AND USE ACCORDING TO MANUFACTURER'S INSTRUCTIONS.**
- **INSTALL ACCORDING TO THE MANUFACTURER'S INSTRUCTIONS.**
- **NEVER USE WITH A CHILD ABLE TO CLIMB OVER OR DISLodge/OPEN THE GATE OR ENCLOSURE.**
- **NEVER USE IF GATE IS LESS THAN 3/4 OF CHILD'S HEIGHT.**
- **DO NOT USE IF ANY PART OF THE GATE IS BROKEN OR MISSING.**
- **THIS PRODUCT WILL NOT NECESSARILY PREVENT ALL ACCIDENTS. NEVER LEAVE CHILD UNATTENDED.**
- **USE ONLY SPARE PARTS AVAILABLE FROM CNP BRANDS.**
- **NEVER ALLOW CHILD TO CLIMB OR SWING ON GATE.**
- **USE ONLY WITH THE LOCKING/LATCHING MECHANISM SECURELY ENGAGED.**
- **NEVER USE GATE AT TOP OF STAIRS.**
- **DISCONTINUE USE IF ANY PART OF THE GATE IS DAMAGED.**
- **NEVER CLIMB OVER THE GATE.**
- **NEVER HANG OR TIE TOYS, ETC, TO ANY PART OF THE GATE.**



Assisted Auto Close GATE EXTENSION

Model # 089361-003

Installation

Check what you have received...



**Upper Extension
Housing**
x 2

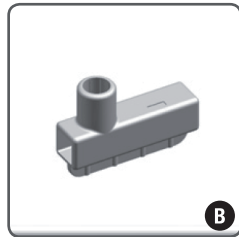

**Lower Extension
Housing**
x 2

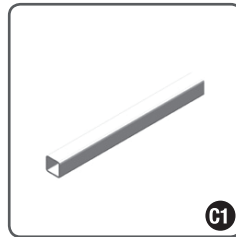

**Extension Tube
20cm**
x 2

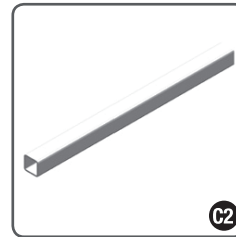

**Extension Tube
26cm**
x 2

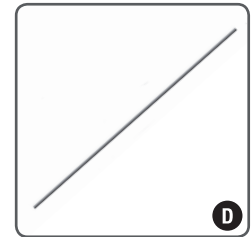

Extension Bar
x 2

Housings bars and square extension tubes (13cm) from gate may be needed. Depending on how many extensions are being added, insert the appropriate square extension tubes (C) into gate ends.

Connect the bar (D) to one upper extension housing (A) and one lower extension housing (B).

Push assembly over extension tubes. There should be no metal showing from extension tubes. It may be necessary to apply pressure to tubes to ensure they are fully inserted into gate ends. Slide spindles into extension tubes.

PLEASE NOTE: Do not over tighten the adjusters

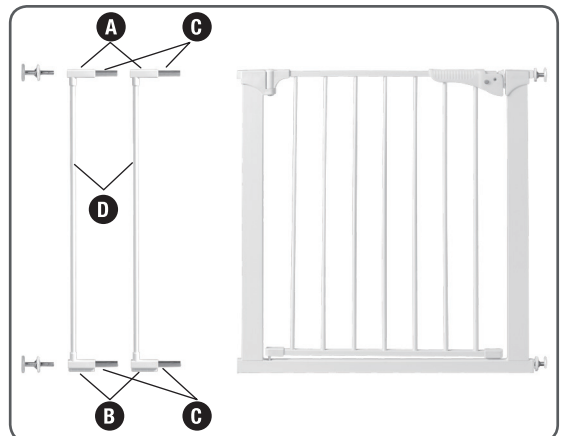

Distributed in Australia by CNP Brands
20 Calarco Drive,
Derrimut, VIC, 3030
Customer Service 1300 667 137

W: www.cnpbrands.com.au
E: info@cnpbrands.com.au
F: www.facebook.com/CNPBrands
I: @cnp_baby

Distributed in New Zealand by Wainhouse Distribution
2-6 Argyle St, Morningside, PO Box 41-014,
St Lukes, Auckland, New Zealand
Customer Service: 0800 567 5000

E: helpline@wainhousedist.co.nz

