

SERENE

SWING

MODEL # 037730



**IMPORTANT:
RETAIN FOR FUTURE REFERENCE,
READ CAREFULLY**



Read all instructions before assembly and use of the swing. Keep instructions for future use.

⚠ WARNING ⚠

BEFORE ASSEMBLING THIS SWING, READ AND UNDERSTAND THE INSTRUCTIONS.

Never leave the child unattended.

Never use this product on an elevated surface, eg. A table.

This swing is not intended for prolonged periods of sleeping.

Always use the restraint system.

Do not use the swing once your child can sit unaided.

Do not let children play with this product.

Do not move or lift this product with the baby inside it.

Do not use if any components are broken or missing.

KEEP INSTRUCTIONS IN A SAFE PLACE FOR FUTURE REFERENCE.

⚠ WARNING ⚠

Transformers used with the swing are to be regularly examined for damage to the cord, plug, enclosure and other parts, and in the event of such damage, they shall not be used.

The swing shall only be used with a transformer with 5V / 2A

Make sure all the locking equipment is installed well before using the swing.

DO NOT use the swing on any rough surface to avoid any injury to the infant.

DISCONTINUE USE of swing when infant attempts to climb out.

DISCONTINUE USE of swing when infant can roll over.

NEVER use the toy-bar to carry the swing.

Age range suitability: Birth to 9kgs.

This swing **DOES NOT** replace a cot or a bed. Should your child need to sleep, then they should be placed in a suitable cot or bed.

DO NOT use accessories or replacement parts other than those approved by the manufacturer.



Congratulations on your purchase of the **Bebecare Serene Swing**.

This product has been designed and developed with safety, comfort and functionality in mind. Please take the time to read this manual carefully before using this product and keep it in a safe place for future reference.

Contents

Assembly contents list

Assembly / Operating instructions

How to care for your **Serene Swing**



Due to variations in the style and design of our products, the photographs and illustrations shown in this instruction manual are generic, therefore product fabrics, colour and design may vary from images shown. CNP Brands reserves the right to alter product specifications without notice as a result of our ongoing policy of product improvement.



Check what you have received...

You have received **1 box**. Please check the contents of the box against the list below. If anything is missing, please contact Customer Service.

In Australia, contact CNP Brands on **1300 667 137**, in **New Zealand** contact **Wainhouse Distribution on 0800 567 5000**.

Supplied loose in box:

Seat Frame
(with Seat
Insert and
Harness
preassembled)



x 1

Swing Base



x 1

Toy Bar
(with 3 x toys
pre-assembled)



x 1

Seat Sliding Tube

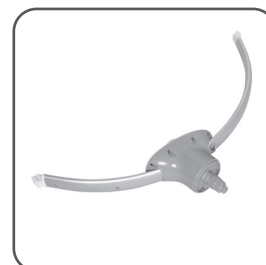

x 1

USB Power Lead



x 1

There are no accessories recommended for use with this Bebecare Swing.



To assemble Swing frame...

1

1a. Insert top end (end with 2 x underside push pins) of Seat Sliding Tube into the housing at the top of Seat Frame until secure.



1b. Insert bottom end of Seat Sliding Tube into the housing at the bottom of Seat Frame until secure.



2

2a. Align the Rotating Base semi-circle with the motor pin inside the Swing Base.



2b. Insert Seat Assembly into the Swing Base until secure.



3

3a. The Seat Frame can be held in a stationary position by sliding the lever at the front down to lock, or up to release.





To assemble Toy Bar...

1

- 1a. Align bottom of Toy Bar with housing on top of Seat.
- 1b. Insert Toy Bar until secure.



2

- 2a. To remove Toy Bar, press tab at back of Toy Bar whilst pulling Toy Bar up and away from Seat Frame.



To power Swing...

1

- 1a. The USB power lead plugs in to the front right hand side of the Swing Base.

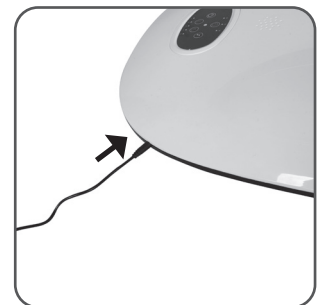

- 1b. Plug the other end into a suitable power adaptor/ transformer and plug into power supply.



! WARNING !

Transformers used with the swing are to be regularly examined for damage to the cord, plug, enclosure and other parts, and in the event of such damage, they shall not be used.

The swing shall only be used with a transformer with 5V / 2A



To operate Swing...

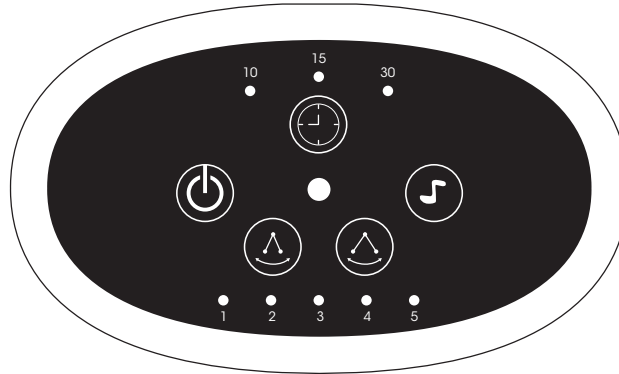

Power Button: Press power button to turn swing on/off.



Swing Speed Down Button: Press button to reduce swing speed.



Swing Speed Up Button: Press button to increase swing speed.



Timer Button: One press will set timer for 10 minutes.
Two presses will set timer for 15 minutes.
Three presses will set timer for 30 minutes.
(For power saving, the Swing will turn off automatically after 90 minutes).



Music Button: Press music button to begin playing music.
Second press will stop playing music.
Third press will change to next song.

Volume Up: When music is playing, hold 'Swing Speed Up' button to increase volume.

Volume Down: When music is playing, hold 'Swing Speed Down' button to decrease volume.

To use Bluetooth...



- 1a. Turn on Bluetooth on your chosen device.
- 1b. Hold down the 'Music' Button on the Swing Base to enter Bluetooth mode.
- 1c. Connect to 'AC-46'.
- 1d. Play music from your device through the swing speakers.
- 1e. Volume control and song selection can be made through your device.

PLEASE NOTE: To return to playing the swings built-in music, disconnect the Bluetooth device.



To use the Harness...

1

1a. Place child into the swing.



2

2a. Place crotch pad up and between child's legs.



3

3a. Secure left and right hand side shoulder clips into waist straps.

3b. Insert combined shoulder and waist strap clips into harness buckle.

3c. Secure crotch pad flap down and over harness buckle.

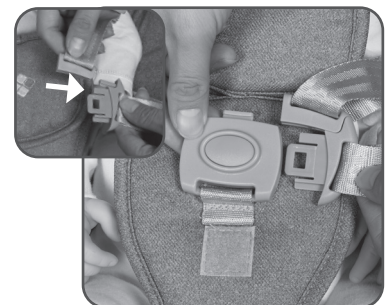

4

4a. Tighten the adjusters on the waist and shoulder straps to ensure the harness is secure.



5

5a. To release the harness buckle, push the buckle release button.



PLEASE NOTE: Always adjust the harness when changing the seating position of the child.



To adjust shoulder harness height...

1

- 1a. Release harness buckle and separate shoulder straps from waist straps.
- 1b. Feed the shoulder straps back through the Seat Insert and Seat Liner.
- 1c. Re-insert the shoulder straps through the higher harness adjustment height in the Seat Liner and the Seat Insert.



To adjust Seat...

1

- 1a. Rotate Seat Adjuster to the 'unlocked' position.
- 1b. Whilst holding the Seat Adjuster in the 'unlocked' position, slide the Seat assembly up or down to desired position.
- 1c. Rotate Seat Adjuster to the 'locked' position to secure.





To remove Seat Insert...

1

1a. Release the waist and shoulder straps from the harness buckle.



1b. Feed the crotch strap, waist straps and shoulder straps back through the Seat Insert and remove Seat Insert away from the seat.



To remove Seat Liner from frame...

1

1a. Locate Seat Liner zipper on the right hand side of Seat.

1b. Unzip Seat Liner and remove from Frame.

1c. To re-install Seat Liner, align Seat Liner zipper with Frame zipper.

1d. Completely re-zip to secure.

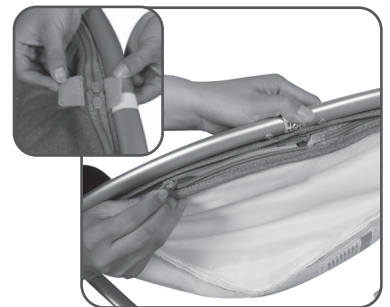

To remove Seat from frame....

1

1a. Locate seat release tab where the Seat meets the Frame.

1b. Pull and hold seat release tab whilst simultaneously pulling Seat up and away from the Frame.

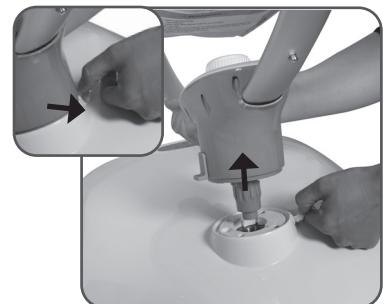



Cleaning

To ensure the long-lasting use of your swing, use a damp cloth to clean the frame. Do not use abrasive cleaners. Allow it to dry completely before storing it away. Do not dry clean, or use bleach on fabrics or trims. Do not machine wash, tumble or spin dry. Hand wash Seat Liner and Seat Insert separately if required.

Maintenance

Check swing regularly to ensure that locking devices and components are secure and working properly. Always check parts regularly for tightness of screws, nuts and other fasteners – tighten or replace if required. To maintain the safety of your swing, seek prompt repairs for bent, torn, worn or broken parts. Use only those parts and accessories approved by **CNP Brands**.

If you have any difficulties in assembling the swing, please contact our Service Department.

In Australia, contact **CNP Brands on 1300 667 137**, in New Zealand contact **Wainhouse Distribution on 0800 567 5000**.

Warranty

For all warranty terms and conditions, please visit cnpbrands.com.au



CNP BRANDS[®]

CHILDCARE NURSERY PRODUCTS

About CNP Brands

Currently, **CNP Brands** boasts one of the most diverse brand portfolios with a combination of company owned brands and distribution agreements.

Our own brands, including **Childcare**, have gone from strength to strength in recent years. **Childcare**, and our premium brand **bebe care**, demonstrate our commitment to quality and continuing investment in product development.

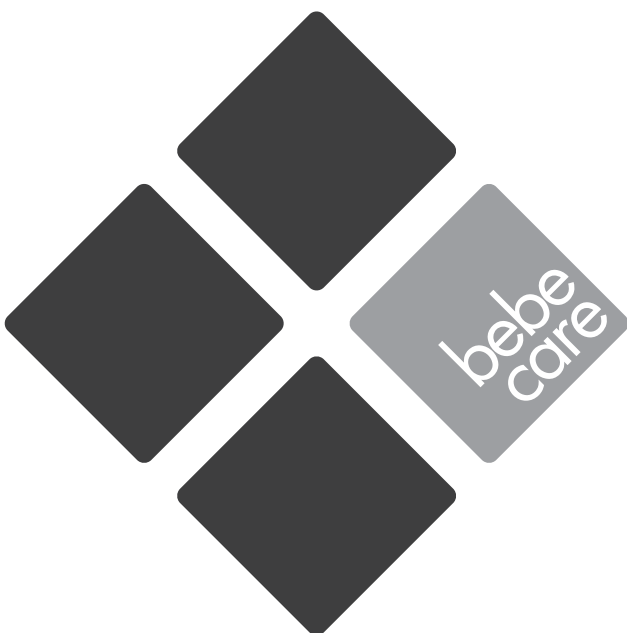

NOTES



A series of horizontal dotted lines for writing notes.



CNP BRANDS®

CHILDCARE NURSERY PRODUCTS



Distributed in Australia by CNP Brands
82 Maribyrnong Street, Footscray, VIC, 3011
Customer Service 1300 667 137

W: www.cnpbrands.com.au
E: info@cnpbrands.com.au
F: www.facebook.com/CNPBrands
I: [@cnp_baby](https://www.instagram.com/cnp_baby)

Distributed in New Zealand by Wainhouse
Distribution
2-6 Argyle St, Morningside,
PO Box 41-014,
St Lukes, Auckland, New Zealand
Customer Service: 0800 567 5000

E: helpline@wainhousedist.co.nz

