



Gas Valve Igniter Alignment

This guide is for the RCS main burners not igniting when the valve clicks over.

First

Check to make sure you have your main gas supply open.

Will your grill light manually with a long lighter? If so, proceed with steps below.

Are you waiting pushing in the knob & holding for 2-3 seconds before clicking the igniter?

If your grill still will not ignite, please check the following

Upon inspection, if you find that your igniter is off-centered, follow these steps.

Step 1:

Align Igniter with the center of the cut-out hole

- 1 Turn off the gas supply to the grill
- 2 Remove cooking grids from grill
- 3 Remove heat tents from grill
- 4 Look inside the grill at the front inside panel where the burner goes through housing.
 - a. Check to see if the igniter is centered in the hole.

If not, Take your hand and push the valve to make the igniter centered

(You can either use a flat head screw driver to align the valve or use your hand by reaching underneath the control panel and rotating valve to align the igniter with the center of the hole.) **DO NOT PRY ON THE WHITE CERAMIC PIECE**

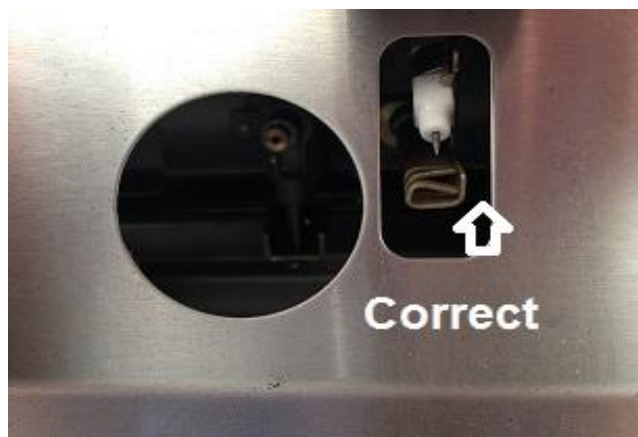

If igniter is not igniting gas after completing step 1 please continue with step 2 below.

Step 2:

Bend tab on end of igniter

Tools Needed:

1 - Needle Nose Pliers

- 1 Turn off the gas supply to the grill
- 2 Remove Cooking Grids
- 3 Remove Heat Tents
- 4 Remove Burners
 - a RON27a, RON30a, RON36a, & RON42a Grills. Remove clip and burner will slide back and out of the grill.
 - b There are bolts at the back of the burner holding the burner in place on the RJC26a & RJC32a Grills. Remove the bolts and the burner will slide back and out of the grill.
- 5 Use Pliers to bend the tab down like in the picture below.
- 6 Make sure there is no grease or food particles in this area, blocking the spark.
(Clean with a soft brush if necessary.)



Step 3:

Reassembling your grill

- 1 Re-Install burners in the same way you removed them
 - a Make sure the venturi tube of the burner is seated correctly over the valve & orifice
 - b Re-attach the clips you removed from the back of the burner or the bolts you unbolted from the back of the burners.
- 2 Re-Install the heat tents over the burners
- 3 Re-install the cooking grates on the grill.
- 4 Turn on the gas supply to the grill.