

# MASTERBUILT®

## Controller Instruction Sheet

### Portable Grill CGT18G1A



- Always remove plug from outlet before servicing your grill.
- Make sure your grill has fully cooled to avoid burns.
- Some components may have sharp edges. Use caution id injury.
- Remove charcoal, cooking grate, manifold, and charcoal hopper before starting.

<p>1 Remove the body liner. Rotate the liner to sit on the left shelf.</p>	<p>2 Remove the probe bracket.</p>	<p>3 Remove the probe from the bracket. Slide the probe out of the liner.</p>
<p>4 Remove the control knob.</p>	<p>5 Remove the panel screws.</p>	<p>6 Remove the front control panel.</p>
<p>7 Remove the rear panel screws.</p>	<p>8 Remove the rear panel screws.</p>	<p>9 Remove the control panel back.</p>

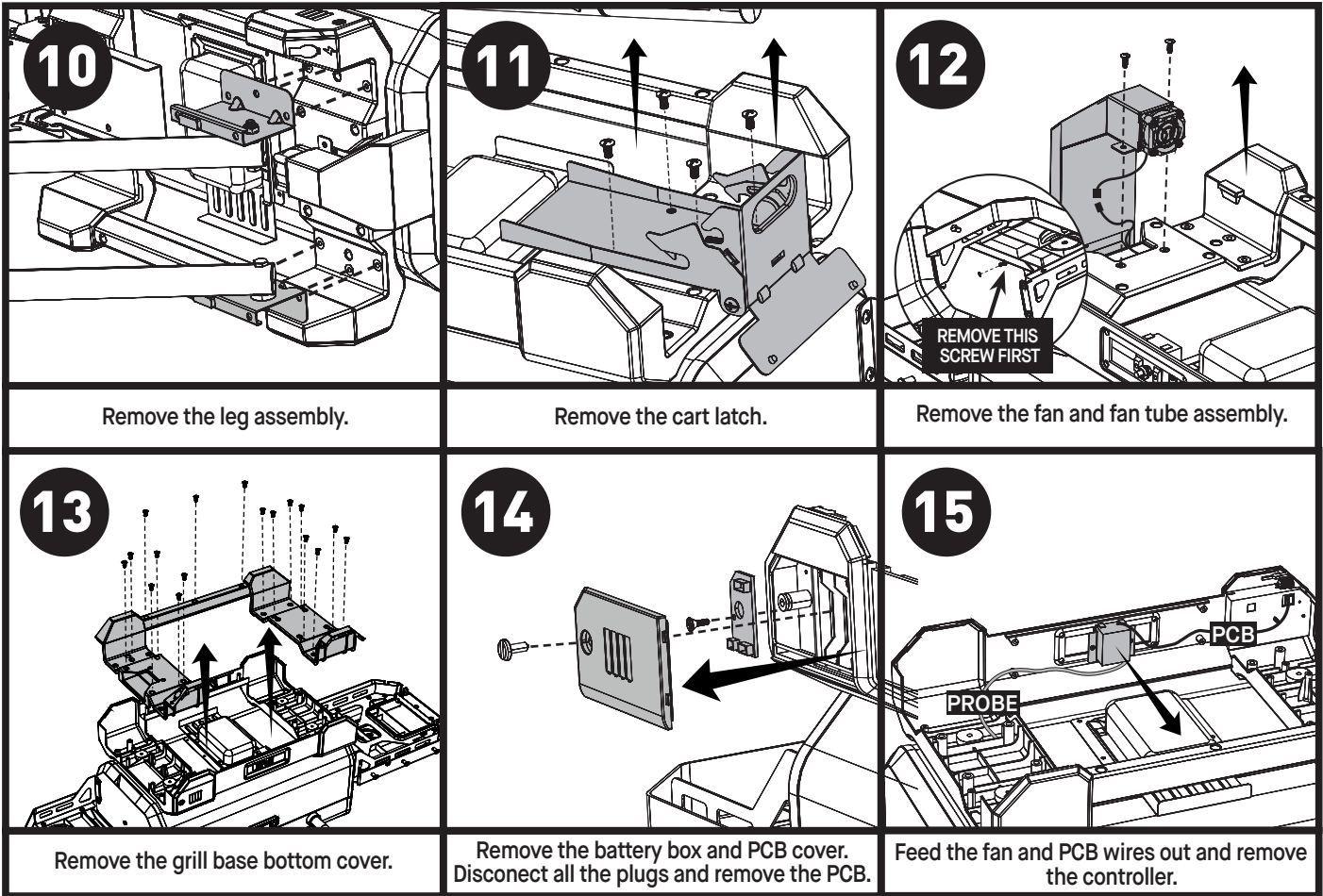

## ASSEMBLY INSTRUCTIONS

1. Place the new controller in place and begin feeding the probe and fan wires through the grill base (see step 15).
2. Install the new PCB and reconnect all the wires (see step 14).
2. Replace the grill base bottom cover (see step 13).
3. Attach the fan and fan tube assembly (see step 12).
5. Attach the cart latch to the grill base (see step 11).
6. Attach the leg assembly (see step 10).
7. Replace the back and front of the control panel (see steps 9,8,7, and 6).
8. Attach the control knob (see step 4).
9. Feed the probe through the grill and mount the probe and probe bracket to the grill liner (see steps 3 and 2).
10. Replace the grill liner (see step 1).