

Solar Security Light - Single Light

USER MANUAL

☎ 1-888-883-2456

✉ support@techkogroup.com

TECHKO®

Model: SSL-306

▲ Please carefully read this manual before using the product.

▲ Keep this manual with you for reference as needed.

PLEASE FULLY CHARGE THE PRODUCT BEFORE USING

1. Please turn the product to the 1,2 or 3 setting and fully charge under direct sunlight before use.
2. Charging time may vary depending on the weather, temperature, and seasons.
3. Do not charge the product indoors or any place where direct sunlight can't reach. Otherwise, the product will not charge properly.
4. Please keep the solar panel clean to make sure the product can be properly charged. Frequently clean the solar panel as needed. Avoid scratching on the panel or it may lower charging efficiency.

INSTALLATION INSTRUCTIONS

Please make sure the location where the unit is to be installed has enough space for it to fit in before installing.

The solar panel and LED panel can be adjusted up to 40° angles.

When adjusting the unit, secure the screw to hold the panel in the correct position.

Solar panel is removable for users to select and mount the solar panel in an optimal location.

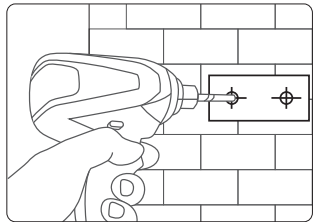

1. Place the mounting sticker in a location where the product will be installed to. Then drill 2 holes into the guides shown on the mounting sticker.

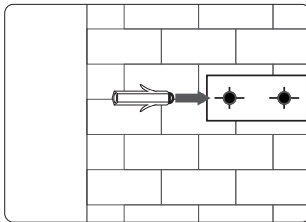

2. Insert the supplied anchors into the drilled holes.

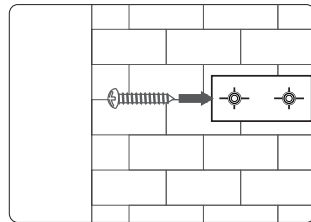

3. Use a screwdriver to secure the supplied screws into the anchors. Leave enough of the screw threads exposed as this will be used to mount the unit.

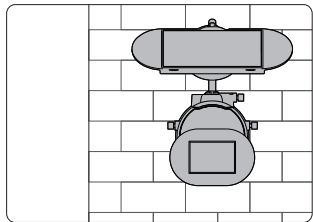

4. Hang the unit on the installed screws corresponding to the holes behind the unit.

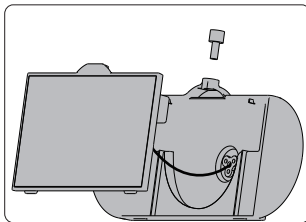

5. Solar panel can be removed as an option by twisting counter-clockwise on the adjustable screw above the solar panel to detach from the unit and be placed into an optimal charging location.

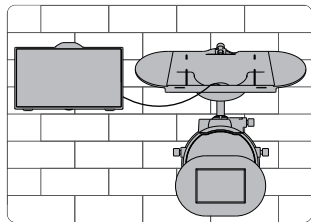

6. Use the additionally provided accessories and repeat steps 1 to 4 for installing the detached solar panel in an optimal position.

▲ Please install the unit in a place where the solar panel can be continually exposed to the sun.

▲ Avoid placing the unit where shade from buildings or objects would block the solar panel.

Switch & Functions (Please see Figure A for reference)

OFF – Move the switch to the "OFF" position. While in the "OFF" position the unit will not charge or light up.

1. Light remains on while in a dark environment and automatically shuts off in a bright environment. Motion sensor is disabled in this mode.
2. Light remains off while in a dark environment. When motion is detected, the light will automatically turn on to its brightest setting and turn off after 10 seconds if no further motion is detected.
3. Light remains in a constant dim light setting. When motion is detected, the light will automatically turn on to its brightest setting and return to a dim light setting after 10 seconds if no further motion is detected.

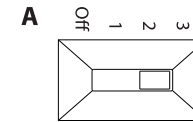

WARNING & NOTICE

1. Do not look directly at the LED lights, or it may damage your eyes.
2. Do not attempt to disassemble or remodel the product. Any changes can be dangerous and will void the warranty.
3. Please keep away from any flammable items, or explosion, property damages, or casual injuries may occur.
4. Please install the product according to the user manual.

PRODUCT SPECIFICATION

Material	ABS	Solar Panel	5.51 x 3.11 inch/1.55W
Battery	Li-ion battery 18650 2200mAh	Waterproof Performance	IP65
Size	7.83 x 8.85 x 5.67 inch	Accessories	1*Solar security light 4*Screws / 4*Anchors 2*Mounting stickers 1*User manual

This product has a 1-year limited warranty. For further information please visit our website at www.techkogroup.com

Copyrights Reserved

Patent Pending : US 16/412,865