

OPERATION

This unit has three modes - CHIME/OFF/ALARM. When the batteries are loaded, a red LED light on the front of the unit will flash once and a single beep will sound. This indicates the unit is set up and ready to work.

CHIME MODE

When the door is opened, the S183 sounds a pleasant CHIME sound.

ALARM MODE

When the opening of a protected door or window is detected from the sensors, the unit will sound a 6-tone alarm after a 5 second entry delay time with the red LED light flashing. The alarm will sound for 60 seconds and then reset itself to resume protection.

OFF MODE

When the function switch is set to the OFF position, either CHIME or ALARM will remain inactive.

CHIME OPERATION

1. Set the function switch to the CHIME position.
2. When in the CHIME mode, opening the door will trigger a chime sound three times.
3. To turn off the CHIME mode, turn function switch to the OFF position.

ALARM OPERATION

1. Set the function switch to the ALARM position.
2. When in the ALARM mode, opening the door will trigger and the unit will give out a loud alarm siren.
3. To turn off the alarm, turn function switch to the OFF position.

ENTRY DELAY

There will be a 5 second delay with the red LED light flashing to allow user to turn off the Alarm when entering.

EXIT DELAY

When turning on the unit to Alarm mode, there will be an 8-12 second delay to allow user's exit.

MAINTENANCE

When the red LED light on the front of the unit stays on, it means "Low Battery". Please replace with (3) new 1.5V AAA batteries.

CAUTION

THE SAFETY ENTRY ALARM IS EXTREMELY LOUD. FOR YOUR SAFETY, NEVER PLACE THE UNIT CLOSE TO YOUR EARS. TO TEST THE ALARM, DIRECT THE UNIT AWAY FROM YOU AT ARM'S LENGTH AND ACTIVATE.

Customer Service :

1-888-8TECHKO(1-888-883-2456)

Website: www.techkousa.com

Mfg. By **TECHKO**[®]
9767 Research Drive
Irvine, CA 92618-4626
MADE IN CHINA

Patent No. 7,187,280

NOTICE

THIS PRODUCT IS PROTECTED UNDER FEDERAL PATENT, TRADEMARK AND COPYRIGHT LAWS AND LAWS PREVENTING UNFAIR COMPETITION. NO DUPLICATION OR SIMULATION OF THIS PRODUCT IS PERMITTED EXCEPT BY WRITTEN AUTHORIZATION OF TECHKO, INC.

TECHKO AND THE CONFIGURATION OF THIS PRODUCT ARE TRADEMARKS OF TECHKO INC. COPYRIGHT 1994 TECHKO, INC. ALL RIGHTS RESERVED
MADE IN CHINA

TECHKO[®]

**SAFETY ENTRY™
MODEL S183
MAGNETIC SENSOR
ENTRY ALARM / CHIME**

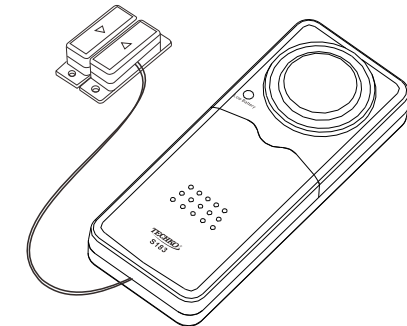

OPERATION MANUAL

INTRODUCTION

Congratulations on your purchase of the TECHKO S183 Magnetic Sensor Entry Alarm/Chime. The Safety Entry provides protection of unauthorized entry by detecting the opening of the door. The S183 can also provide a chime function when the protected door is opened.

IMPORTANT SAFETY TIPS

*The alarm siren is very loud, never place the unit close to your ear.

*Install the unit high enough to be out of the reach of children.

*Your S183 Magnetic Sensor Alarm can provide valuable protection for your home and property if utilized properly. However, this unit cannot guarantee complete protection against burglary or robbery. Therefore, TECHKO will not be held responsible for any loss or damage which could occur.

*Keep this manual for future reference.

INSTALLATION

The S183 requires (3) 1.5V AAA batteries (included) for operation.

Installing Battery:

1. Switch the unit to the OFF position.
2. Remove the back plate of the unit and install (3) 1.5V AAA batteries Fig. 1.
3. Replace the back plate and be careful when routing the sensor wire leads so they are not pinched or cut.

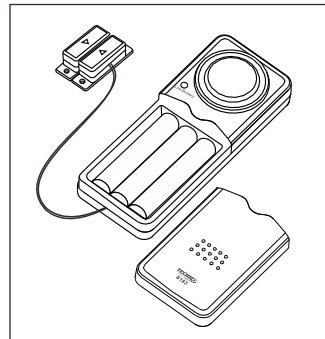

Fig. 1

Mounting of alarm unit and sensors:

1. Using the template provided, mark the screw hole location and drill a 0.4 inch hole. Tap the provided screw anchors into place. Fig. 2

2. Peel the protection sheets of the double-sided tape and stick to the bottom back side of the unit. Slide the alarm over and on to the screw, Fig 2, then press bottom of the unit to secure taped unit to the wall.

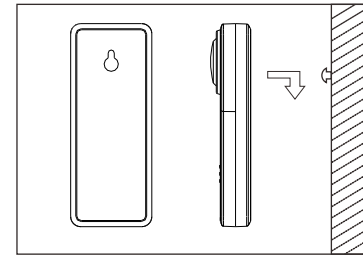

Fig. 2

3. Attach the magnetic sensor with the wire connection to the door frame so that it will not be more than 0.5 inch from the door. Mount the magnet portion of the sensor to door as shown in Fig. 3.

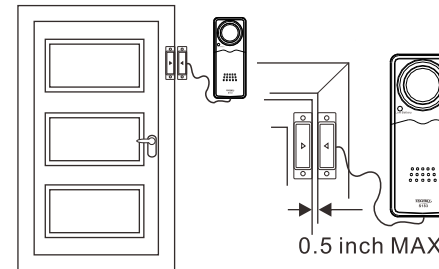

Fig. 3

TEMPLATE MODEL S183

