

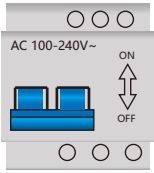

LED LINEAR LIGHT INSTALLATION

Suspension



1. Turn off the main power switch.

2. Take out the light fitting and fix it on the ceiling.

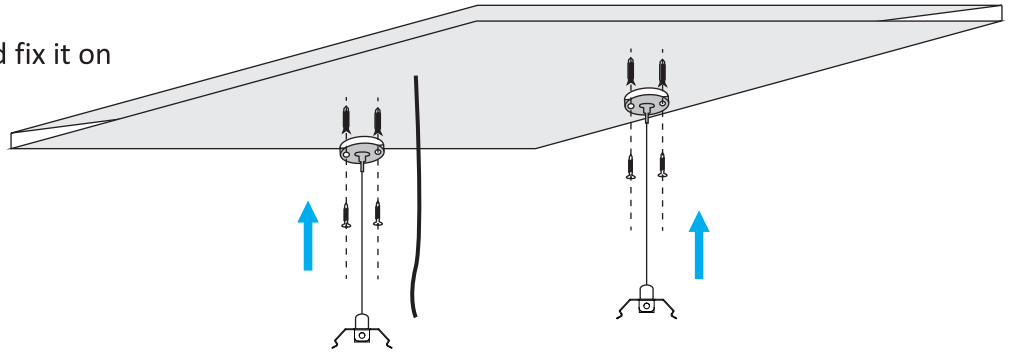
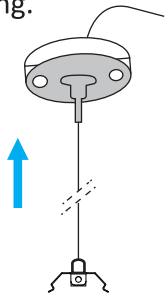

3. Suspension installation

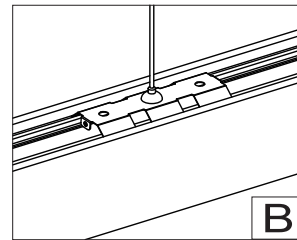
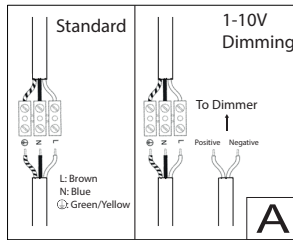
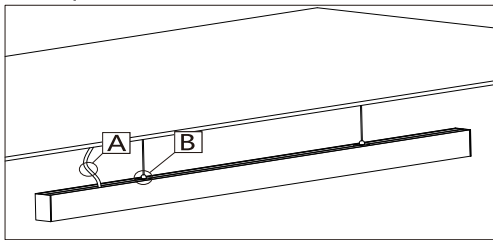

4. Linked installation

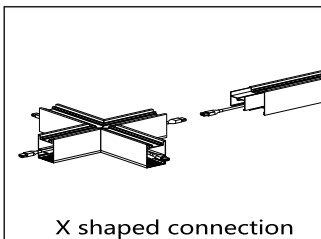
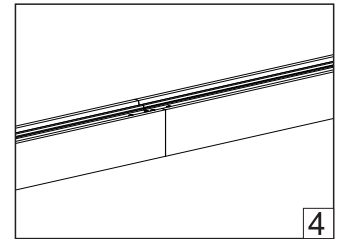
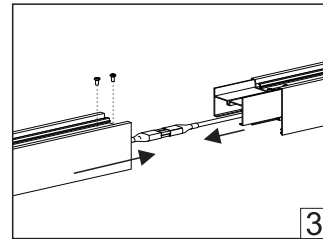
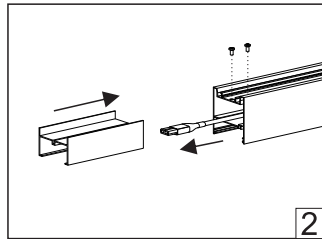
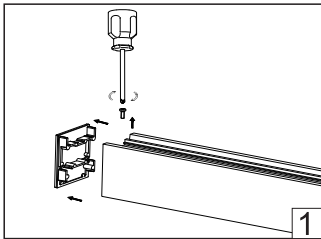

X shaped connection

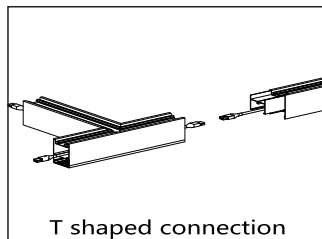

T shaped connection

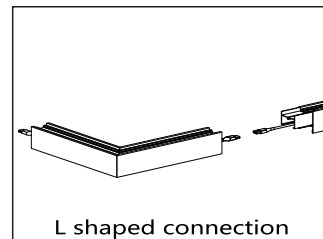

L shaped connection

5. Turn on the main power switch and complete the installation.

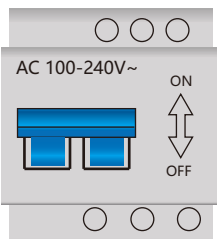

Cautions

1. Input voltage: 220-240VAC, 50Hz.
2. Maximum rated power for linkable linear light is **1000W**.
3. Cut off the power before installation, maintenance, and replacement.
4. Do not connect the power before the light has been installed correctly.
5. Do not install the light on any damaged or deformed ceiling.
6. Cut off the power immediately if any exceptional cases happen and contact a professional engineer.

Surface Mount

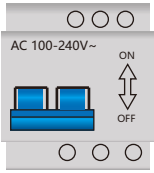

1. Turn off the main power switch.

2. Take out the light fitting and fix it on the ceiling.

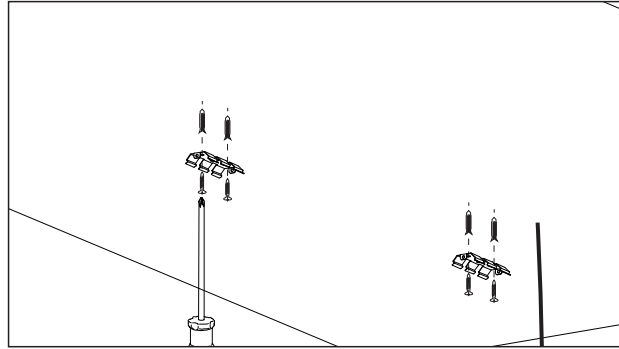
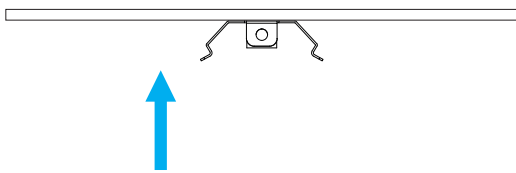

3. Surface Mount Installation

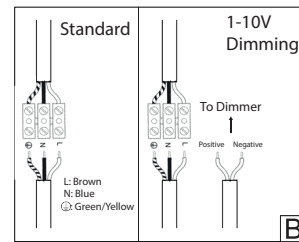
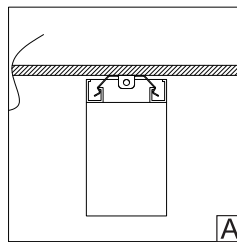
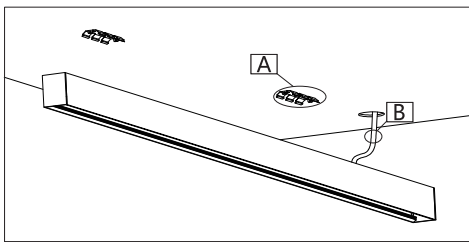

4. Linked installation

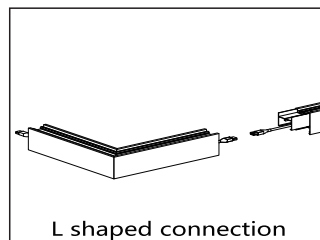
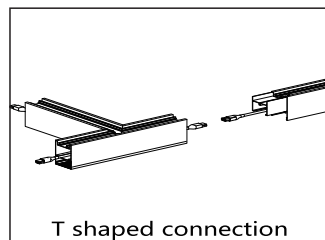
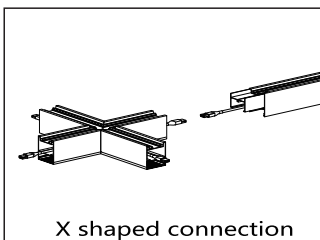
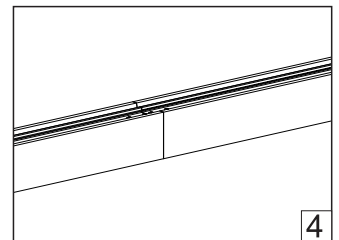
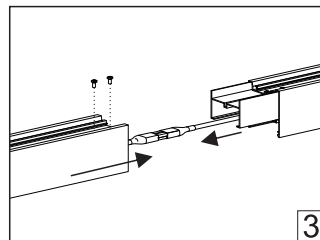
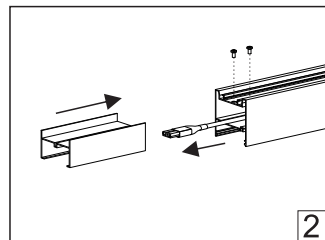
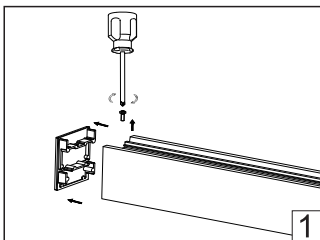

5. Turn on the main power switch and complete the installation.

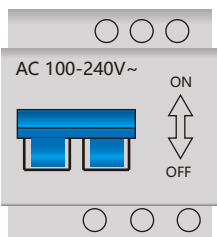

Cautions

1. Input voltage: 220-240VAC, 50Hz.
2. Maximum rated power for linkable linear light is **1000W**.
3. Cut off the power before installation, maintenance, and replacement.
4. Do not connect the power before the light has been installed correctly.
5. Do not install the light on any damaged or deformed ceiling.
6. Cut off the power immediately if any exceptional cases happen and contact a professional engineer.