



LED WALL LIGHT

Installation Instructions

Warning

1. Installation only to be carried out by a qualified electrician.
2. Make sure all electrical connections are in accordance with the safety codes.
3. Turn off power at fuse or circuit breaker before installation or servicing.

Model	Dimension(mm)	Beam Angle
WL-A-RD-16W	180(L)*75(W)*85(H)	36°
WL-A-SQ-16W	180(L)*75(W)*85(H)	36°
WL-B1-UD-10W	58.5(L)*73.5(W)*128(H)	36°
WL-B1-D-5W	58.5(L)*73.5(W)*103(H)	36°
WL-B2-UD-10W	155(L)*65(W)*75(H)	36°
WL-B2-D-5W	75(L)*65(W)*75(H)	36°
WL-T2-2W	80(L)*78(W)*35(H)	28°
WL-T4-4W	117(L)*80(W)*38(H)	28°
WL-T6-6W	170(L)*80(W)*40(H)	28°
WL-T8-8W	220(L)*80(W)*45(H)	28°
WL-D-UD-6W	138(L)*40(W)*55(H)	5°

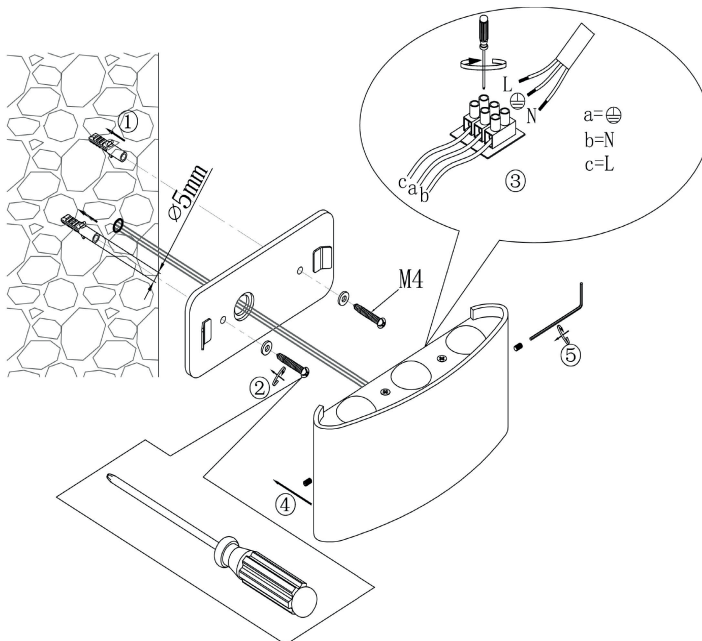

Installation

1. Turn the power off from the fuse board before installation. Drill the holes accordingly to where the light will be fixed.
2. Remove the back casing of the light and fix it to the desired location.
3. Connect the wires from the light to the main voltage wires.
4. Reattach the light to the back casing.
5. Tighten the two side screws on the light.
6. Turn the power on from the fuse board.

For more product information please visit our website www.gws-led.co.uk

53 Summer Lane, Birmingham, B19 3TH Telephone: 01214398181 Email: sales@gws-led.co.uk