



# User Manual

## Tuya Smart WIFI Digital Music Light Panel



G.W.S. LED  
53 Summer Lane, B19 3TH

# Features

1. This product adopts DIY smart splicing scheme, which can splice and shape according to customer needs.
2. Cool lighting effects, colourful, flowing water, rainbow, horse racing, synchronising with music.
3. With classic appearance, compact structure, different shapes can be spliced, and the installation is convenient.
4. APP+music control method.
5. High-quality RGB, and multiple conversion modes.
6. Low voltage 24V power supply, any single product can be used to supply power for the overall shape.

# Parameters

Model	Colour	Voltage	Power	Control	Parts List
FWWSCB-33-6	Dreamcolour	DC24V	6*2W	IR+APP	Ruler x 1      Fixed card x 12 Controller x 1    Connecting piece x 6 3M adhesive x 18
FWWSCB-33-9	Dreamcolour	DC24V	9*2W	IR+APP	Ruler x 1      Fixed card x 18 Controller x 1    Connecting piece x 9 3M adhesive x 27
FWWSCB-33-12	Dreamcolour	DC24V	12*2W	IR+APP	Ruler x 1      Fixed card x 24 Controller x 1    Connecting piece x 12 3M adhesive x 36

# Dimension

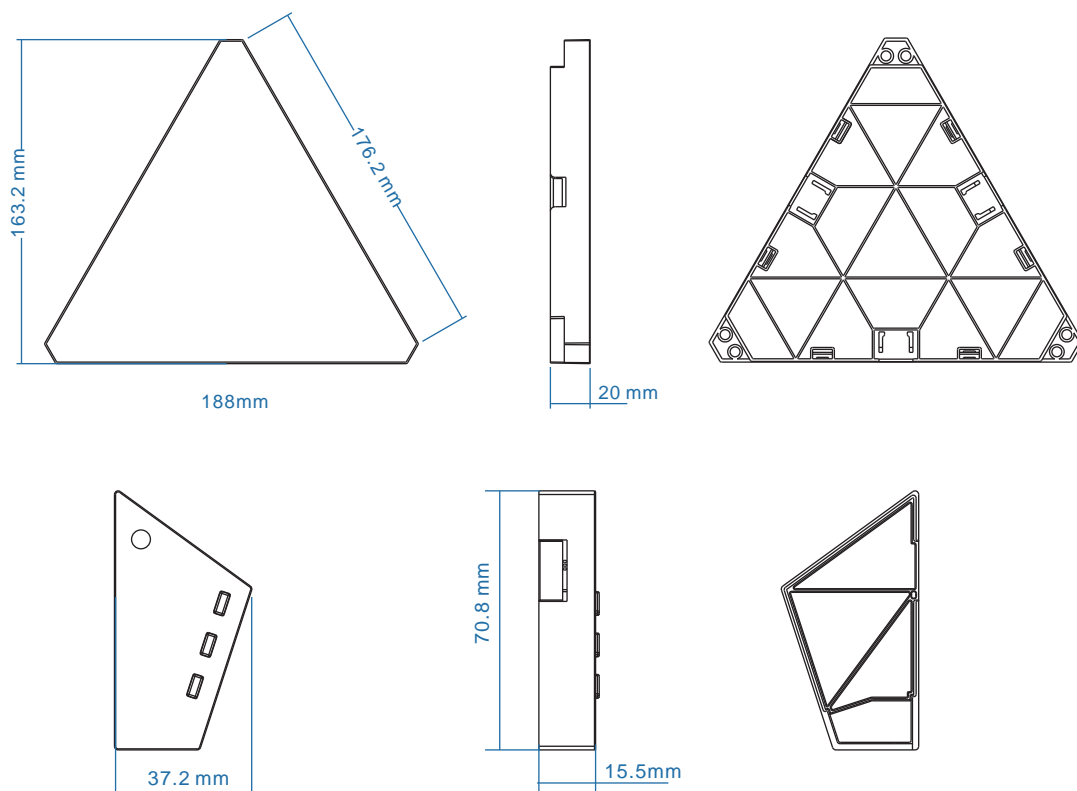

# Modeling Reference

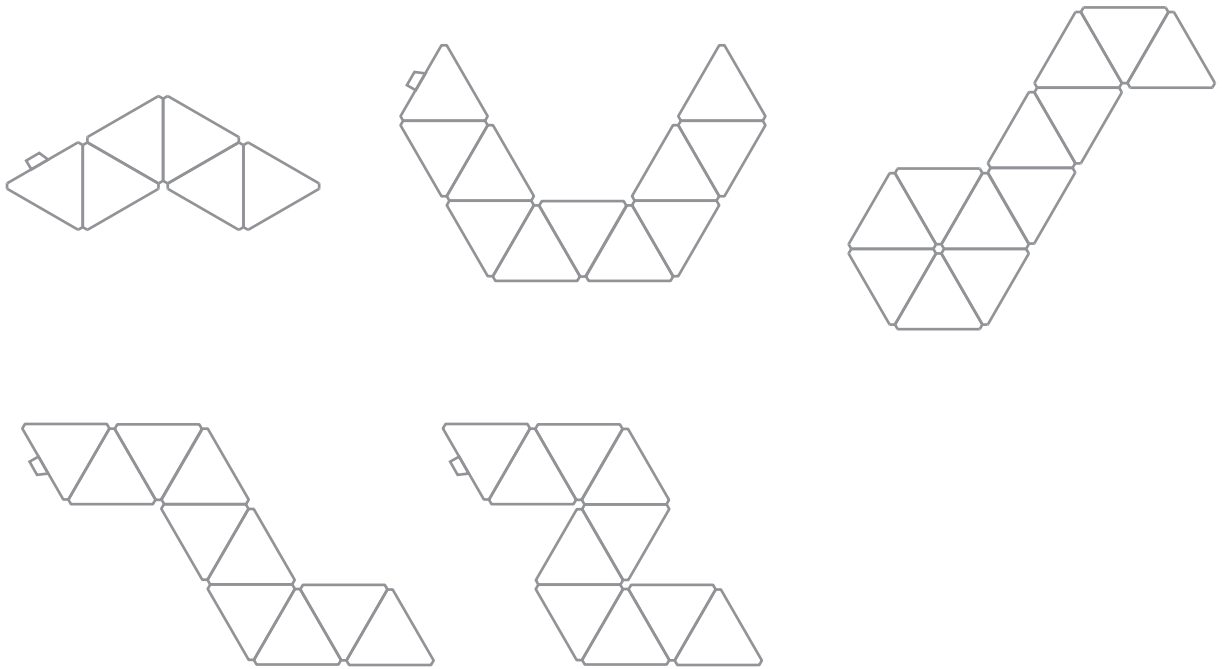

# Product Function Diagram

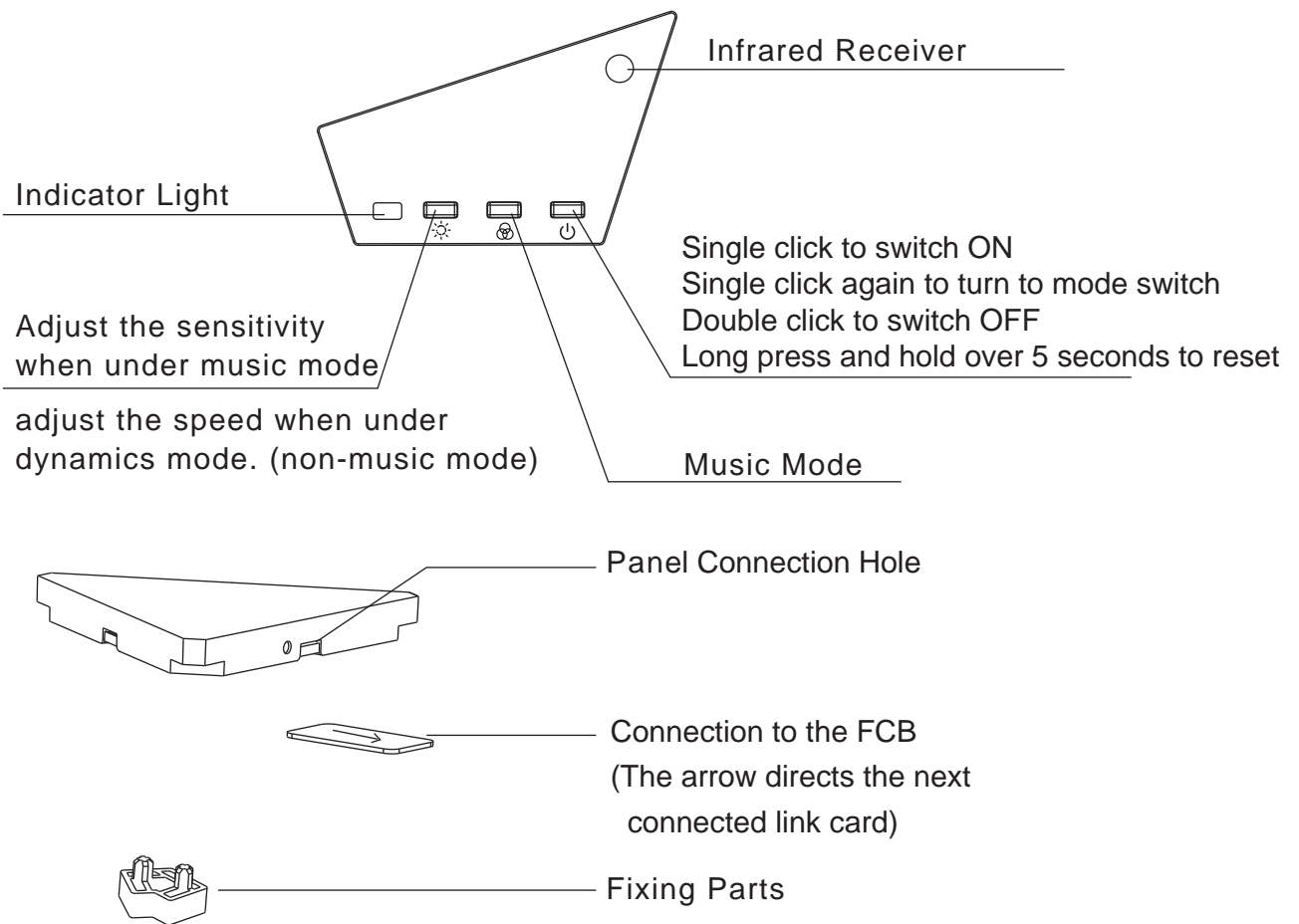

# Installation

1: Unpack the package, check whether the appearance is intact, and whether the number of accessories is correct: Design the shape according to your own preferences and set it up. Figure ① ②

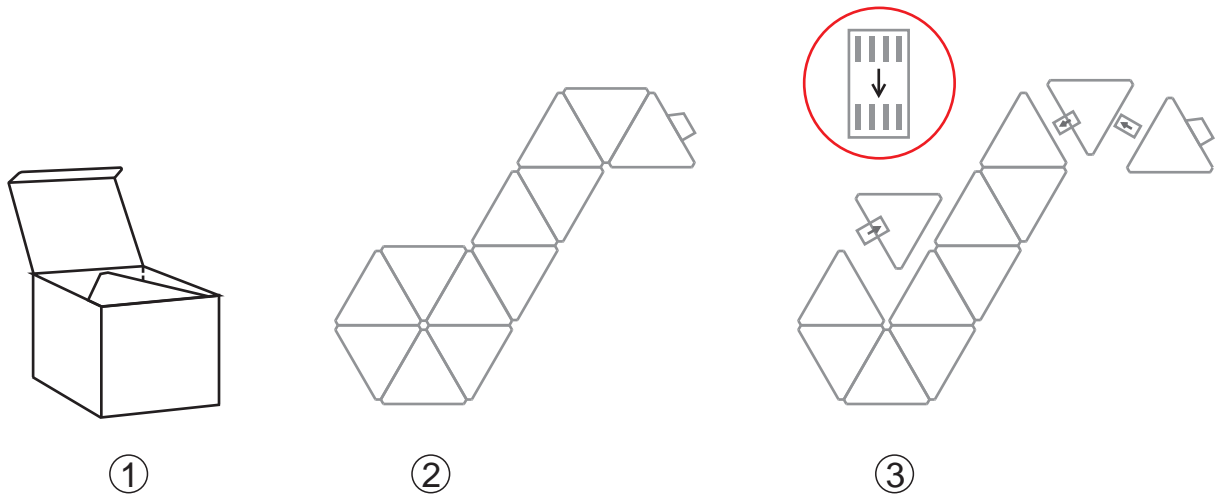

2: Determine the initial position of the lamp body running, and insert the controller on the lamp body in the initial position. Figure ②

3: Insert the connecting piece in the order of the initial position, insert the opposite port on any side of the next lamp body pointed by the arrow, and insert a lamp body pair port on the arrow tail (one input and one output are recommended for each lamp body). Figure ③

4: Complete the splicing of the remaining lamp bodies in sequence, and the controller connects directly to the 24V adapter to light up. Figure ④

5: Download the APP (see page 7 ) and connect, test whether the whole light can be lit, switch, scene mode, customise whether the relevant commands are executed normally, and test to ensure everything is OK. Figure ④

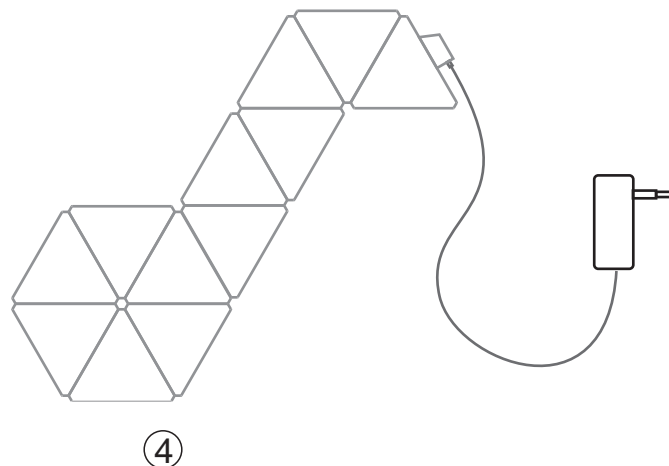

6: Turn each piece of the lamp body in order (rear side) and splice it in the opposite direction (make sure to insert the connecting piece according to step 3). Figure ⑤



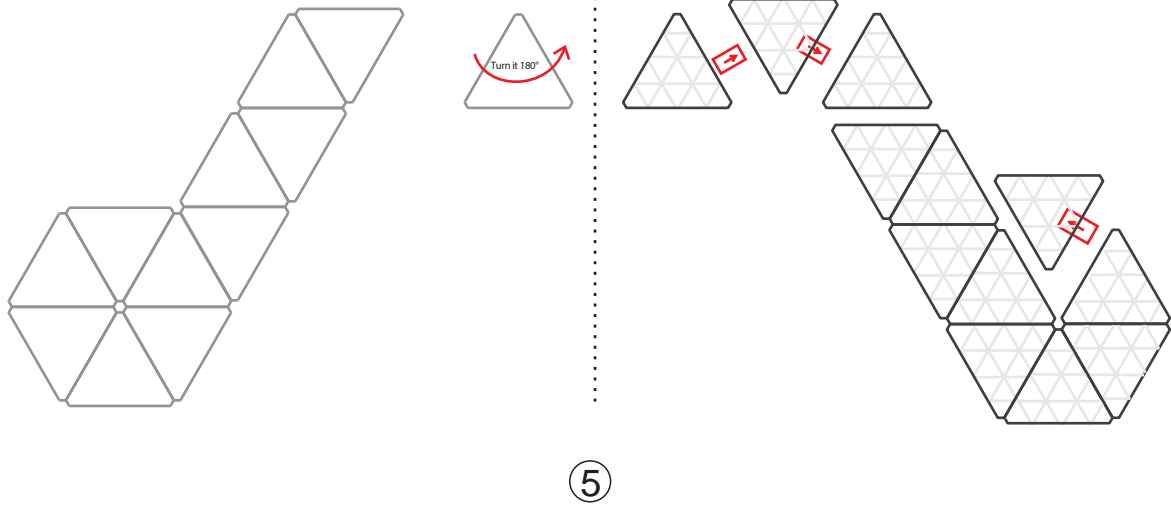

⑤

7: Fix the fixing clips on the fixing holes of the two lamp bodies. Figure ⑥

8: Tear off the 3M adhesive white centrifugal paper, and stick it on the 3 corners of the lamp body (each piece of 3PCS). Figure ⑦

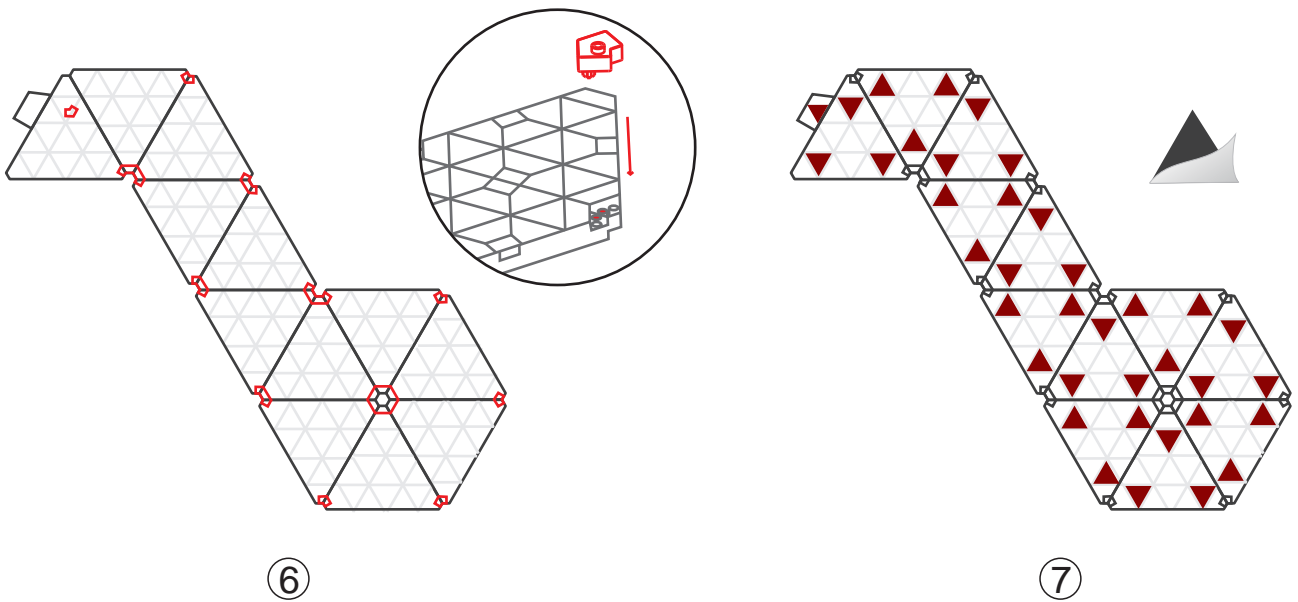

⑥

⑦

9: Grasp 3M adhesive. Figure ⑧

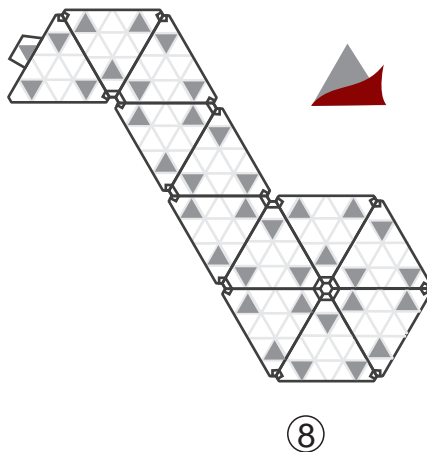

⑧

10: Determine the installation position, clean the surface, and move it as a whole, turn it 180°, return the light-emitting surface back to the wall, and press the 3M glue surface against the wall. Figure ⑨

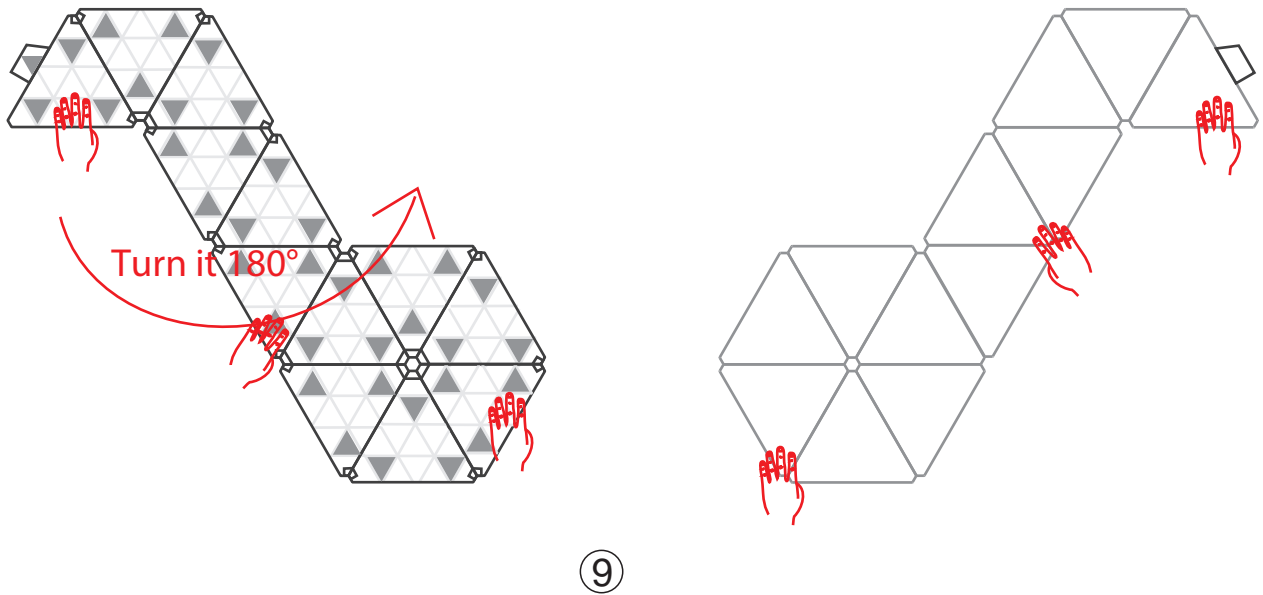

11: Check that the installation is OK, plug in the adapter, and power on to enjoy the fun of lighting.

# Download APP

1: Search "Smart Life" from App store or Google play.



2: Scan the QR code from the label or user manual.

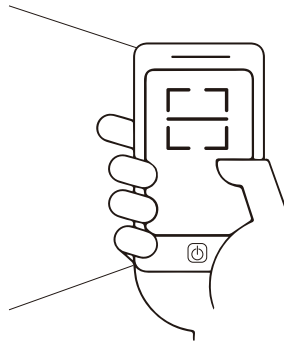

The APP is compatible with Android 5.0 and IOS 10.0 and higher version.



Android 5.0



iOS10.0

## Log in / Register account number

Open the Smart APP, sign up for a new account or log in with an existing account.

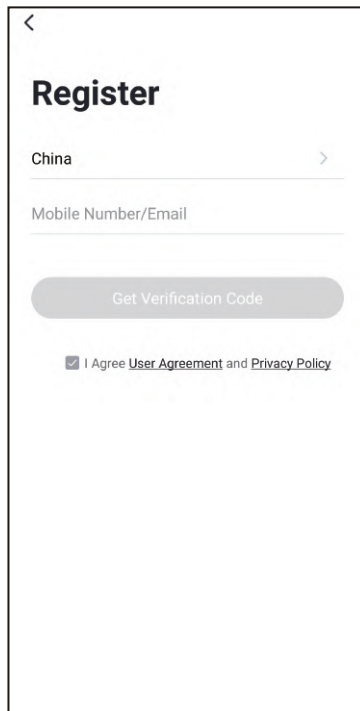
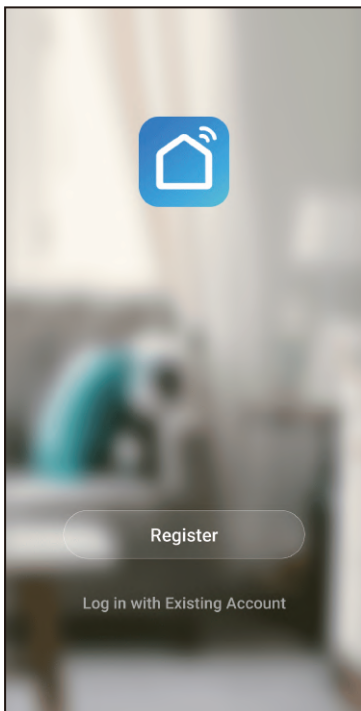

# APP connection

1. Preparation: Turn on the LED and open the APP, while ensuring the signal is stable.
2. The LED will flash when turned on. Add all devices on the APP using the 'adding lighting' interface, match the LED.

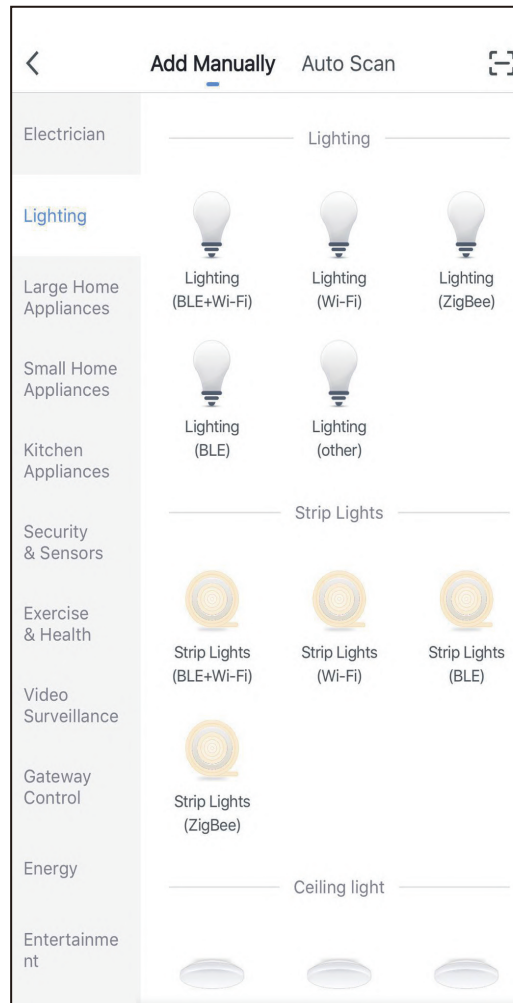
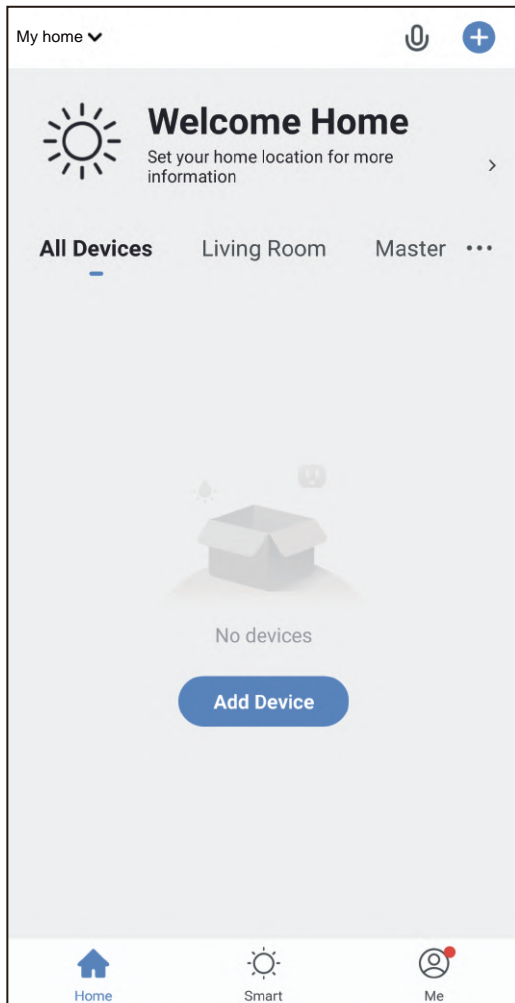

3. If the LED is not flashing when turned on, long press and hold the Reset button for more than 5 seconds. The LED will then flashes. While the LED is flashing go to the APP 'adding lighting' interface and match the LED.

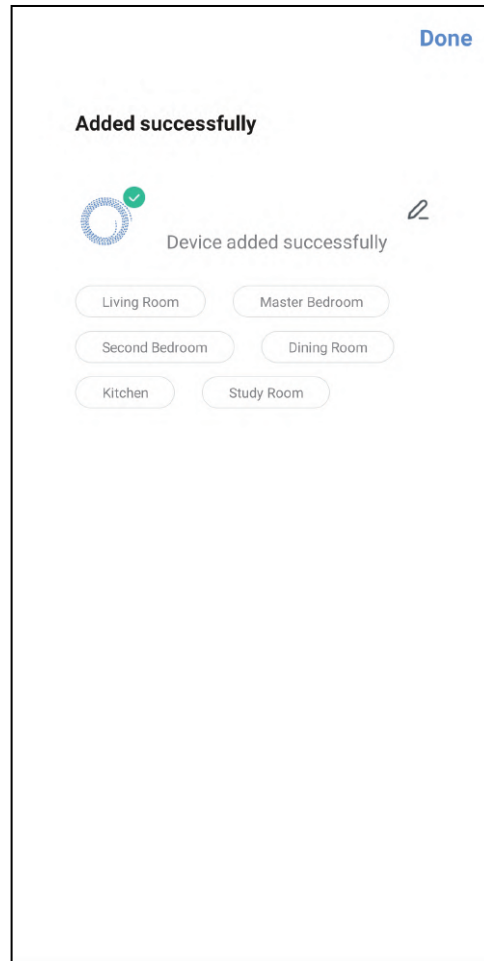
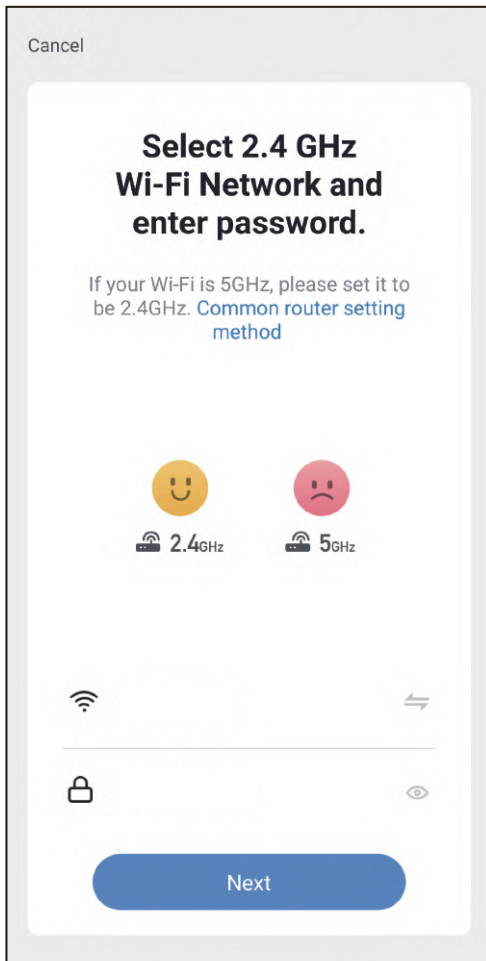

# Introduction to the interface:

After pairing is successful, adapt the control quantity on the app to be same as the exact quantity of lights. The defaulted control quantity on the app is 9pcs, if the exact quantity of lights is over 9pcs, please go and adapt the control quantity.

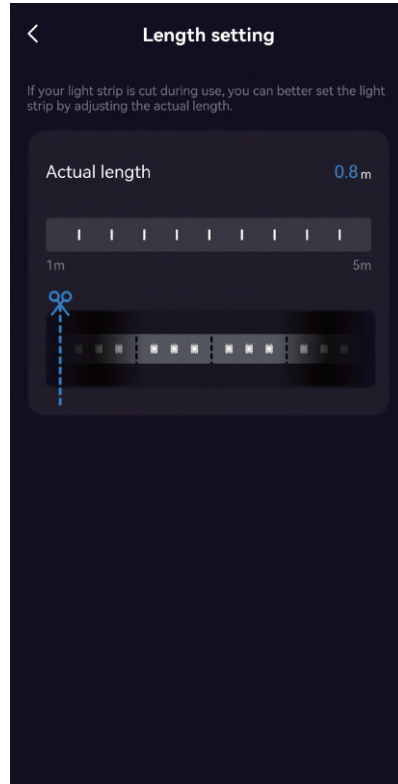
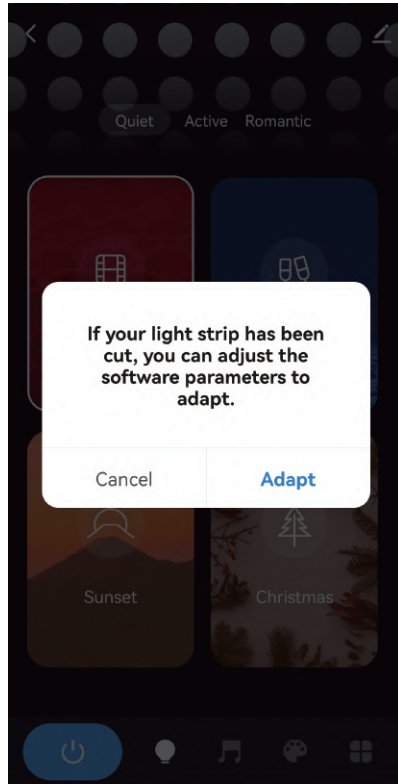

If this function is not selected when pairing, please adjust it in the setting interface.

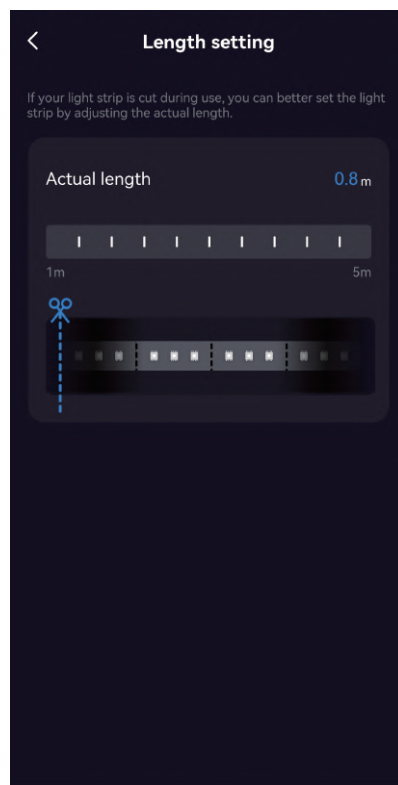
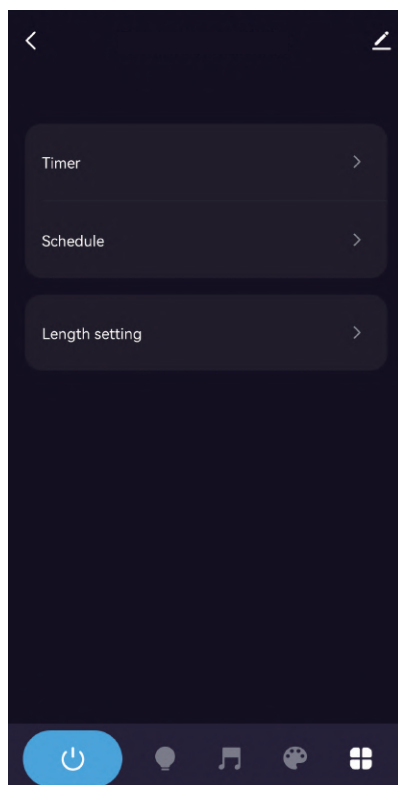

The scheduled scenes of the APP function are: quiet, active and colourful (Figure 1 2 3).

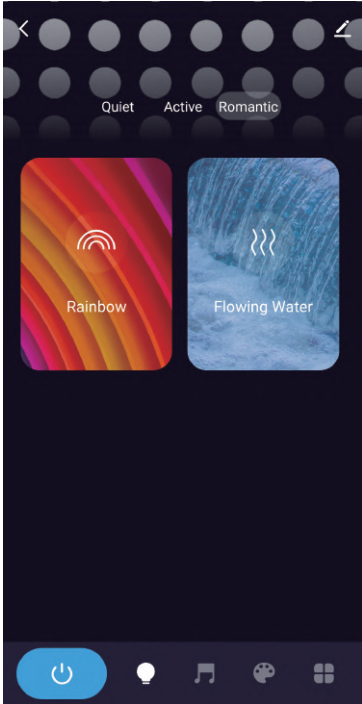
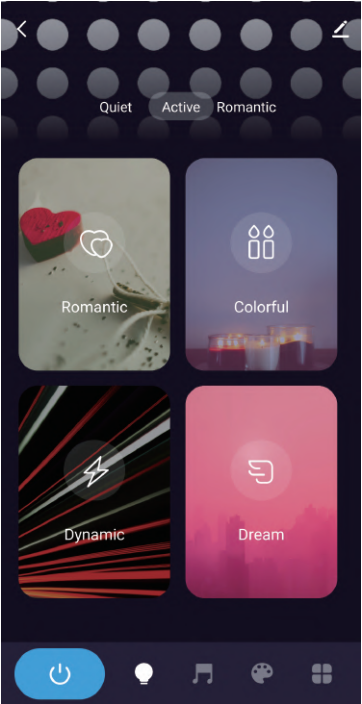
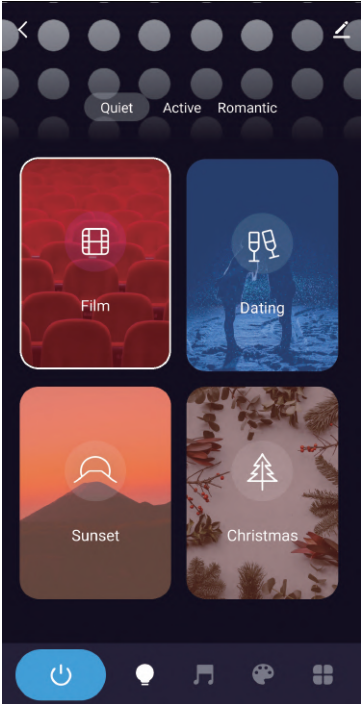

Digital music mode (Figure 4)

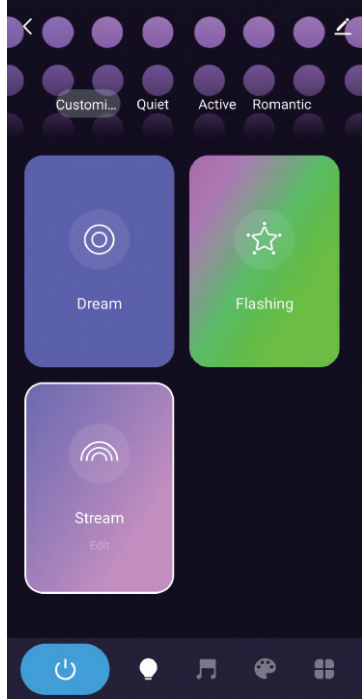
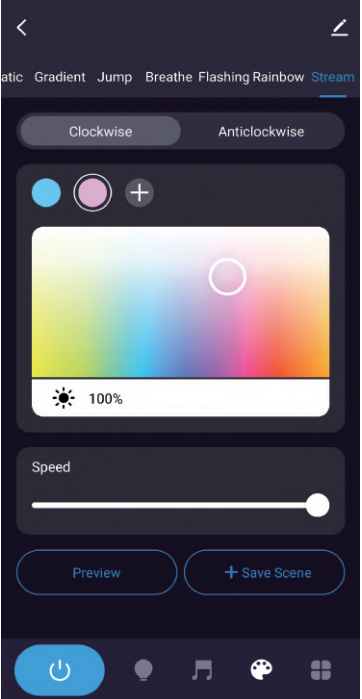
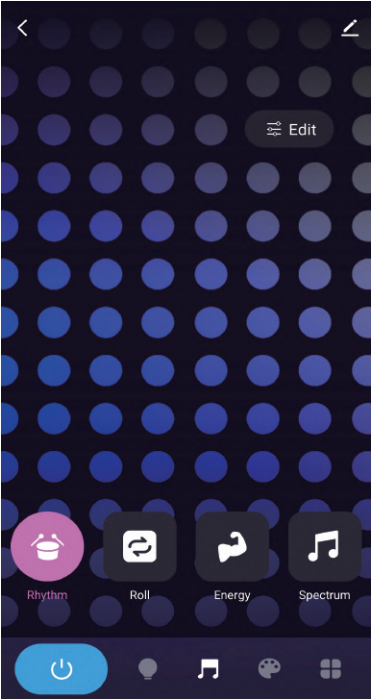

APP scene custom multiple modes (after the definition is successful, the mode will automatically appear in the scene interface)  
Figure 5 Figure 6



# IR Music remote controller manual

## Product introduction:

The 19 keys IR remote control include various dreamcolour modes i.e. running water and music modes etc.

## Parameters:

Power supply: 3V button cell

Control distance: 5-8 meters in open area

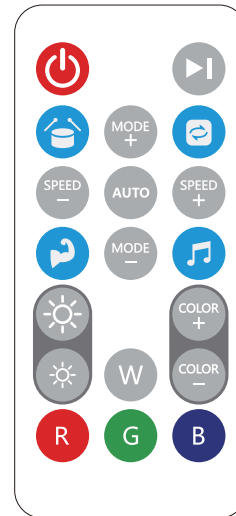

## Instructions of remote control:

Please remove the PVC insulation sheet from the end of the remote control before using. Please set the APP internet connection as priority when the light is flashing.

Features	Action	Remote control buttons
ON/OFF	Short Press	
Pause/beat	Short Press	
Speed/sensitivity	Short Press	
Dynamic mode switching	Short Press	
Music mode	Short Press	
Automatic mode	Short Press	
Brightness +/-	Short Press	
Static color switching	Short Press	
W R G B	Short Press	