



LED GIMBAL LIGHT

Installation Instructions

Warning

1. Installation only to be carried out by a qualified electrician.
2. Make sure all electrical connections are in accordance with the safety codes.
3. Turn off power at fuse or circuit breaker before installation or servicing.
4. Pre-cut the hole before installation (see below chart for the hole diameter).

Model	Dimension(mm)	Cut-Out(mm)
GB-RD-7W	85(Ø)*67(H)	75(Ø)
GB-RD-10W	112(Ø)*90(H)	100(Ø)
GB-RD-20W	140(Ø)*120(H)	125(Ø)
GB-RD-30W	165(Ø)*135(H)	150(Ø)
GB-RD-40W	190(Ø)*160(H)	175(Ø)

120
Lms/W

36°

Flicker
Free

IP20

CRI
>80

2
Years
Warranty

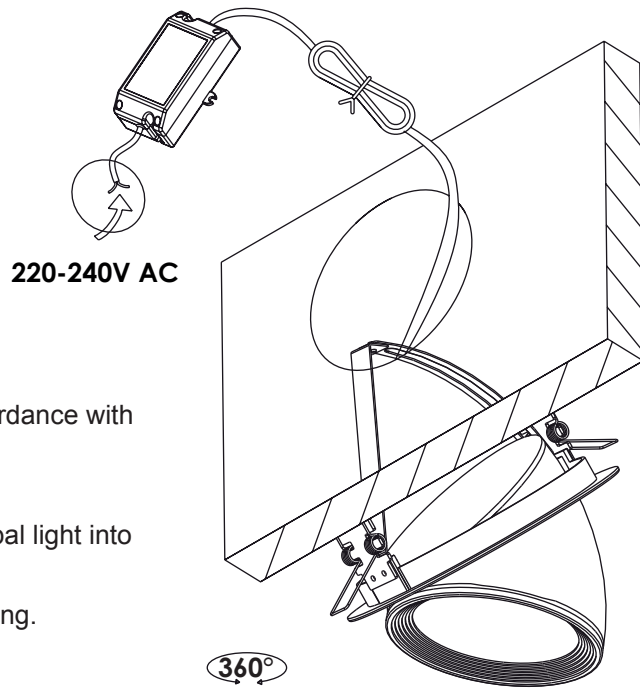
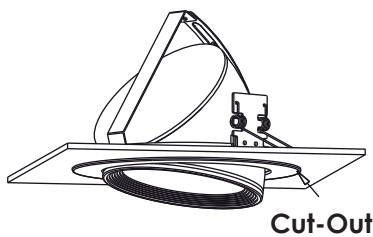

220-240V AC

Installation

1. Cut a hole in the ceiling.
2. Connect the driver to mains electricity in accordance with current wiring regulation.
3. Connect the gimbal light to the driver.
4. Push back the spring clips and insert the gimbal light into the ceiling.
5. Ensure the gimbal light is a flush fit to the ceiling.

