

Thank you for your custom. Please read this manual carefully before installation and keep it safe for your reference.

**Attention:**

1. This lamp must be installed/dismantled by a qualified electrician.
2. The input voltage to the driver inside of the lamp is AC220-240V 50Hz.
3. Ensure the power is switched off before installation/dismantling/maintenance.  
Check power cable is properly connected before switching the lamp on.
4. Always follow the fire code (NFC/UFC) and allow at least 7.5cm space for ventilation.
5. Do not install the lamp on combustible, plaster board, sloping, or damaged surface.
6. Under no circumstances should the lamp be covered with insulation blankets or any other similar materials.
7. Do not wipe lamp with damp or wet cloth.

**Installation Instruction:**

1. Twist diffuser anticlockwise to remove from lamp body.
2. Fix installation plate to ceiling/wall with screws.
3. Connect the wires(L for live wire,N for null wire)and fix the lamp to the installation plate.
4. Return the diffuser to the lamp by twisting it clockwise onto the body of the lamp.

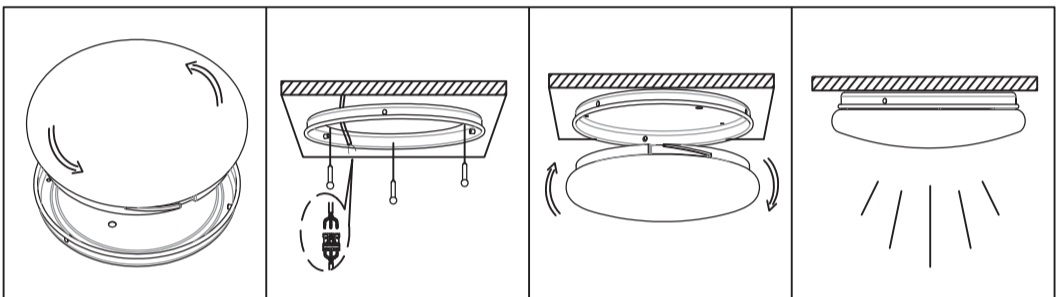

**Special Attention:**

1. Don't dismantle the lamp or unscrew the led board,otherwise it will affect the heat dissipation,and reduce the lifespan of the led ceiling light.
2. if you have any question about the product,please consult our professional engineers.

**Remote Control Guide:**

Turn off	①	OFF	ON	②	Turn on
Brighten the light	③			④	Change the light modes
Decrease color temperature	⑤			⑥	Increase color temperature
Dim the light	⑦			⑧	White light
Warm light	⑨	3000K Warm	6000K White	⑩	Natural light
Night light	⑪	4000K Natural	⑫	Auto turn off after 30 Mins	

**Wall Switch**  
Without the remote control, the light can also be changed by the wall switch.

Open the cover  
2 pcs of AAA batteries needed  
Note: Batterie Not Included

