

Attention:

01. This lamp must be installed/dismantled by a qualified electrician.
02. The input voltage to the driver inside of the lamp is AC220-240V 50Hz.
03. Ensure the power is switched off before installation/dismantling/maintenance.
04. Check power cable is properly connected before switching the lamp on.
05. Always follow the fire code (NFC/UFC) and allow at least 7.5cm space for ventilation.
06. Do not install the lamp on combustible, plaster board, sloping, or damaged surface.
07. Under no circumstances should the lamp be covered with insulation blankets or any other similar materials.
08. Do not wipe lamp with damp or wet cloth.

Installation Instruction:

01. Unscrew the installation plate from the lamp.
02. Fix installation plate to ceiling/wall with screws.
03. Connect the utility supply (L for Live wire, N for null wire).
04. Fix the lamp to the installation plate.

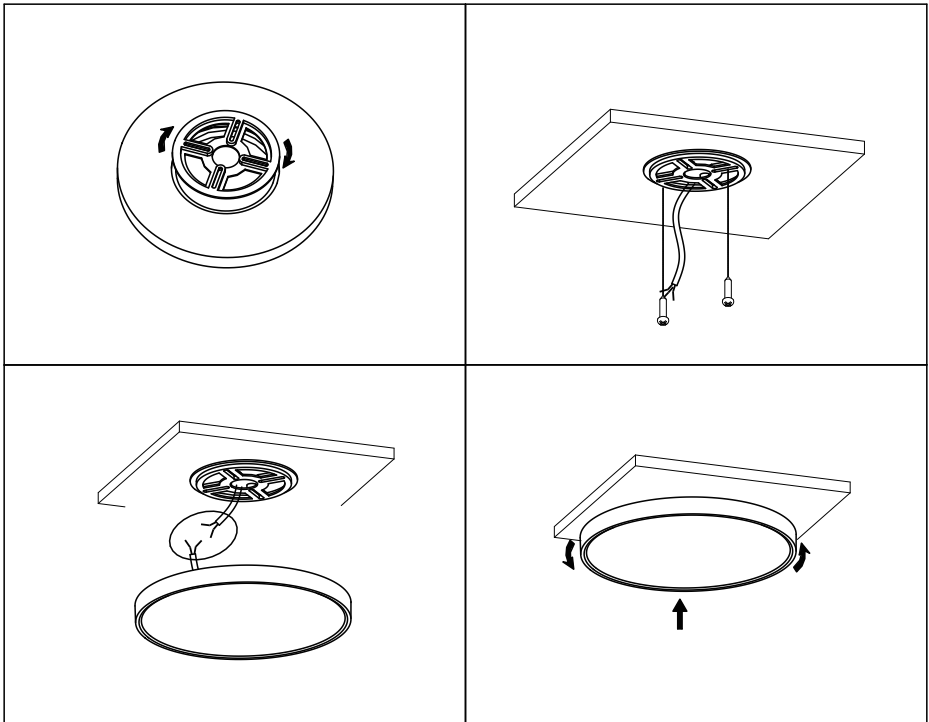

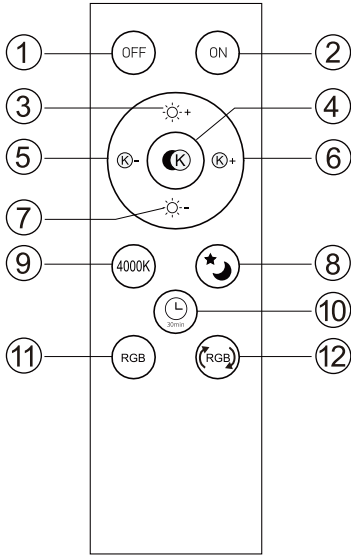

NOTICE:

2 x 1.5V(AAA) Batteries are needed but not included in the remote control.

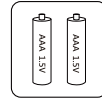

TIPS:

When use remote control OFF button to turn OFF the light, if you want to use the wall switch to turn on the light, then need to turn OFF the light >3s can be turned on

1		Turn off / Long press to turn off the side lighting
2		Turn on / Long press to turn on the side lighting
3		Brightness +
4		Color Temperature Switch Mode (3000K/4000K/6000K)
5		Color Temperature -
6		Color Temperature +
7		Brightness -
8		Night Light Mode
9		Natural White
10		Auto turn off after 30 Mins
11		change one color each time you press it
12		6 kinds of dynamic modes, change one mode each time you press it