

First Session

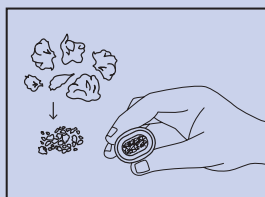

- 1** Flower: Grind material and pack tightly into oven.

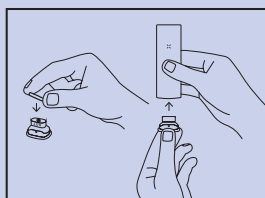

- 2** Concentrates: Remove oven screen. Open concentrate chamber lid. Place material within circle. Close lid, and place insert into oven.

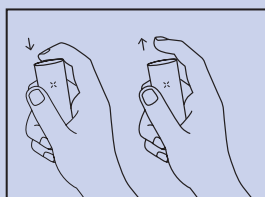

- 3** Press and release mouthpiece to power on your PAX device.

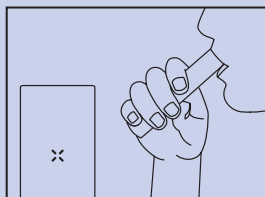

- 4** Device will vibrate and LEDs will illuminate the color of the set Experience Mode when ready. Enjoy! "Sip it, don't rip it."

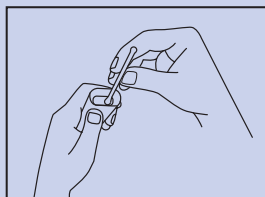

- 5** Use included maintenance kit to clean device every 3-5 uses.

Visit pax.com/support for tips.

Experience Modes

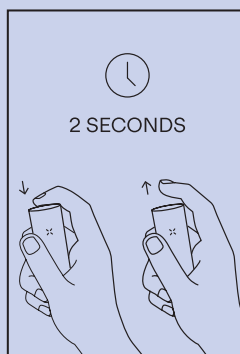

With device powered on, long-press mouthpiece for 2 seconds and release.

Use short presses to cycle through Experience Modes.

To select a Mode, long-press mouthpiece again or simply shake your PAX device.

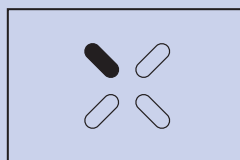

STEALTH MODE

Produces minimal vapor; dims LEDs and vibration settings for discreet sessions.

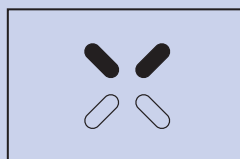

EFFICIENCY MODE

Conserves material for longer lasting sessions.

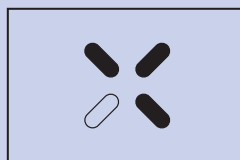

FLAVOR MODE

Delivers a balance of flavor and vapor throughout your sessions.

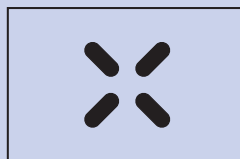

BOOST MODE

Provides maximum vapor production, ideal for concentrates.

Device Anatomy

Flat Mouthpiece



Raised Mouthpiece

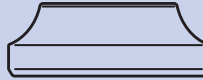

Indicator LEDs



Charge Pins

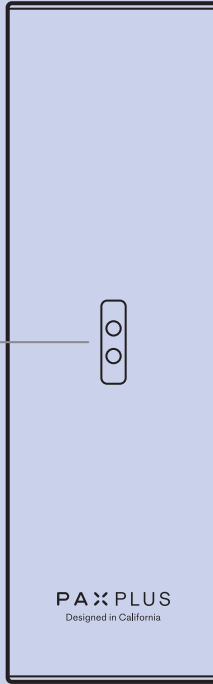

Multi-Tool



Oven

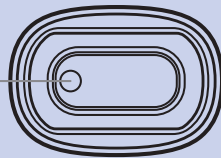

Screen



Standard Lid



Half-Pack Lid

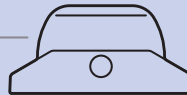

Chamber Lid & O-Ring



Concentrate Chamber



Concentrate Insert

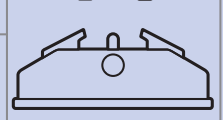

Fully read Safety and Warning Guide before using this device