

# X1/X2

UNIVERSAL KIT FOR FRAMELESS DOORS

XINIX<sup>®</sup>  
DOOR SYSTEMS

INSTALLATIE HANDLEIDING - GUIDE D'INSTALLATION  
INSTALLATION MANUAL - INSTALLATIONSANLEITUNG





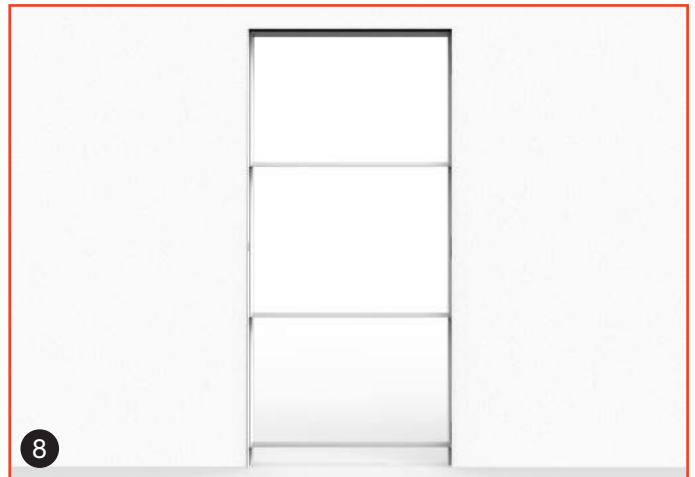

**X240** - UNIVERSAL KIT FOR DOOR THICKNESS - 40/50 mm

**X245** - UNIVERSAL KIT FOR DOOR THICKNESS - 44-45/55 mm

**X250** - UNIVERSAL KIT FOR DOOR THICKNESS - 50/60 mm

**EU RECHTS | DROIT | RIGHT**



**Trekken EU rechts**  
**Tirant EU droit**  
**Pull EU right**  
**Ziehen DIN Rechts**

**Duwen EU rechts**  
**Poussant EU droit**  
**Push EU right**  
**Drücken DIN Rechts**



**EU LINKS | GAUCHE | LEFT**



**Trekken EU links**  
**Tirant EU gauche**  
**Pull EU left**  
**Ziehen DIN Links**

**Duwen EU links**  
**Poussant EU gauche**  
**Push EU left**  
**Drücken DIN Links**



**DEURFRAME | CADRE DE PORTE | DOOR FRAME | UNIVERSALZARGE**

- 1** **Standers + bevestigingsprofielen**  
 Montants + profilés de fixation  
 Uprights + fixing profiles  
 Ständer + Befestigungsprofile
- 2** **Kopstuk + afstandhouders**  
 Traverse + entretoises  
 Upper rail + spacers  
 Querleiste + Abstandhalter
- 3** **Afwerkingsprofiel XA-FIN \***  
 Profil de finition \*  
 Finition profile \*  
 Fertigungsprofil \*

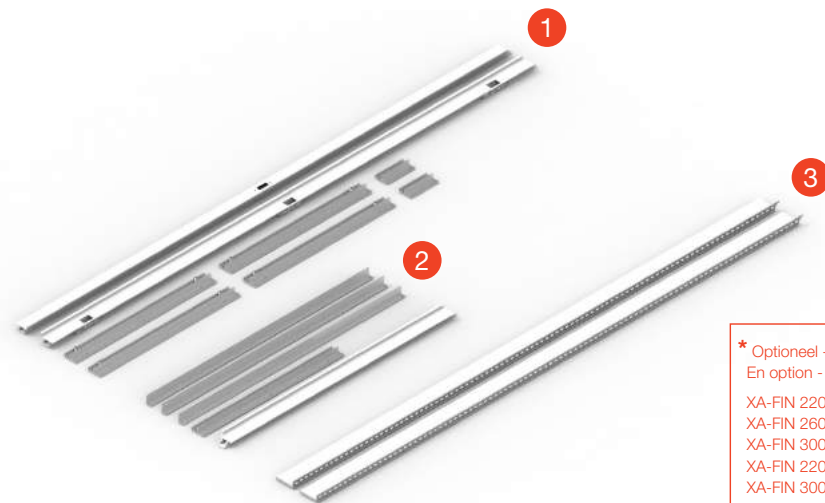

\* Optioneel - Option  
 En option - Option  
 XA-FIN 2200 x 120 x 9  
 XA-FIN 2600 x 120 x 9  
 XA-FIN 3000 x 120 x 9  
 XA-FIN 2200 x 260 x 9  
 XA-FIN 3000 x 260 x 9

**XINNIX SELECTION DEURBESLAG | QUINCAILLERIE | HARDWARE | BESCHLÄGE**



**X240** - UNIVERSAL KIT FOR DOOR THICKNESS - 40/50 mm

**X245** - UNIVERSAL KIT FOR DOOR THICKNESS - 44-45/55 mm

**X250** - UNIVERSAL KIT FOR DOOR THICKNESS - 50/60 mm

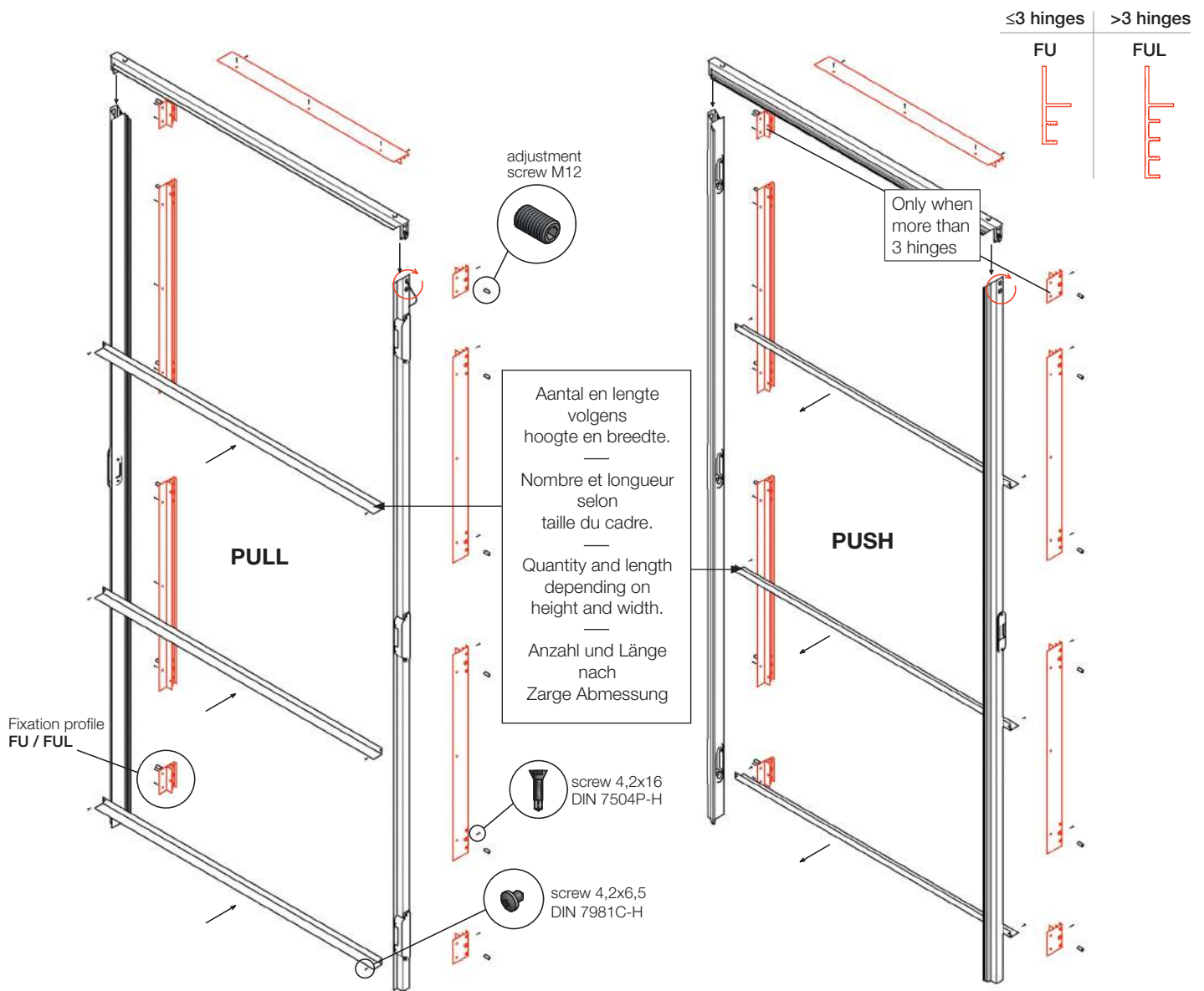

**XP50<sup>®</sup>** - UNIVERSAL INTEGRATED XINNIX PLINTH

- a** X2
- b** XP50-C002
- c** XP50 + XP50-Cover
- d** XP50-C001
- e** XP50-A045 (+45° / -45°)

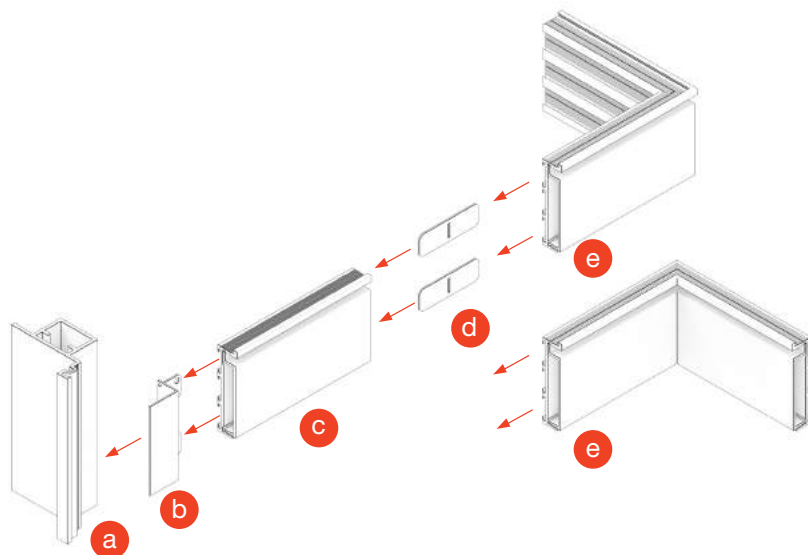

**X240** - UNIVERSAL KIT FOR DOOR THICKNESS - 40/50 mm

**X245** - UNIVERSAL KIT FOR DOOR THICKNESS - 44-45/55 mm

**X250** - UNIVERSAL KIT FOR DOOR THICKNESS - 50/60 mm

## METAL STUD INSTALLATION

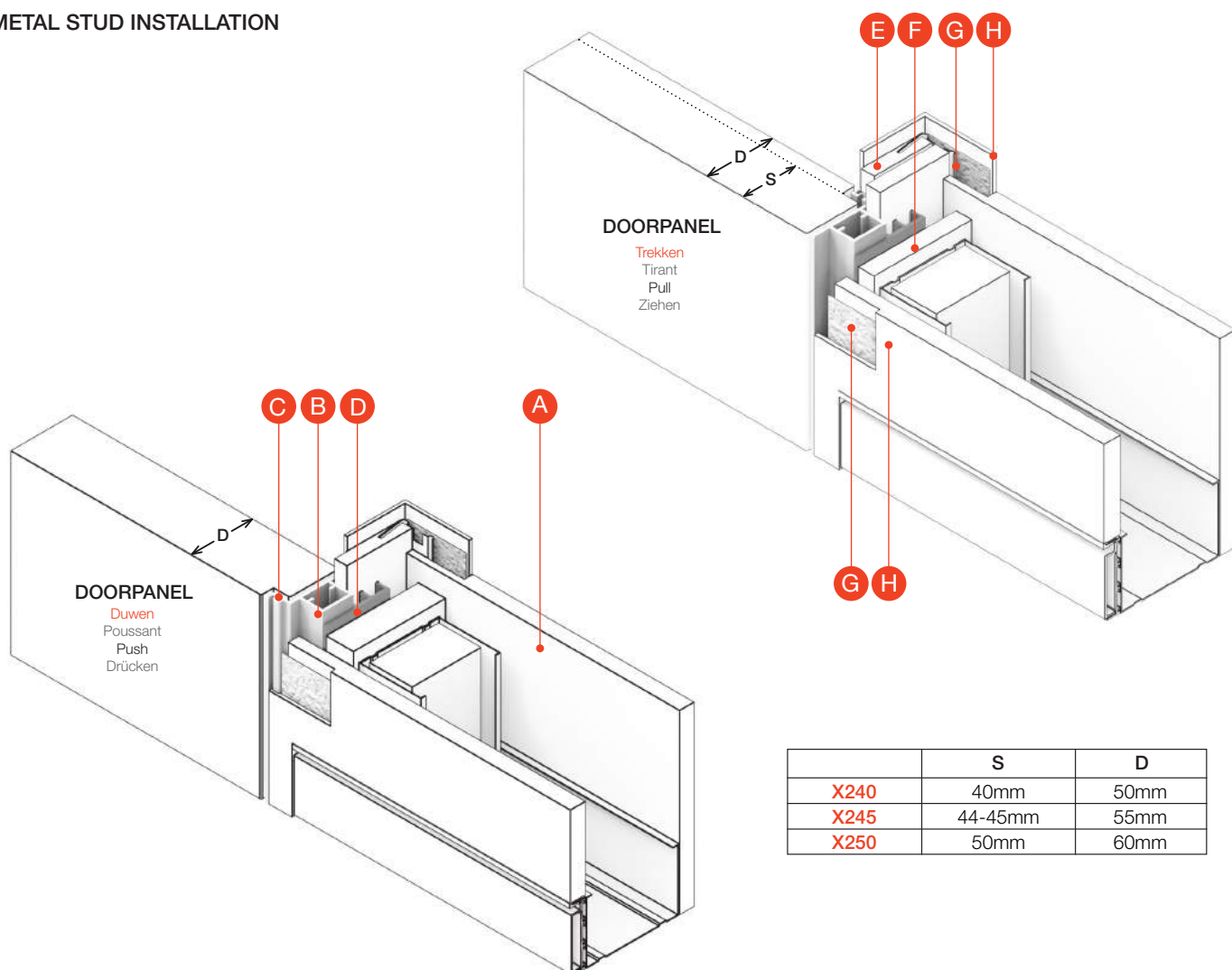

**A** Metal Stud + gipsplaat  
Métal Stud + carton-plâtre  
Metal Stud + plasterboard  
Ständerwerk + Beplankung

**B** Xinnix profiel X2  
Profilé Xinnix X2  
Xinnix profile X2  
Xinnix Universalzarge X2

**C** Slagdichting  
Joint d'étanchéité  
Gasket  
Anschlagdichtung

**D** FU/ FUL profiel met stelschroeven  
Profil de montage FU/ FUL avec des vis de fixation  
Fixing profile FU/ FUL with adjustment screws  
Montageprofil FU/FUL mit Stellschrauben

**E** Afwerkingsprofiel XA-FIN (optioneel)  
Profilé de finition XA-FIN (option)  
Finishing profile XA-FIN (optional)  
Fertigungsprofil Gipskarton mit Verputzecke XA-FIN (optional)

**F** PU schuim (Low Expansion)  
Mousse PU (Low Expansion)  
PU-foam (Low Expansion)  
Pu Schaum (Low Expansion)

**G** Papierpand P50 (niet meegeleverd)  
Bande de papier P50 (non inclus)  
Paper tape P50 (not included)  
Papierband P50 (nicht enthalten)

**H** Opvullaag - Jointfiller Vario, ProMix Premium of gelijkaardig  
Couche de finition - Jointfiller Vario, ProMix Medium ou similaire  
Finishing layer - Jointfiller Vario, ProMix Medium or equivalent  
Verspachtelung - Rigips Vario, Knauf Uniflott oder gleichwertig

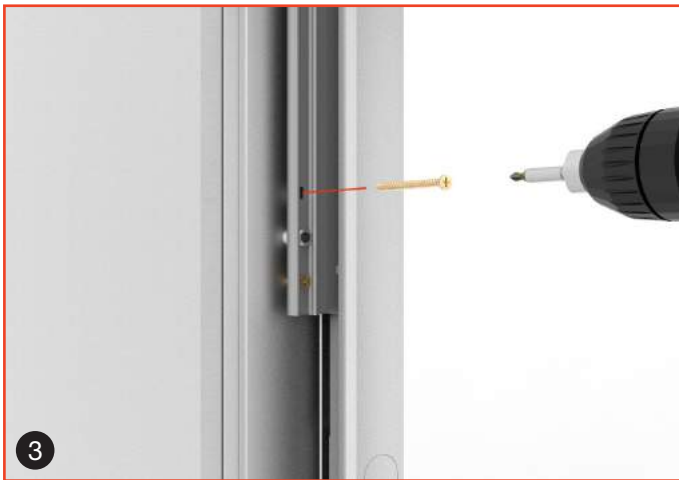
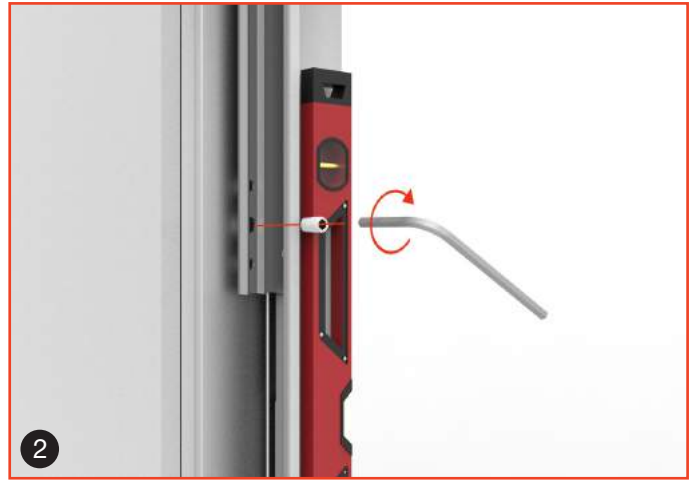
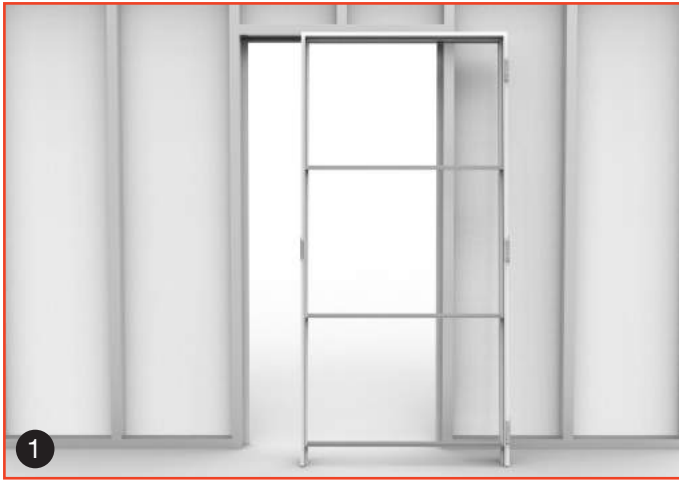

**X240** - UNIVERSAL KIT FOR DOOR THICKNESS - 40/50 mm  
**X245** - UNIVERSAL KIT FOR DOOR THICKNESS - 44-45/55 mm  
**X250** - UNIVERSAL KIT FOR DOOR THICKNESS - 50/60 mm

### BRICK WALL INSTALLATION

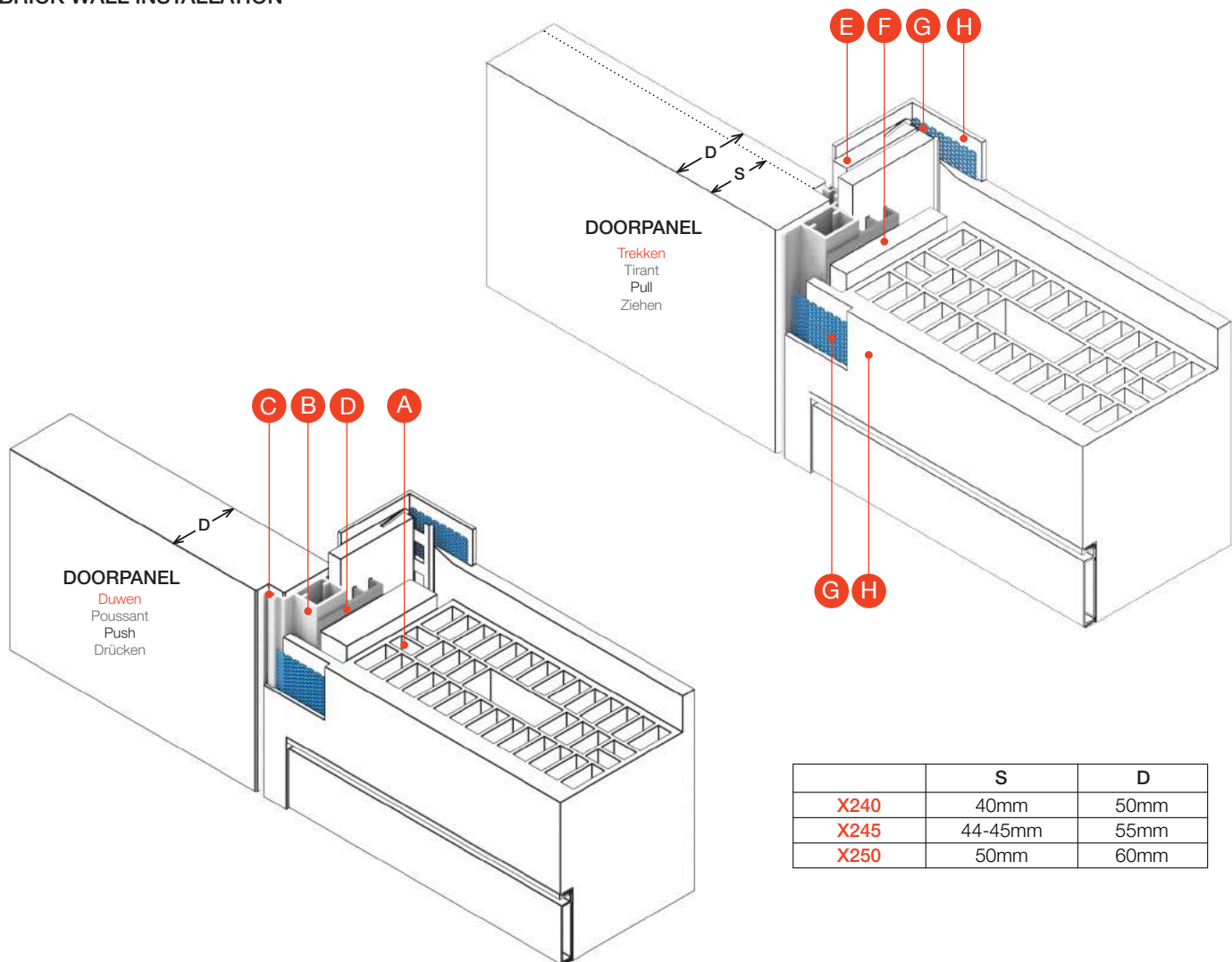

|      | S       | D    |
|------|---------|------|
| X240 | 40mm    | 50mm |
| X245 | 44-45mm | 55mm |
| X250 | 50mm    | 60mm |

**A** Gemetste muur + bepleistering

Mur maçonnerie + plafonnage  
 Brick wall + plastering  
 Mauerwerk + Verputzung

**B** Xinnix profiel X2

Profilé Xinnix X2  
 Xinnix profile X2  
 Xinnix Universalzarge X2

**C** Slagdichting

Joint d'étanchéité  
 Gasket  
 Anschlagdichtung

**D** FU/ FUL profiel met stelschroeven

Profil de montage FU/ FUL avec des vis de fixation  
 Fixing profile FU/ FUL with adjustment screws  
 Montageprofil FU/FUL mit Stellschrauben

**E** Afwerkingsprofiel XA-FIN (optioneel)

Profilé de finition XA-FIN (option)  
 Finishing profile XA-FIN (optional)  
 Fertigungsprofil Gipskarton mit Verputzecke XA-FIN (optional)

**F** PU schuim (Low Expansion)

Mousse PU (Low Expansion)  
 PU-foam (Low Expansion)  
 Pu Schaum (Low Expansion)

**G** Glasvezel Gitex (niet meegeleverd)

Fibre de verre Gitex (non inclus)  
 Fiberglass Gitex (not included)  
 Abdichtungsband Gewebe (nicht enthalten)

**H** Opvullaag - Jointfiller Vario, ProMix Premium of gelijkaardig

Couche de finition - Jointfiller Vario, ProMix Medium ou similaire  
 Finishing layer - Jointfiller Vario, ProMix Medium or equivalent  
 Verspachtelung - Rigips Vario, Knauf Uniflott oder gleichwertig



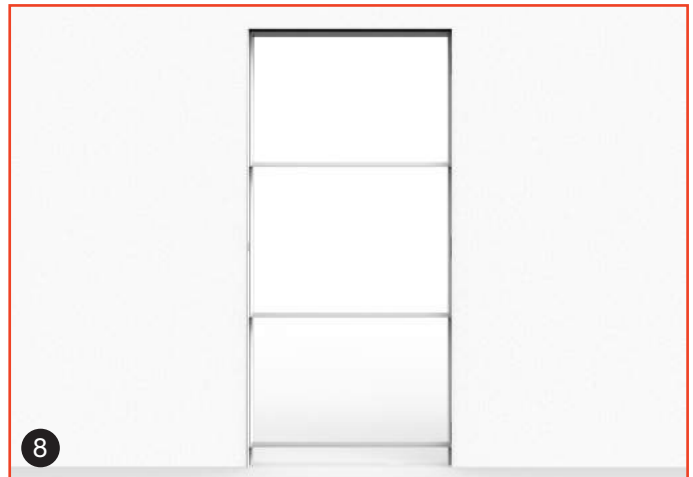
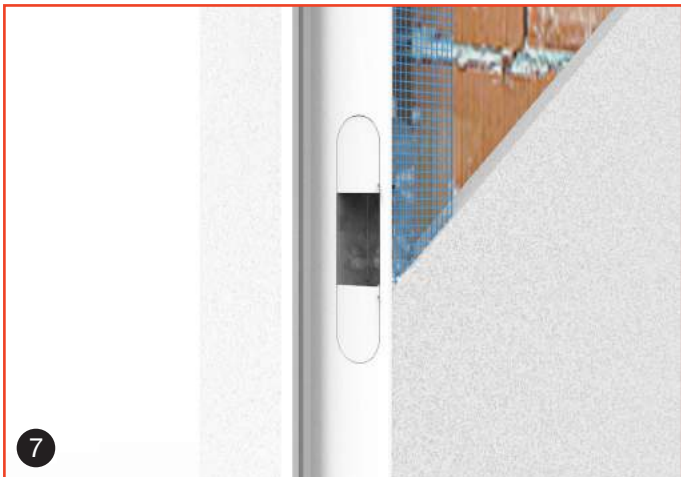

# X1 / X2 - MEASUREMENTS

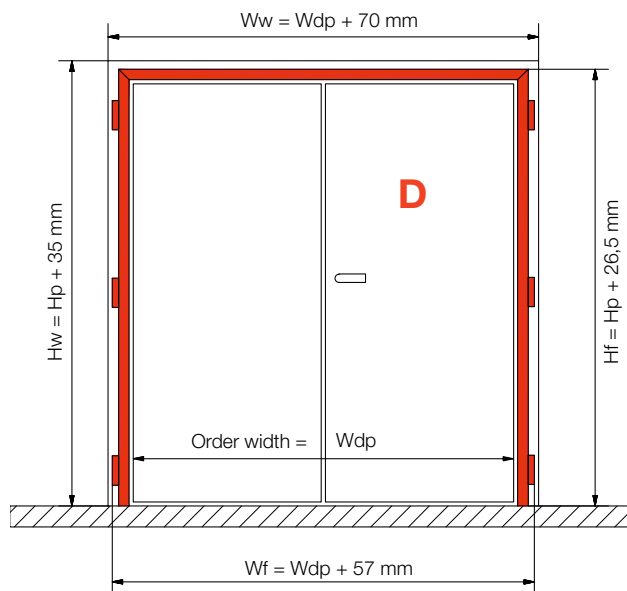
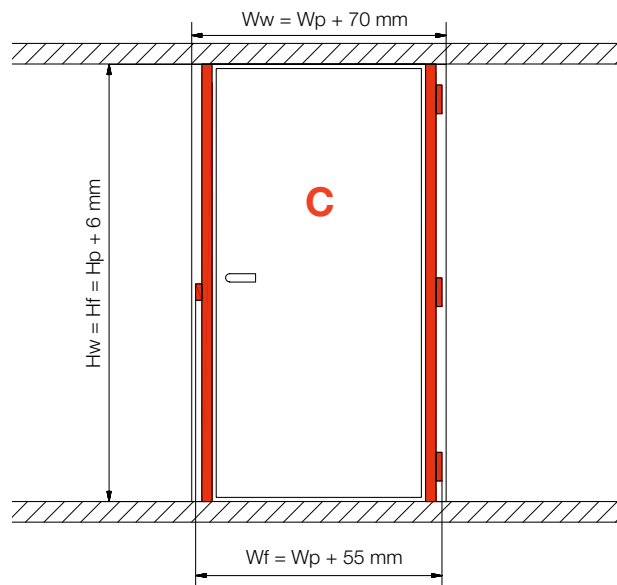
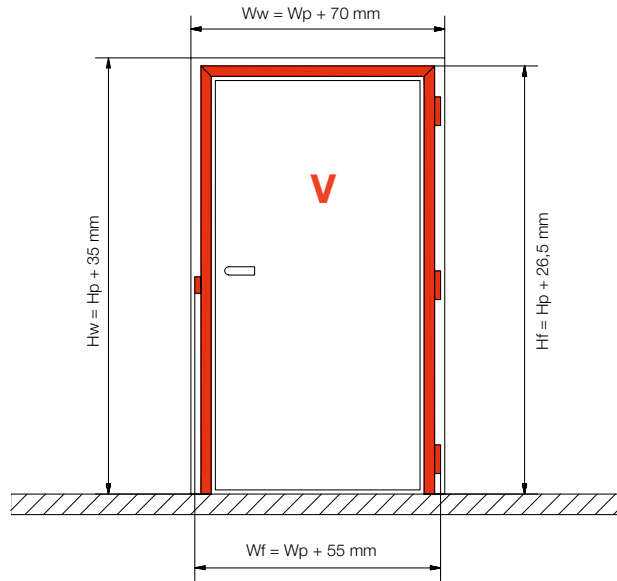

HP = Height doorpanel (max 3000mm)  
 WP = Width doorpanel

Hf = Height doorframe  
 Wf = Width doorframe

Hw = Opening height wall  
 Ww = Opening width wall