

# TRADITIONAL INDOOR MODULAR SAUNA



[saunas.com](https://saunas.com)



  
saunas

# INTRODUCTION

We understand remodeling an existing structure is not always the easiest solution for installing a quality sauna. As a completely freestanding structure, the Scandia Manufacturing pre-fabricated Sauna kit can be placed in almost any room or covered space with little to no room



saunas.com  
info@saunas.com  
1-888-503-8157

saunas.com  
info@saunas.com  
1-888-503-8157

# FEATURES

Scandia MFG caters to your customer needs and will build your Traditional Indoor Modular Sauna to your desired dimensions.

7/16"x6" Spanish cedar tongue and groove panels for all walls and ceiling (vertical installation)

1 x4 Spanish cedar benches and supports

Matching trim for ceiling, corners, and base

Standard with stainless steel heater with external controls

Pre-hung, solid core, cedar wood door with glass panel

Spanish cedar bench skirts

Tru-Tile flooring for walking area (does not cover under benches)

FSK vapor barrier

Vapor proof wall light

Deluxe wall thermometer/hygrometer

Wooden bucket and wooden ladle

Hardware for assembly



# CUSTOMIZE YOUR SAUNA

Color Wood



Spanish Cedar



Poplar Wood



Hand-Finished  
Natural Black



Hand-Finished  
Ivory White

# CUSTOMIZE YOUR SAUNA

## Wood Classic Doors

Size 1

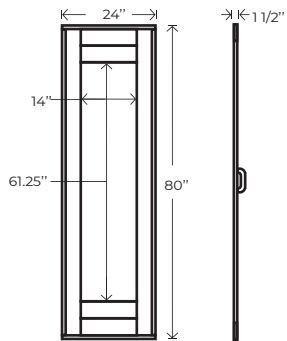

Size 2

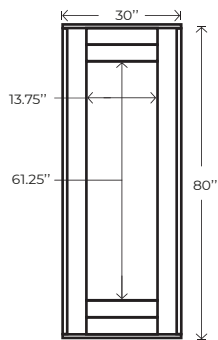

Size 3

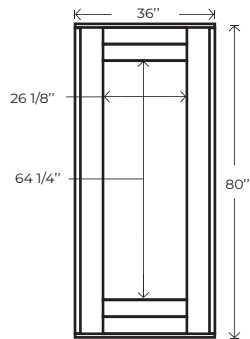

# CUSTOMIZE YOUR SAUNA

## Glass Doors

Size 1

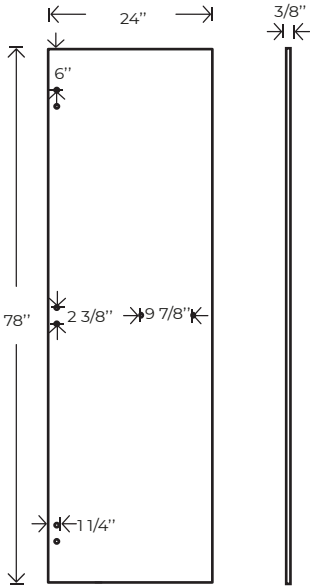

Clear Glass Doors



Tinted Glass Doors



Size 2

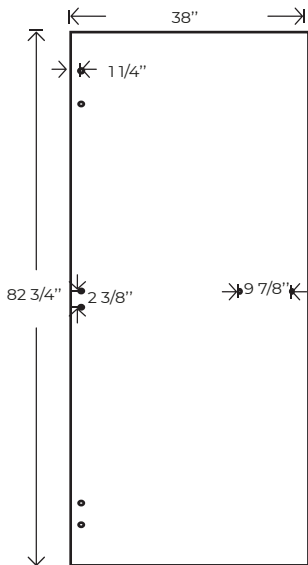

# CUSTOMIZE YOUR SAUNA

## Heaters



### Electric Heater

Considered the best Electric Heater in the world. Our electric heaters are the only sauna heaters that offer a solid pan design; with 100% stainless steel construction that protects the heater components.

Energy efficient  
Simple and clean design



### Gas Heater

Our gas heater is also highly sophisticated and built to last. These are made from 32 l spec stainless steel, which is the same material used in jet engine after-burners. Our gas heaters also feature the largest rock tray in the industry.

No electricity needed  
Produces more heat

# CUSTOMIZE YOUR SAUNA

## Flooring



### Duck-board

An excellent option if you are looking for a high quality, traditional, flooring.

Dimensions: 24" x 24" x 1 3/8"

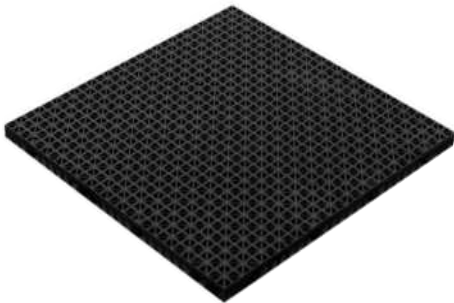

### Tru-Tile

Perfect for your sauna or steam room floors. These tiles are made of PVC and interlock. Place them in your high traffic areas in your sauna or steam room.

Dimensions: 12"W x 12"L x 9/16"H

## PowerZone 100



Max Room Size 1000 cu ft.

Neutralizes and eliminates unwanted, bacteria, viruses, mold, and mildew.

Utilizes electrolysis to convert O<sub>2</sub> molecules (oxygen) to O<sub>3</sub> (ozone).

Reduces the use of toxic chemicals.

Drastically decreases man-hours dedicated to traditional cleaning methods of saunas and









# CUSTOMIZE YOUR SAUNA

## Smart Sauna Wi-Fi Controller

Our Smart WiFi Controller allows you to regulate your sauna from anywhere in the world with our smartphone app.

### Features

-  Time selector from 0 to 60 minutes
-  Temperature selector
-  °C / °F Selector
-  Capacitive Touch Sensor
-  Integrated to the Cloud
-  Chromotherapy Lights (Check availability)

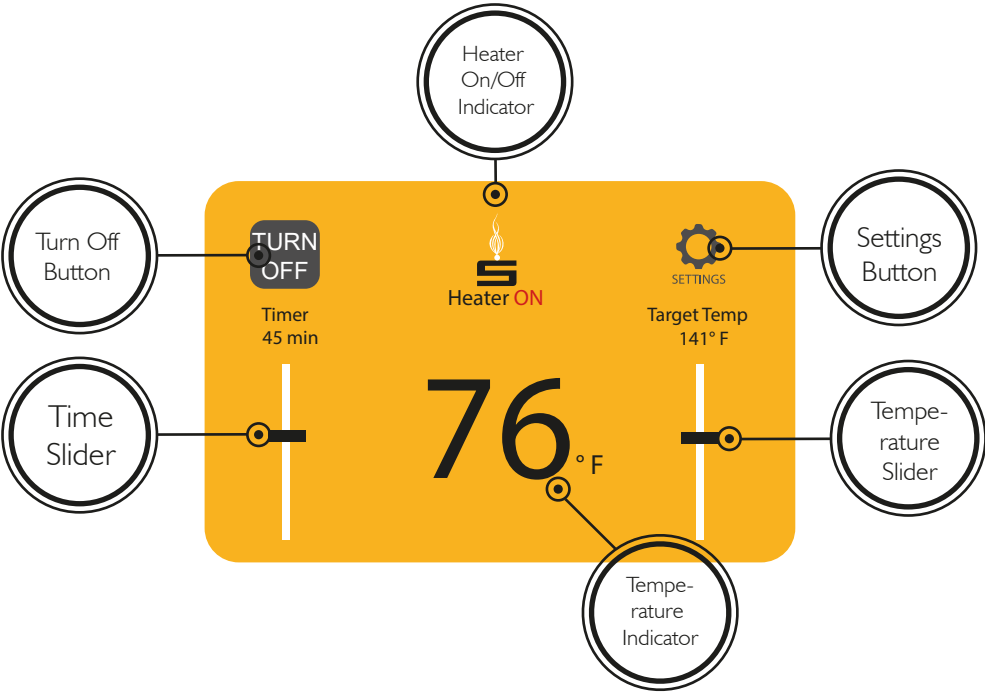

# CUSTOMIZE YOUR SAUNA

## Himalayan Salt Panels

Our Himalayan Salt Wall Panels make an excellent addition to your sauna room. They have an aesthetic appeal plus a unique functionality that creates a beautiful look, along with the health benefits of himalayan salt itself.

### Features

Made from 100% authentic himalayan salt blocks

Choose between pink, red or white panel colors

Available with LED lighting with remote

Proprietary mounting system for easy installation

Easily removable for cleaning, maintenance or repair



Pink Salt Panel



White Salt Panel



Red Salt Panel

Perimeter Light



# GALLERY





**saunas**

**info@saunas.com**

**1.888.503.8157**



**saunas.com**

