

Configuring the QRA-C for the camera

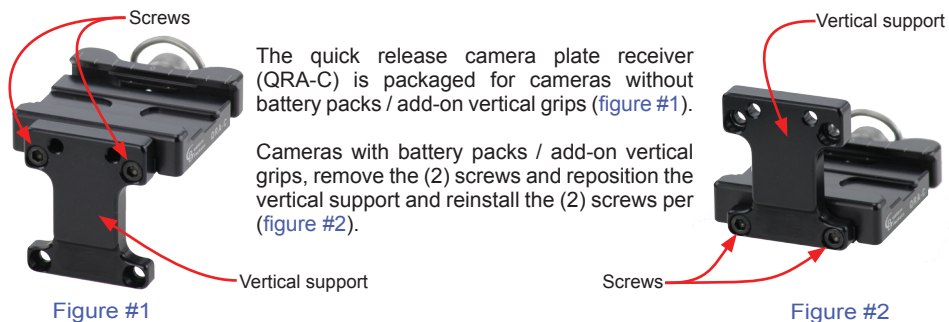

Attaching the QRA-C to the bracket

Attach the quick release camera plate receiver (QRA-C) to the bracket using the two screws (8-32 threads x 1/2" long socket head) and Allen wrench (5/64") supplied with the bracket. *Note: Loosen the "D" screw (see figure #5 below) and slide the receiver back to install screws.*

Cameras without battery packs / add on vertical grips (figure #3)
Cameras with battery packs / add on vertical grips (figure #4)



Attaching your camera to the QRA-C

Loosen the "D" screw, slide the quick release camera plate receiver all the way back, install camera with (Arca Swiss style plate) attached (center lens), tighten the "D" screw (camera clamp) - see figure #3 - #4 above). Move camera forward, still allowing the camera to be quick released from the bracket.

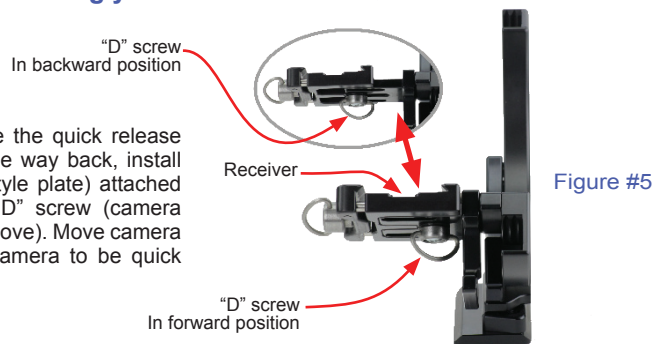

Replacing the Bottom Plate with the CK-500

The bracket is packaged with a Custom Brackets' style bottom plate which will be removed in order to attach the Arca Swiss style bottom plate. Using the Allen wrench (1/8") supplied with the QRA-C / QRA-C Kit / CK-500, unscrew the two screws (10-32 threads by 1/2" long flat head) from underneath the bracket (Figure #6). Once the bottom plate is removed, use the two new screws supplied (10-32 threads by 1/2" long flat head) and screw the Arca Swiss style bottom plate in according to Figure #7. Once in place, tighten the screws.



USA: One Year Warranty

For a period of one (1) year from date of purchase, Custom Brackets will repair or replace free of charge, any defect in material or workmanship. Warranty does not cover repairs due to abuse, negligence, impact or any modifications made by the customer. Excessive force unscrewing knobs will void warranty. Warranty service is available by returning the product (shipping prepaid) to Custom Brackets. All returns must include a return authorization (RA) number (contact Custom Brackets to obtain), letter explaining the problem, and a copy of the sales receipt.

International: One Year Limited Warranty

For a period of one (1) year from date of purchase, Custom Brackets will repair or replace free of charge, any defect in material or workmanship. Warranty does not cover repairs due to abuse, negligence, impact or any modifications made by the customer. Excessive force unscrewing knobs will void warranty. Warranty service is available by returning the product (shipping prepaid) to Custom Brackets. All returns must include a return authorization (RA) number (email info@custombrackets.com to obtain), letter explaining the problem, and a copy of the sales receipt.

Repair

Repair service is available by returning the products (shipping prepaid) to Custom Brackets. All returns must include a return authorization (RA) number (contact Custom Brackets to obtain), letter explaining the problem, and a copy of the sales receipt. A repair cost will be issued and must be approved prior to any repairs. Shipping charges are the responsibility of the customer.