

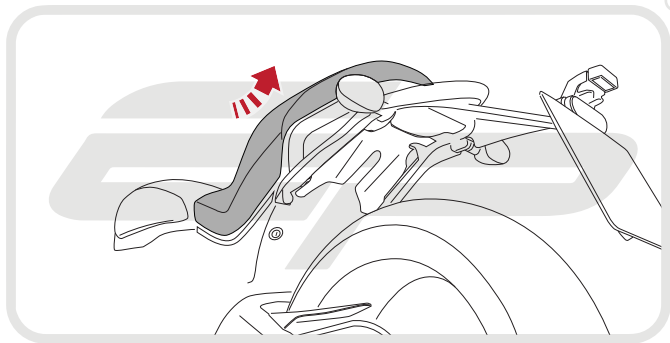

## Kit Contents

- Ⓐ 1 x Main Bracket
- Ⓑ 1 x Number Plate Bracket
- Ⓒ 1 x Light Spacer
- Ⓓ 1 x Number Plate Light
- Ⓔ 1 x Reflector Kit
- Ⓕ 1 x Rear Light Connector
- Ⓖ 2 x M5 x 12 Countersunk Screws
- Ⓗ 2 x Side Mounting Brackets

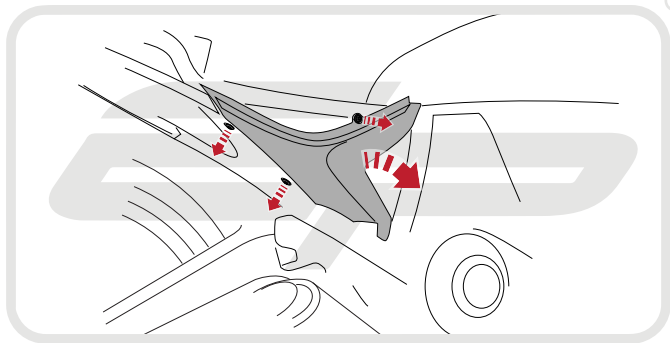



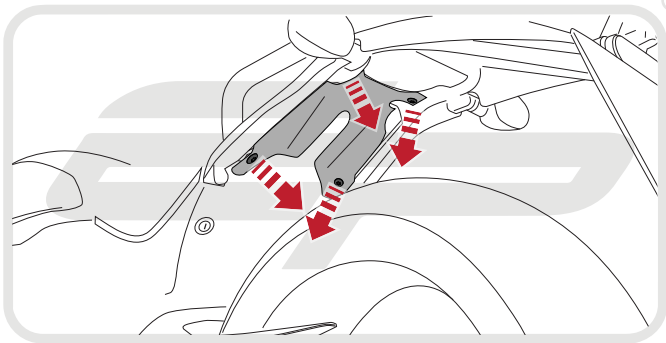

**EVOTECH**<sup>®</sup>  
P E R F O R M A N C E

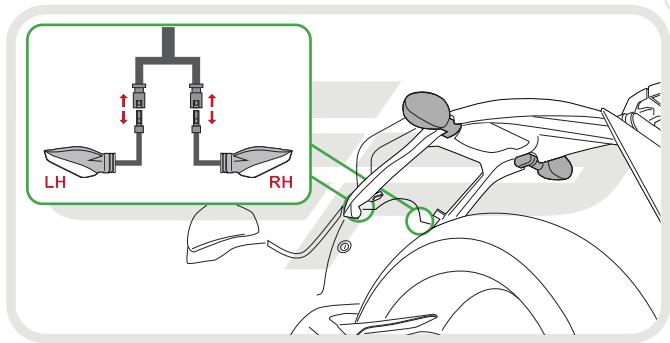



®

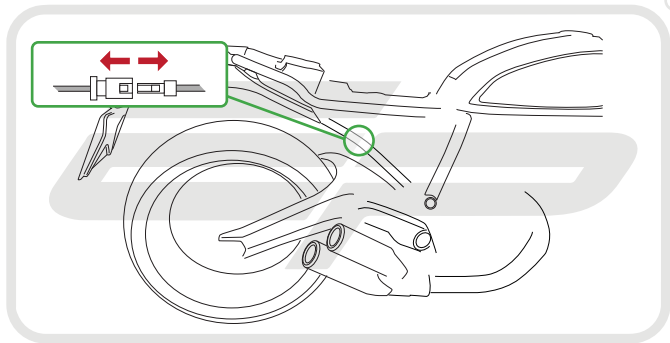

**EVOTECH**<sup>®</sup>  
P E R F O R M A N C E

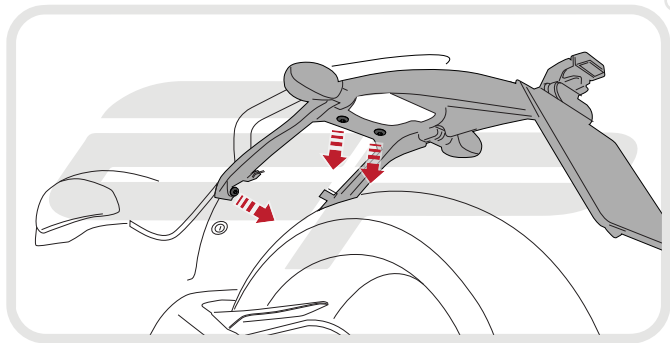

**EVOTECH**<sup>®</sup>  
P E R F O R M A N C E

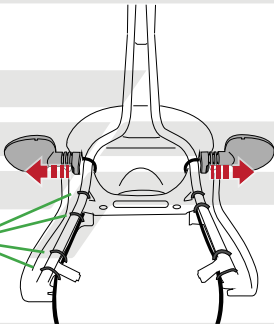
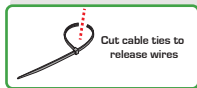





Caution

Ensure indicators are installed  
on the correct sides - drain  
holes should face down

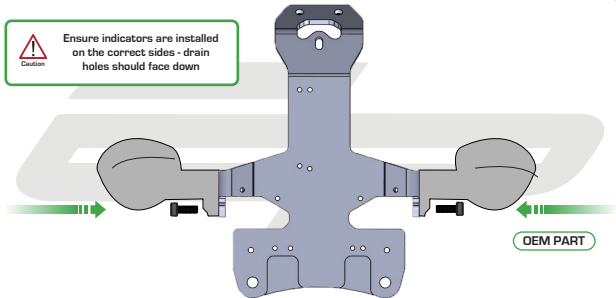

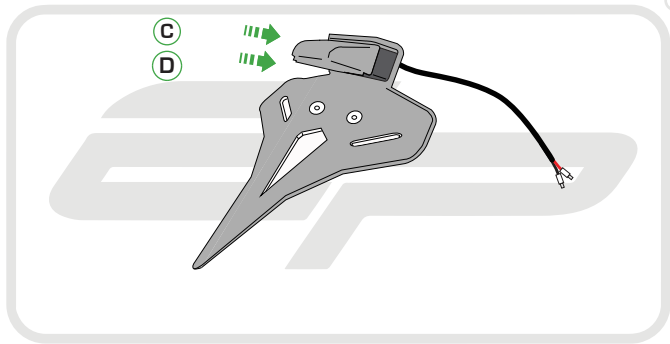

**EVOTECH**<sup>®</sup>  
P E R F O R M A N C E

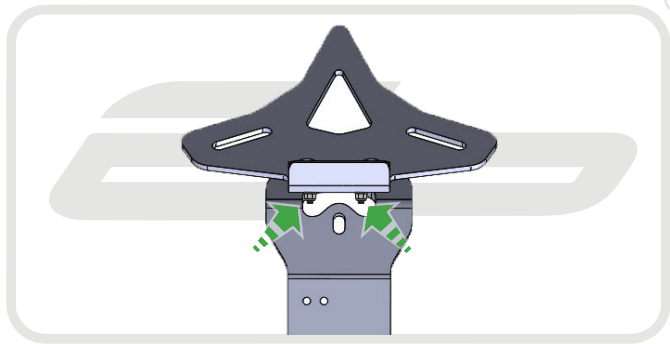

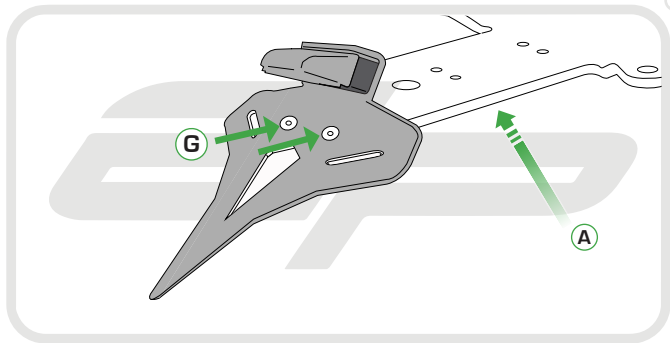

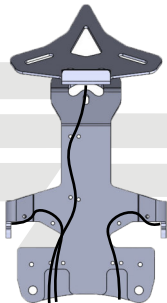
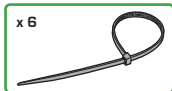
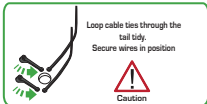

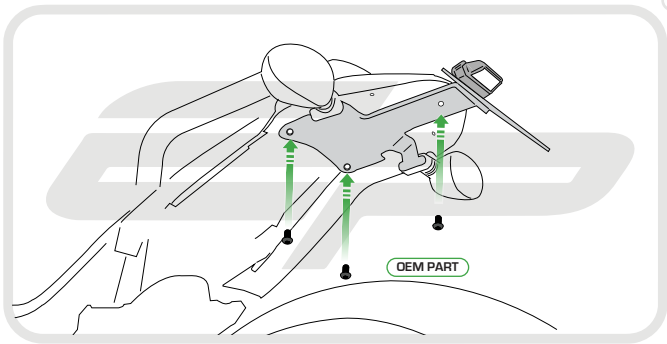



Caution

Run wires neatly down the right hand side of the bike. As shown in stage 14 ensuring they do not get trapped or squashed

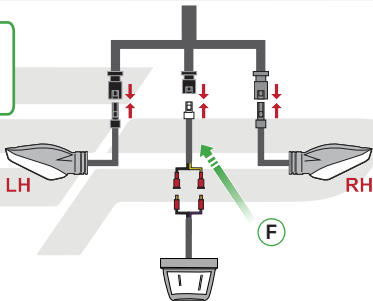



®

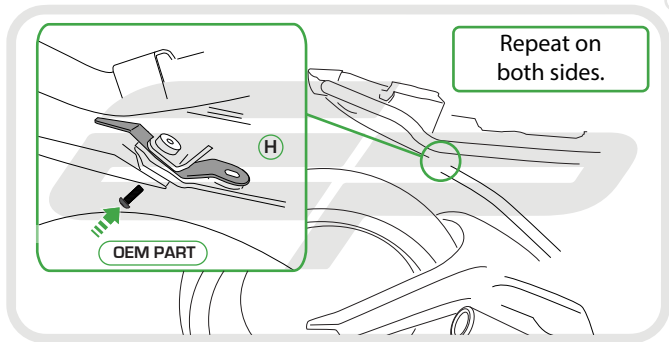





Reverse Stage

3,2,1

## Reflector Bracket Installation

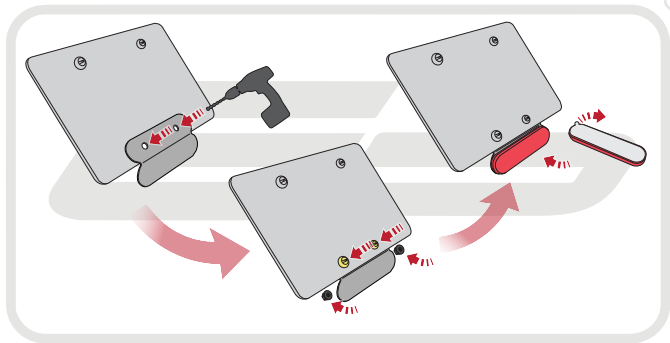

**EVOTECH**<sup>®</sup>  
P E R F O R M A N C E

## Number Plate Adapter Installation Instructions

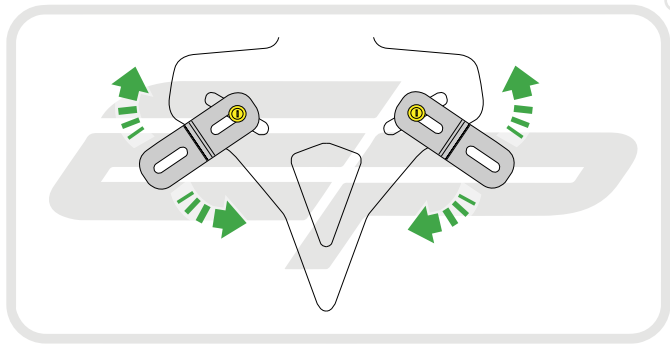

**EVOTECH**<sup>®</sup>  
P E R F O R M A N C E



 **ESSENTIAL CHECKS** 

After installation of your tail tidy ensure that the licence plate does not contact the rear tyre when suspension is fully compressed.

Ensure all electrics including indicators, tail light, brake light and licence plate light lights are working correctly before riding the motorcycle.

It is recommended that periodic inspections are made to ensure that all fixings are fully tightend.