

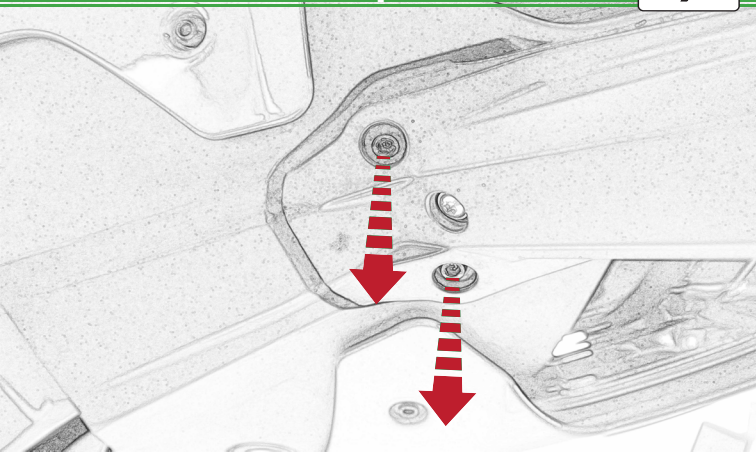

## Kit Contents PRN013868

- A** 1 x Reflector Kit
- B** 2 x M5 Black Washers
- C** 2 x M5 x 50 Stainless Steel Button Head Bolts
- D** 2 x M5 x 16 Black Button Head Bolts
- E** 2 x M4 x 12 Black Button Head Bolts
- F** 2 x M5 x 12 Black Countersunk Screws
- G** 2 x Indicator Adaptors
- H** 2 x 4mm x 18mm Dowel Pin
- I** 2 x Black Spacers
- J** 4 x M4 x 10 Stainless Steel Button Head Bolts
- K** 4 x Indicator Clamps

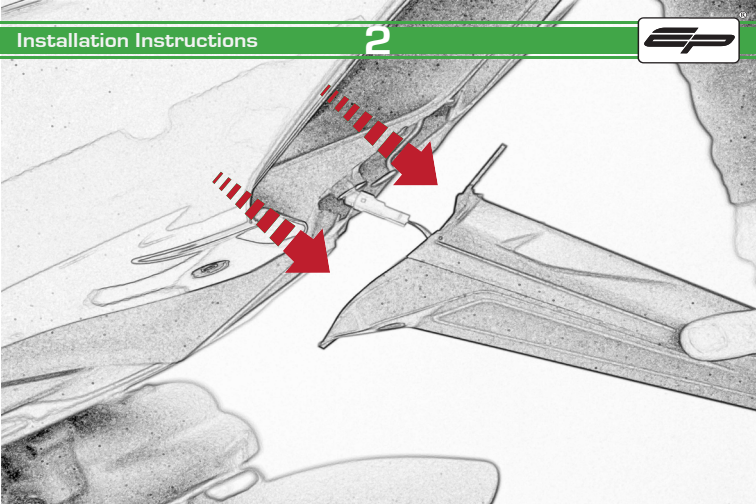



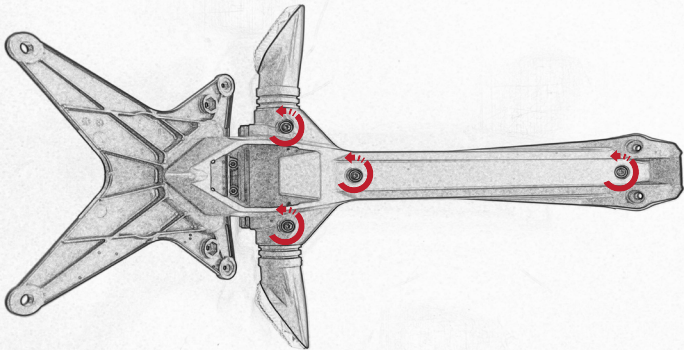

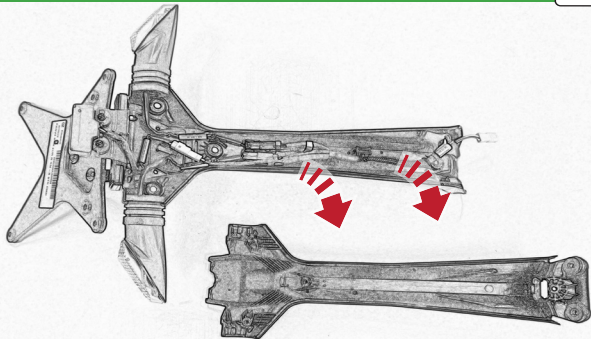

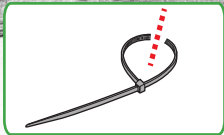
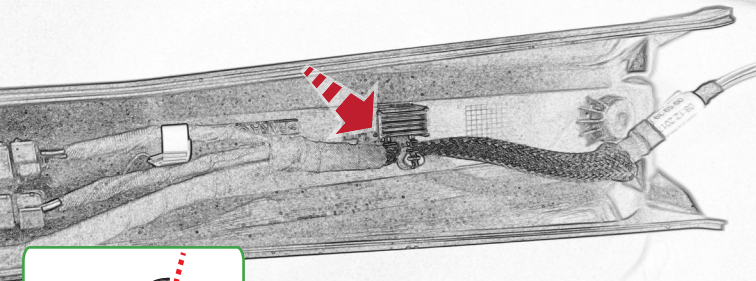

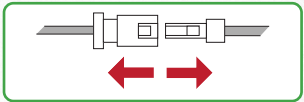
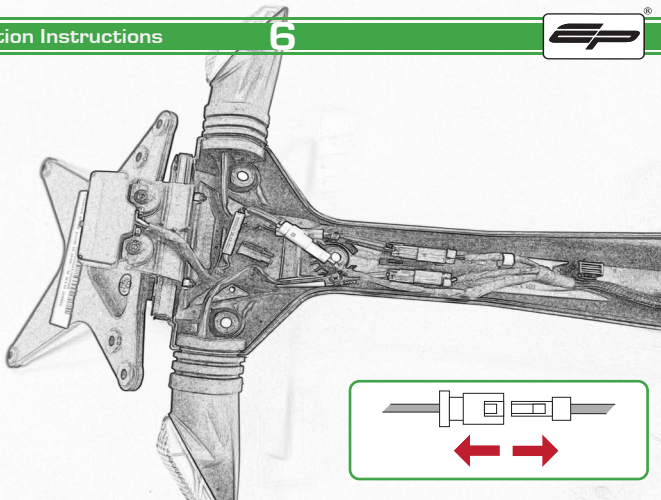

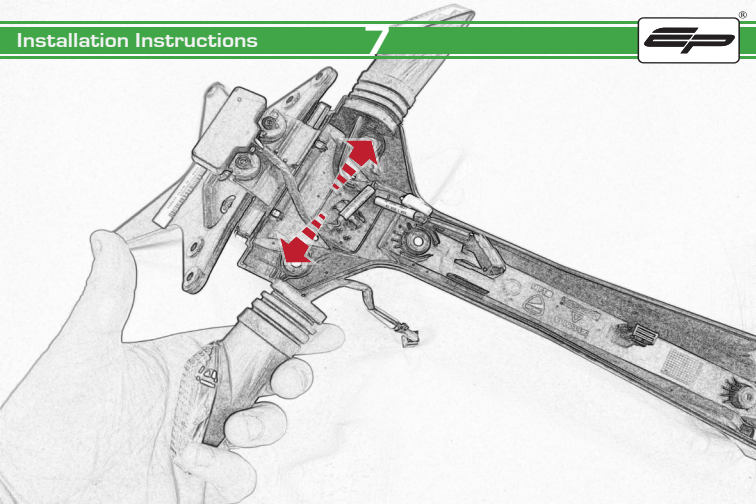



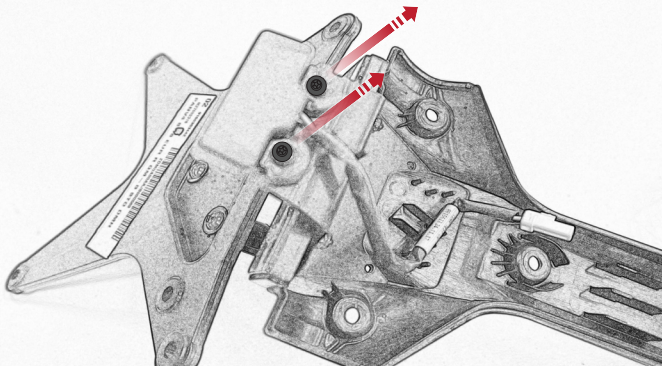

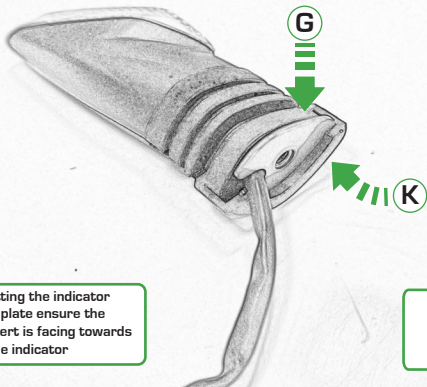

Caution

When fitting the indicator adaptor plate ensure the threaded insert is facing towards the indicator

Repeat  
Both Sides

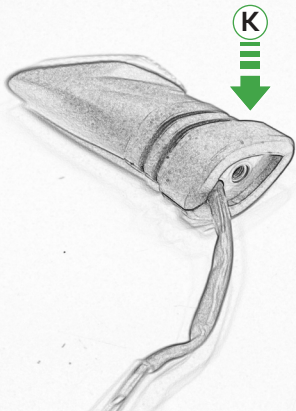

Repeat  
Both Sides

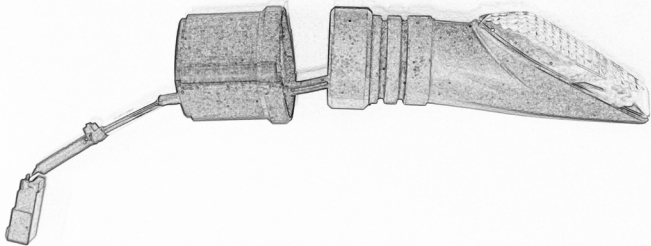

Repeat  
Both Sides

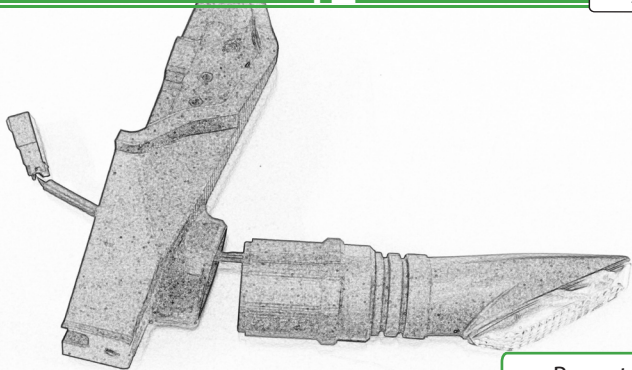

Repeat  
Both Sides

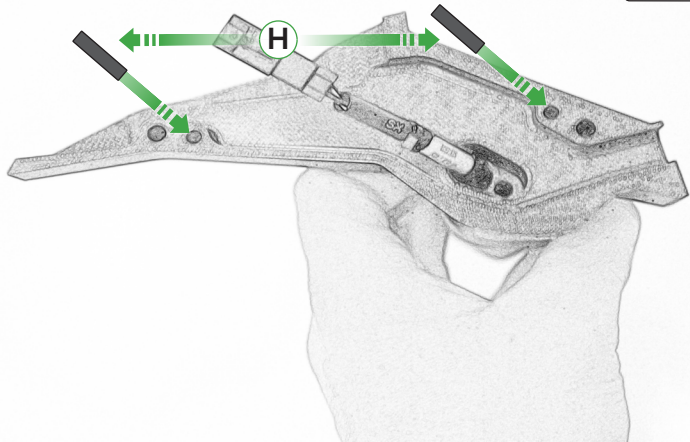

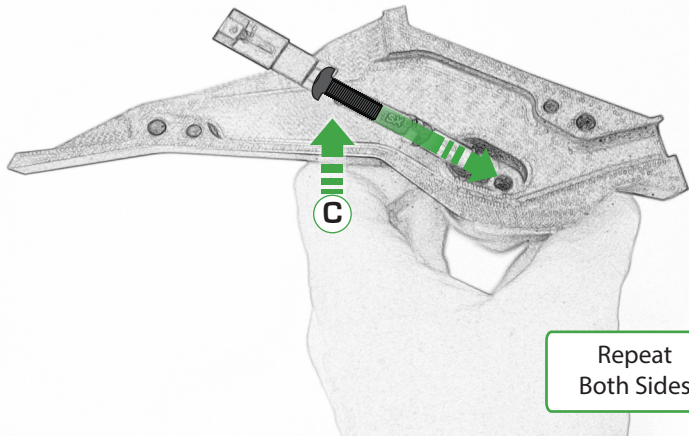

C

Repeat  
Both Sides

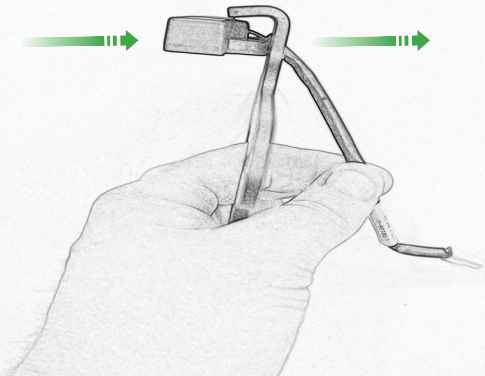



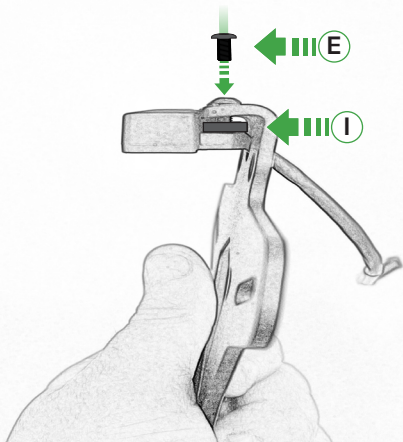

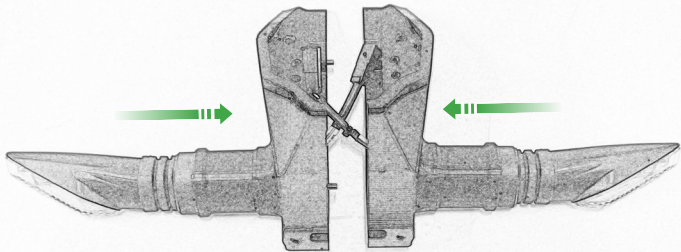

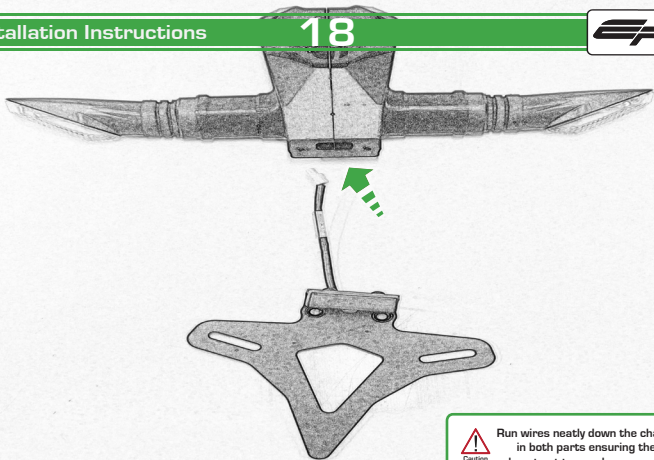

Caution

Run wires neatly down the channel in both parts ensuring they do not get trapped or squashed

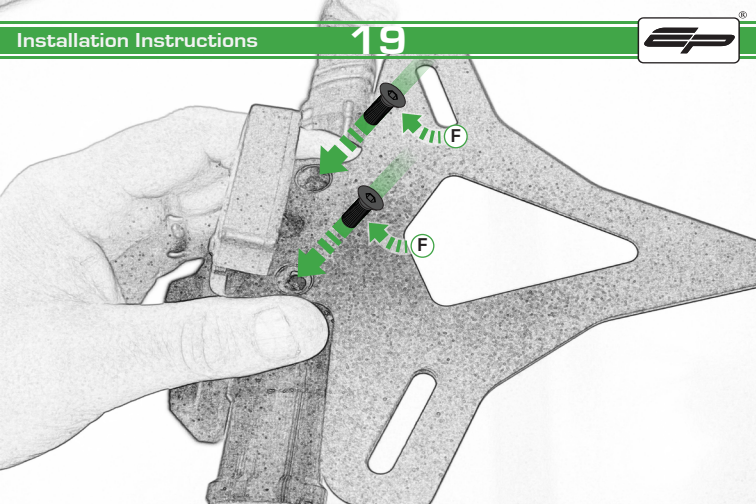

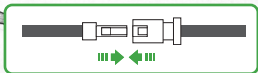
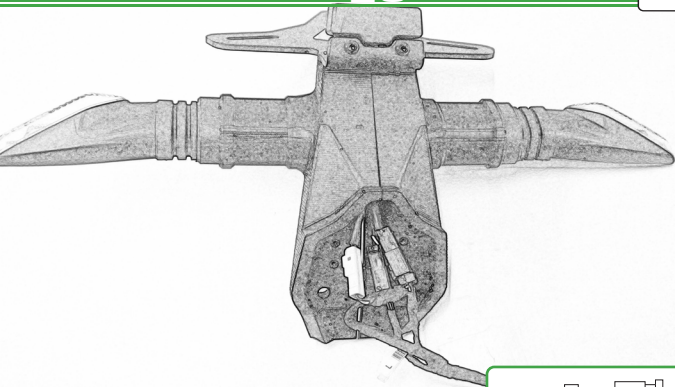

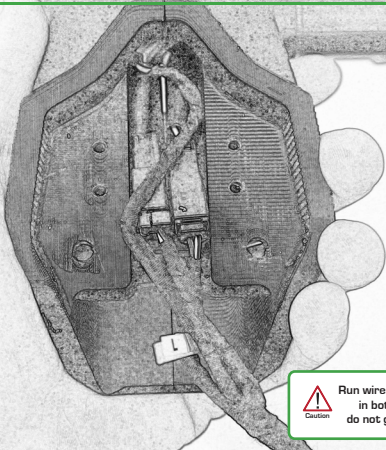

Run wires neatly down the channel  
in both parts ensuring they  
do not get trapped or squashed

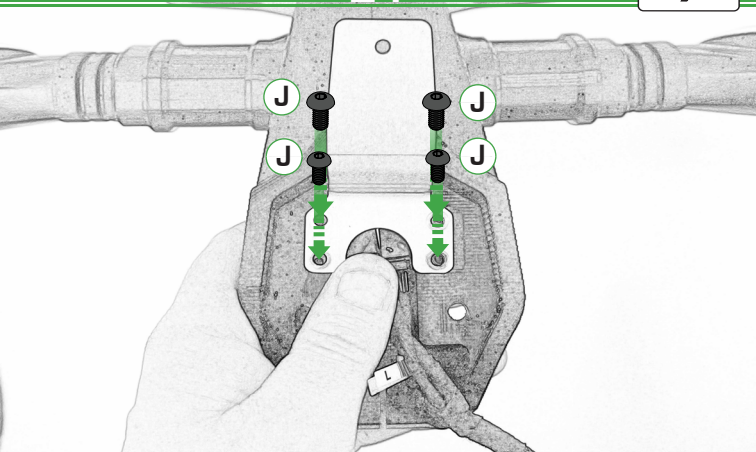

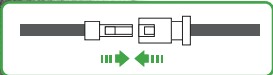
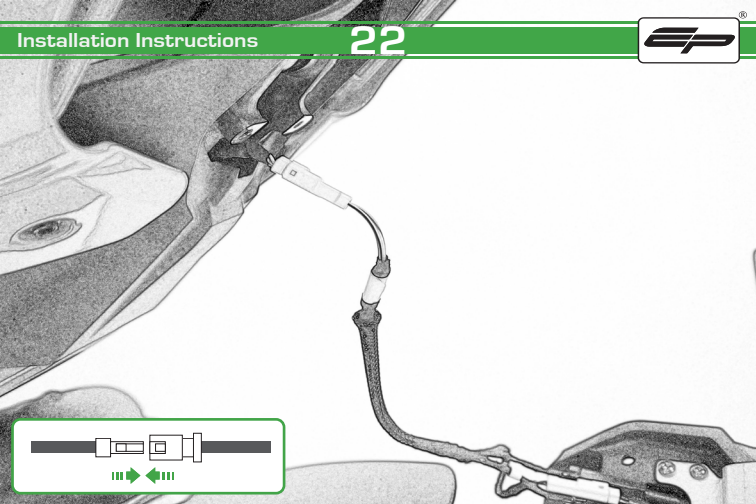



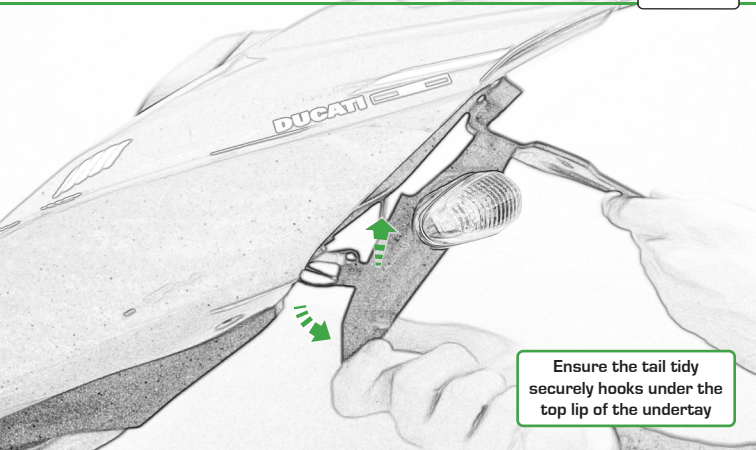

Ensure the tail tidy  
securely hooks under the  
top lip of the undertay

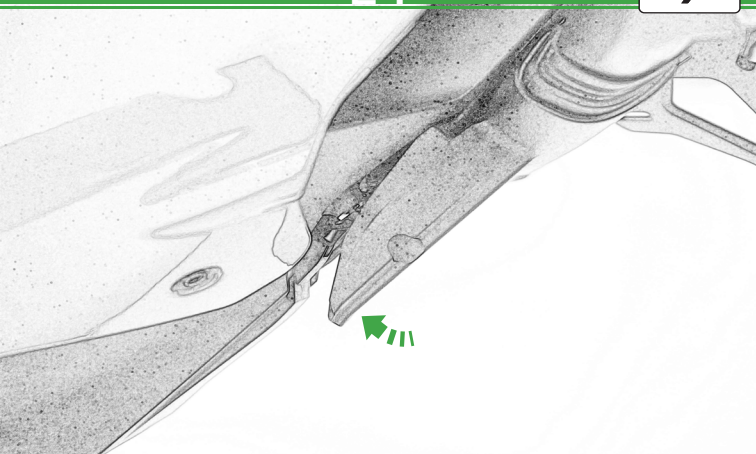

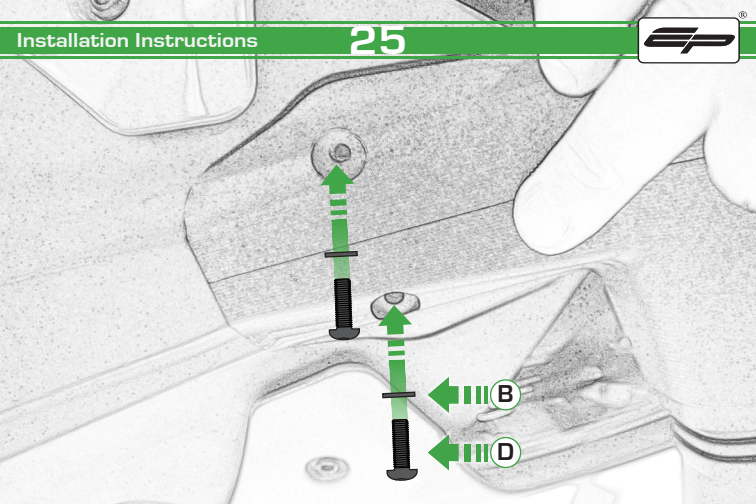



### ESSENTIAL CHECKS



After installation of your tail tidy ensure that the licence plate does not contact the rear tyre when suspension is fully compressed.

Ensure all electrics including indicators, tail light, brake light and licence plate light lights are working correctly before riding the motorcycle.

It is recommended that periodic inspections are made to ensure that all fixings are fully tightend.

