



**FITTING INSTRUCTIONS FOR ECC0265 HONDA CB125R 2018- RHS ENGINE CASE COVER**



**THIS KIT CONTAINS:**

- 1x ENGINE CASE COVER (ECC0265)
- 2 x M6 x 40mm LONG CAP HEAD BOLTS
- 2 x M6 x 50mm LONG CAP HEAD BOLTS
- 4 x SPACERS (S0820)
- 2 x M6 WASHER

**TOOLS REQUIRED**

SET OF METRIC ALLEN KEYS

**Digital copies of these instructions are available to download from [www.rg-racing.com](http://www.rg-racing.com)**



Picture 1



Picture 2



Picture 3

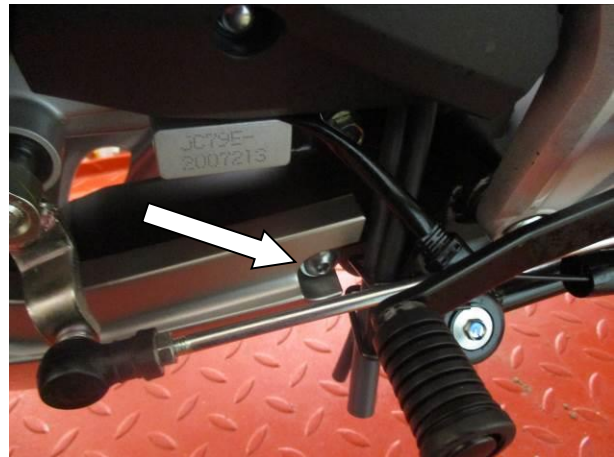

Picture 4

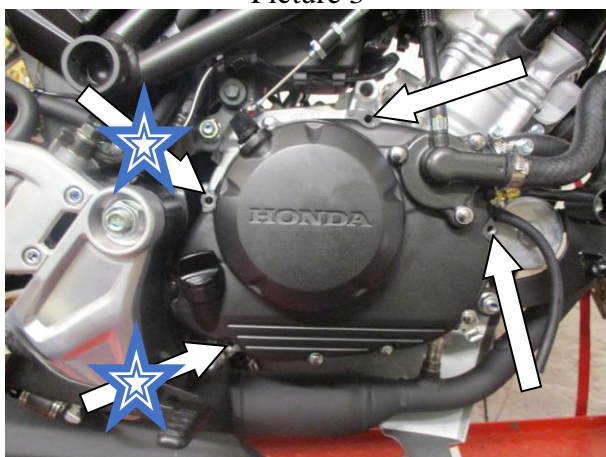

Picture 5





Picture 6

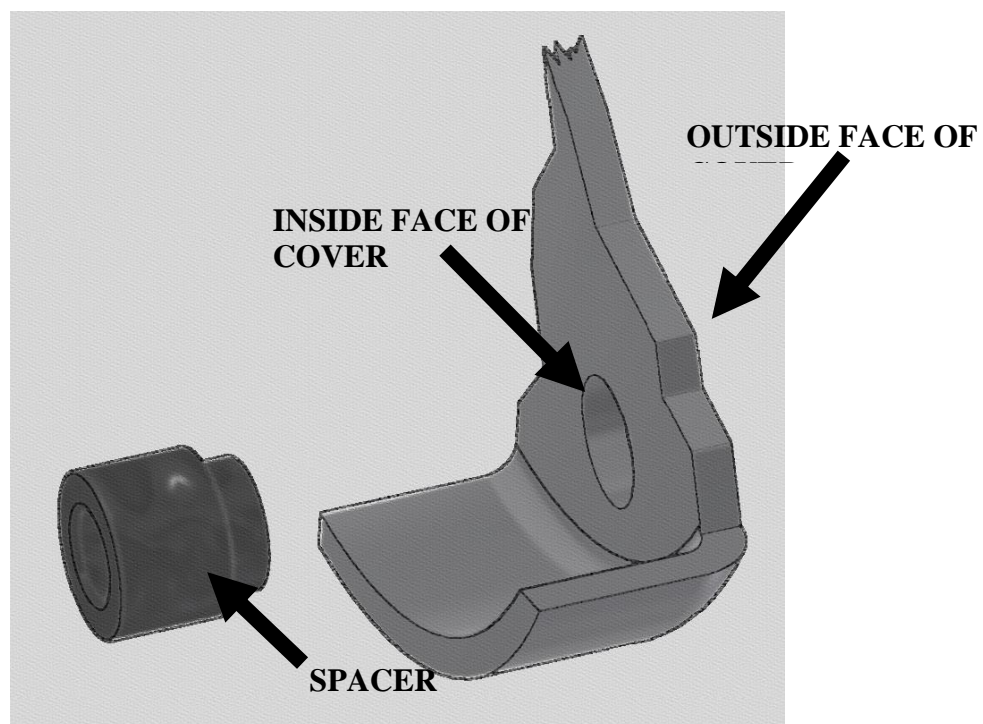

**PLEASE READ THESE INSTRUCTIONS FULLY BEFORE STARTING**

- Please make sure the engine is cold before proceeding with the fitting of the R&G cover.
- While supporting the belly pan remove the four bolts arrowed in Picture 1 to Picture 4, and carefully remove the belly pan.
- To fit the R&G engine case cover remove the four M6 engine case bolts shown in Picture 5. Hold the cover loosely over the case to help identify the correct ones. **DO NOT REMOVE ALL OF THE CASE BOLTS.**
- Fit the four spacers into the four holes of the engine case cover as shown in the diagram below (these should be a tight fit to secure in position while fitting (ensure they are correctly seated before proceeding, once tightened they will remain in position)).



- Remove the oil filler cap.
- Offer up the R&G cover to the engine and carefully fit it over the casing. Ensure that the four R&G bolts are lined up with the holes in the engine casing, and then push on as far as it will go.
- Fit the two shorter bolts (40mm long) through the Engine Case Cover in the positions marked with a  and into the engine case, then place the remaining two longer bolts into the remaining holes.
- Tighten the bolts equally so that they pull the cover into place. **DO NOT FULLY TIGHTEN.**
- Use a torque wrench set at 10 N/m (7 Lb/ft) to fully tighten.
- Finally re-fit the oil filler cap and belly pan.
- It is suggested that you check the tightness of the mounting bolts on a regular basis i.e. when cleaning or once a month.
- NOTE for the cleaning of this product you should only use a soft polishing cloth and a mild general cleaning agent.
- **AVOID HARMFUL CHEMICALS. IF IN DOUBT DO NOT USE AS THEY COULD ALTER THE STRENGTH OF THE COVER.**
- R&G will accept no liability if the above procedure and torque settings are not followed.

ISSUE 2 10/05/2019 (NSY)

R&G

Unit 1, Shelley's Lane, East Worldham, Alton, Hampshire, GU34 3AQ  
Tel: +44 (0)1420 89007 Fax: +44 (0)1420 87301 [www.rg-racing.com](http://www.rg-racing.com) Email: [info@rg-racing.com](mailto:info@rg-racing.com)



### **GENERAL TORQUE SETTINGS**

M4 BOLT = 8Nm  
M5 BOLT = 12Nm  
M6 BOLT = 15Nm  
M8 BOLT = 20Nm  
M10 BOLT = 40Nm

### **CONSUMER NOTICE**

The catalogue description and any exhibition of samples are only broad indications of the Products and R&G may make design changes which do not diminish their performance or visual appeal and supplying them in such state shall conform to the order. The Buyer acknowledges no representation or warranty (other than as to title) has been given or will apply to the Products other than those in R&G's order or confirmation and the Buyer confirms it has chosen the Products as being of merchantable quality and suitable for its particular purposes. Where R&G fits the Products or undertakes other services it shall exercise reasonable skill and care and rectify any fault free of charge unless the workmanship has been disturbed. The Buyer is responsible for ensuring that the warranty on the motorcycle is not affected by the fitting of the Products. On return of any defective Products R&G shall at its option either supply a replacement or refund the purchase money but shall not be liable if the Products have been modified or used or maintained otherwise than in accordance with R&G's or manufacturer's instructions and good engineering practice or if the defect arises from accident or neglect. Other than identified above and subject to R&G not limiting its liability for causing death and personal injury, it shall not be liable for indirect or consequential loss and otherwise its liability shall be limited to the amounts paid by the Buyer for the Products or the fitting or service concerned. These terms do not affect the Buyer's statutory rights.

### **R&G RACING RETURNS POLICY (NON-FAULTY GOODS)**

Returns must be pre-authorised (if not pre-authorised the return will be rejected). Goods may only be returned direct to us if they were purchased direct from us (customer must prove if necessary). Otherwise to be returned to original vendor. Goods must be in re-sellable condition, in the opinion of R&G Racing. All returns are subject to a 25% restocking and handling fee (25% of the gross value exc. P&P – at the prevailing price at time of purchase). The customer must pay any and all carriage charges. No returns of discontinued products, unless within 14 days of purchase. This policy does not affect your statutory rights and does not refer to faulty goods.

R&G

Unit 1, Shelley's Lane, East Worldham, Alton, Hampshire, GU34 3AQ  
Tel: +44 (0)1420 89007 Fax: +44 (0)1420 87301 [www.rg-racing.com](http://www.rg-racing.com) Email: [info@rg-racing.com](mailto:info@rg-racing.com)



**NOTICE DE MONTAGE POUR ECC0265 HONDA CB125R 2018-  
PROTECTION CARTER MOTEUR DROIT**

Le kit doit contenir :

- 1x Protection carter moteur (ECC0265)
- 2 x M6 x 40mm Boulons
- 2 x M6 x 50mm Boulons
- 4 x Entretoises (S0820)
- 2 x M6 Rondelle

OUTILS REQUIS

Clés Allen

**Notice disponible au téléchargement sur [www.rg-racing.com](http://www.rg-racing.com)**

**LIRE L'ENSEMBLE DES INSTRUCTIONS AVANT DE COMMENCER**

- Assurez-vous que le moteur soit froid.
- Tout en supportant le ventre plat de carénage, enlever les 4 boulons indiqués de la photo 1 à Photo 4, puis enlever le ventre plat de carénage.
- Pour monter la protection R&G, enlever les 4 boulons M6 de carter moteur, voir photo 5. Tenir le couvercle autour du carter pour aider à les identifier. **NE PAS ENLEVER TOUS LES BOULONS DE CARTER.**
- Insérer les 4 entretoises dans les 4 trous de la protection carter moteur, voir schéma ci-dessous (il n'y a pas beaucoup d'espace pour les insérer (veiller à ce qu'elles soient correctement positionnées avant de procéder, une fois en place elles resteront en position).

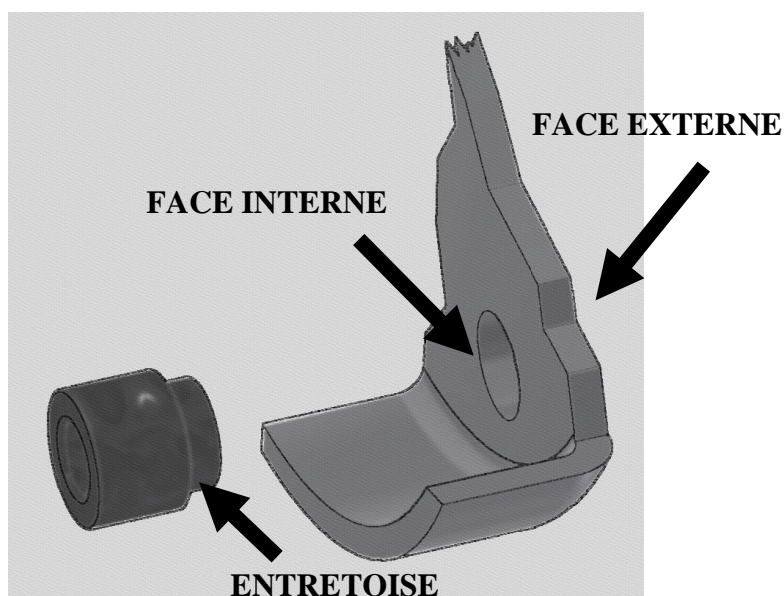

R&G



- Enlever le bouchon d'huile.
- Monter la protection R&G sur le moteur puis montez la sur le carter. Veiller à ce que les 4 boulons R&G soient alignés avec les trous du carter moteur, puis poussez jusqu'à la limite.
- Insérer les 2 boulons courts (40mm long) dans la protection carter moteur, en respectant les positions marquées d'une étoile, puis dans le carter moteur. Ensuite, placez les 2 boulons restant dans les trous restant.
- Serrer les boulons de façon identique de façon à ce que la cache se mette en place. **NE PAS SERRER COMPLETEMENT.**
- Utiliser une clé dynamométrique à 10 Nm (7 Lb ft) pour bloquer.
- Remonter le bouchon d'huile et le ventre plat de carénage.
- Nous vous suggérons de vérifier le serrage au moins une fois par mois, lors du nettoyage par.
- NOTE : Pour le nettoyage, vous devriez utiliser uniquement un chiffon doux et un agent nettoyant doux.
- Ne pas utiliser d'agents chimiques qui pourraient altérer l'efficacité de la protection.
- R&G n'acceptera aucune responsabilité en cas de mauvais couple de serrage ou d'utilisation inappropriée d'agents nocif.

ISSUE 2 10/05/2019 (NSY)

#### **VALEURS DE SERRAGE RECOMMANDEES**

M4 BOULON = 8Nm  
M5 BOULON = 12Nm  
M6 BOULON = 15Nm  
M8 BOULON = 20Nm  
M10 BOULON = 40Nm

#### **CONSUMER NOTICE**

The catalogue description and any exhibition of samples are only broad indications of the Products and R&G may make design changes which do not diminish their performance or visual appeal and supplying them in such state shall conform to the order. The Buyer acknowledges no representation or warranty (other than as to title) has been given or will apply to the Products other than those in R&G's order or confirmation and the Buyer confirms it has chosen the Products as being of merchantable quality and suitable for its particular purposes. Where R&G fits the Products or undertakes other services it shall exercise reasonable skill and care and rectify any fault free of charge unless the workmanship has been disturbed. The Buyer is responsible for ensuring that the warranty on the motorcycle is not affected by the fitting of the Products. On return of any defective Products R&G shall at its option either supply a replacement or refund the purchase money but shall not be liable if the Products have been modified or used or maintained otherwise than in accordance with R&G's or manufacturer's instructions and good engineering practice or if the defect arises from accident or neglect. Other than identified above and subject to R&G not limiting its liability for causing death and personal injury, it shall not be liable for indirect or consequential loss and otherwise its liability shall be limited to the amounts paid by the Buyer for the Products or the fitting or service concerned. These terms do not affect the Buyer's statutory rights.

#### **R&G RACING RETURNS POLICY (NON-FAULTY GOODS)**

Returns must be pre-authorized (if not pre-authorized the return will be rejected). Goods may only be returned direct to us if they were purchased direct from us (customer must prove if necessary). Otherwise to be returned to original vendor. Goods must be in re-sellable condition, in the opinion of R&G Racing. All returns are subject to a 25% restocking and handling fee (25% of the gross value exc. P&P – at the prevailing price at time of purchase). The customer must pay any and all carriage charges. No returns of discontinued products, unless within 14 days of purchase. This policy does not affect your statutory rights and does not refer to faulty goods.

R&G

Unit 1, Shelley's Lane, East Worldham, Alton, Hampshire, GU34 3AQ  
Tel: +44 (0)1420 89007 Fax: +44 (0)1420 87301 [www.rg-racing.com](http://www.rg-racing.com) Email: [info@rg-racing.com](mailto:info@rg-racing.com)



**MONTAGEANLEITUNG FÜR ECC0265 HONDA CB125R 2018-  
MOTORGEHÄUSE-ABDECKUNG – RECHTE SEITE**

**INHALT DES KITS:**

- 1x MOTORGEHÄUSE-ABDECKUNG (ECC0265)
- 2 x M6 x 40mm INBUSSCHRAUBEN
- 2 x M6 x 50mm INBUSSCHRAUBEN
- 4 x DISTANZHALTER (S0820)
- 2 x M6 UNTERLEGSCHNEIBEN

**SIE BENÖTIGEN FOLGENDES WERKZEUG  
SATZ INBUSSCHLÜSSEL**

**Eine digitale Version dieser Montageanleitung kann auf folgender Seite heruntergeladen werden: [www.rg-racing.com](http://www.rg-racing.com)**

**BITTE LESEN SIE DIE MONTAGEANLEITUNG DURCH, BEVOR SIE MIT DER  
MONTAGE BEGINNEN.**

- Bitte achten Sie unbedingt darauf, dass der Motor kalt ist, bevor Sie mit der Montage der R&G Abdeckung beginnen.
- Stützen Sie das Verkleidungsunterteil während Sie die vier Schrauben entfernen, die in den Abbildungen 1 bis 4 gekennzeichnet sind. Das Verkleidungsunterteil danach vorsichtig entfernen.
- Um die R&G Motorgehäuse-Abdeckung montieren zu können, entfernen Sie die vier M6 Motorgehäuse-Schrauben, die in Abbildung 5 abgebildet sind. Um die richtigen Schrauben identifizieren zu können, halten Sie die Abdeckung an das Gehäuse. **ENTFERNEN SIE NICHT ALLE SCHRAUBEN AM MOTORGEHÄUSE.**
- Montieren Sie die vier Distanzhalter an den vier Öffnungen in der Motorgehäuse-Abdeckung wie unten abgebildet (enge Passform, um sie bei der Montage in Position zu sichern). Bitte darauf achten, dass sie richtig positioniert sind, bevor Sie fortfahren - sobald sie befestigt sind, bleiben sie in Position).

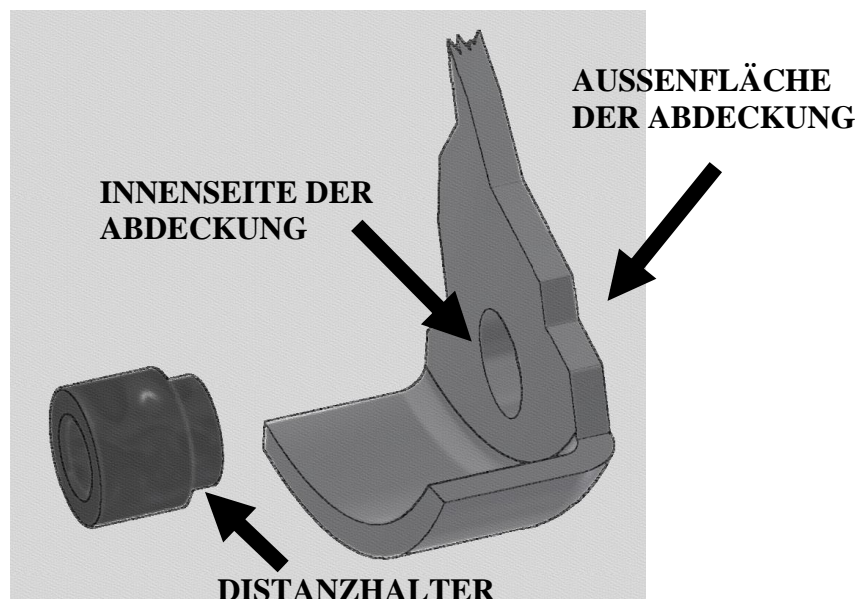

R&G



- Entfernen Sie den Öleinfüllstutzen.
- Die R&G Abdeckung an den Motor ansetzen und vorsichtig am Gehäuse anbringen. Achten Sie darauf, dass die vier R&G Schrauben mit den Bohrungen im Motorgehäuse ausgerichtet sind, dann die Abdeckung soweit wie möglich eindrücken.
- Montieren Sie die zwei kürzeren Schrauben (40mm Länge) durch die Abdeckung an den Positionen, die mit einem  markiert sind und dann in das Motorgehäuse. Die zwei übrigen, längeren Schrauben in die übrigen Öffnungen einführen.
- Ziehen Sie die Schrauben gleichmäßig an, sodass sie die Abdeckung in Position ziehen. NICHT FESTZIEHEN.
- Benutzen Sie einen Drehmomentschlüssel, der auf 10 N/m (7 Lb/ft) eingestellt ist, um die Schrauben festzuziehen.
- Anschließend den Öleinfüllstutzen und das Verkleidungsunterteil wieder montieren.
- Es wird empfohlen, die Festigkeit der Schrauben in regelmäßigen Abständen zu kontrollieren (d.h. einmal im Monat).
- HINWEIS: Bei der Reinigung dieses Produkts benutzen Sie nur ein weiches Poliertuch und ein mildes Putzmittel.
- VERMEIDEN SIE SCHÄDLICHE CHEMIKALIEN. IM ZWEIFELSFALL NICHT BENUTZEN, DA SIE DIE FESTIGKEIT DER ABDECKUNG VERÄNDERN KÖNNEN.
- R&G übernimmt keine Haftung, wenn die obengenannten Schritte nicht eingehalten werden und/oder die angegebenen Anzugsdrehmomente nicht angewendet werden.

AUSGABE 2 10/05/2019 (NSY)

#### **ANZUGSDREHMOMENT**

M4 SCHRAUBE = 8Nm

M5 SCHRAUBE = 12Nm

M6 SCHRAUBE = 15Nm

M8 SCHRAUBE = 20Nm

M10 SCHRAUBE = 40Nm

#### **CONSUMER NOTICE**

The catalogue description and any exhibition of samples are only broad indications of the Products and R&G may make design changes which do not diminish their performance or visual appeal and supplying them in such state shall conform to the order. The Buyer acknowledges no representation or warranty (other than as to title) has been given or will apply to the Products other than those in R&G's order or confirmation and the Buyer confirms it has chosen the Products as being of merchantable quality and suitable for its particular purposes. Where R&G fits the Products or undertakes other services it shall exercise reasonable skill and care and rectify any fault free of charge unless the workmanship has been disturbed. The Buyer is responsible for ensuring that the warranty on the motorcycle is not affected by the fitting of the Products. On return of any defective Products R&G shall at its option either supply a replacement or refund the purchase money but shall not be liable if the Products have been modified or used or maintained otherwise than in accordance with R&G's or manufacturer's instructions and good engineering practice or if the defect arises from accident or neglect. Other than identified above and subject to R&G not limiting its liability for causing death and personal injury, it shall not be liable for indirect or consequential loss and otherwise its liability shall be limited to the amounts paid by the Buyer for the Products or the fitting or service concerned. These terms do not affect the Buyer's statutory rights.

#### **R&G RACING RETURNS POLICY (NON-FAULTY GOODS)**

Returns must be pre-authorized (if not pre-authorized the return will be rejected). Goods may only be returned direct to us if they were purchased direct from us (customer must prove if necessary). Otherwise to be returned to original vendor. Goods must be in re-sellable condition, in the opinion of R&G Racing. All returns are subject to a 25% restocking and handling fee (25% of the gross value exc. P&P – at the prevailing price at time of purchase). The customer must pay any and all carriage charges. No returns of discontinued products, unless within 14 days of purchase. This policy does not affect your statutory rights and does not refer to faulty goods.

R&G

Unit 1, Shelley's Lane, East Worldham, Alton, Hampshire, GU34 3AQ

Tel: +44 (0)1420 89007 Fax: +44 (0)1420 87301 [www.rg-racing.com](http://www.rg-racing.com) Email: [info@rg-racing.com](mailto:info@rg-racing.com)