



# Corporate

Locksmiths & Electronic Security

**CL-BTG3E**

## Intelligent Bluetooth Gateway

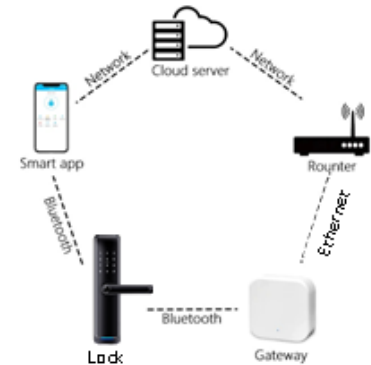

The G3 Intelligent Bluetooth Gateway allows access to various features of "TTLock" enabled locks without needing to be in Bluetooth range of the lock. By installing the gateway, the locks are able to be controlled using the internet.

The device is powered by an included USB-C cable. A USB power adapter & Cat5 Ethernet cable are also required (not included)

In order for the gateway to function correctly, it needs to be within 8 metres of the Bluetooth locks you wish to control. (Solid walls may impede Bluetooth signals)

The gateway allows for custom codes to be added/deleted remotely. This can be useful for landlords, Airbnb hosts, & many other users. It also gives an audit trail & push notifications when users lock or unlock doors.

### Features

- Remote Lock/Unlock (disabled by default)
- Real Time Audit Trail
- Push Notifications
- Add/Delete Passcodes/eKeys
- Lock Setting Editing
- Lock Clock Changes
- Monitor Lock Status

### Specifications

- Voltage - DC 5V/500mA
- USB-A to USB-C cable included
- Dimensions - 70 x 70 x 25mm (L x W x H)
- Weight - 53g NET, 120g Gross
- 10m Max Bluetooth Range
- Wired Ethernet Connection Required

### Works with

**Google Home/Nest & Amazon Alexa**



**TTLock Available  
on iOS & Android**



Google Home



amazon alexa



# Corporate

## Locksmiths & Electronic Security

### Enabling Remote Unlock

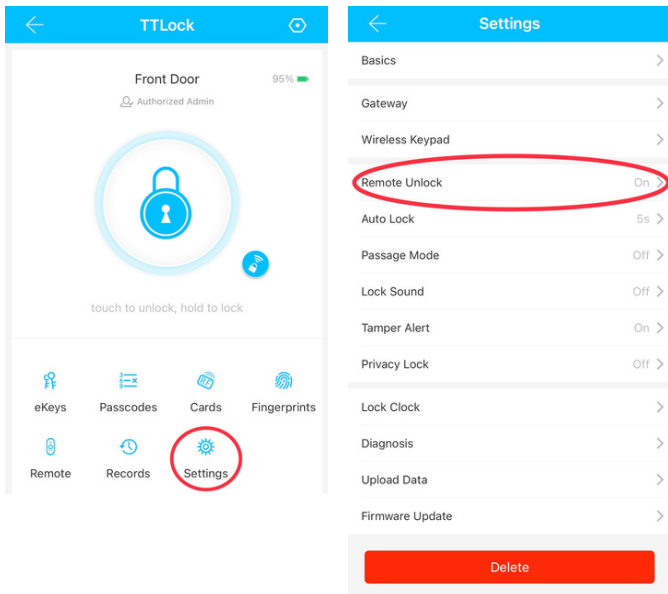

1. Open "TTLock"
2. Select the lock, then select "Settings"
3. Select the "Remote Unlock" setting
4. Press the button to turn **ON** "Remote Unlock"
5. Repeat this process for each lock that will connect to the gateway.

### Gateway Setup

1. Open "TTLock" and press the menu button. ("Hamburger"/3 horizontal lines) ☰
2. Select the "Gateway" option, then press the "+" icon.
3. Connect the G3 Gateway to your network using an Ethernet cable.
4. Press the "G3" Gateway option, then power the gateway using the included USB-C cable.  
The light will start blinking Blue & Red.
5. Choose the Gateway from the list, name it & move to the next page.
6. The gateway will then search for nearby locks.
7. Afterwards, the connected locks will be shown as well as their signal strength.

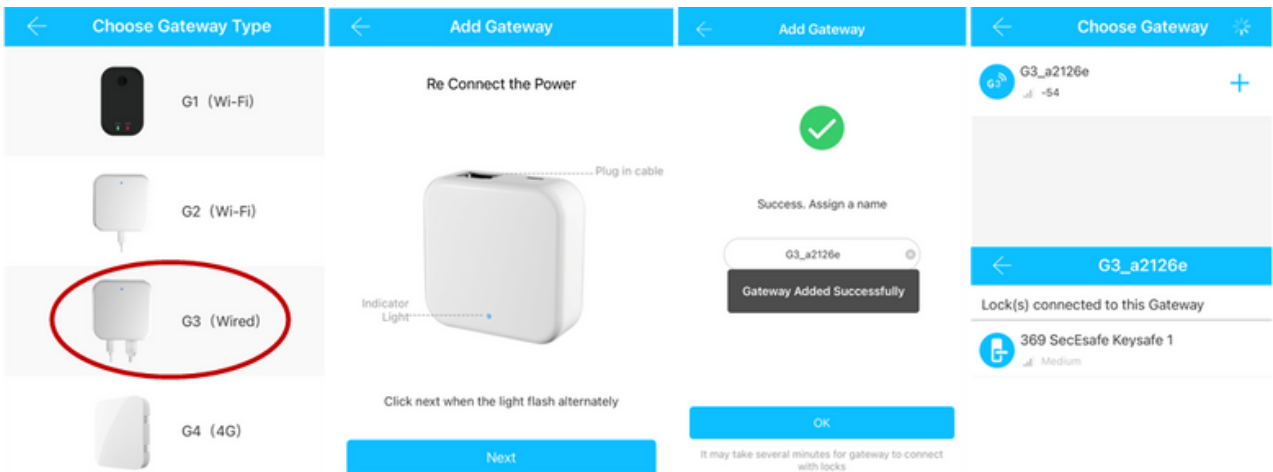



# Corporate

Locksmiths & Electronic Security

## Installing TTLock

Search for "TTLock" on the App Store

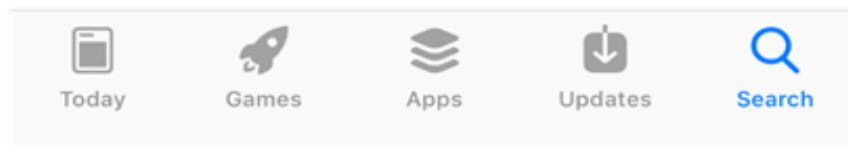
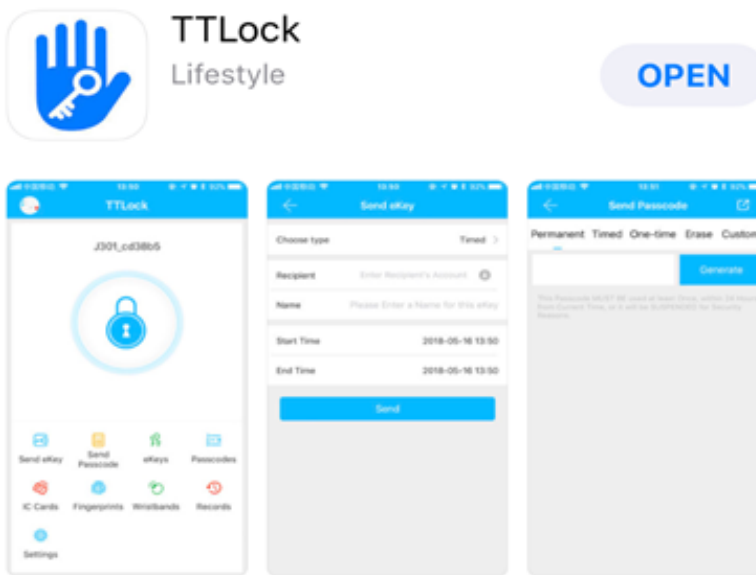
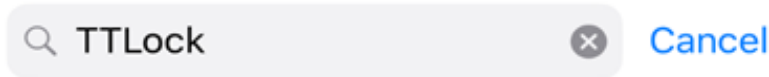

Android



Apple (iOS)



More Information

