



# Corporate

## Locksmiths & Electronic Security

### CL-BTG3E

## Intelligent Bluetooth Gateway

The G3 Intelligent Bluetooth Gateway allows access to various features of “TTLock” enabled locks without needing to be in Bluetooth range of the lock. By installing the gateway, the locks are able to be controlled using the internet.

The device is powered by an included USB-C cable. A USB power adapter & Cat5 Ethernet cable are also required (not included)

In order for the gateway to function correctly, it needs to be within 10 metres of the Bluetooth locks you wish to control. (Solid walls may impede Bluetooth signals)

The gateway allows for custom codes to be added/deleted remotely. This can be useful for landlords, Airbnb hosts, & many other users. It also gives an audit trail & push notifications for when doors are opened.

### Features

- Remote Lock/Unlock (disabled by default)
- Real Time Audit Trail
- Push Notifications
- Add/Delete Passcodes/eKeys
- Lock Setting Editing
- Lock Clock Changes
- Monitor Lock Status

### Specifications

- Voltage - DC 5V/500mA
- USB-A to USB-C cable included
- Dimensions - 70 x 70 x 25mm (L x W x H)
- Weight - 53g NET, 120g Gross
- 10m Max Bluetooth Range
- Wired Ethernet Connection Required



Set up eKeys and passcodes for your Smart Lock anytime, anywhere.

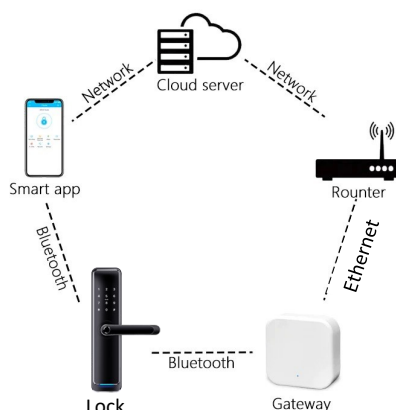



# Corporate

## Locksmiths & Electronic Security

### CL-BTG3E

## Installation Guide

1. Open "TTLock" and press the menu button. ("Hamburger"/3 horizontal lines) 
2. Select the "Gateway" option, then press the "+" icon.
3. Connect the G3 Gateway to your network using an Ethernet cable.
4. Press the "G3" Gateway option, then power the gateway using the included USB-C cable. The light will start blinking **Blue & Red**.
5. Choose the Gateway from the list, name it & move to the next page.
6. The gateway will then search for nearby locks.

Many settings can now be modified while outside of Bluetooth range of the lock. Push notifications and audit trail can also be accessed.

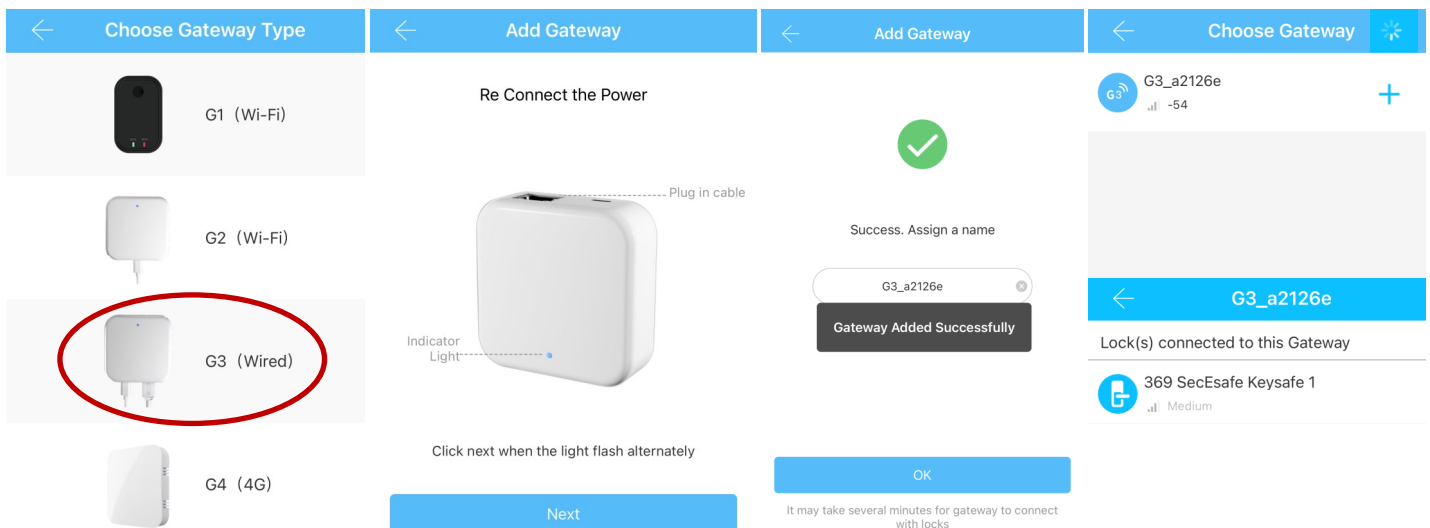

**Works with**  
Google Home/Nest & Amazon Alexa



**For More Information**  
Email [sales@corplock.com.au](mailto:sales@corplock.com.au)  
Call [1300 366 277](tel:1300366277) Or [Contact Us](#)



**TTLock Available**  
**on iOS & Android**





# Corporate

## Locksmiths & Electronic Security

### Installing TTLock

Search for "TTLock" on the App Store

Search bar containing "TTLock" and a "Cancel" button.



TTLock  
Lifestyle

OPEN

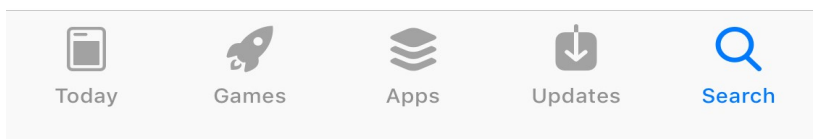
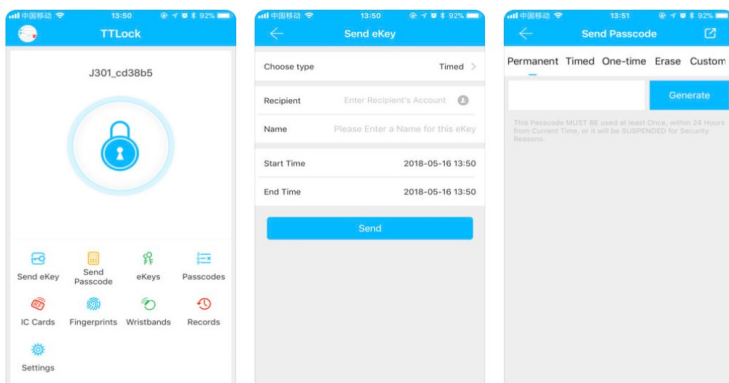

Android



Apple (iOS)



More Information

