

ITEM NO.	PART NUMBER	Revision	Description	QTY.
1	FR1601M101BOX1	1	BOX	1
2	FR1601M101CLP1	-	CLAMP	4
3	FR1601M101PLTMG1	1	MOUNTING BRACKET	1
4	FR1601M101BZL1	1	BEZEL	1
5	92005A218		M4 x 0.7 mm Thread, 8 mm Long Zinc-Plated Steel	8
6	90190A205		Number 8 Size, 2" Long Zinc-Plated Steel	4

REVISION			
REV.	DESCRIPTION	DATE	APPROVED
1	ITEM 3 & 4 ADJUSTED PER CUSTOMER REQUEST	09-05-18	SBUCIO

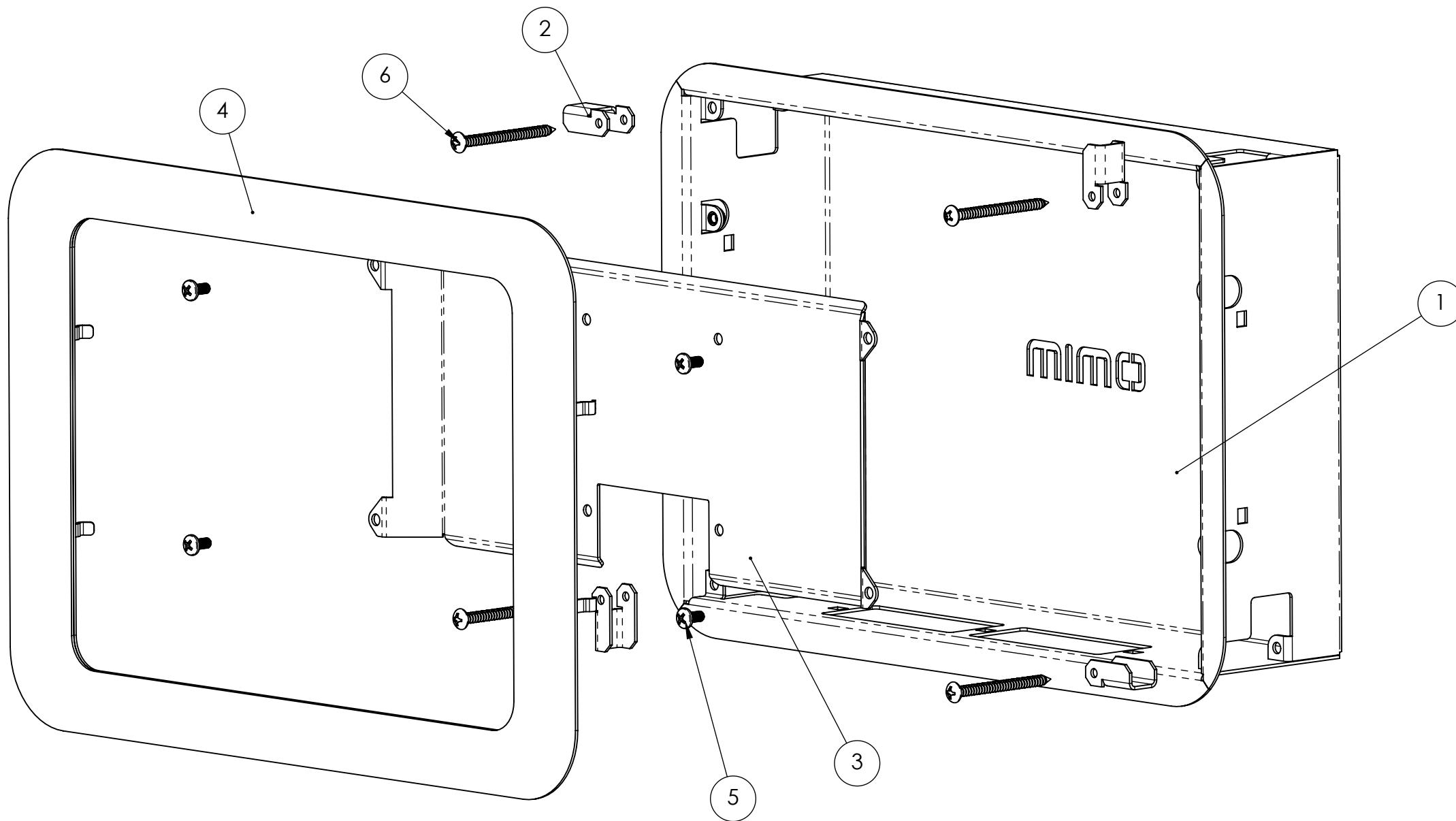

NOTES:

- 1.- WRAP IN PAPER ITEM 3 ( DO NOT INSTALL)
- 2.- PLACE ITEM 5 (8X) IN A POLY BAG 2" x 2" (ULINE S-1690)
- 3.- INSTALL ITEM 2 AND 6 (4X) AS SHOWN.
- 4.-ASSEMBLE COMPLETE AND PLACE THE BOX IN A POLY BAG 18X24 (ULINE S-1379)
- 5.- PACKAGE IN KRAFT TAB LOCKING BOX 19"x 12"x 3" (ULINE S-12640)
- 6.- LABEL FINAL PACKAGE "MWB-10-MCT"

DIMENSIONS ARE IN INCHES TOLERANCES UNLESS OTHERWISE SPECIFIED: FRACTIONS    DECIMALS    ANGLES +/-1/32    .XX +/- .02    +/- .5 .XXX+/- .010			CAD GENERATED DRAWING DO NOT MANUALLY UPDATE DO NOT SCALE DRAWING		
APPROVALS		DATE		DESCRIPTION 10" Wall Box for Tablets PART NUMBER MWB-10-MCT REV. 1	
MATERIAL SEE COMP LEVEL		SOLID MODEL SBUCIO    09-14-18			CAD FILE NAME FR1601M10X EMT    SIZE B    SCALE 1:8    SHEET 1 OF 1
FINISH SEE COMP LEVEL		DRAWN SBUCIO    09-14-18			
PROJECTION: THIRD ANGLE		CHECKED			