

# ROCKWELL®

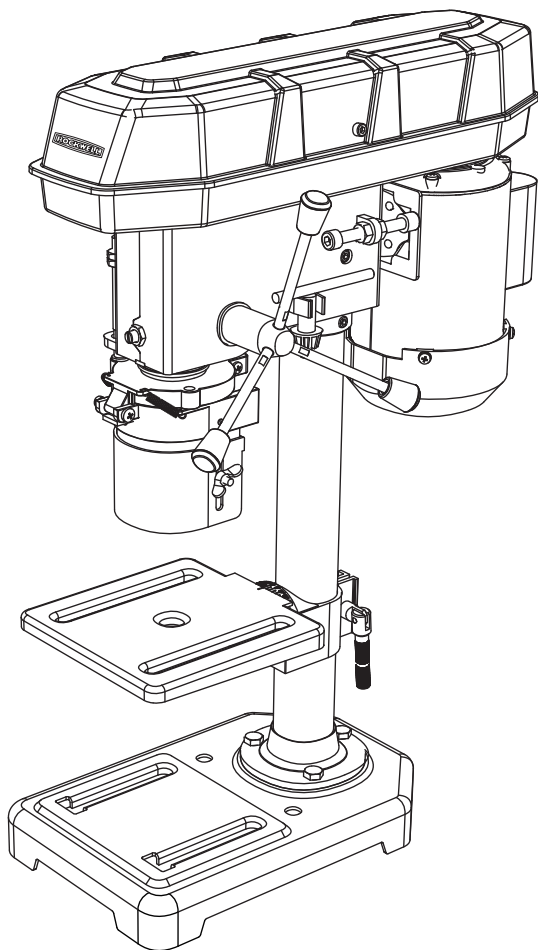

**RT7053**

**13mm DRILL PRESS**

**EN**



# RT7053

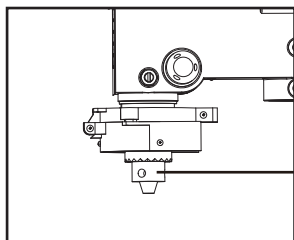
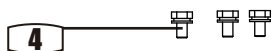
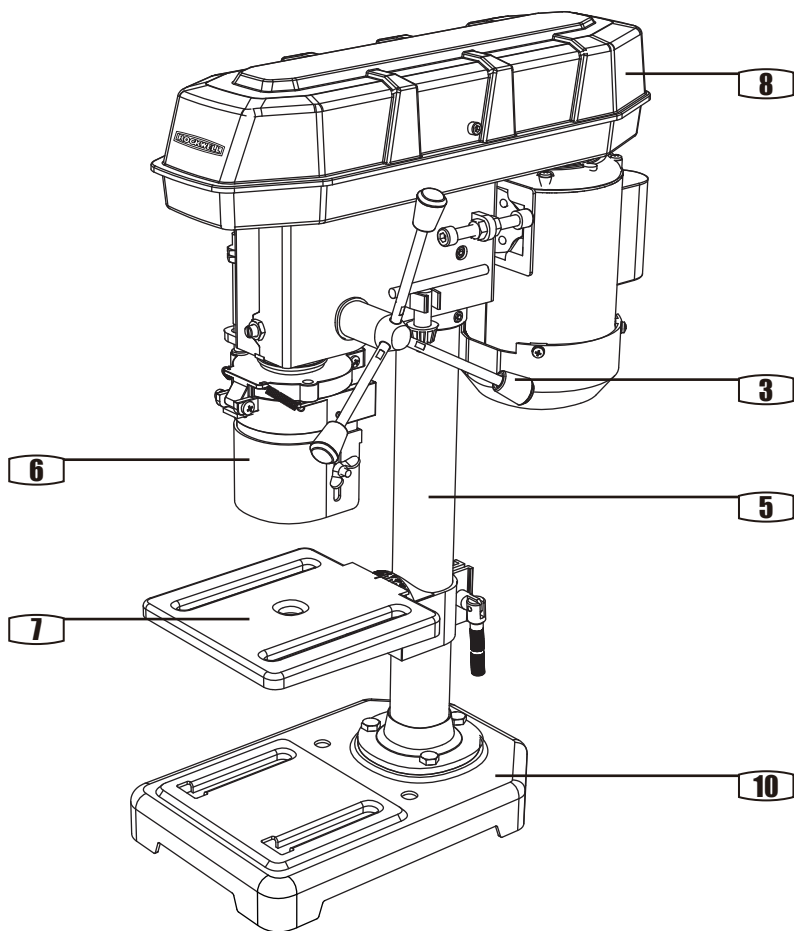

# RT7053

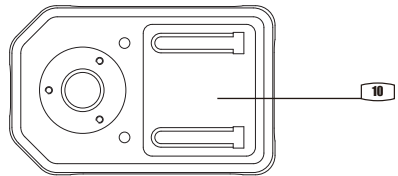
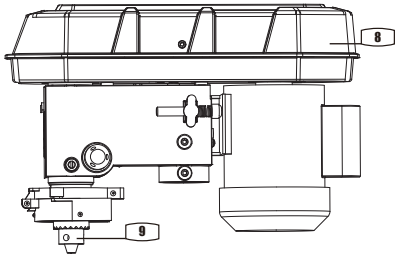
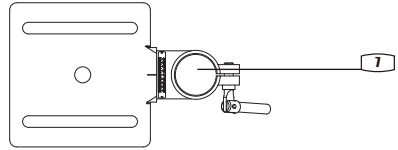
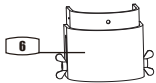
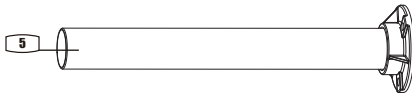
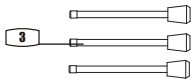
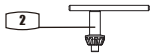

A

# RT7053

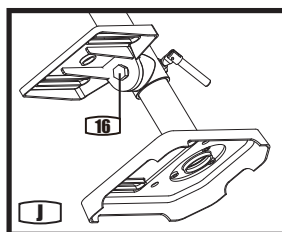
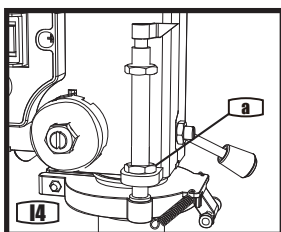
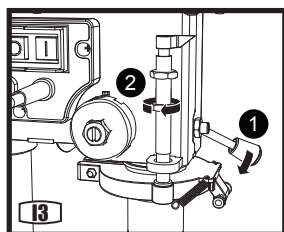
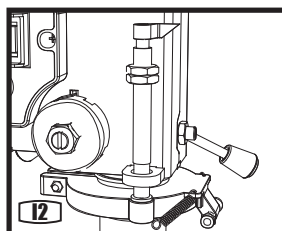
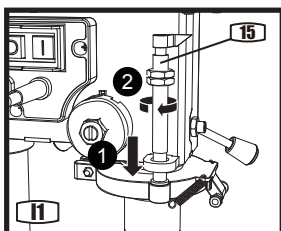
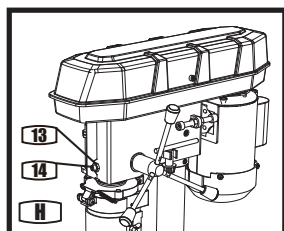
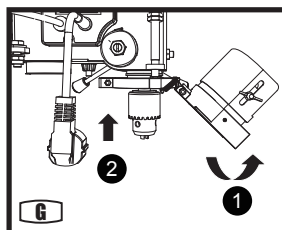
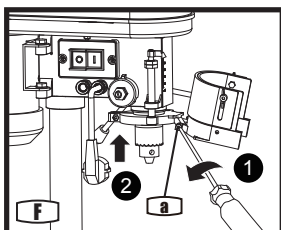
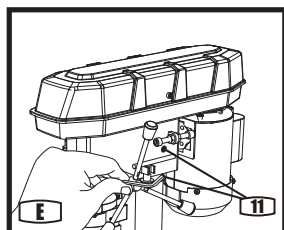
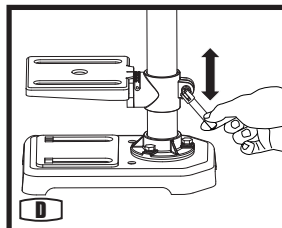
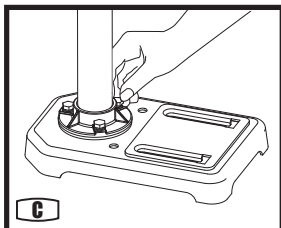
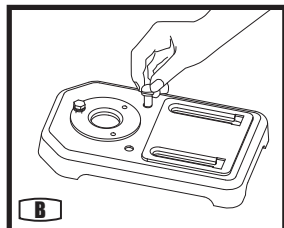

# RT7053

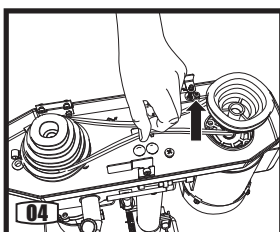
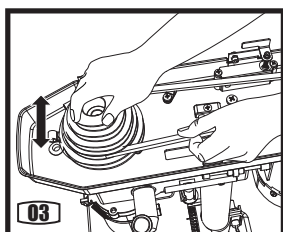
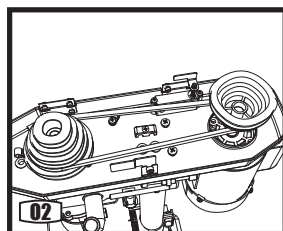
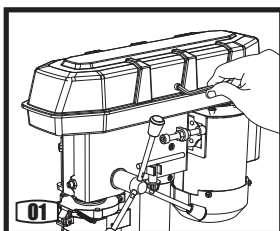
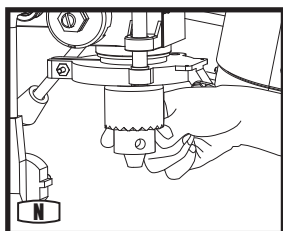
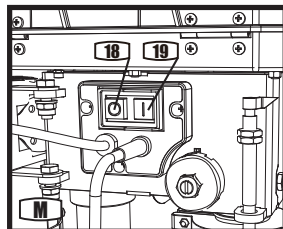
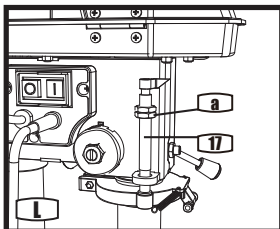
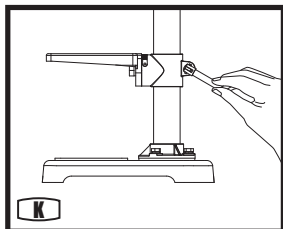

## COMPONENT LIST

- |    |  |
|----|--|
| 1  | Allen key  |
| 2  | Chuck key  |
| 3  | Up and down handles                                    |
| 4  | Bolts and washers                                      |
| 5  | Support column   |
| 6  | Safety guard   |
| 7  | Table  |
| 8  | Headstock/motor assembly                               |
| 9  | Chuck  |
| 10 | Base plate   |
| 11 | Screws (SEE FIG E)                                     |
| 12 | Guard securing screw x 3 (SEE FIG F)                   |
| 13 | Locking nut (SEE FIG H)                                |
| 14 | Spindle alignment adjustment screw (SEE FIG H)         |
| 15 | Depth stop (SEE FIG I)                                 |
| 16 | Table securing bolt (SEE FIG J)                        |
| 17 | Depth stop locking nuts, pointer and scale (SEE FIG L) |
| 18 | Switch "OFF" (SEE FIG M)                               |
| 19 | Switch "ON" (SEE FIG M)                                |

## ACCESSORIES

Chuck key	1
Allen key	1
Safety guard	1

We recommend that you purchase your accessories listed in the above list from the same store that sold you the tool. Refer to the accessory packaging for further details. Store personnel can assist you and offer advice.

## SAFETY INSTRUCTIONS

**WARNING!** When using electric tools basic safety precautions should always be followed to reduce the risk of fire, electric shock and personal injury. Read all these instructions before attempting to operate this product and save these instructions.

This appliance is not intended for use by persons (including children) with reduced physical, sensory or mental capabilities, or lack of experience and knowledge, unless they have been given supervision or instruction concerning use of the appliance by a person responsible for their safety.

Children should be supervised to ensure that they do not play with the appliance.

Safe operation

1. **Keep work area clear**
  - Cluttered areas and benches invite injuries.
2. **Consider work area environment**
  - Do not expose tools to rain.
  - Do not use tools in damp or wet locations.
  - Keep work area well lit.
  - Do not use tools in the presence of flammable liquids or gases.
3. **Guard against electric shock**
  - Avoid body contact with earthed or grounded surfaces (e.g. pipes, radiators, ranges, refrigerators).
4. **Keep other persons away**
  - Do not let persons, especially children, not involved in the work touch the tool or the extension cord and keep them away from the work area
5. **Store idle tools**
  - When not in use, tools should be stored in a dry locked-up place, out of reach of children.
6. **Do not force the tool**
  - It will do the job better and safer at the rate for which it was intended.
7. **Use the right tool**
  - Do not force small tools to do the job of a heavy duty tool.
  - Do not use tools for purposes not intended; for example do not use circular saws to cut tree limbs or logs.
8. **Dress properly**
  - Do not wear loose clothing or jewellery, they can be caught in moving parts.
  - Non-skid footwear is recommended when working outdoors.
  - Wear protective hair covering to contain long hair.
9. **Use protective equipment**
  - Use safety glasses.
  - Use face or dust mask if working operations create dust.
10. **Connect dust extraction equipment**
  - If the tool is provided for the connection of dust extraction and collecting equipment, ensure these are connected and properly used.
11. **Do not abuse the cord**
  - Never yank the cord to disconnect it from the socket Keep the cord away from heat, oil and sharp edges.
12. **Secure work**
  - Where possible use clamps or a vice to hold the work. It is safer than using your hand.
13. **Do not overreach**
  - Keep proper footing and balance at all times.
14. **Maintain tools with care**
  - Keep cutting tools sharp and clean for better and safer performance.
  - Follow instruction for lubricating and changing accessories.
  - Inspect tool cords periodically and if damaged have them repaired by an authorized service facility.
  - Inspect extension cords periodically and replace if damaged.
  - Keep handles dry, clean and free from oil and grease.
15. **Disconnect tools**
  - When not in use, before servicing and when changing accessories such as blades, bits and cutters, disconnect tools from the power supply.
16. **Remove adjusting keys and wrenches**
  - Form the habit of checking to see that keys and adjusting wrenches are removed from the tool before turning it on.
17. **Avoid unintentional starting**
  - Ensure switch is in "off" position when plugging in
18. **Use outdoor extension leads**
  - When the tool is used outdoors, use only extension cords intended for outdoor use and so marked.
19. **Stay alert**
  - Watch what you are doing, use common sense and do not operate the tool when you are tired.
20. **Check damaged parts**
  - Before further use of tool, it should be carefully checked to determine that it will operate properly and perform its intended function.
  - Check for alignment of moving parts, binding of moving parts, breakage of parts, mounting and



any other conditions that may affect its operation.

- A guard or other part that is damaged should be properly repaired or replaced by an authorized service centre unless otherwise indicated in this instruction manual.
- Have defective switches replaced by an authorized service centre.
- Do not use the tool if the switch does not turn it on and off.

## 21. Warning

- The use of any accessory or attachment other than one recommended in this instruction manual may present a risk of personal injury.

## 22. Have your tool repaired by a qualified person

- This electric tool complies with the relevant safety rules. Repairs should only be carried out by qualified persons using original spare parts, otherwise this may result in considerable danger to the user.

## 23. If the replacement of the supply cord is necessary, this has to be done by the manufacturer or his agent in order to avoid a safety hazard.

## 24. For tools intended to be connected to a water supply:

- Replacement of the plug or the supply cord shall always be carried out by the manufacturer of the tool or his service organisation.
- Keep water clear off the electrical parts of the tool and away from persons in the working area.

## SYMBOLS



To reduce the risk of injury, user must read instruction manual



Warning



Wear ear protection



Wear eye protection



Wear dust mask



RCM marking

ABN: Australian Business Number. By this number, business information such as entity type, status, business location etc. can be found at website <http://abr.business.gov.au>.

ABN of Positec Australia Pty Ltd is 14 101 682 357

## TECHNICAL DATA

Type RT7053 (RT, RS-designation of machinery, representative of Pillar Drill)

	RT7053
Voltage	230-240V~50Hz
Power input	350W
No load speed	500-2500/min
Drilling capacity	13mm
Depth of throat	104mm
Table size	160mm x 160mm
Table bevel	0-45 degree
Speed steps number	5
Spindle taper	B13
Spindle travel	50mm
Machine weight	13.2kg

## OPERATING INSTRUCTIONS



**NOTE:** Before using the tool, read the instruction book carefully.

### INTENDED USE

The machine is intended for drilling in metal, wood and plastic.

## ASSEMBLY INSTRUCTIONS

### 1. UNPACKING YOUR TOOL

Carefully unpack all of the contents and lay them out on the floor (See Fig. A). To prevent corrosion some of the parts have been coated in a fine layer of oil, it is advised to assemble this product in a working area to prevent damage to upholstery or carpets. Check

contents against check list. Retain packaging until all parts are accounted for and assembly has been completed.

Lift out base plate and remove protective paper and place on workbench.

Inside the small box you will find the chuck, three handles, three set bolts, three washers, allen key and chuck key. Place on workbench.

Lift worktable out and remove protective paper. Put on workbench. Remove headstock and motor assembly and put on workbench. Remove column and plastic guard. Put plastic guard away for time being.

## 2. ASSEMBLY

Take base plate and select a suitable place on workbench for mounting (See Fig. B). Be aware of table legs and anything, which might reduce access to underneath:

Locate the four mounting holes (with 12mm diameter). Select suitable length bolts (at least 45mm length), washers and nuts (not supplied). Using base as a template drill four holes through the workbench. Bolt the base plate to the bench. Do not overtighten as this could crack the cast base.

Take the protective paper or plastic bag off the column. Align with the three threaded holes on the base plate. (See Fig. C) Secure with the three bolt sets supplied. Again do not use excessive torque.

Slide the adjustable height work table over the column. Secure midway with the clamping lever. (See Fig. D)



**CAUTION: The head stock and motor assembly is heavy and may require two person handling.**

Use the allen key to loosen the two screws.

Lower the headstock and motor assembly all the way onto the column.

Position the headstock and motor assembly so the front aligns with the centre of the base plate.

Use the allen key to tighten the two screws. Retain the allen key for further adjustments. (See Fig. E)



**CAUTION: Do not connect to power supply yet.** Loosen the securing screw (a) of the safety guard, insert the guard into the spindle and tighten the screw (See Fig. F). Open the safety guard, and insert the chuck into the spindle. The chuck is mounted firmly when you can not pull it out with your hand (See Fig. G).

Attach the three handles into the feed shaft. (See Fig. H)

Raise the table and place a piece of scrap wood on it. Locate the depth stop into the hole and hold it using one hand, then rotate clockwise to lock it using another hand. Keep the red depth mark with the 0mm level. (See Fig. I1, I2).

Rotate the handles to keep the red depth mark with any depth you want, then rotate the lower screw (a) onto the hole to fix the depth. (See Fig. I3, I4)

**NOTE:** It has a tapered shaft and the chuck locates onto this. Bring the chuck into contact with the wood on the work table and gently apply pressure to lock the chuck onto the spindle.

## OPERATING INSTRUCTIONS

### 1. OPERATING THE PILLAR DRILL

**NOTE:** Remove the plug from the socket before carrying out any adjustment, servicing or maintenance.

#### 1) SELECTING THE CORRECT SPEED FOR DIFFERENT WORK

Refer to speed selection label inside of motor housing and select the speed required for the job in hand. The tool has five speed settings: 500-2500/min. Choose the setting nearest to the speed selection label recommendation.

#### 2) WORK TABLE ADJUSTMENT

The table can rotate Bevel  $\pm 45$  degrees. Loosen the table securing bolt and rotate to desired angle. Retighten lock nut. (See Fig. J)

Loosen the locking lever to the rear of the table. (See Fig. K)

Move the column up or down to desired height. When desired height is reached lock into position.

#### 3) DEPTH STOP ADJUSTMENT

Bring the drill bit in contact with the work piece to be drilled. Take a measurement from the scale on front of tool (See Fig. L). Move work piece and add the amount on to the previous measurement. Move lock nuts down to that required position and lock. This will give a consistent depth when drilling.

#### 4) STARTING AND STOPPING THE PILLAR DRILL

The tool is fitted with a no volt switch assembly (See Fig. M). This means in the event of a power failure when drilling, the motor will not start once the power is restored until the switch is reactivated.

**NOTE:** The cover is fitted with a safety interlock switch (See Fig. N). If the cover is not correctly located and

secured following a speed change, the main switch may fail to operate.

Check that the cover is fully closed and secured.

Loosen the screw of the headstock/motor assembly and open the cover, then adjust the speed by moving the belt among different groves (See Fig. O1, O2, O3).

Check the belt by pulling it with pressure from the middle using one hand, and the belt is fine when it is locked on the fixed groove and not moving upward (See Fig. O4).

---

## **MAINTENANCE**

Always lubricate the drill bits with suitable oil before drilling. This will prolong the life of the drill bits.

**Caution:** Do not use water-based coolant or any kind of continuous coolant pump.

Remove all shavings and dust after each operation.

Spread oil onto the unplated surfaces especially if the machine is not used for long periods.

Lubricate the spindle drive with oil every six months.

The spindle guide screw should be checked periodically to finger tightness.

If the supply cord is damaged, it must be replaced by the manufacturer, its service agent or similarly qualified persons in order to avoid a hazard.



**POSITEC AUSTRALIA PTY LTD**  
**ABN 14 101 682 357**

**MADE IN PRC**