

SPIN DOWN SEDIMENT WATER FILTER





SPIN DOWN SEDIMENT WATER FILTER

Owner's Manual

OWNERS MANUAL

SPIN DOWN SEDIMENT WATER FILTER

Model: WHP1

Installation, Operation and Maintenance

Congratulations on the purchase of your spin down sediment filter. It is the first line of defense to protect and extends the life of your standard water filters and other system such as UV sterilizer by removing the large dirt, sand and rust particles before they reach the rest of your plumbing system and your expensive appliances.

SAFETY INFORMATION

These are the original instructions. Please read this entire manual before operating this equipment. Pay attention to all danger, warning and caution statements in this manual. Failure to do so could result in serious personal injury or damage to the equipment.

Make sure that the protection provided by this equipment is not impaired. DO NOT use or install this equipment in any manner other than that specified in the installation manual.

The information and recommendations contained in this publication are based upon data by Applied Laboratories Limited and are believed to be correct. However, no guarantee or warranty of any kind, expressed or implied, is made with respect to the information contained herein. Specifications and information are subject to change without notice.



Potential Hazards

Read all labels and tags attached to the system. Personal injury or damage to the system could occur if not observed. **CAUTION:** The stainless steel mesh is easily damaged. Exercise care when handling



This is the safety alert symbol. Obey all safety messages that follow this symbol to avoid potential injury. When on the equipment, refer to the Operational and Maintenance manual for additional safety information



This symbol indicates the operator must read all available documentation to perform required procedures

Warning: This product may contain chemicals known to the State of California to cause cancer and birth defects or other reproductive harm.



CAUTION

- Keep out of direct sunlight. UV rays can weaken the integrity of the filter housing, and also promotes biological growth within the water filter unit.
- Make certain that installation complies with all state and local laws and regulations.
- Filter housing must be protected against freezing temperatures, frost, snow, sleet, and ice. Exposure to these elements can produce cracks and product failures.
- Some harmless bacteria may attack the filter. If your filter seems to disintegrate or develops a mushy or moldy odor, switch to a new filter.



DANGER

Failure to follow these instructions will result in serious injury or death.

- **DO NOT** use this water filter for other than intended use (potable water applications). The use of attachments not recommended or sold by the manufacturer / distributor may cause an unsafe condition.
- **DO NOT** install this water filter where it will be exposed to the weather or to temperatures below freezing unless all water has been drained from it and the water supply has been disconnected.



WARNING

- Changes or modifications made to this system without the consent of the manufacturer could render the system unsafe for operation and may void the manufacturer's warranty.
- Do not use with water that is microbiologically unsafe or of unknown source/quality without adequate disinfection before or after the system.
- Filter housing must be protected against freezing temperatures, frost, snow, sleet, and ice. Exposure to these elements can produce cracks and product failures.
- The rubber O-Ring provides the water-tight seal between the filter head and the housing. It is important that the O-Ring be properly seated in the O-Ring groove or a water leak will occur.



NOTICE

- Read and understand the Owner's Manual before operating and performing any maintenance on this equipment.

PRODUCT APPLICATION

- The water filter is designed to mount with the inlets/outlets horizontally.

PRINCIPLE OF OPERATION

- The WHP1 will remove dirt, sand, rust and other partikels, it protects and extends the life of water filter which are typically installed behind this system. It also prevents the faucets from being damaged by grinding from small particles in the water.
- It should be installed as a pre filter and its flushable and reusable. With just a quick turn of the lever it can flush out particles that are trapped in the filter without the need to shut down the water supply first.

LIMITATION OF USE

The water filter is intended for the use with visually clear water, not colored, cloudy or turbid. See “Water Quality” section. The water purifier is NOT intended for the treatment of water that has an obvious contamination or intentional source, such as raw sewage; nor is the unit intended to convert waste water to microbiologically safe drinking water.

WHP1

Model no	WHP1	Flush valve	3/8 inch
Pressure Range	15 - 115 PSI	Rating temperature	40°F - 113°F
Water outlet	1"MNPT & 3/4 FNPT	Filter item no	WHP1
Water inlet	1"MNPT & 3/4 FNPT	Flow rate	13 GPM

PARTS INCLUDED

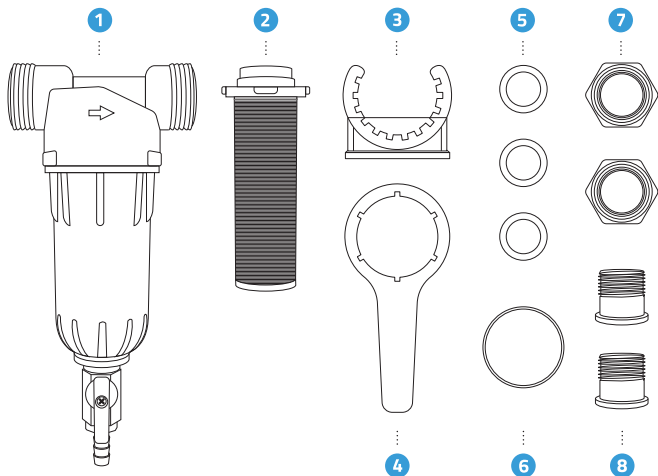

1 Filter Housing
with Flush Valve

2 Filter - 50 Micron

3 Mounting Bracket

4 Housing Wrench

5 Gasket rings

6 Spare O-Ring

7 Hexagonal Nut

8 3/4 Joint

INSTALLATION

- 1** **Open package to check all components inside:**
See content on previous page
- 2** Install filter after water meter or pressure tank. Turn off water supply and open the nearest faucet to drain pipes before installation. Start by making sure the arrows facing you on the housing are consistent with the direction of your water flow.
- 3** Connect the filter housing either with the 1" MNPT or 3/4" depending on your piping or preferences. Measure the overall length of the water filter and reduce this measurement enough to allow for full engagement of the pipe into the adapter. Mark this length on the pipe and use a pipe cutter or saw to cut and remove it. File or sand sharp edges on remaining pipe. Slip the brass nut and sealing gasket, or ferrule (not included) onto each end of the pipe. Use Teflon tape for fitting connections.
- 4** If using the optional mounting bracket attach it to the wall and slide the housing inside.
- 5** Align the filter housing with the ends of the pipe and make sure the water flows in the same direction as the arrow indicator on the housing and tighten firmly. **Do not over-tighten!**
- 6** After it the water filter has properly been installed slowly turn on the main water supply and check for leaks. Open the nearest faucet and flush filter for about 3 minutes.

FILTER REPLACEMENT

- 1** Turn off water supply and open the nearest water faucet to drain pipes. Unscrew the clear housing from the housing cap with the supplied housing wrench. Remove o-ring from housing, wipe it clean and set it aside. If its damaged, replace it with the supplied spare o-ring.
- 2** Rinse out the housing and fill 1/3 of water, add two tablespoons of bleach and scrub with a soft brush or sponge. Rinse several times thouroughly. Lubricate o-ring with clean food grade silicone grease and insert it into the groove of housing.
- 3** Insert a new water filter cartridge into the hole of the bottom cap and screw the housing back onto the cap until its tight.
DO NOT OVER-TIGHTEN.
- 4** Turn on water supply slowly to allow filter to fill with water and check for leaks. Flush filter for about 3 minutes.

MAINTENANCE

The water filter's see thru housing offers easy visual monitoring. To ensure the filter performance, the unit should be flushed out at least once per week. To flush connect a hose to the flush valve at the bottom. Turn off the valve after the outlet and open the lever of the flush valve. Be careful as now all the water and dirt will exit on the bottom thru the hose.

Do a visual check on the stainless steel filter once per month. To clean it, twist off the clear housing with the supplied tool and take out the filter carefully. Clean it with a brush and vinegar to remove any mineral deposits.

Replace the mesh filter unit every 12 to 24 months, depending on the pollution of your water and usage.

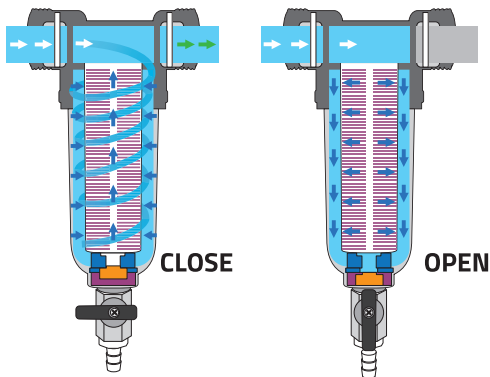

INFORMATION FOR USAGE

After periods of non-use (such as during a vacation) we recommend to flush the system thoroughly. Let water run for 5–6 minutes before using.

All filter cartridges have a limited service life. Changes in taste, odor, color, and/or flow of the water being filtered indicate that the cartridge should be replaced.

TROUBLESHOOTING

1

LEAKS BETWEEN FILTER HEAD AND HOUSING

Turn off water supply and press the red pressure-relief button. Remove bottom of housing.

Clean O-Ring and O-Ring groove (located directly beneath threads of housing). Lubricate O-Ring with clean silicone grease and place securely into groove. Screw housing into filter head and hand-tighten.

DO NOT OVER-TIGHTEN.

2

LEAKS FROM INLET/OUTLET CONNECTIONS

Turn off water supply. For brass fittings, tighten nut snugly about 1/2-turn with a wrench.

Turn on water supply. If leaks persist, or if there are other leaks on system, consult with your local plumber.

USEFUL INFORMATION

RELATIVE SIZE OF PARTICLES IN MICRONS

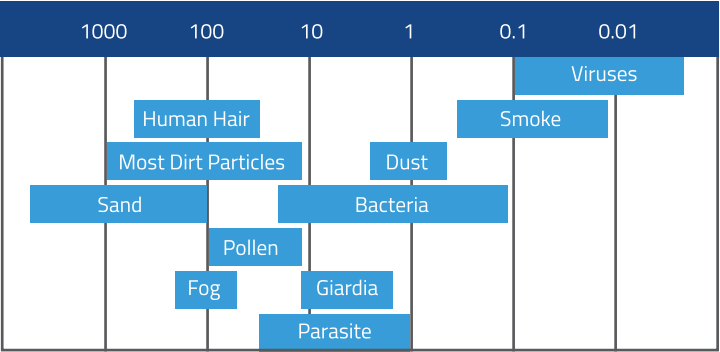

1 YEAR LIMITED WARRANTY

We Cover

This warranty covers any defects in the parts or manufacturing of the Express Water Spin Down Sediment Filter. We will give you new replacement parts in exchange for any defective parts. This doesn't apply to consumable items like filters.

What to Do

Give us a call at 1-800-992-8876 and describe the problem to our support. Be sure to have a copy of your purchase confirmation email or receipt. Our support will verify that the product and problem are under warranty and help you arrange to send your defective part back to Express Water with a copy of your receipt and contact information (name, address, phone number, email address). Support will help arrange sending of the defective item/part, the delivery of your replacement part, as well as guide you through the installation.

Time Covered

This warranty is effective for 1 full year from the date of original purchase.

Not Covered

This warranty does not cover labor for removal or installation, accumulation of dirt or grime (you are responsible for your own cleaning), systems with the serial number removed or altered, damage from improper storage (high or low temperature, sun damage, etc), damage from a system not installed as instructions directed, anyone other than the original purchaser, damage from system abuse or unintended operation of system, acts of God, improper water source, modification, negligence, commercial use of the system, Filters, incidental damages from system failure, systems used with parts not provided by Express Water (including tanks, filters, faucets, pumps, diverter valves), or cosmetic damages.

Your Province/State

Some provinces/states has further regulation on damages and warranty coverage. You may have other rights depending on your state.

Support

For warranty questions, service, or help give us a call Monday - Friday 10 am to 5 pm PST:

1-800-992-8876, or email us at: support@expresswater.com



www.expresswater.com

1-800-992-8876