



**LIGHT^{MY}
BRICKS**



**LEGO® PEUGEOT 9X8 24H LE MANS
HYBRID HYPERCAR #42156
LIGHT KIT
INSTALLATION GUIDE**

Light My Bricks



LEGO® PEUGEOT 9X8 24H LE MANS HYBRID HYPERCAR 42156 INSTALLATION GUIDE

Hi There!

We're here to help you get started on the LEGO®

Peugeot 9X8 24H Le Mans Hybrid Hypercar 42156 Light Kit.

This PDF details the instructions for the LED light kit only. If you are wishing to purchase this product, please [click here](#) to view the product page.

If you run into any issues, please refer to the troubleshooting section towards the end of this guide.

Have fun and enjoy!

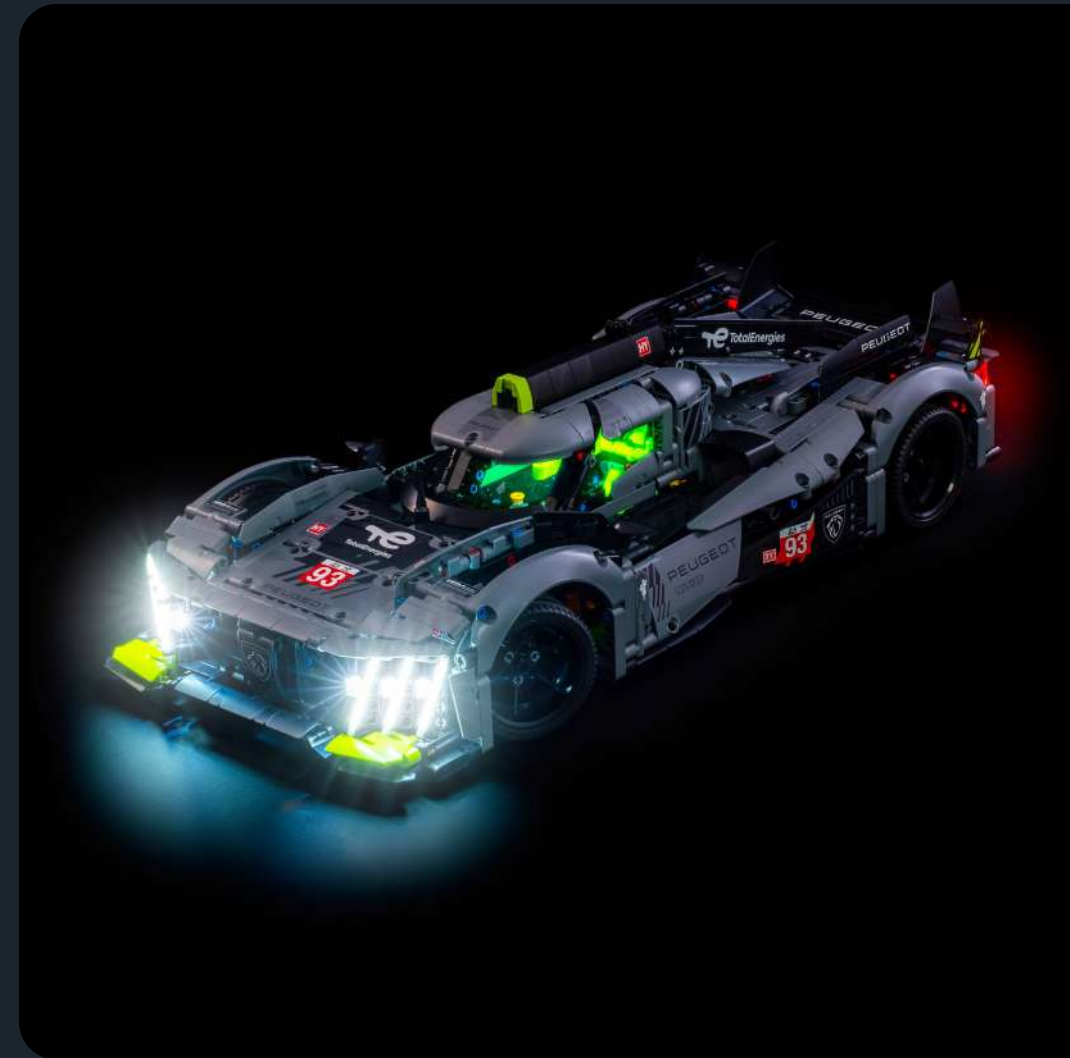



PACKAGE CONTENTS:

Individual Bags



- 12x Red 30cm Large Bit Light
- 7x Cool White 30cm Bit Light
- 6x Cool White 4.2cm Light Bar
- 1x Dimmer Control Board

Connecting Cables



- 2x 5cm Connecting Cable
- 2x 15cm Connecting Cable

USB Power Cable



- 1x USB Power Cable
(Power Source not Included)

Mixed Components 1



- 3x 8-Port Expansion Board
- 1x 12-Port Expansion Board
- 12x Adhesive Square

- 6x Plate, Round 1x1 - Trans Clear
- 1x Plate, Round 1x1 - Trans Dark Green
- 1x Technic Pin 1/2 - Light Bluish Grey

Contents

Before You Begin	5
Blueprint	10
Instructions	11
Final Product	48
Troubleshooting	49
Contact	53

Before You Begin

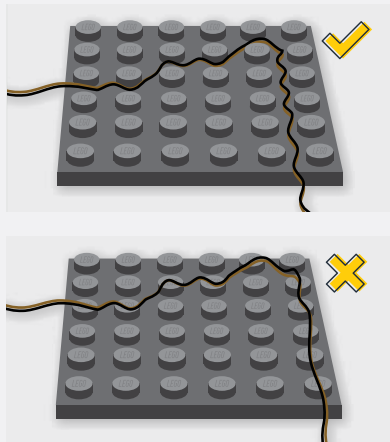

Laying cables in between and underneath bricks

Cables can fit in between and underneath LEGO® bricks, plates, and tiles providing they are laid correctly between the LEGO® studs. Do NOT forcefully join LEGO® together around cables; instead ensure they are laying comfortably in between each stud.

CAUTION: Forcing LEGO® to connect over a cable can result in damaging the cable and light.



Connecting Cable Connectors To Expansion Boards

Take extra care when inserting connectors to ports of Expansion Boards. Connectors can be inserted only one way. With the expansion board facing up, look for the soldered “=” symbol on the left side of the port. The connector side with the wires exposed should be facing toward the soldered “=” symbol as you insert into the port. If a plug won’t fit easily into a port connector, do not force it.

Incorrectly inserting the connector can result in bent pins inside the port or possible overheating of the expansion board when connected.

Before You Begin



Connecting Cable Connectors To Strip Lights

Take extra care when inserting connectors to ports on the Strip Lights. Connectors can be inserted only one way. With the Strip Light facing up, ensure the side of the connector with the wires exposed is facing down. If a plug won't fit easily into a port connector, don't force it. Doing so will damage the plug and the connector.



Connecting Micro Cable Connectors To Micro Expansion Board Ports

Take extra care when inserting the micro connectors to micro ports of Micro Expansion Boards. Connecting Micro Bit Lights to Micro Expansion Boards is similar to connecting lights and cables to Strip Lights. With the expansion board facing up, ensure the side of the connector with the wires exposed is facing down. If a plug won't fit easily into a port connector, do not force it. Use your fingernail to push the plastic part of the connector to the micro port.

Before You Begin

Installing Bit Lights Under Lego® Bricks And Plates

When installing Bit Lights under LEGO® pieces, ensure they are placed the correct way up (Yellow LED component exposed). You can either place them directly on top of LEGO® studs or in between.



Before You Begin

The Symbols Used In This Guide

When going through the following guide you will come across symbols and formats that will assist with the installation of your light kit. Take notice of them as each has a specific purpose.

Light Kit Component

This is the most important image format as it indicates which part to use from the Light Kit. Make sure you pay close attention to which part is shown.

White 30cm Bit Light



Connect

Used when you need to connect a LEGO piece or LMB component.



Disconnect

Used when you need to remove a LEGO piece/ section or LMB component.



Directional

Used to show where to route cables, place components, or move them.



Bend/Pivot

Used when a component needs to be bent, or part folded or pivoted.



Turn/ Flip

Will be found in the top left corner when the set needs to be rotated or flipped.



Twist/ Braid

Seen when a set of cables need to be grouped and twisted together.



Power On Test

Found at the end of a major step to test the lights. Will be located in the top left corner.



Note

Notes will be found alongside the instruction photos and explain what to do.



Before You Begin

Repeat Step

Repeat the previous step eg. Make a spotlight, then make a second spotlight.

x2

Connect Focus

Used to highlight a hard to see area where a component is being connected.



Disconnect Focus

Used to highlight a hard to see area where a component is being disconnected.



General Focus

Used to highlight a hard to see area where a component needs to be acted on.



General Note

This is a sample note that is used anywhere in this guide. It will explain a difficult section where photos are hard to illustrate or easily confused.

Connect Note

The green coloured note is used when the topic focuses on a component being connected, like the shown Power Bank.

Disconnect Note

The red coloured note is used when the topic focuses on a component being disconnected or like here, the removed pieces.



NOTE

Take the 5cm Connecting Cable from the 4-Port Micro Expansion Board and route it into the "IN" port of the Flicker Effects Board

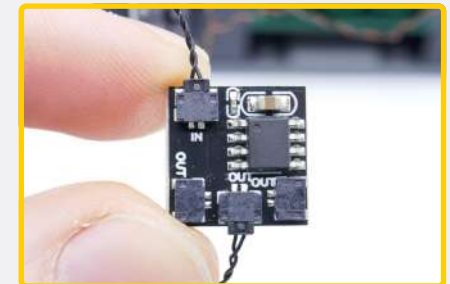



NOTE

Connect to a 5V USB Power Bank, 5V USB Wall Adaptor, or USB to AA Battery Pack (sold separately)





NOTE

You should have these parts left over that were removed from the LEGO set





BLUEPRINT

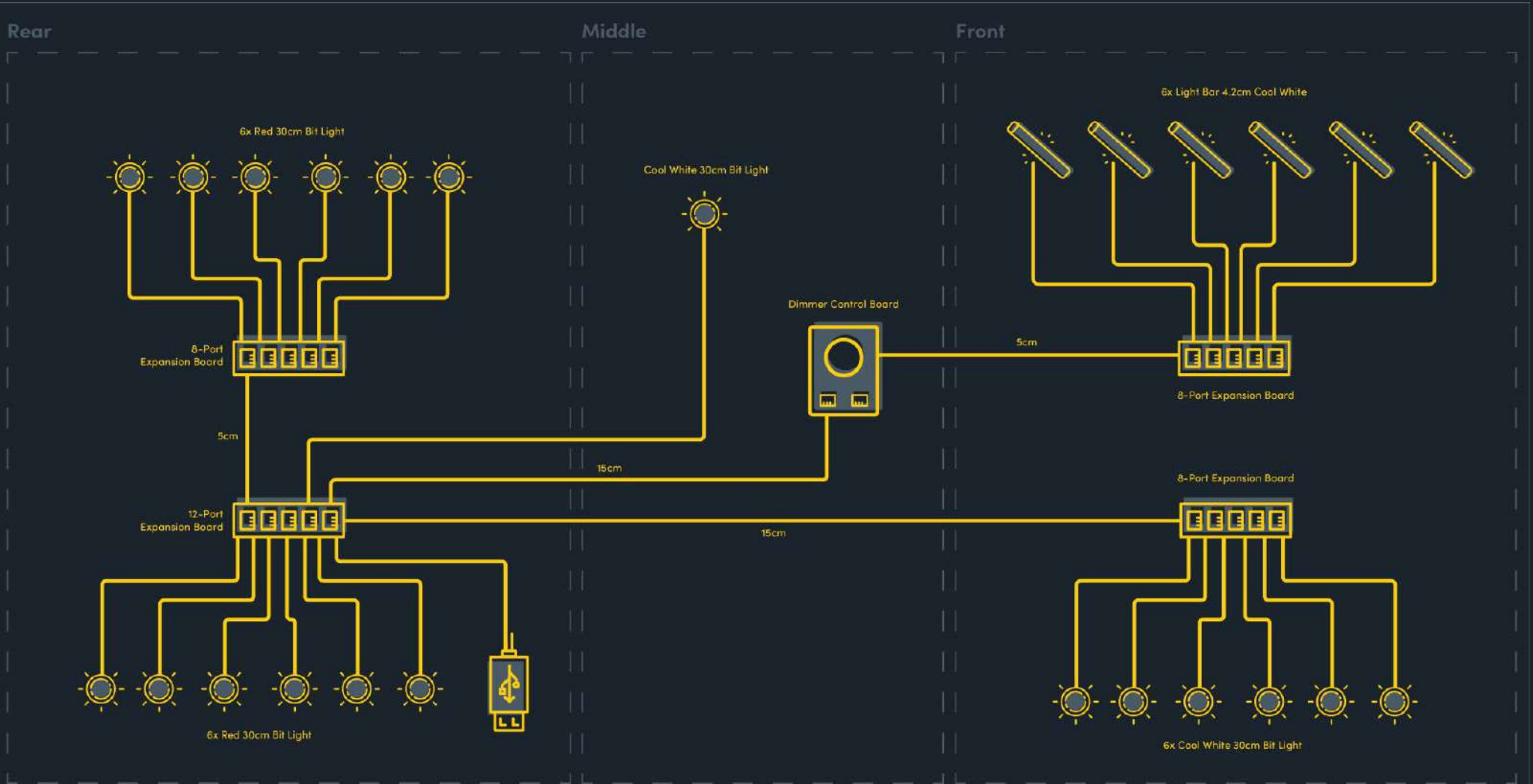



INSTRUCTIONS

To ensure a smooth installation of your light kit, please read and follow each step carefully. If you run into any issues, please refer to the online troubleshooting guide.

1



2



Technic, Pin 1/2 without Friction Ridges - Light Bluish Gray



Cool White 30cm Bit Light

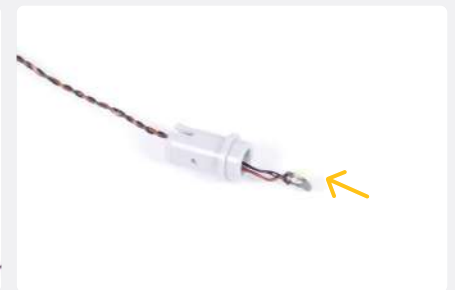

Plate, Round 1x1 - Trans-Dark Green

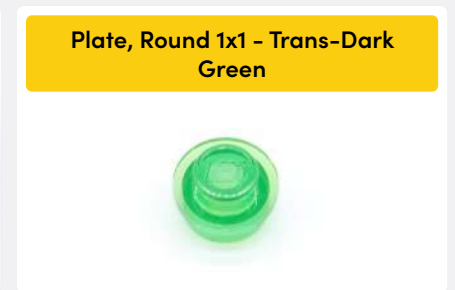
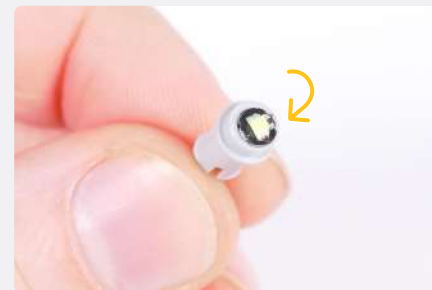

3

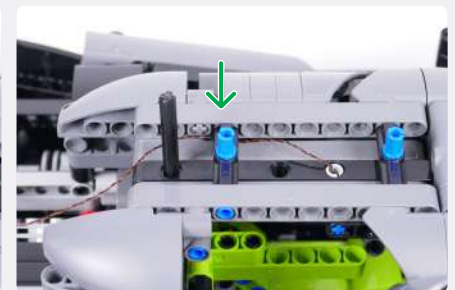

4

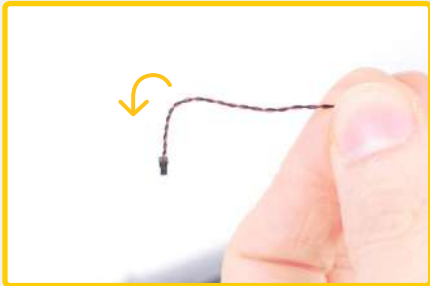
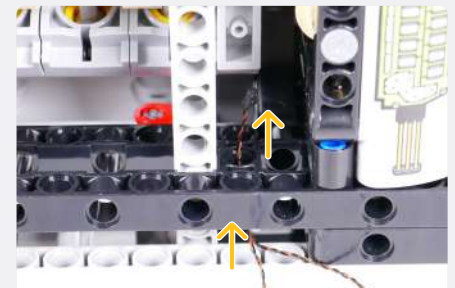
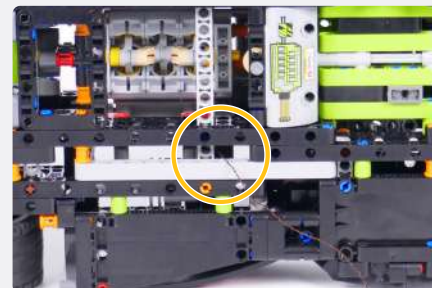
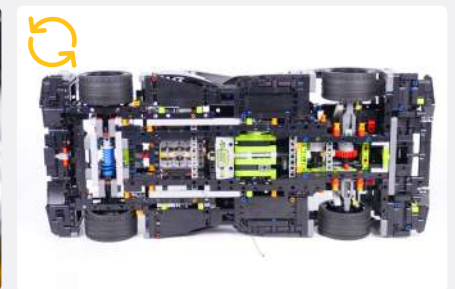
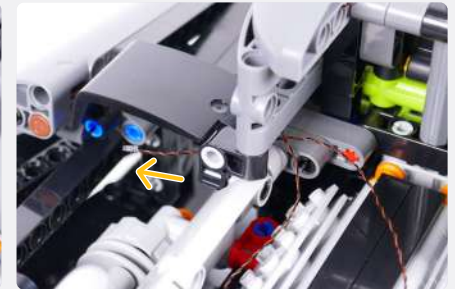

NOTE

Bend the cable on an angle to thread it through the Technic holes.

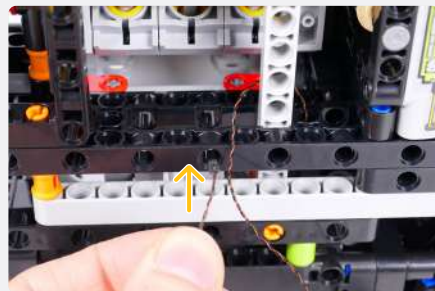
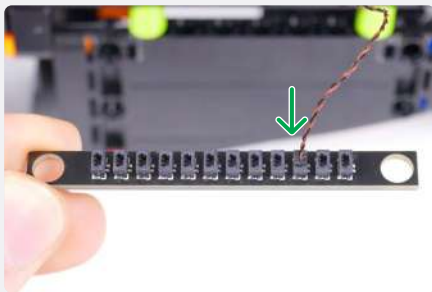
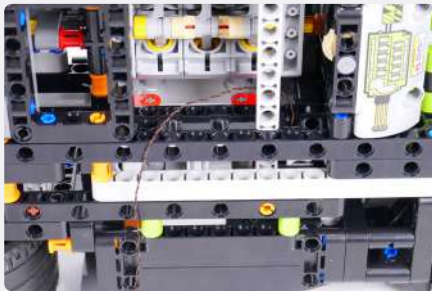
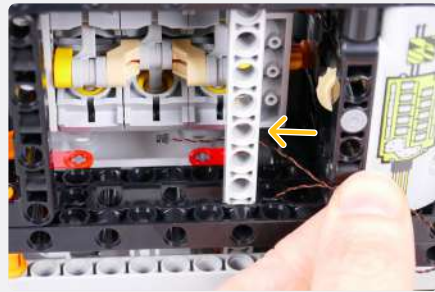
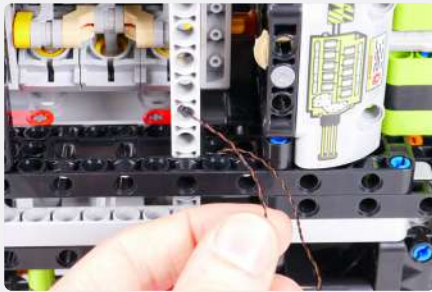

5

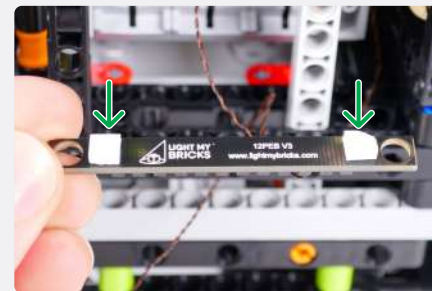
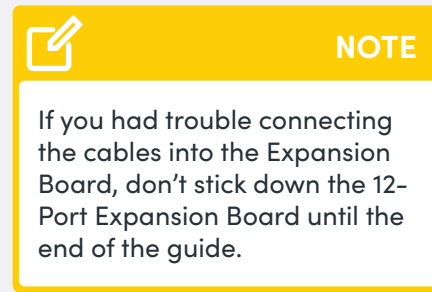
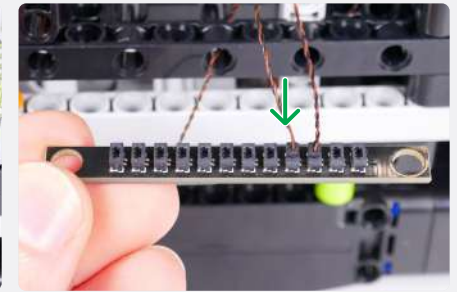
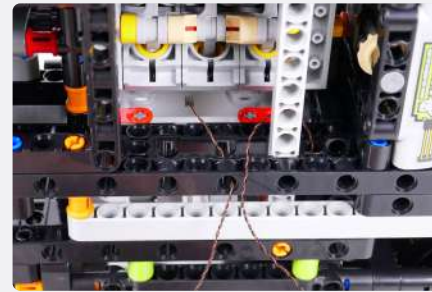

6

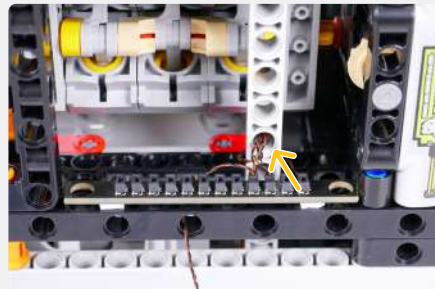
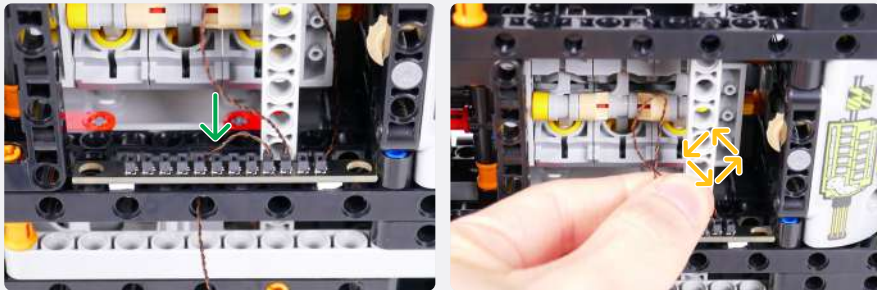

7



NOTE

Connect to a 5V USB Power Bank, 5V USB Wall Adaptor, or USB to AA Battery Pack (sold separately)



! If you experience any issues with the lights not working and suspect an issue with a component, please try a different port on the expansion board to verify where the fault lies (with the light or expansion board). To correct any issues with expansion board ports, please view the section addressing expansion board issues in our troubleshooting section. i



8



9

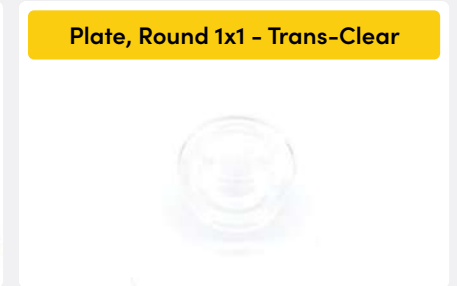
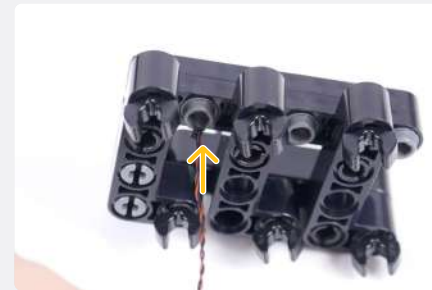
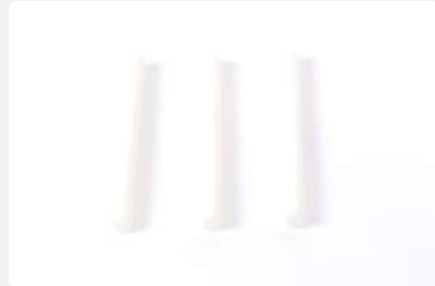

10

Cool White 30cm Bit Light



Plate, Round 1x1 - Trans-Clear



11

Cool White 30cm Bit Light



Plate, Round 1x1 - Trans-Clear



12





13



14

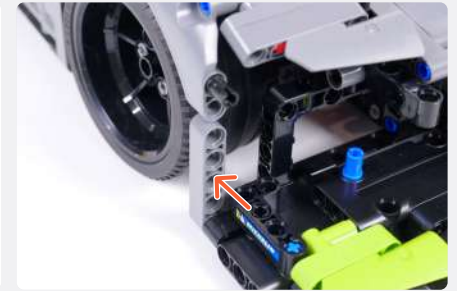
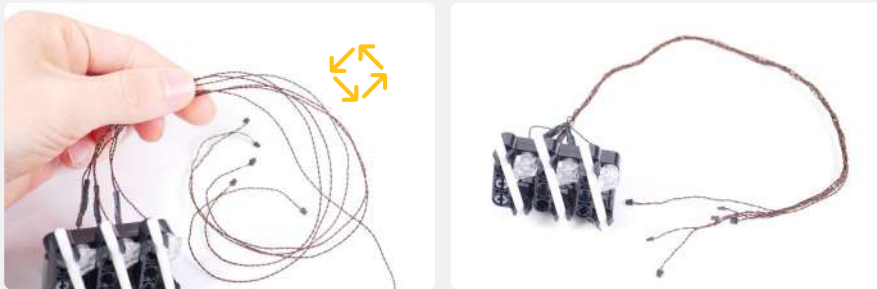
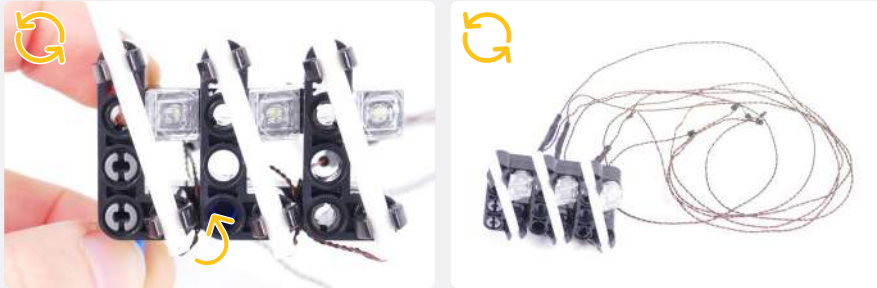
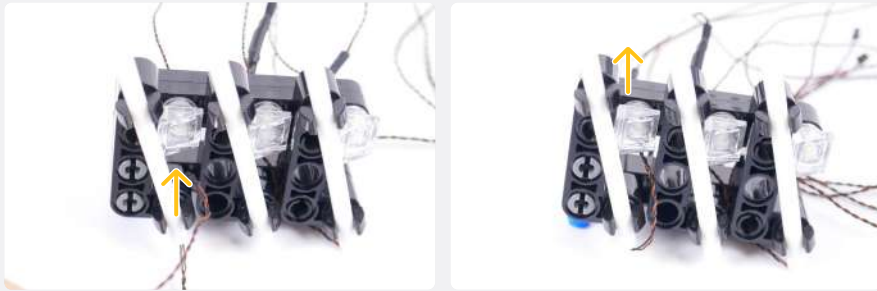



 **NOTE**

Use the wheel to prop up the car in this position.

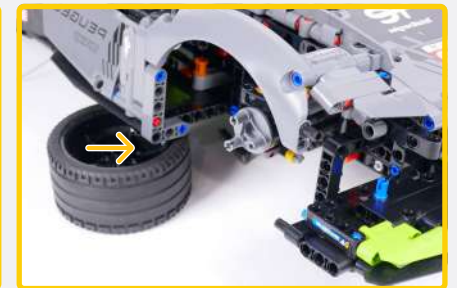

15

16

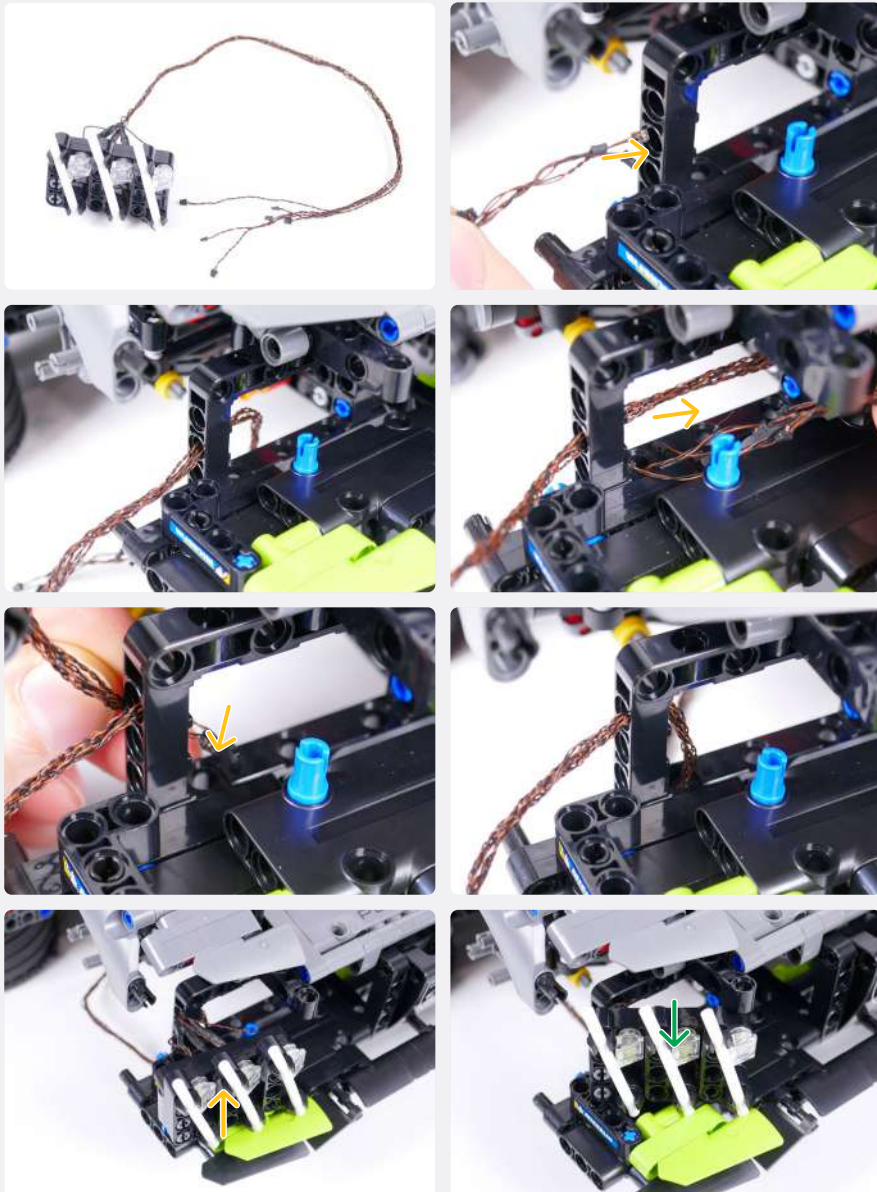

17

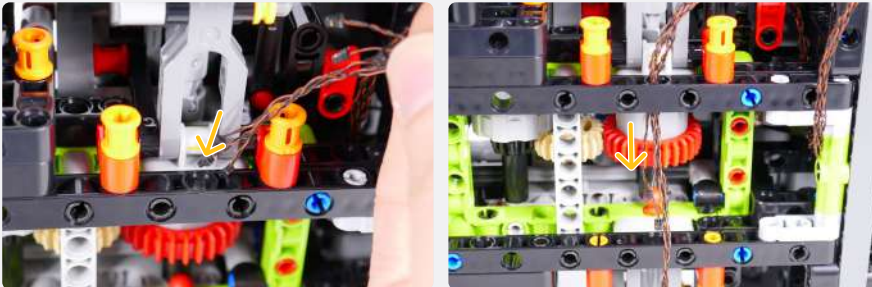
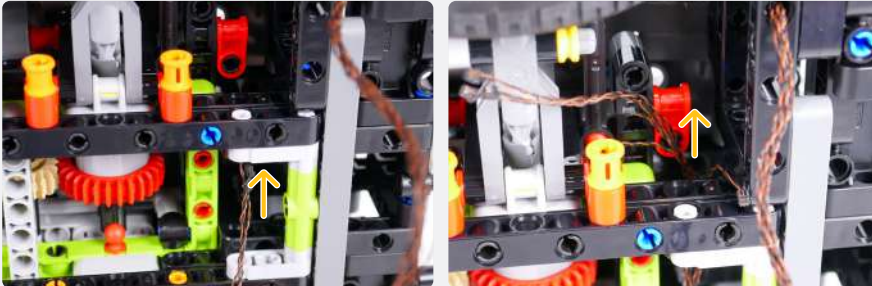
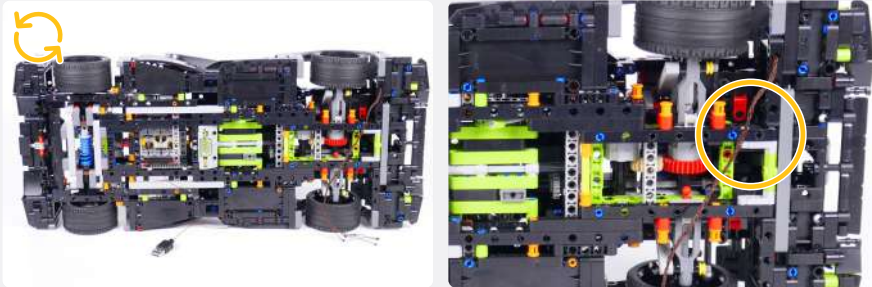

NOTE

Take the 3 shorter cables and connect them to a 8-Port Expansion Board.

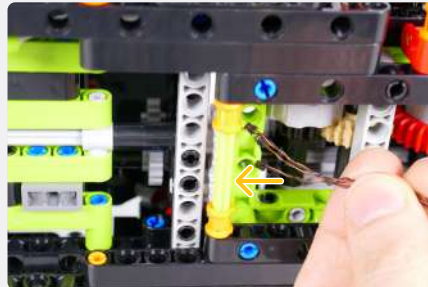
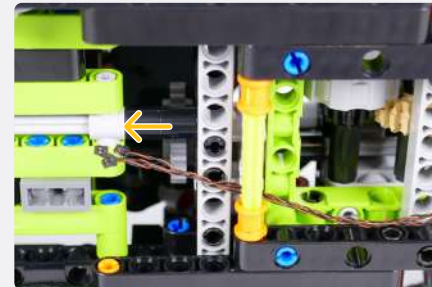
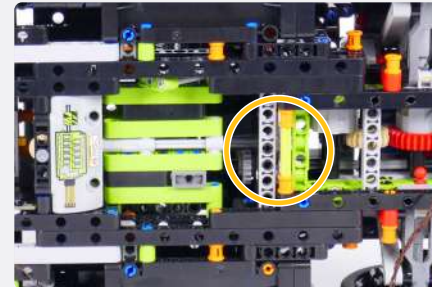
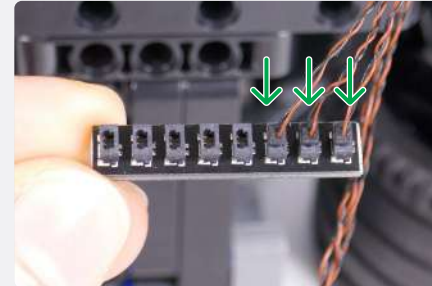

18

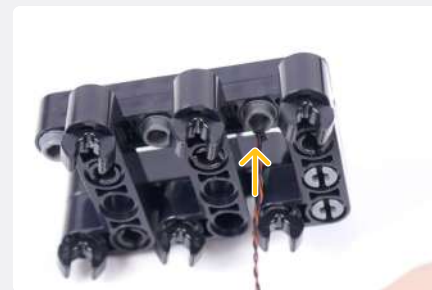
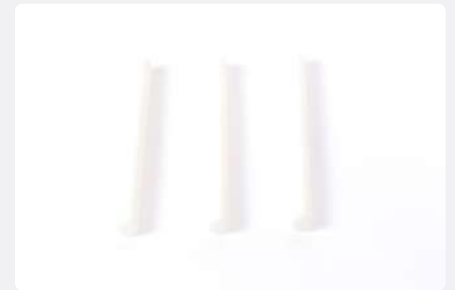
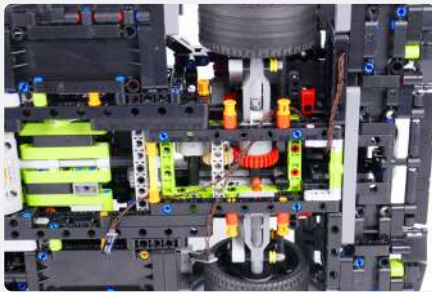
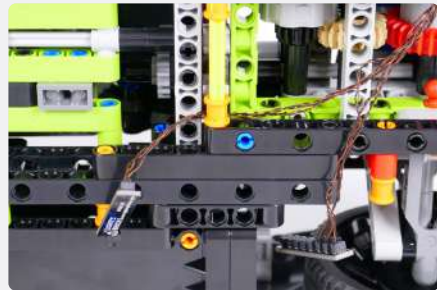
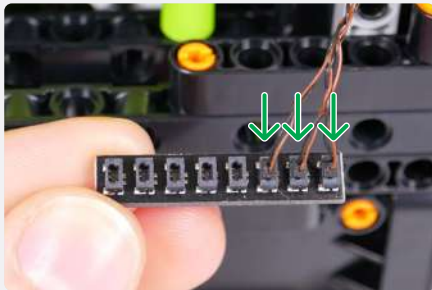

19



Plate, Round 1x1 - Trans-Clear



Cool White 30cm Bit Light



21



Plate, Round 1x1 - Trans-Clear



Cool White 30cm Bit Light



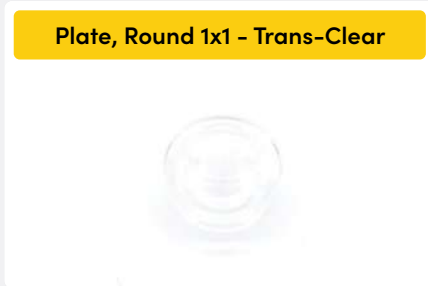
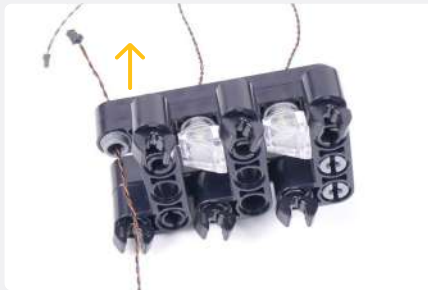

22

Light Bar 4.2cm - Cool White

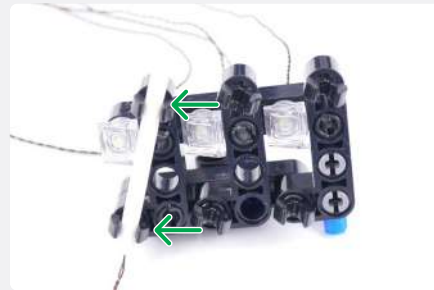

Light Bar 4.2cm - Cool White



23

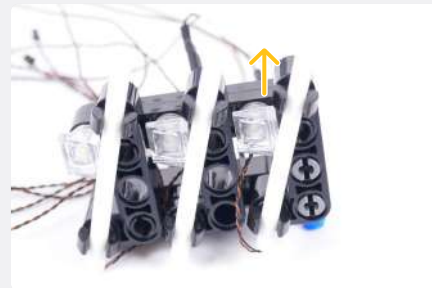
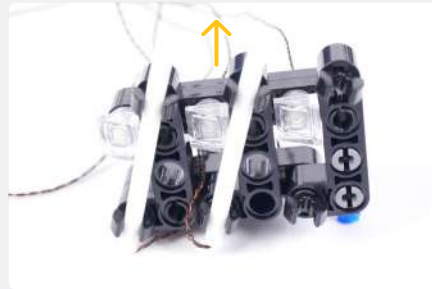

24

Light Bar 4.2cm - Cool White

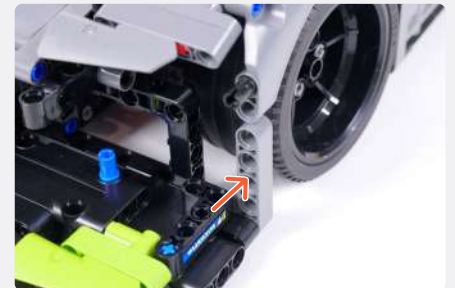
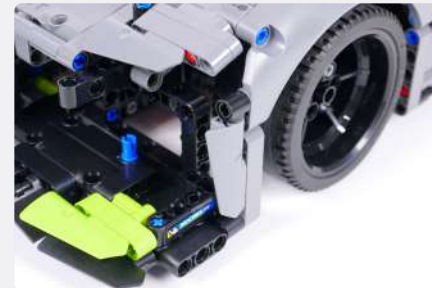
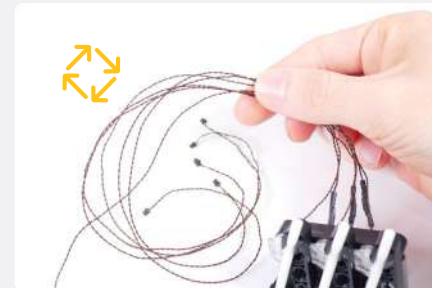
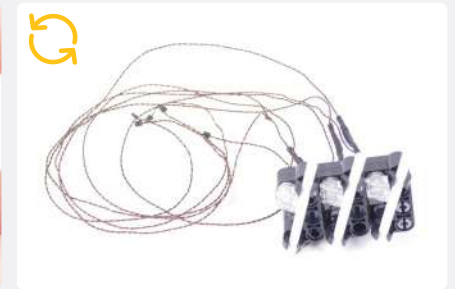

25

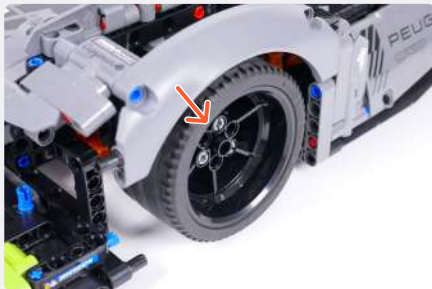

NOTE

Use the wheel to prop up the car in this position.

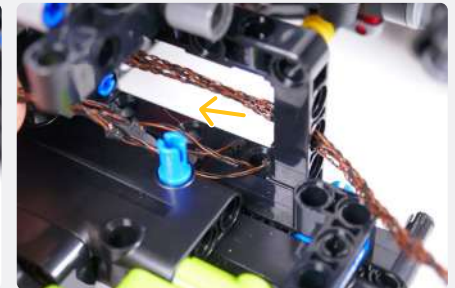
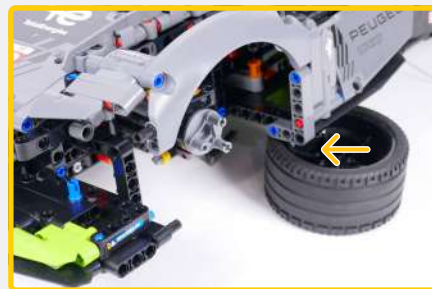

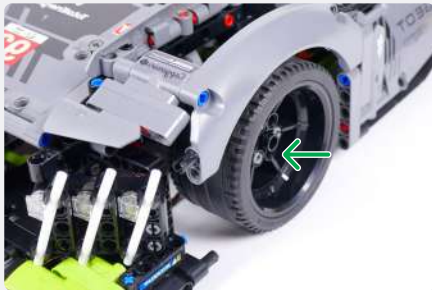

27

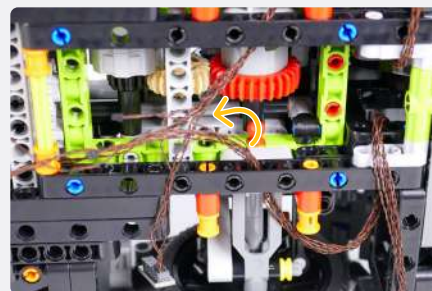
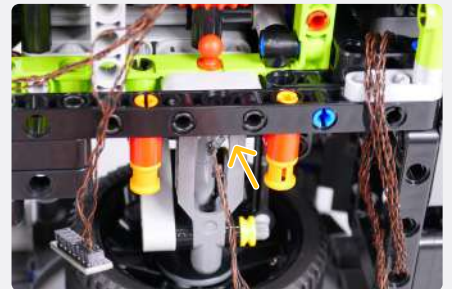
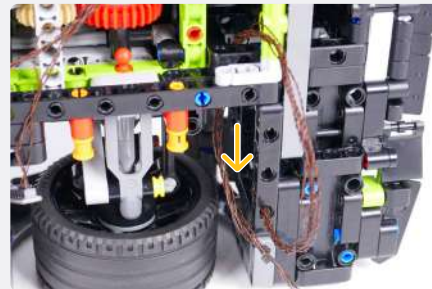
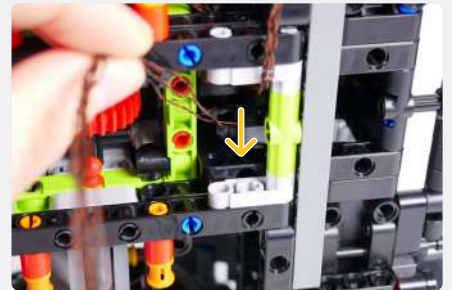
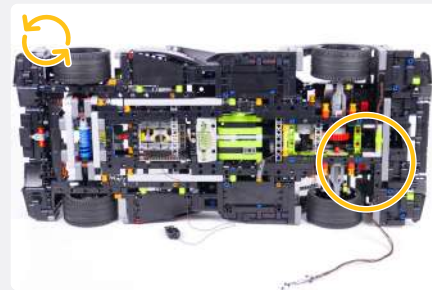

NOTE

Take the 3 shorter cables and connect them to a 8-Port Expansion Board, from Step 17.

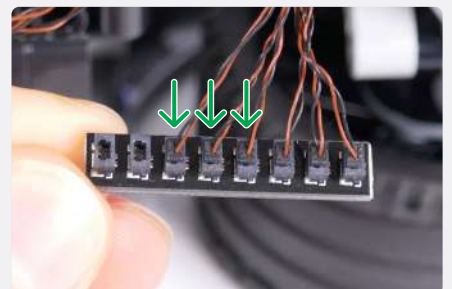
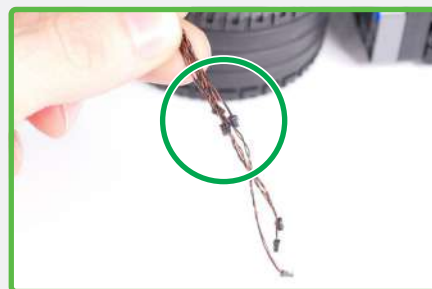

28

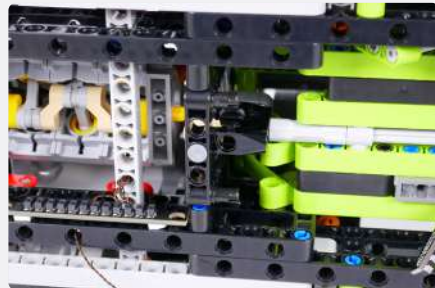
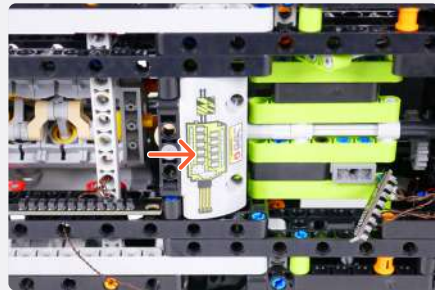
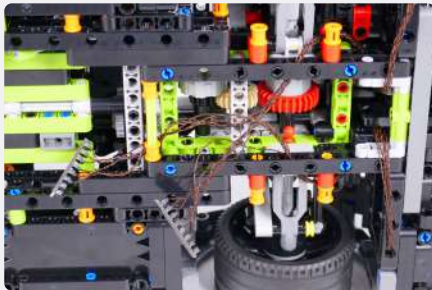
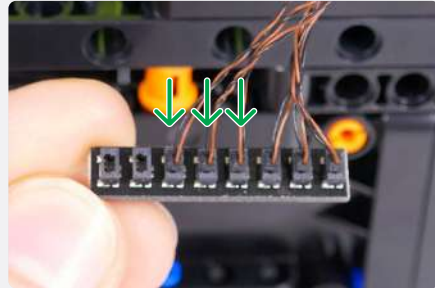
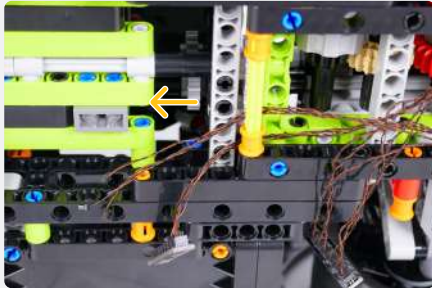
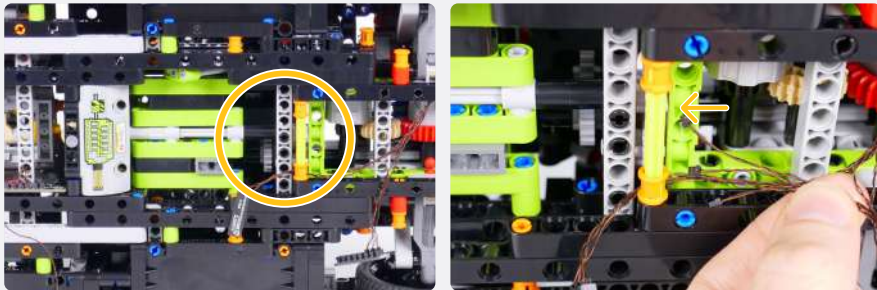

29

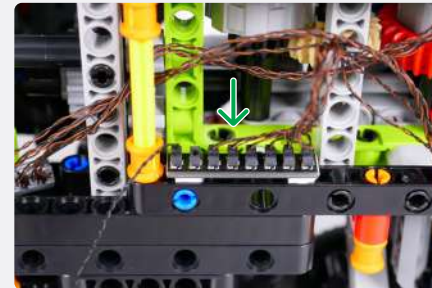
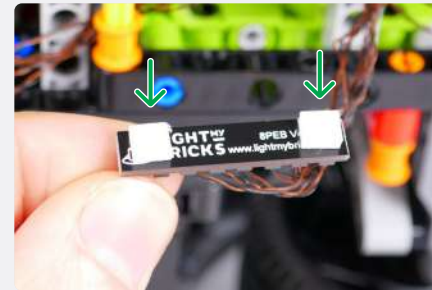
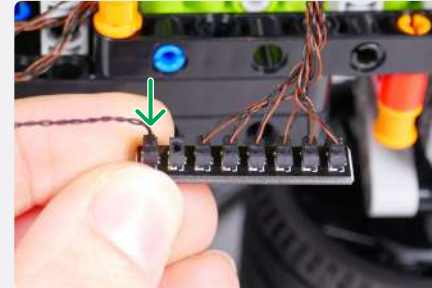
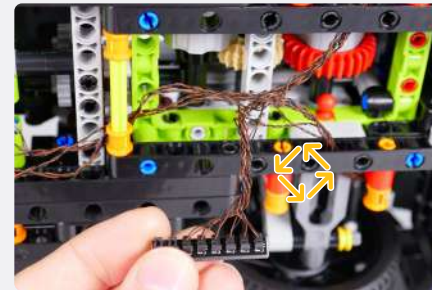

15cm Connecting Cable



2x Adhesive Square

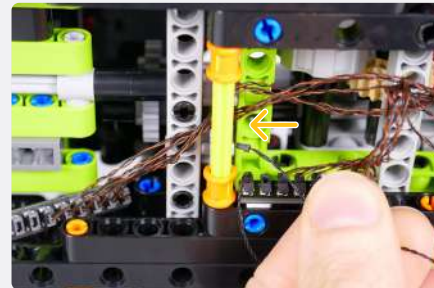
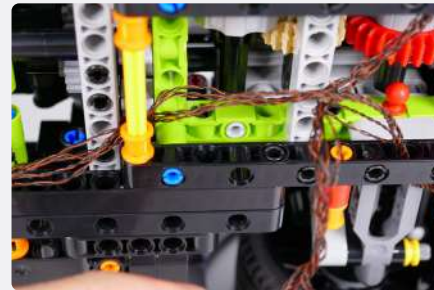

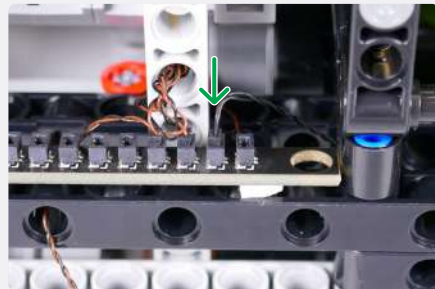
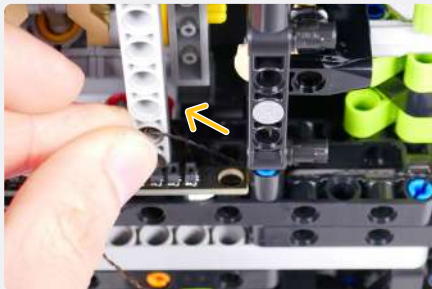

30

5cm Connecting Cable

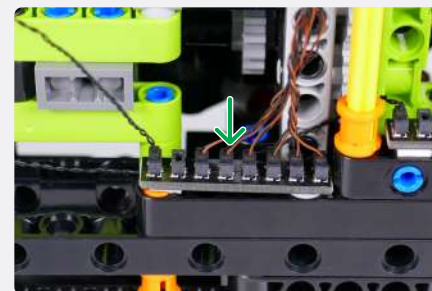
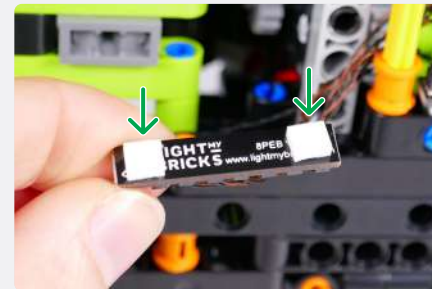
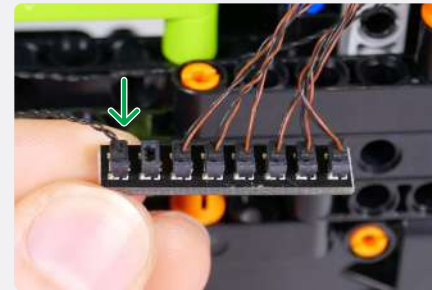

31

Dimmer Control Board



2x Adhesive Square

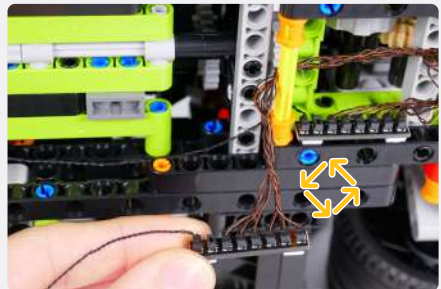

NOTE

Connect the 5cm Connecting Cable from the 8-Port Expansion Board into the "OUT" port of the Dimmer Control Board.

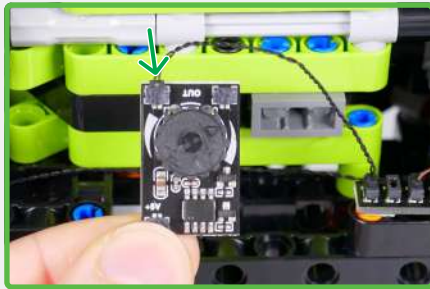

15cm Connecting Cable



NOTE

Connect the 15cm Connecting Cable into the "IN" port of the Dimmer Control Board.

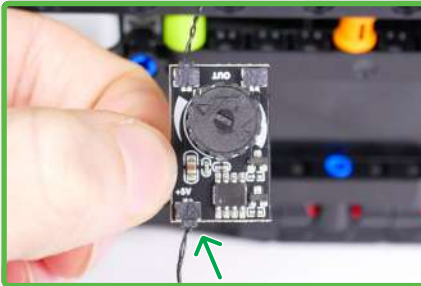

4x Adhesive Square

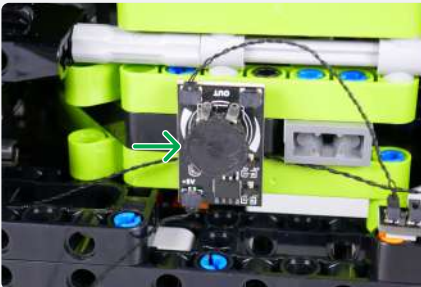
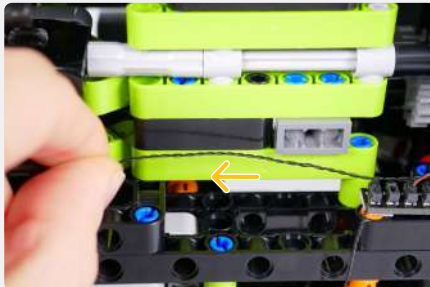
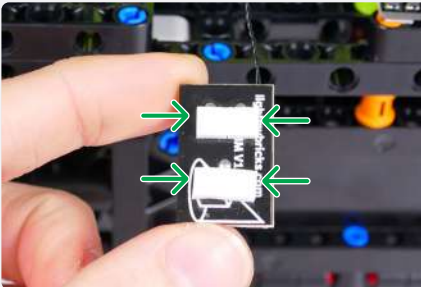

32

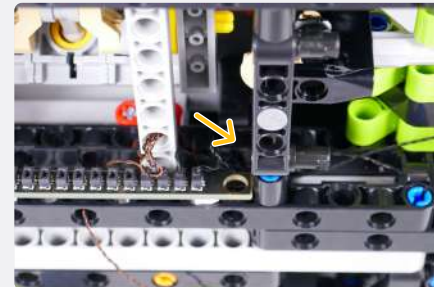
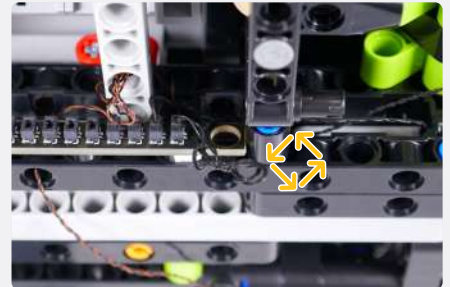
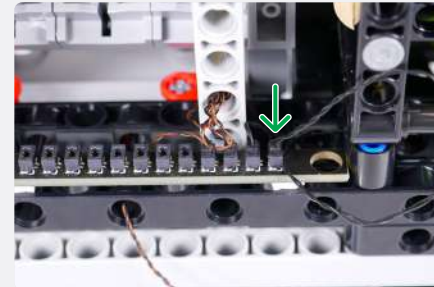
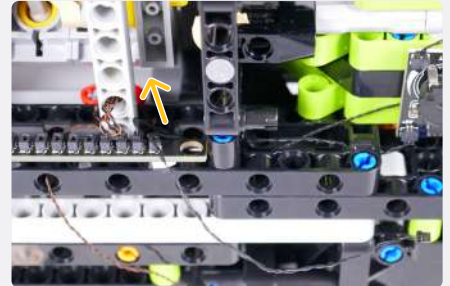
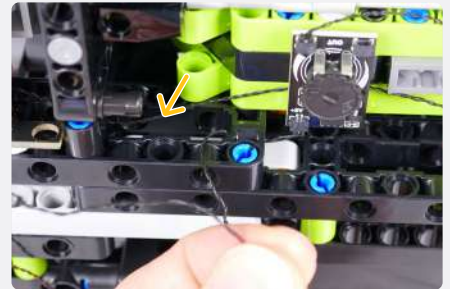

33



34



NOTE

Connect to a 5V USB Power Bank, 5V USB Wall Adaptor, or USB to AA Battery Pack (sold separately)

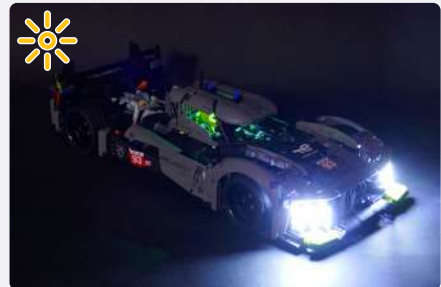

NOTE

Twist the control knob on the Dimmer Control Board to adjust the brightness of the Light Bars.



! If you experience any issues with the lights not working and suspect an issue with a component, please try a different port on the expansion board to verify where the fault lies (with the light or expansion board). To correct any issues with expansion board ports, please view the section addressing expansion board issues in our troubleshooting section. i



35



36

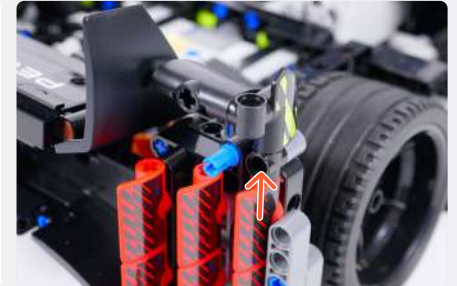



37

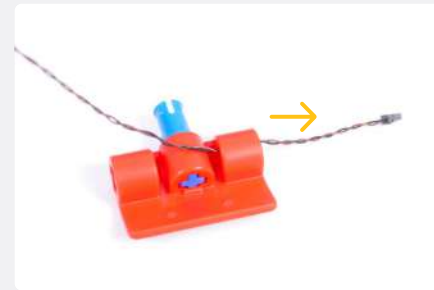
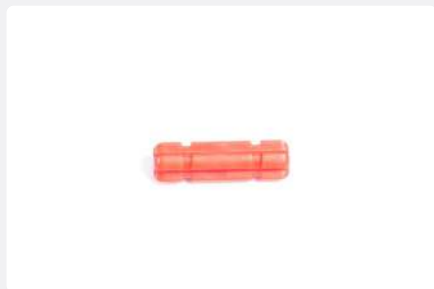

38

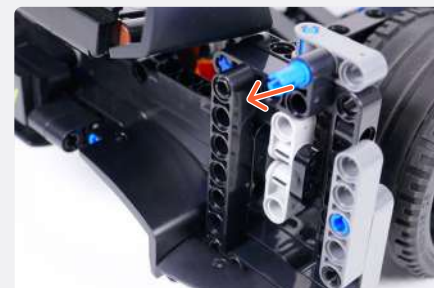

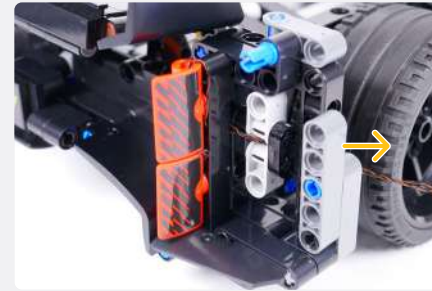
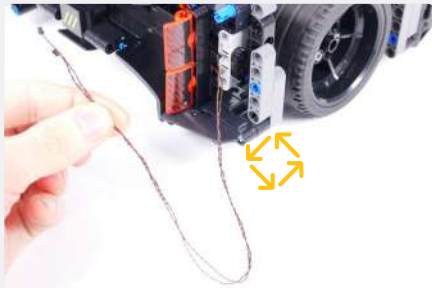
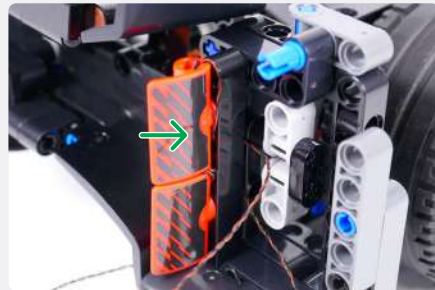
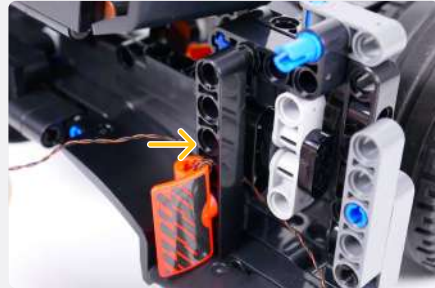
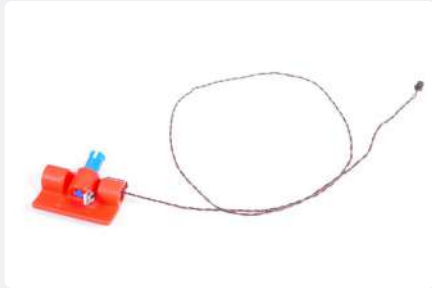

NOTE

Ensure the Large Bit Lights are still positioned as shown, facing down.



39



Red 30cm Large Bit Light

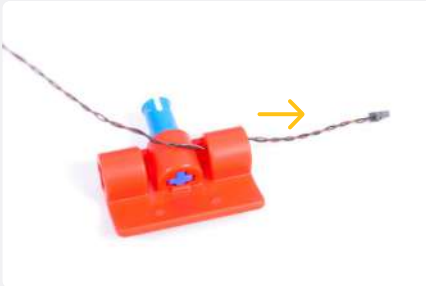

40

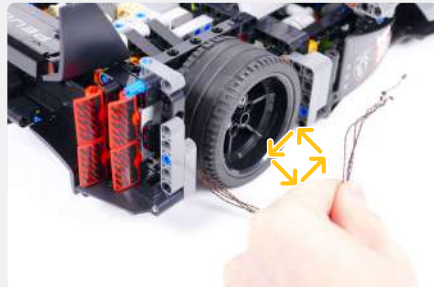
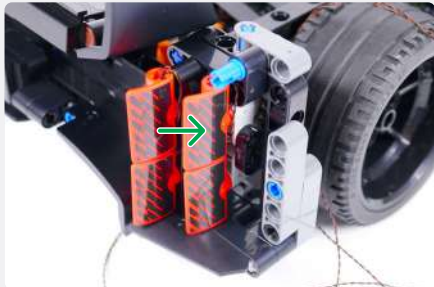
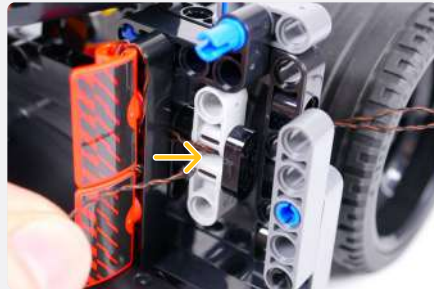

41

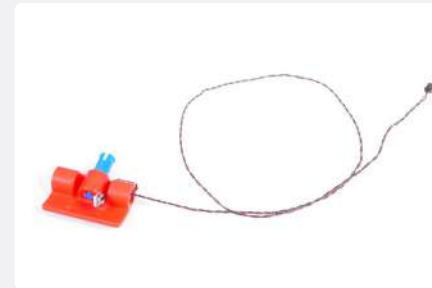
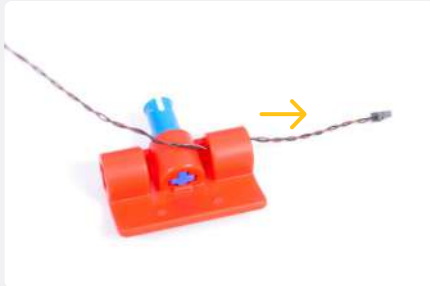

42



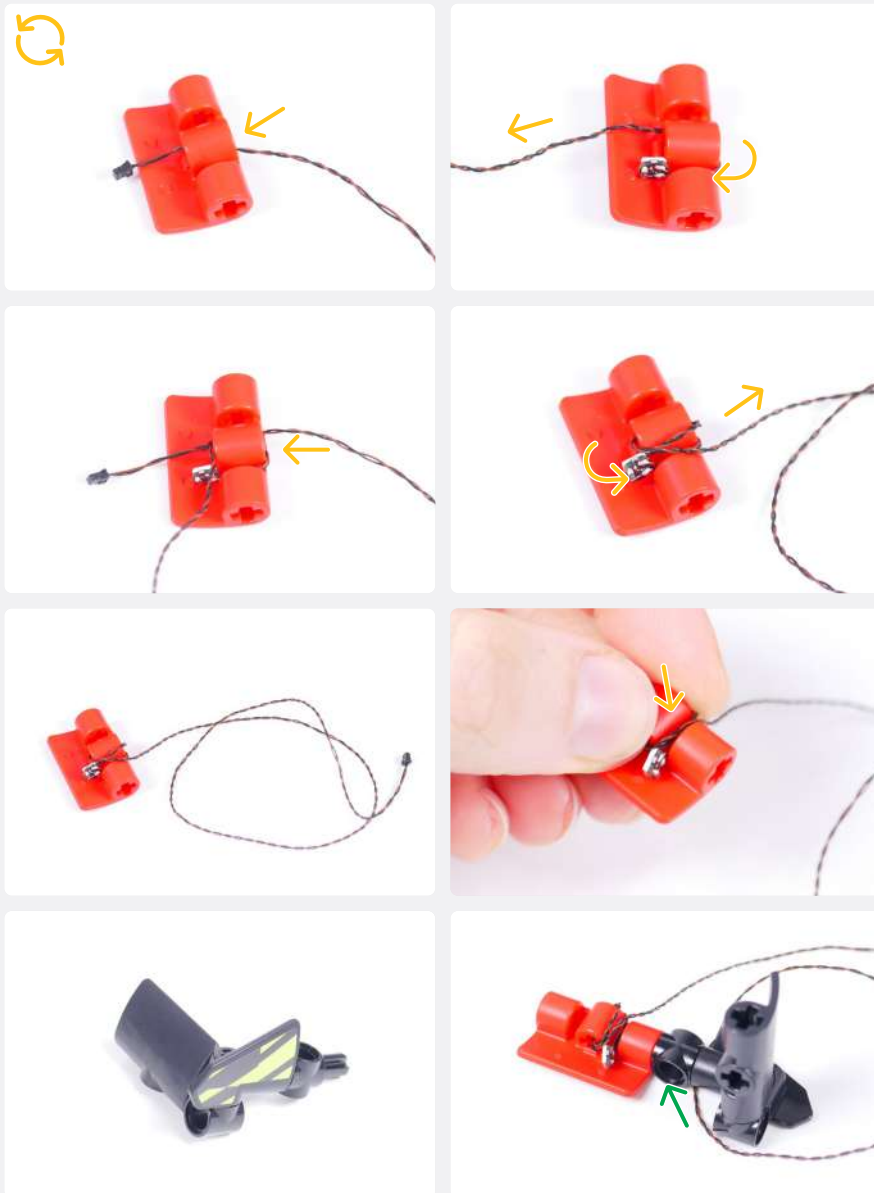

43

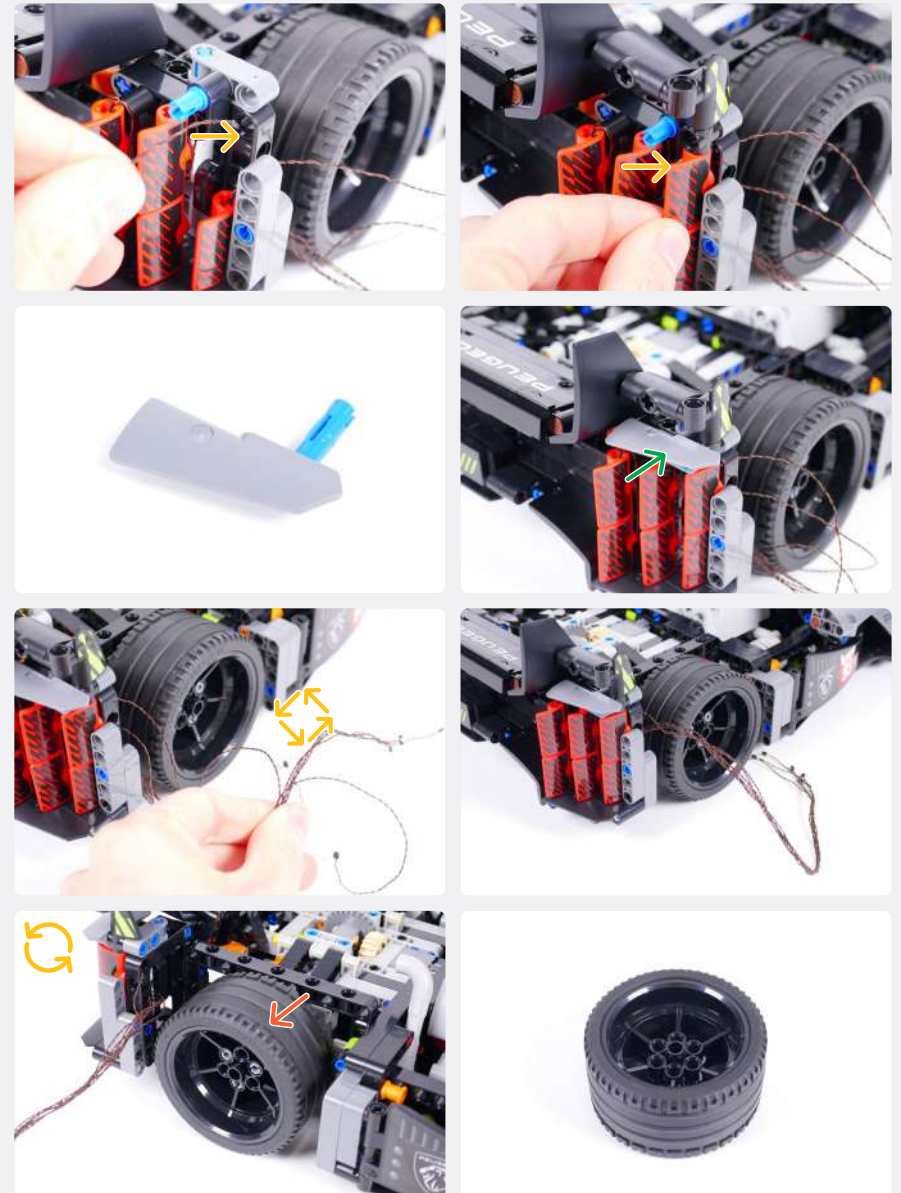

44

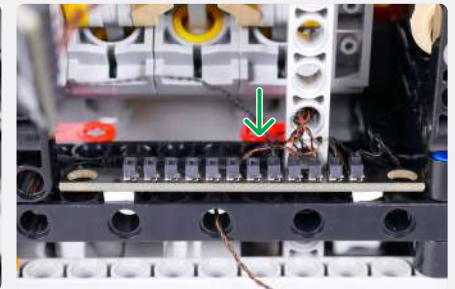
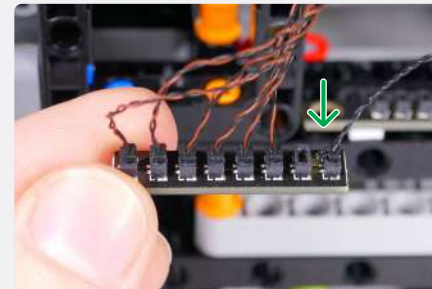
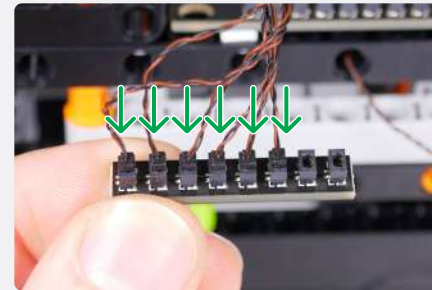
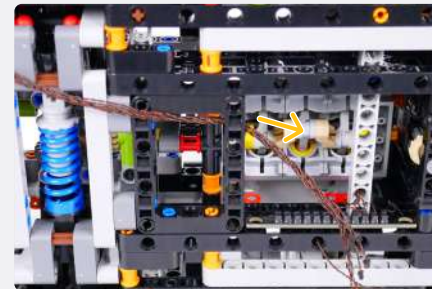
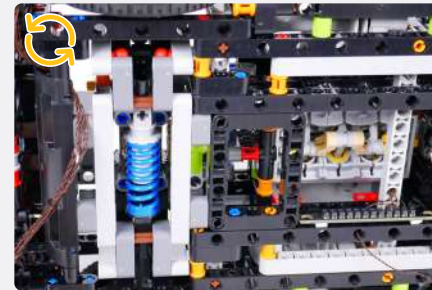
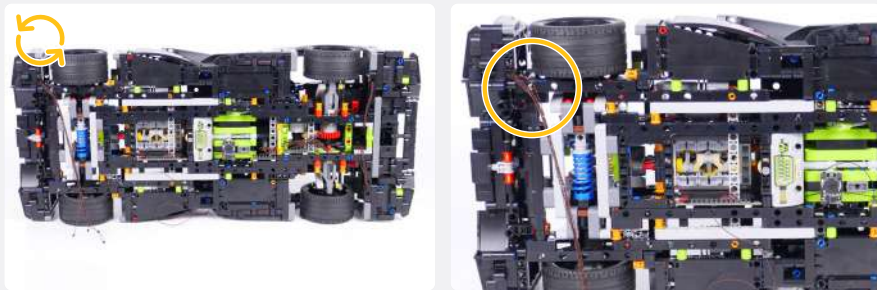
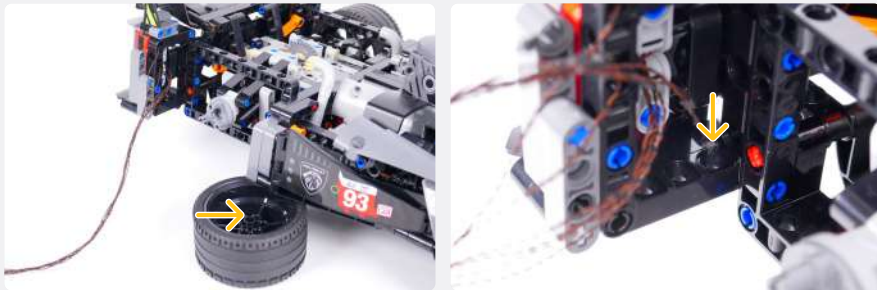

45

46

2x Adhesive Square

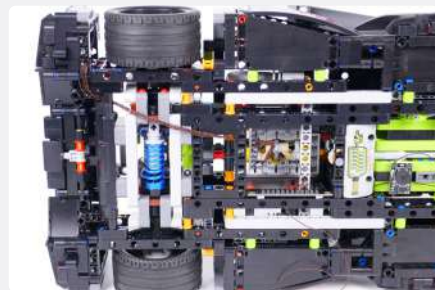
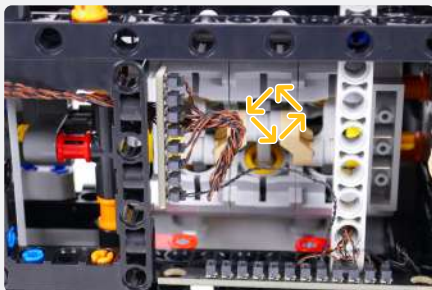
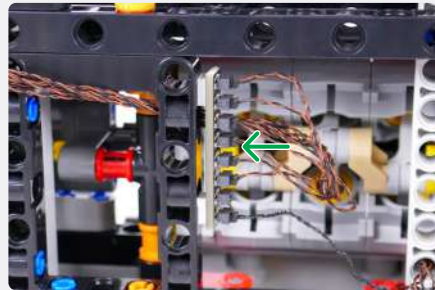
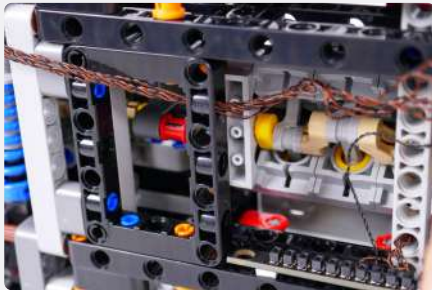
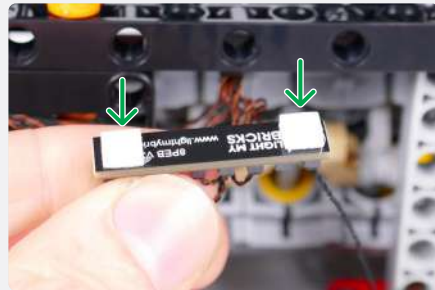

47



48

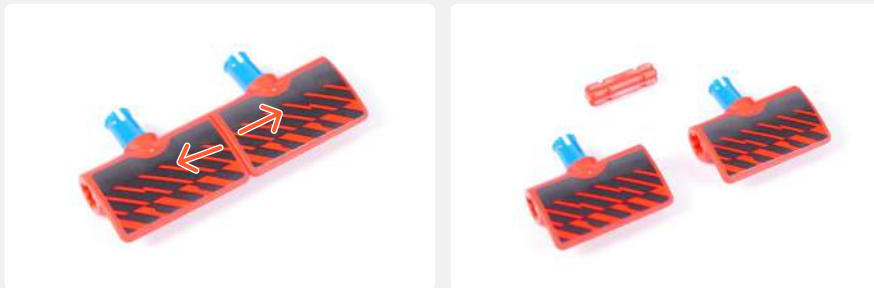

49

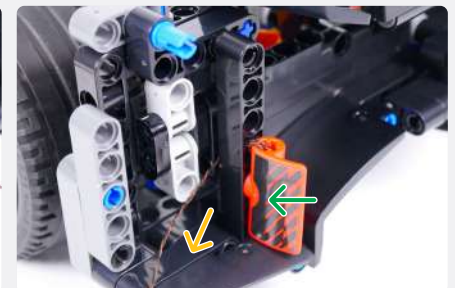
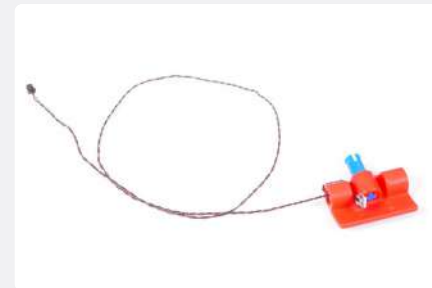

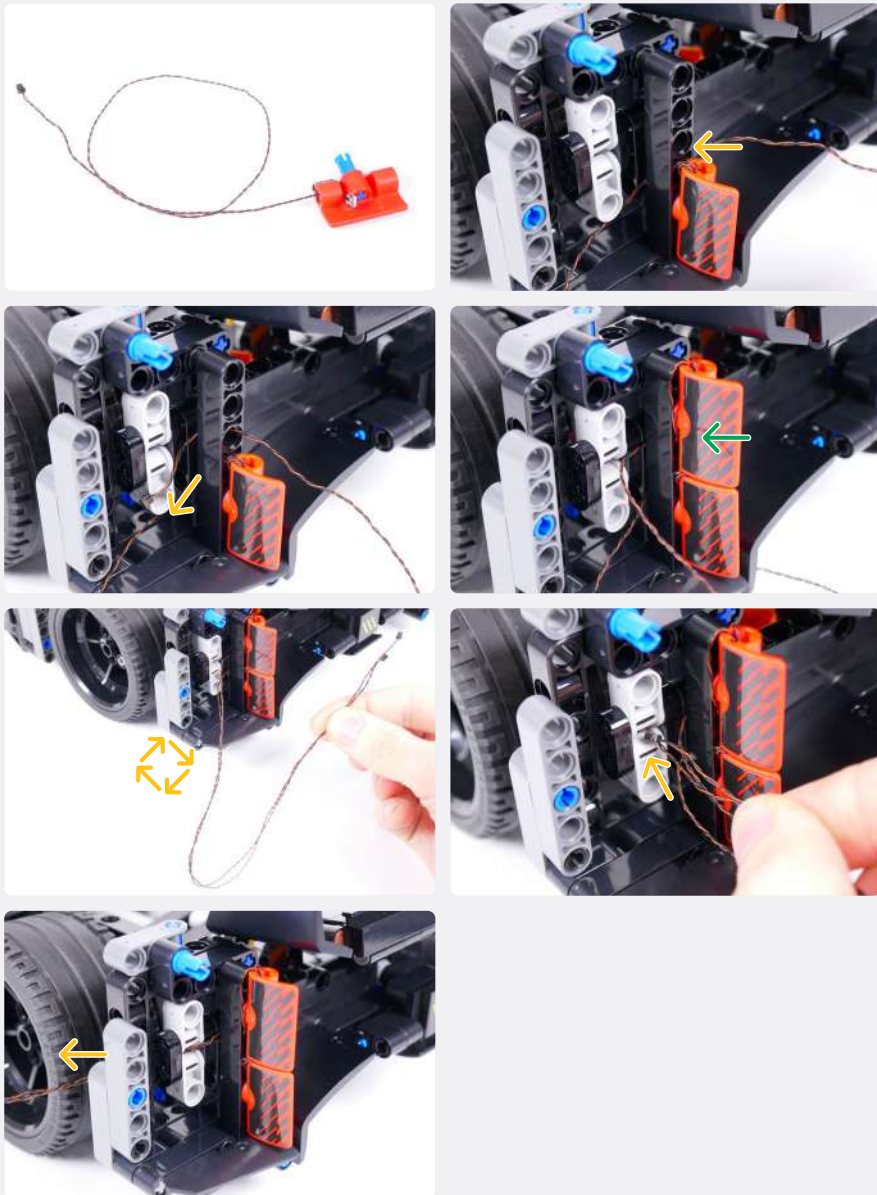

50

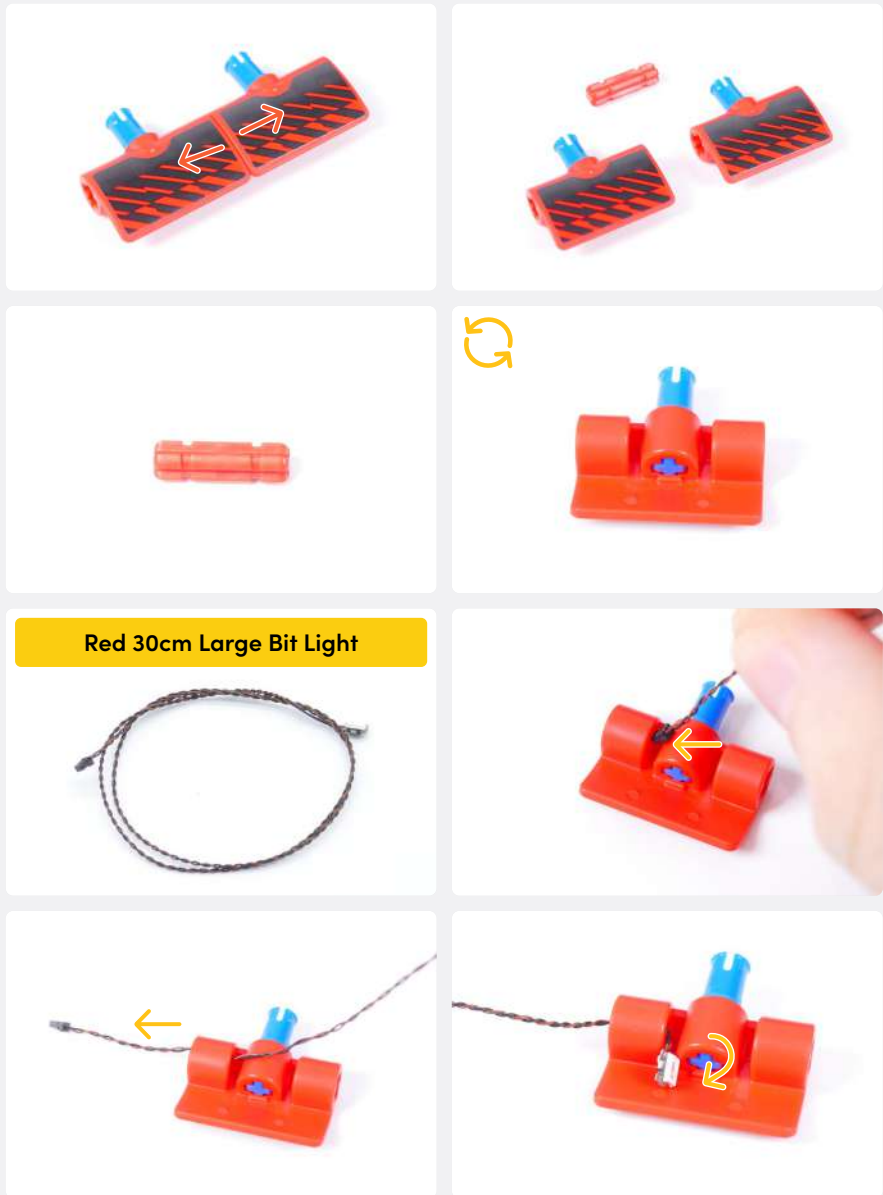

Red 30cm Large Bit Light



51

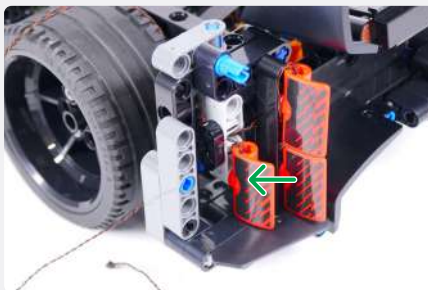

52

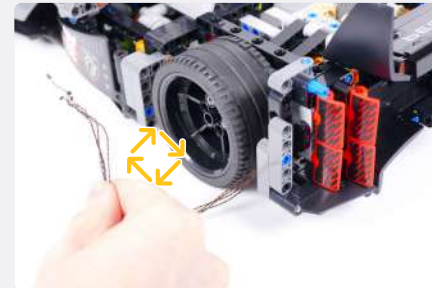
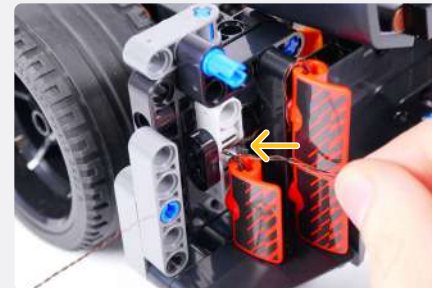

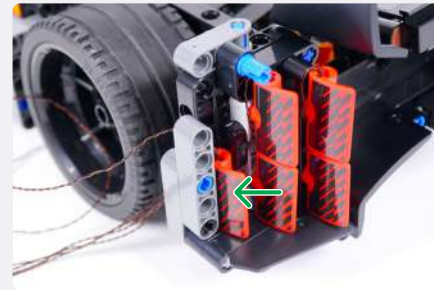
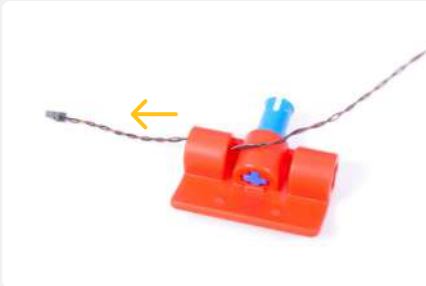

53

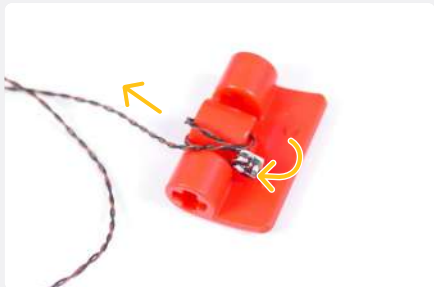
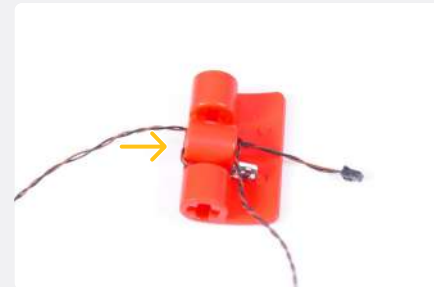
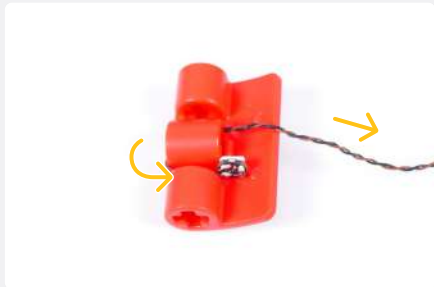



54

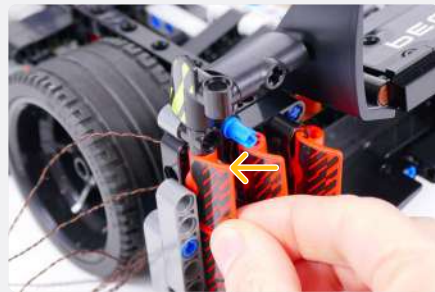

55

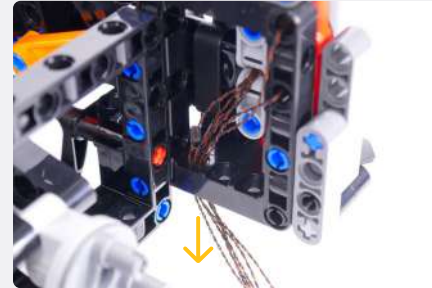
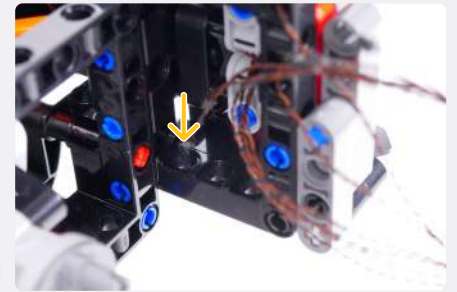
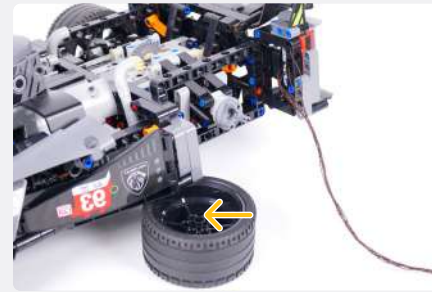
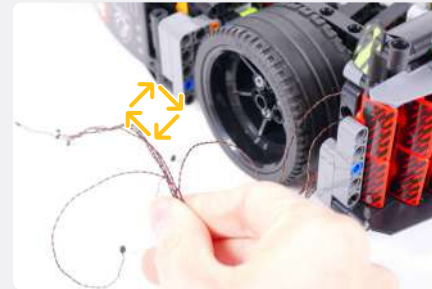

56

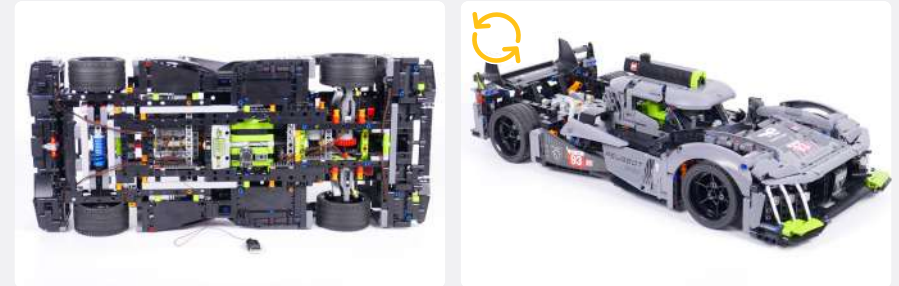
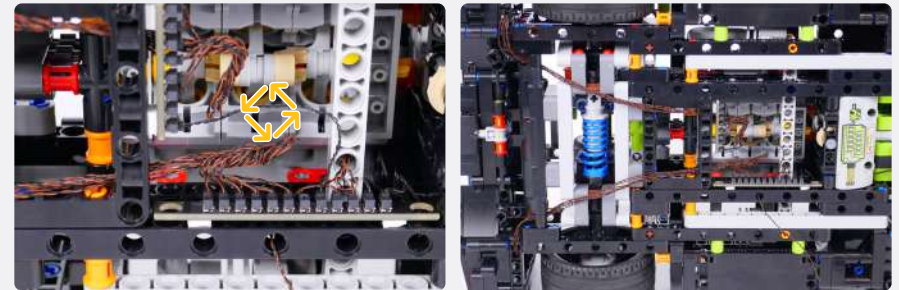
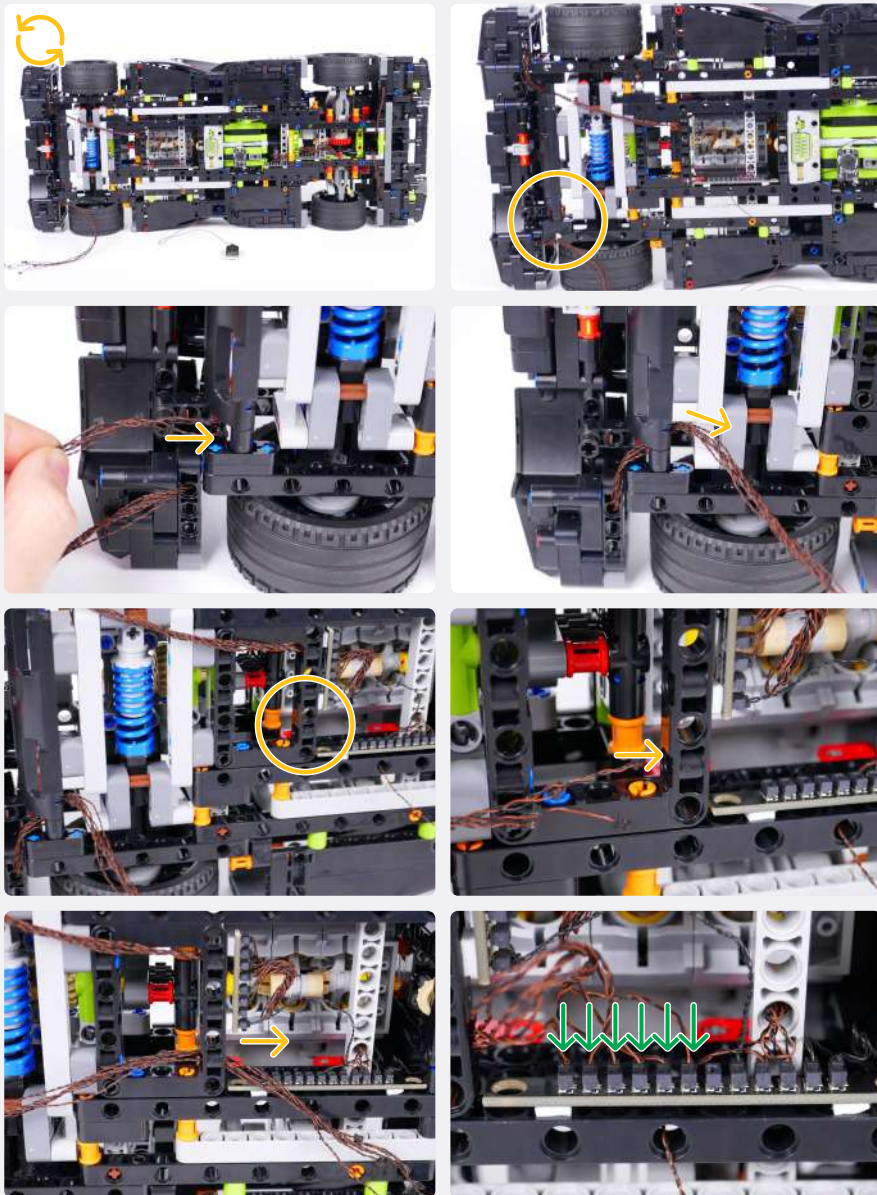

57



NOTE

Connect to a 5V USB Power Bank, 5V USB Wall Adaptor, or USB to AA Battery Pack (sold separately)



! If you experience any issues with the lights not working and suspect an issue with a component, please try a different port on the expansion board to verify where the fault lies (with the light or expansion board). To correct any issues with expansion board ports, please view the section addressing expansion board issues in our troubleshooting section. i

NOTE

You should have these parts left over that were removed from the LEGO set



FINAL PRODUCT

This finally completes installation of the Light My Bricks

LEGO® Peugeot 9X8 24H Le Mans Hybrid Hypercar 42156 Light Kit.

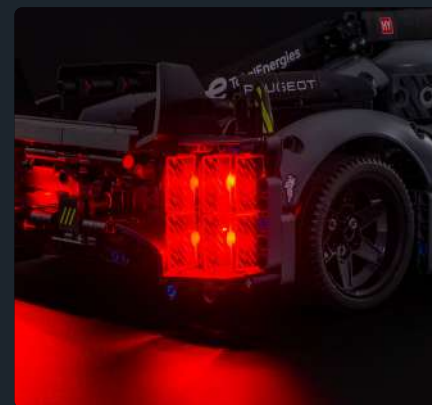



TROUBLESHOOTING

Light My Bricks lighting kits contain individual components that are very small and can be easily damaged if not handled correctly.

To prevent unnecessary damage to components, we highly recommend that the User Guide section, **“Important things to note”** is read carefully. Follow the handling procedures in the User Guide to help prevent faults and damages to your Light My Bricks components.

If you are experiencing issues with your Light My Bricks set, watch our troubleshooting video [here](#) or read on for a list of common causes to help you troubleshoot.

Troubleshooting

Firstly, ensure that the batteries have power using a battery charge gauge.

If the batteries have no power, replace the batteries.

If the batteries still have power, check to see if the batteries have been inserted correctly into the battery pack.

Check for AA batteries using the AA battery pack

Inside the battery pack are symbols indicating which direction the AA battery should be inserted. The flat side of the battery should be paired with the spring side of the battery pack.

If the batteries have been installed correctly and your kit still isn't operating correctly, the next step is to check the wiring.

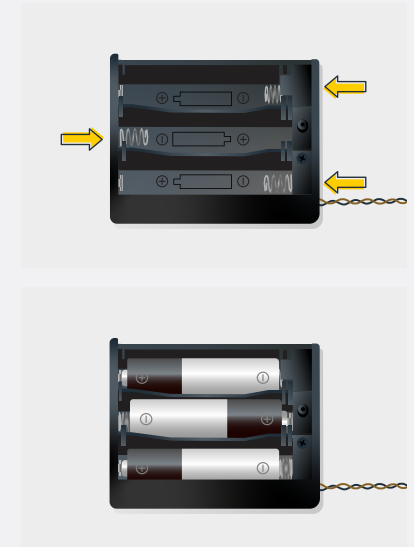

Troubleshooting

Check Your Wires

In order for Light My Bricks components to fit in between and underneath LEGO® bricks, the components need to be very small. Due to this nature, Light My Bricks components can be easily damaged when not handled correctly.

Be careful when removing unpacked components out of the packaging and ensure not to forcibly pull at the wires as this can damage the soldering that attach the wires to the LEDs.

If the wiring is detached from the LED itself, the light will not operate.

When connecting lights to your LEGO® set, check that there are no pinched wires underneath or in between bricks and plates. When the wires are pinched and the exposed wires are touching each other, this can cause a crosswire and the lights to not function correctly.

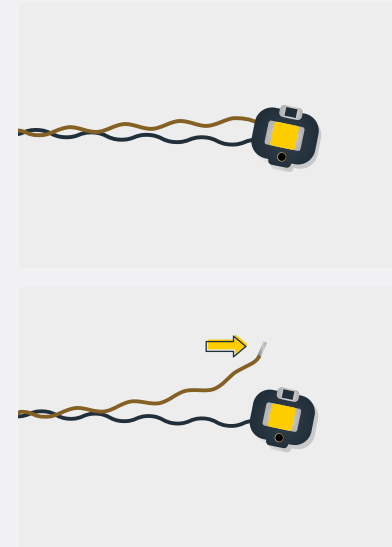

Troubleshooting

Check Your Expansion Board Ports/ Strip Light Ports / Effects Board Ports

It is important to note that connectors can only be inserted to the expansion board, strip light, or effects board ports in one direction.

Forcibly inserting connectors in the incorrect direction will result in damaging the pins inside each of the ports on your component board.

Not only will a light connected to the damaged port not work, but if the pins inside the port are bent to a point they are touching each other, this can result in all other lights in the system to stop working. This is a short circuit.

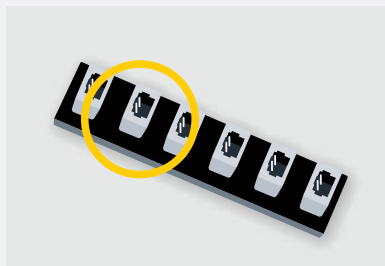

A short circuit can also result in overheating of the board, cable or batteries. If you suspect a short circuit, **DISCONNECT POWER IMMEDIATELY**. Batteries can fail, catch fire, or even explode if left connected to a short circuit for too long.

If you suspect you have a faulty component due to a bent pin, try the following steps:

If you look carefully inside each of the ports, each port contains 2 small pins that should be straight. You will be able to identify a faulty port if it has any bent pins.

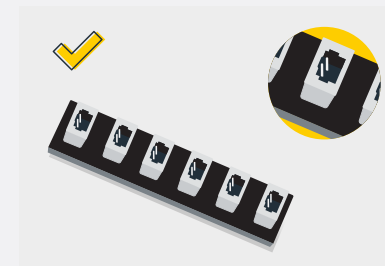
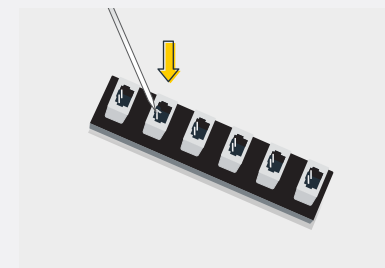



CONTACT US

If you have an enquiry regarding the online shop, our products or a general enquiry please refer to our Frequently Asked Questions webpage here.

Alternatively, you can contact our Customer Services team by visiting our online support portal here.

support.lightmybricks.com

We thank you for purchasing this product and hope you enjoy!



lightmybricks.com