



**LIGHT^{MY}
BRICKS**



**LEGO[®] HARRY POTTER HOGWARTS
EXPRESS & HOGSMEADE STATION
76423 LIGHT KIT
INSTALLATION GUIDE**

Light My Bricks



LEGO® HARRY POTTER HOGWARTS EXPRESS & HOGSMEADE STATION 76423 INSTALLATION GUIDE

Hi There!

We're here to help you get started on the LEGO®

Harry Potter Hogwarts Express & Hogsmeade Station 76423
Light Kit.

This PDF details the instructions for the LED light kit only. If
you are wishing to purchase this product, please [click here](#)
to view the product page.

If you run into any issues, please refer to the troubleshooting
section towards the end of this guide.

Have fun and enjoy!





PACKAGE CONTENTS:

Individual Bags



- 6x White 30cm Bit Light
- 2x Yellow 30cm Bit Light
- 3x Orange 30cm Bit Light

Mixed Components 1



- 2x 6-Port Expansion Board
- 1x 8-Port Expansion Board
- 7x Adhesive Square

Connecting Cables



- 1x 30cm Connecting Cable
- 1x 50cm Connecting Cable

USB Power Cable



- 1x USB Power Cable
(Power Source not Included)

Mixed Components 2



- 1x Plate, Round 1x1 - Trans Yellow
- 1x Plate, Round 1x1 - Trans Clear
- 1x Brick, Round 1x1 - Trans Clear
- 1x Bracket 1x1 - 1x1 Inverted - Black
- 1x Bracket 1x2 - 1x2 - Black
- 2x Plate 1x2 - Black
- 2x Plate, Round 2x2 with Rounded Bottom (Boat Stud) - Trans-Clear
- 1x Plate, Modified 1x2 with 1 Stud with Groove and Bottom Stud
- Holder (Jumper) - Black

Contents

Before You Begin	5
Blueprint	10
Instructions	11
Final Product	51
Troubleshooting	52
Contact	56

Before You Begin



Laying cables in between and underneath bricks

Cables can fit in between and underneath LEGO® bricks, plates, and tiles providing they are laid correctly between the LEGO® studs. Do NOT forcefully join LEGO® together around cables; instead ensure they are laying comfortably in between each stud.

CAUTION: Forcing LEGO® to connect over a cable can result in damaging the cable and light.

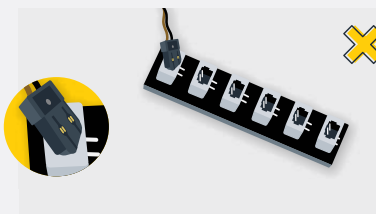
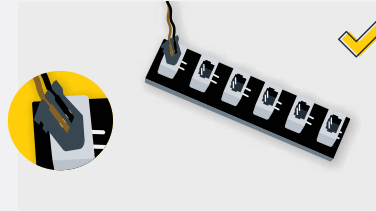

Connecting Cable Connectors To Expansion Boards

Take extra care when inserting connectors to ports of Expansion Boards. Connectors can be inserted only one way. With the expansion board facing up, look for the soldered “=” symbol on the left side of the port. The connector side with the wires exposed should be facing toward the soldered “=” symbol as you insert into the port. If a plug won’t fit easily into a port connector, do not force it.

Incorrectly inserting the connector can result in bent pins inside the port or possible overheating of the expansion board when connected.

Before You Begin



Connecting Cable Connectors To Strip Lights

Take extra care when inserting connectors to ports on the Strip Lights. Connectors can be inserted only one way. With the Strip Light facing up, ensure the side of the connector with the wires exposed is facing down. If a plug won't fit easily into a port connector, don't force it. Doing so will damage the plug and the connector.

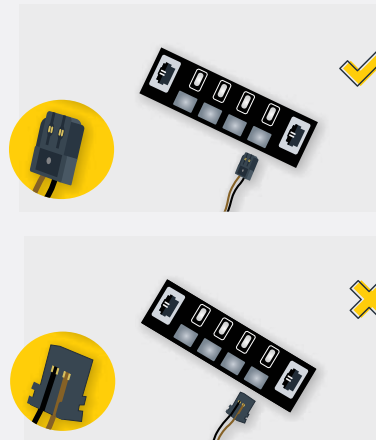

Connecting Micro Cable Connectors To Micro Expansion Board Ports

Take extra care when inserting the micro connectors to micro ports of Micro Expansion Boards. Connecting Micro Bit Lights to Micro Expansion Boards is similar to connecting lights and cables to Strip Lights. With the expansion board facing up, ensure the side of the connector with the wires exposed is facing down. If a plug won't fit easily into a port connector, do not force it. Use your fingernail to push the plastic part of the connector to the micro port.

Before You Begin

Installing Bit Lights Under Lego® Bricks And Plates

When installing Bit Lights under LEGO® pieces, ensure they are placed the correct way up (Yellow LED component exposed). You can either place them directly on top of LEGO® studs or in between.

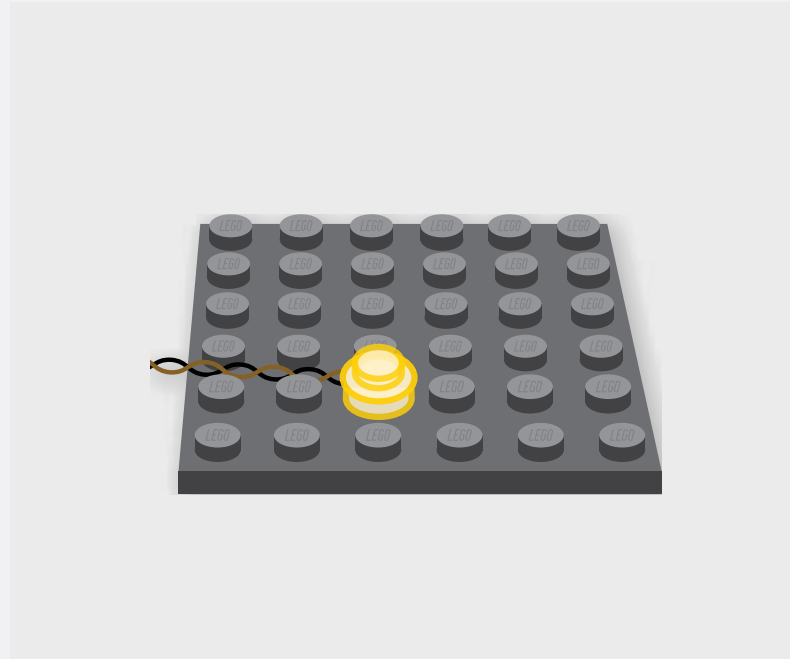

Before You Begin

The Symbols Used In This Guide

When going through the following guide you will come across symbols and formats that will assist with the installation of your light kit. Take notice of them as each has a specific purpose.

Light Kit Component

This is the most important image format as it indicates which part to use from the Light Kit. Make sure you pay close attention to which part is shown.

White 30cm Bit Light



Connect

Used when you need to connect a LEGO piece or LMB component.



Disconnect

Used when you need to remove a LEGO piece/ section or LMB component.



Directional

Used to show where to route cables, place components, or move them.



Bend/Pivot

Used when a component needs to be bent, or part folded or pivoted.



Turn/ Flip

Will be found in the top left corner when the set needs to be rotated or flipped.



Twist/ Braid

Seen when a set of cables need to be grouped and twisted together.



Power On Test

Found at the end of a major step to test the lights. Will be located in the top left corner.



Note

Notes will be found alongside the instruction photos and explain what to do.



Before You Begin

Repeat Step

Repeat the previous step eg. Make a spotlight, then make a second spotlight.

x2

Connect Focus

Used to highlight a hard to see area where a component is being connected.



Disconnect Focus

Used to highlight a hard to see area where a component is being disconnected.



General Focus

Used to highlight a hard to see area where a component needs to be acted on.



General Note

This is a sample note that is used anywhere in this guide. It will explain a difficult section where photos are hard to illustrate or easily confused.

Connect Note

The green coloured note is used when the topic focuses on a component being connected, like the shown Power Bank.

Disconnect Note

The red coloured note is used when the topic focuses on a component being disconnected or like here, the removed pieces.



NOTE

Take the 5cm Connecting Cable from the 4-Port Micro Expansion Board and route it into the "IN" port of the Flicker Effects Board

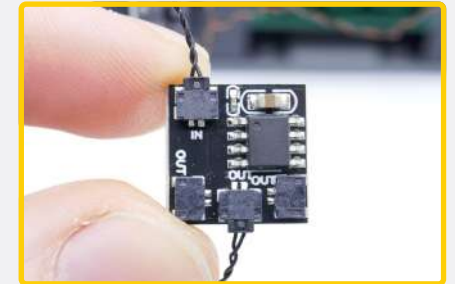



NOTE

Connect to a 5V USB Power Bank, 5V USB Wall Adaptor, or USB to AA Battery Pack (sold separately)





NOTE

You should have these parts left over that were removed from the LEGO set





BLUEPRINT

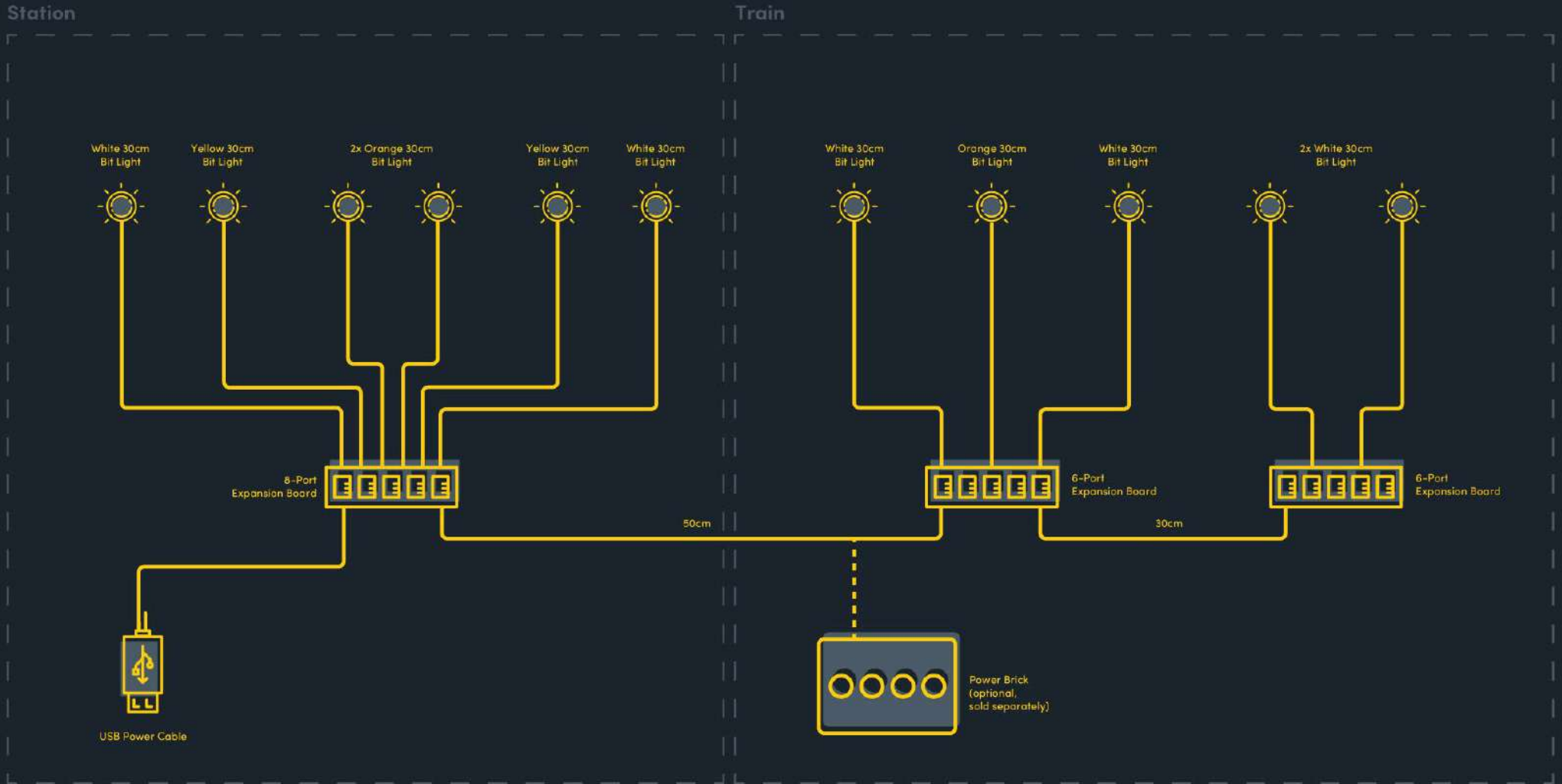



INSTRUCTIONS

To ensure a smooth installation of your light kit, please read and follow each step carefully. If you run into any issues, please refer to the online troubleshooting guide.

1



NOTE

Remove all Minifigures from the set, but leave Hagrid in this position as seen in the LEGO instructions.

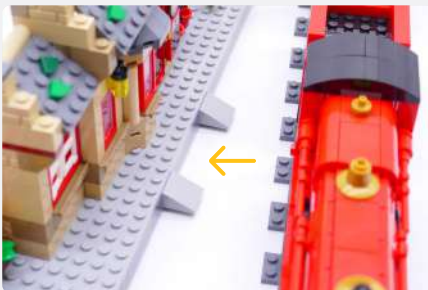
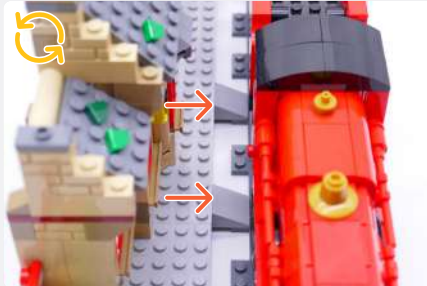

2



3

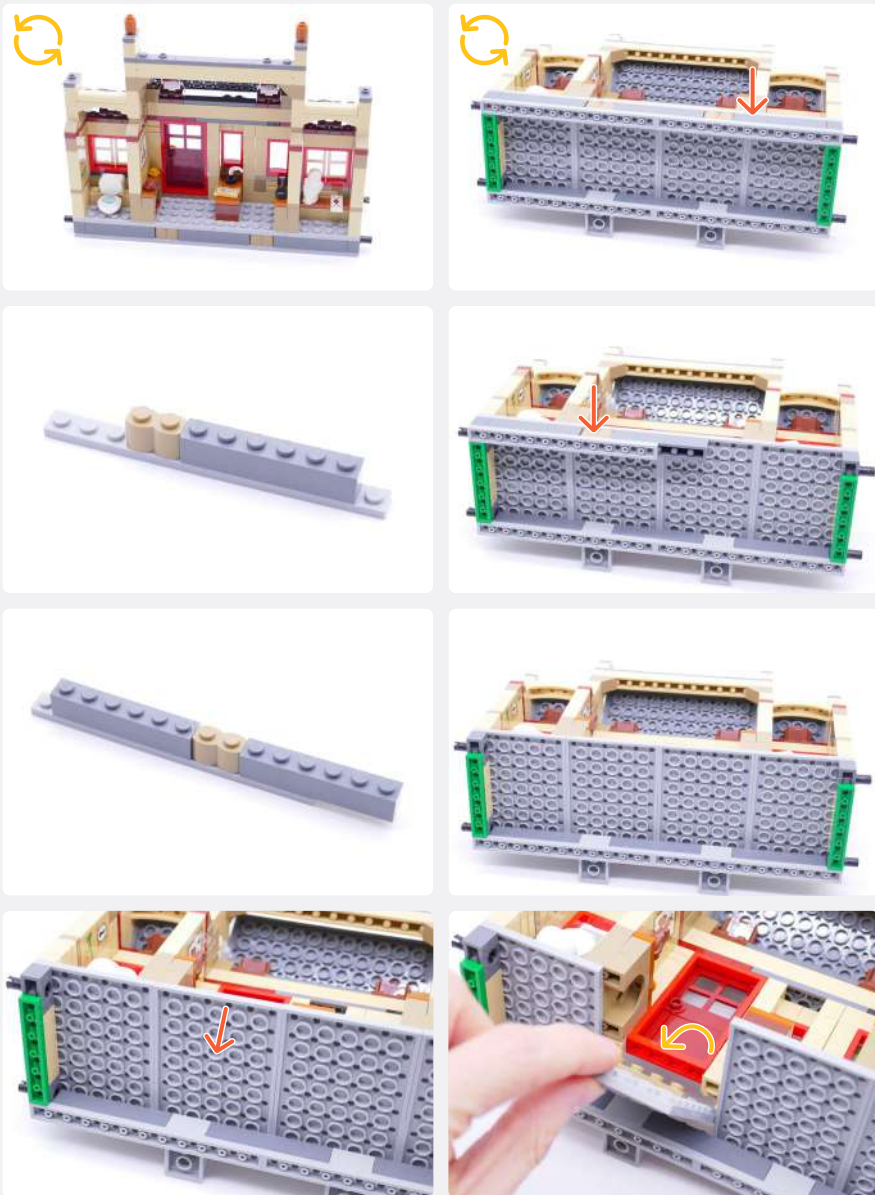

4

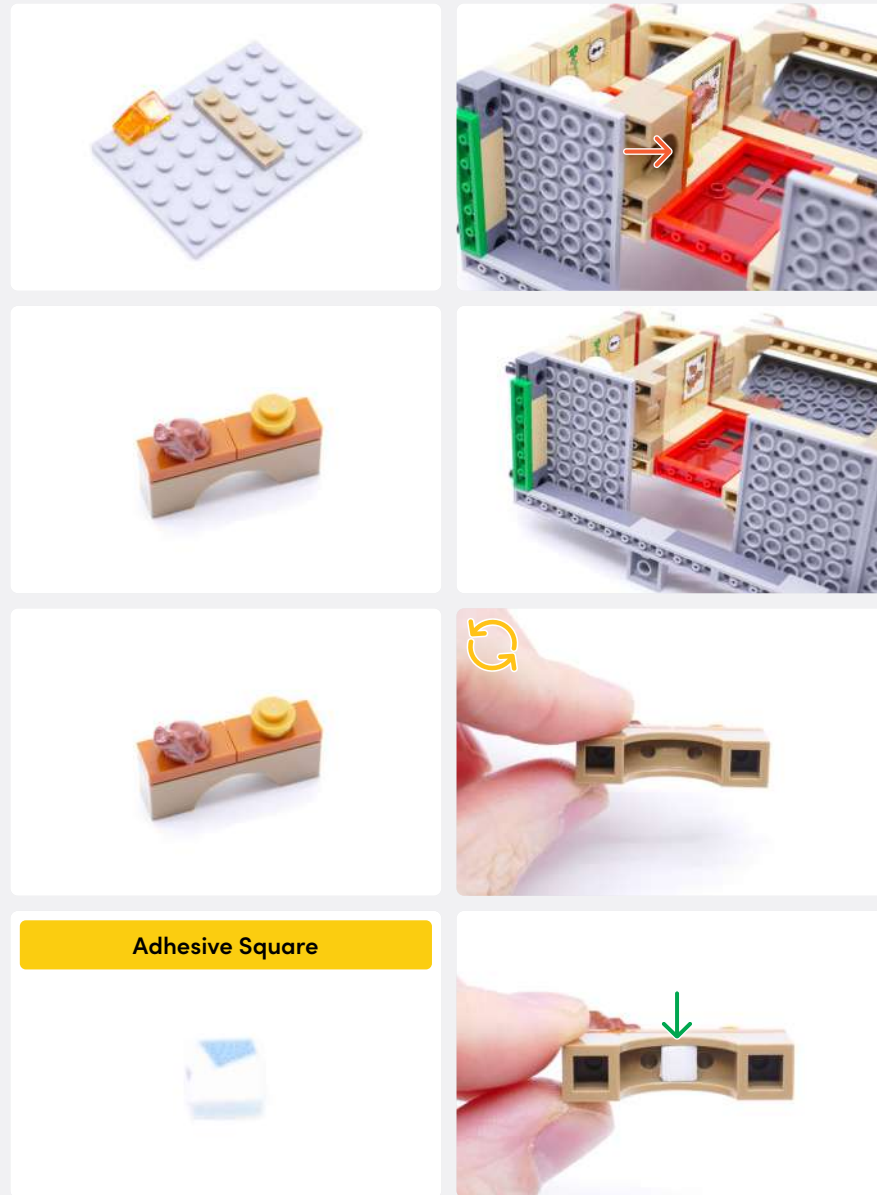

5

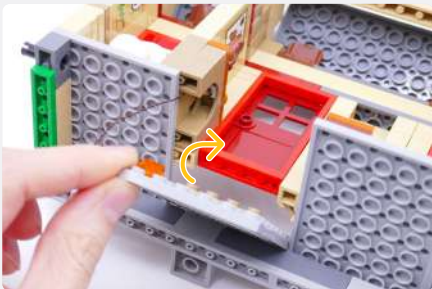
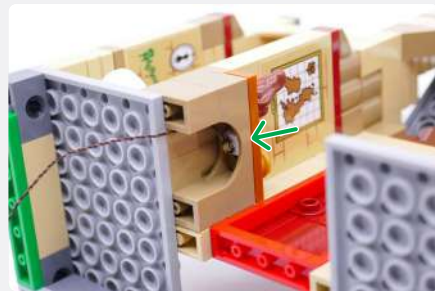
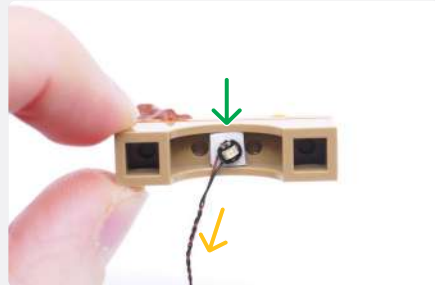

NOTE

Take care when reconnecting the grey plate, by trying not to squish the cable between the plates.

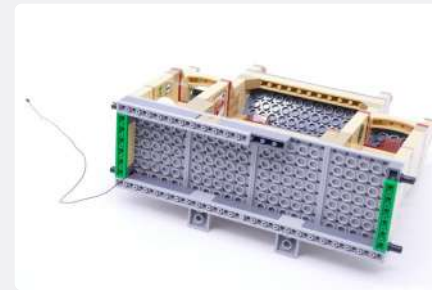
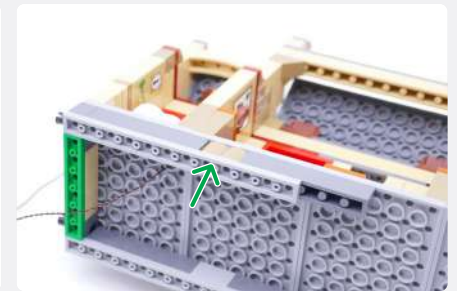
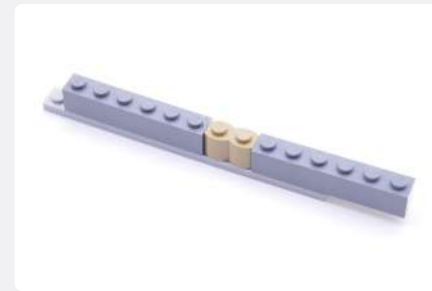
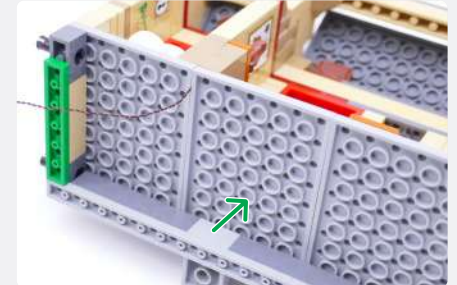

6



NOTE
Partially disconnect the roof of the building where shown, but do not remove it.

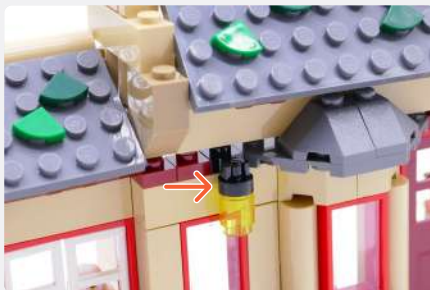

7



Yellow 30cm Bit Light



8

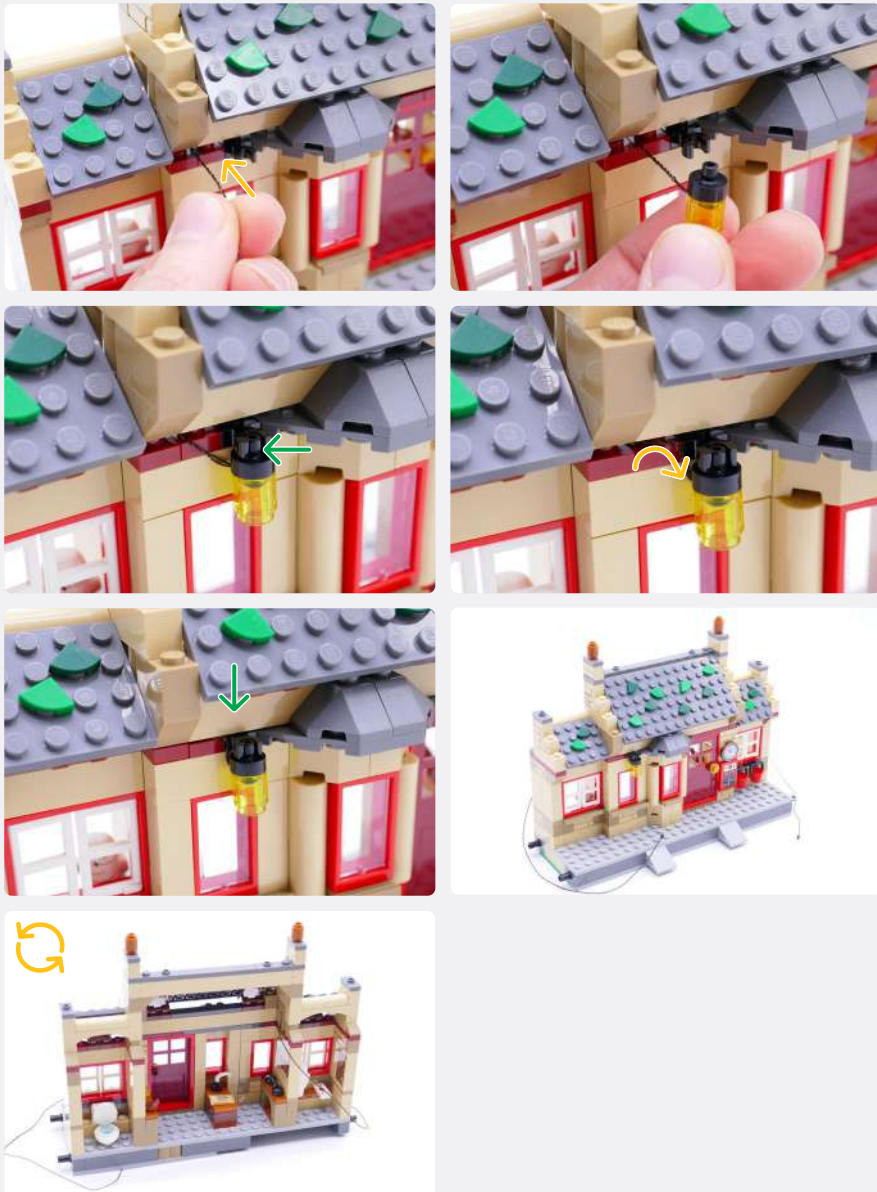

9

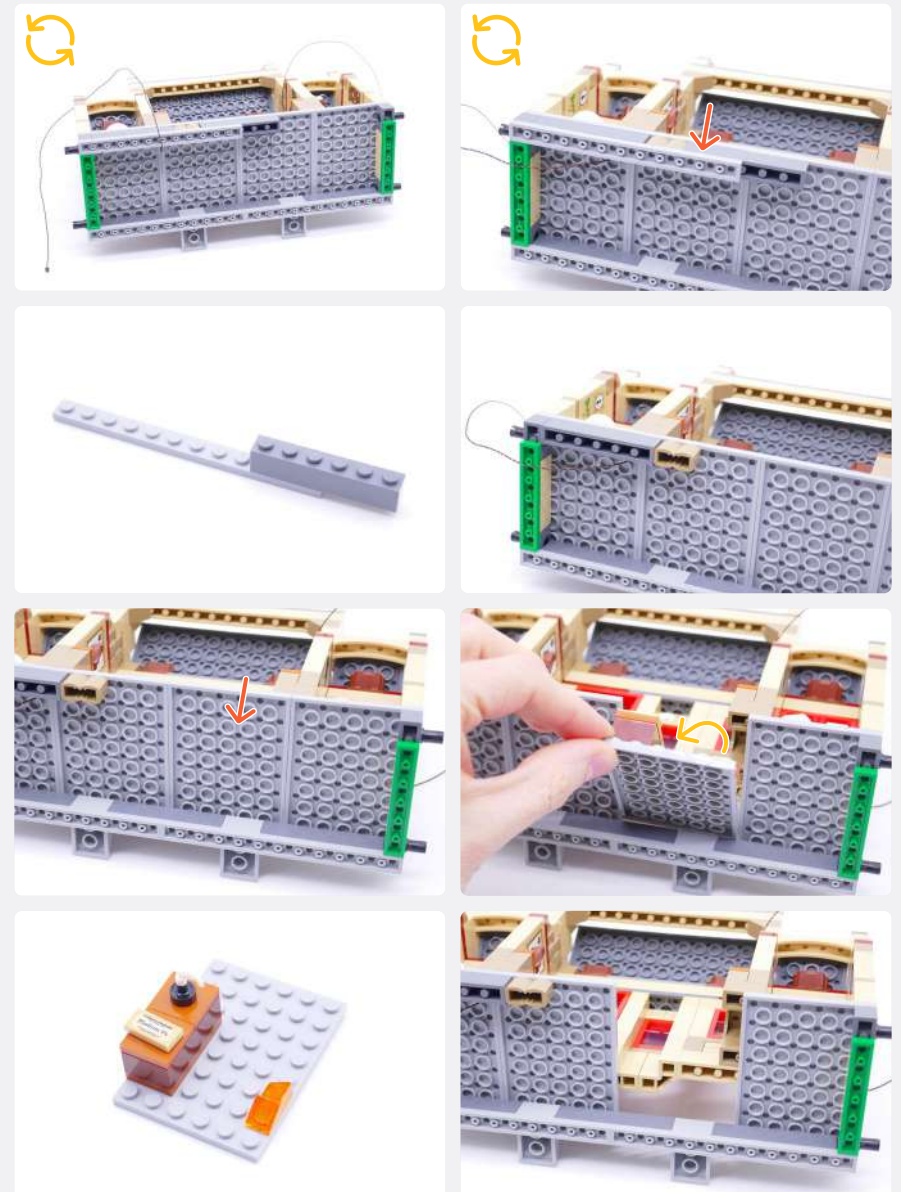

10

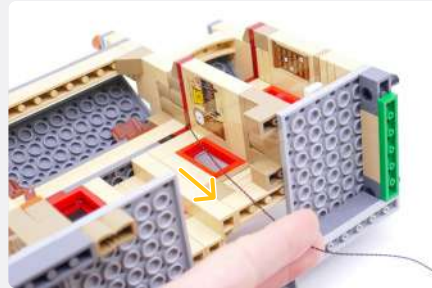
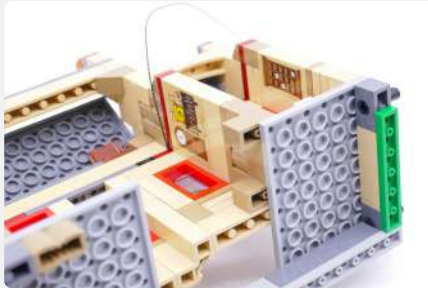
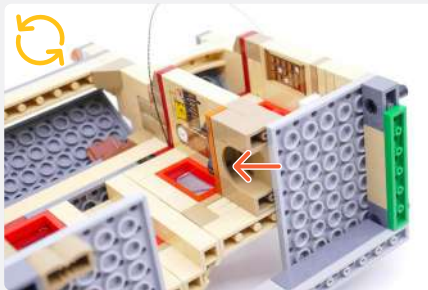

NOTE

Thread the cable between the brown and tan bricks, by lightly bending the bricks and pulling the cable.

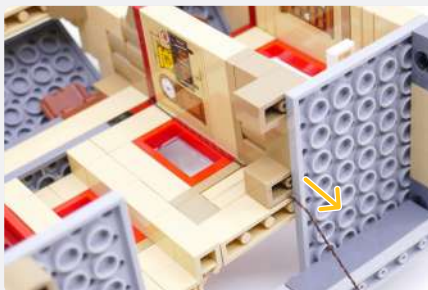

11



Adhesive Square

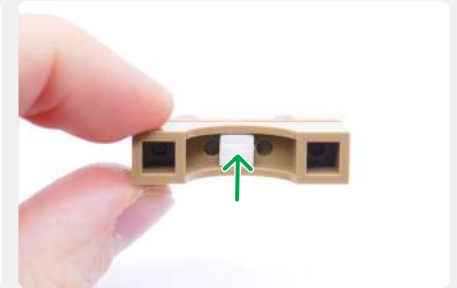
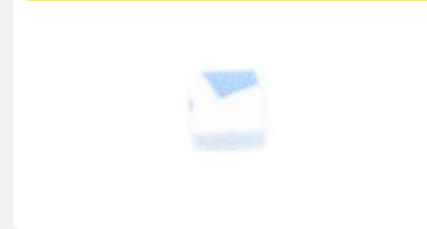

Orange 30cm Bit Light

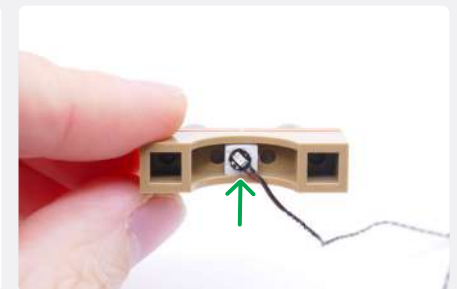

12

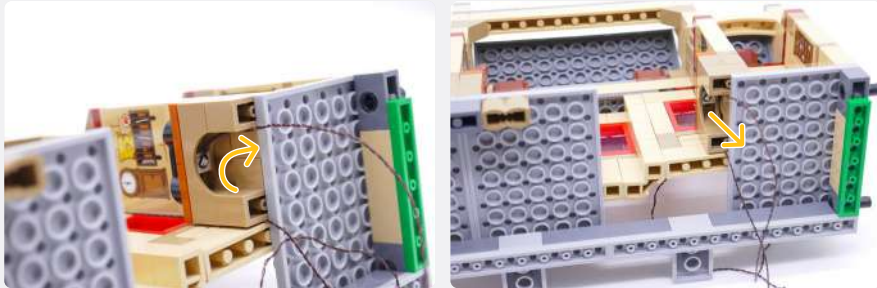
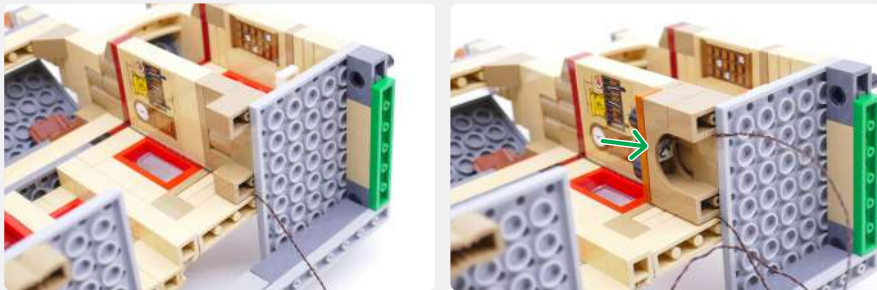

NOTE

Take care when reconnecting the grey plate, by trying not to squish the cables between the plates.

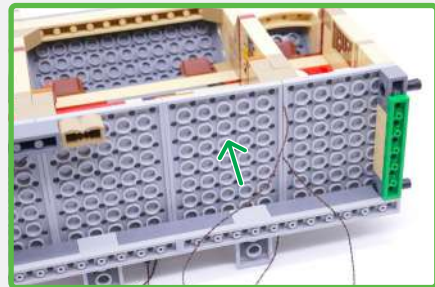

13

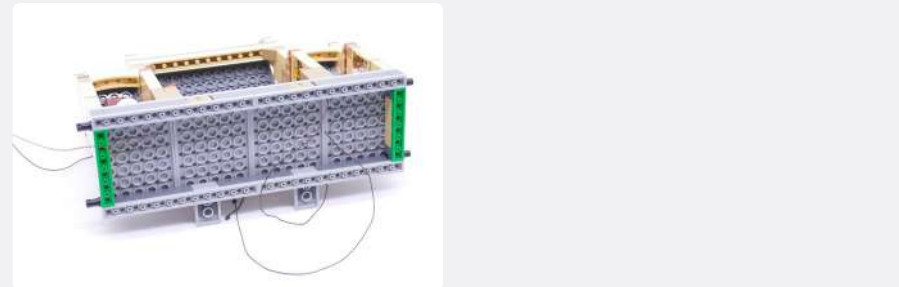
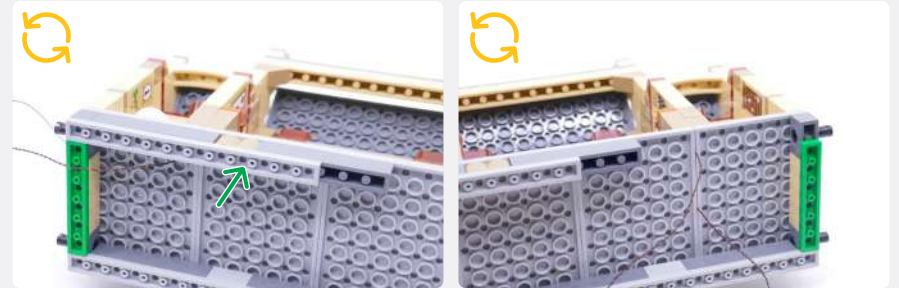
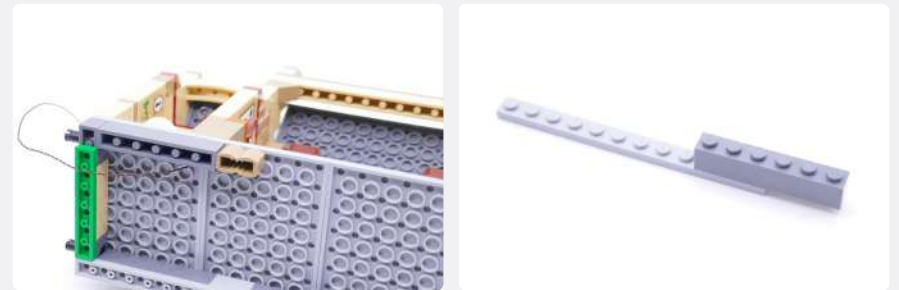

14

8-Port Expansion Board

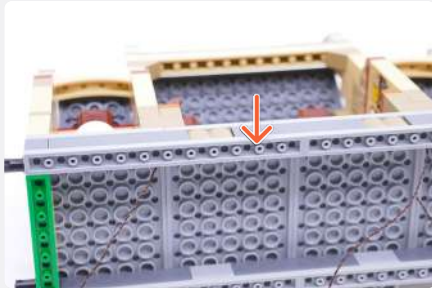
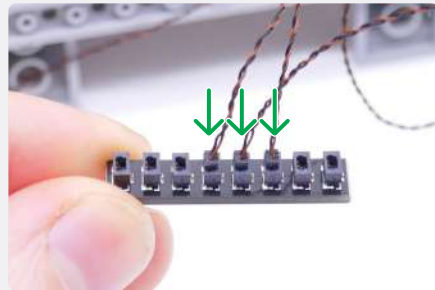

USB Power Cable

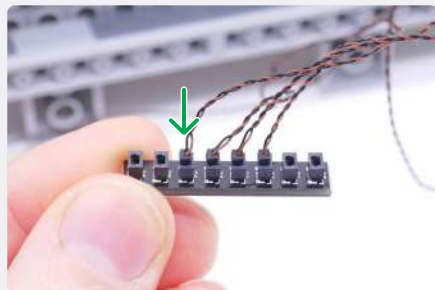

NOTE

Place the expansion board as shown, then run the cable up under the grey plate and reconnect it.

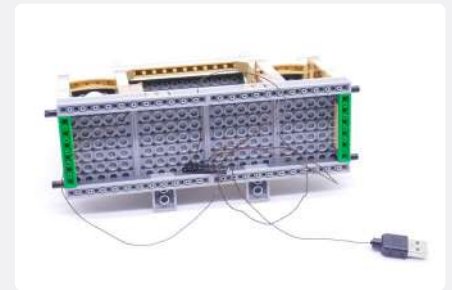
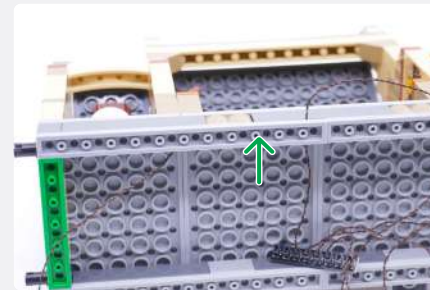
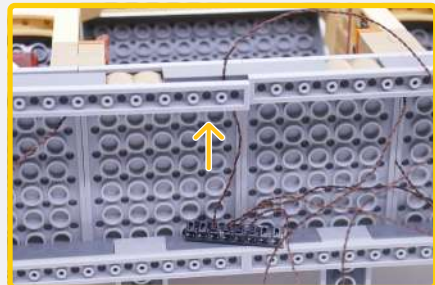

NOTE

Connect to a 5V USB Power Bank, 5V USB Wall Adaptor, or USB to AA Battery Pack (sold separately)

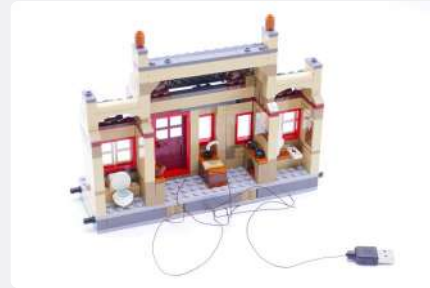

! If you experience any issues with the lights not working and suspect an issue with a component, please try a different port on the expansion board to verify where the fault lies (with the light or expansion board). To correct any issues with expansion board ports, please view the section addressing expansion board issues in our troubleshooting section. i



15

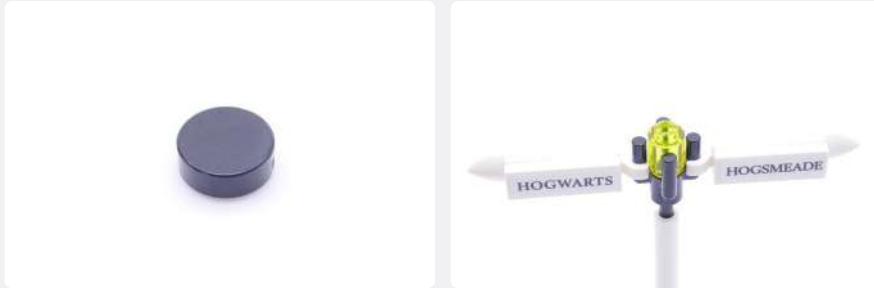

White 30cm Bit Light



16

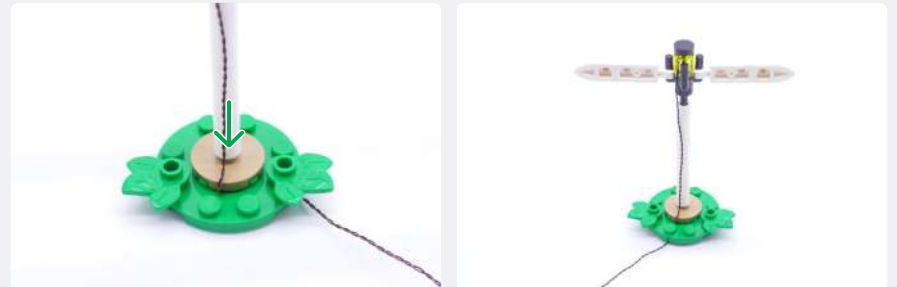
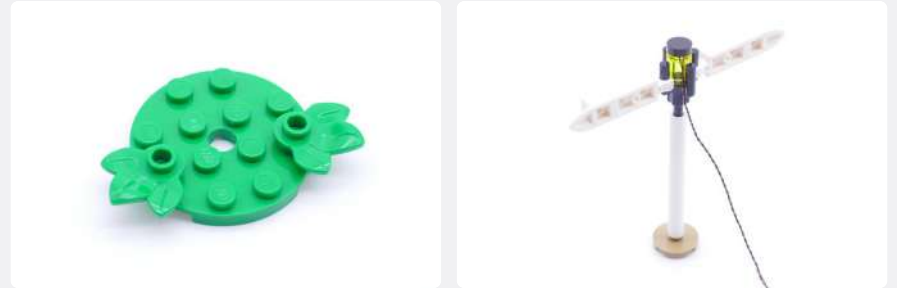
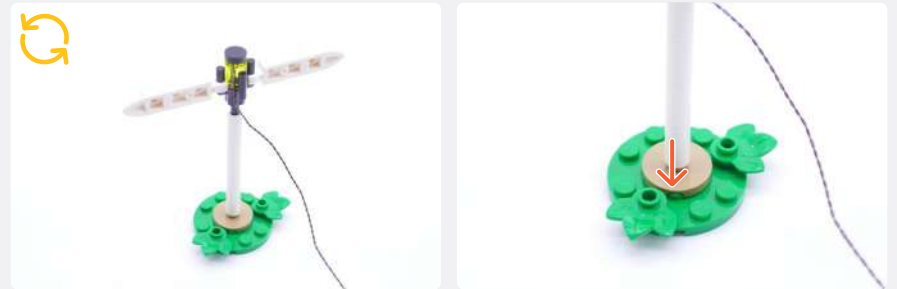

NOTE

Ensure to thread the cable as shown so it sits flat on the table.



NOTE

Run the cable from the sign post under the platform. Leave around 3cm of length between the platform and sign.

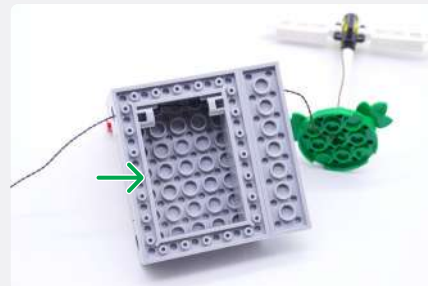
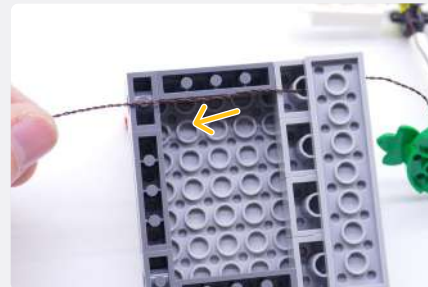
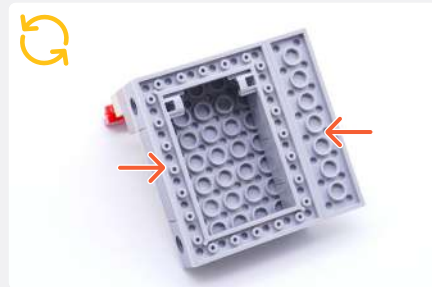
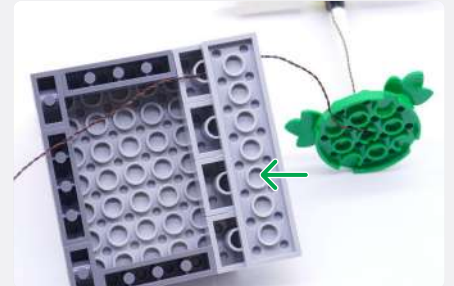

17

18

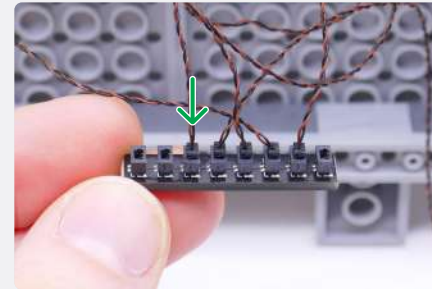
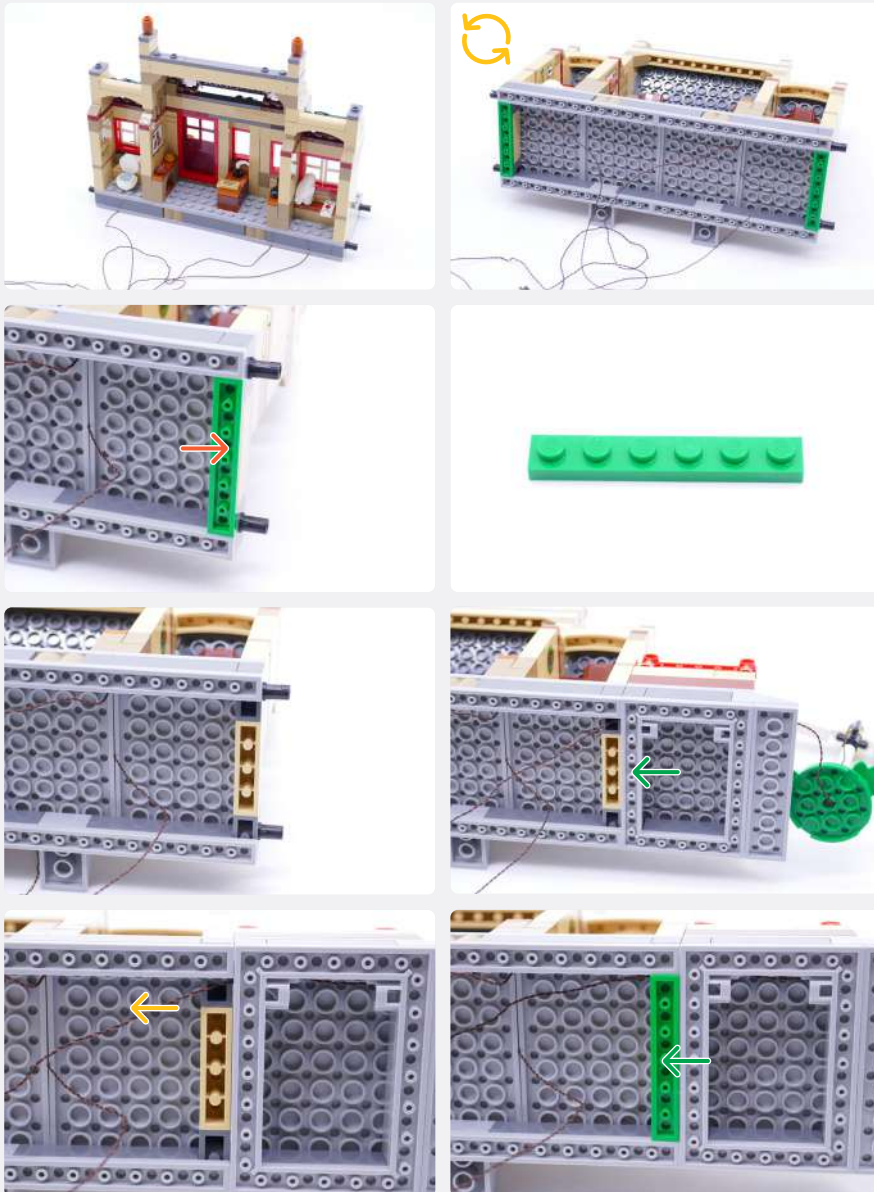

NOTE

Connect to a 5V USB Power Bank, 5V USB Wall Adaptor, or USB to AA Battery Pack (sold separately)



! If you experience any issues with the lights not working and suspect an issue with a component, please try a different port on the expansion board to verify where the fault lies (with the light or expansion board). To correct any issues with expansion board ports, please view the section addressing expansion board issues in our troubleshooting section. i



19

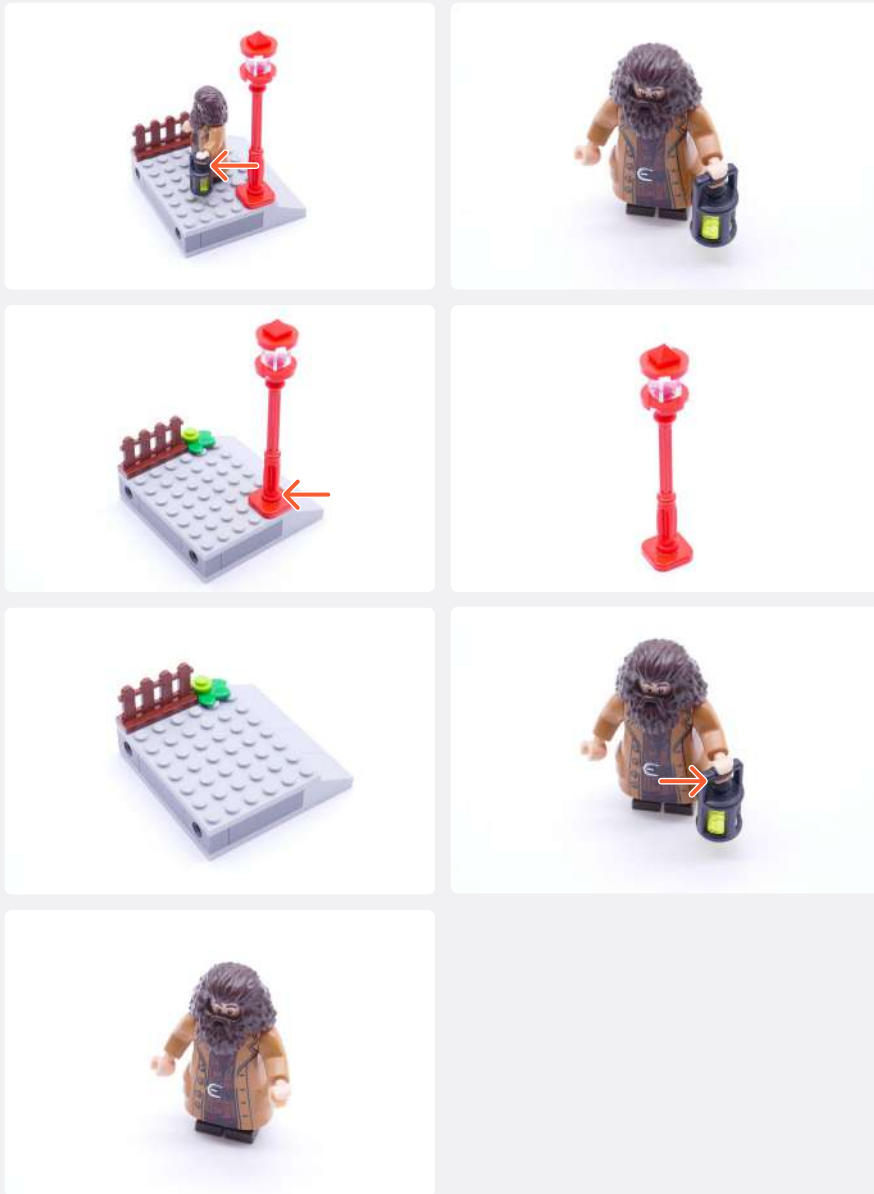

20

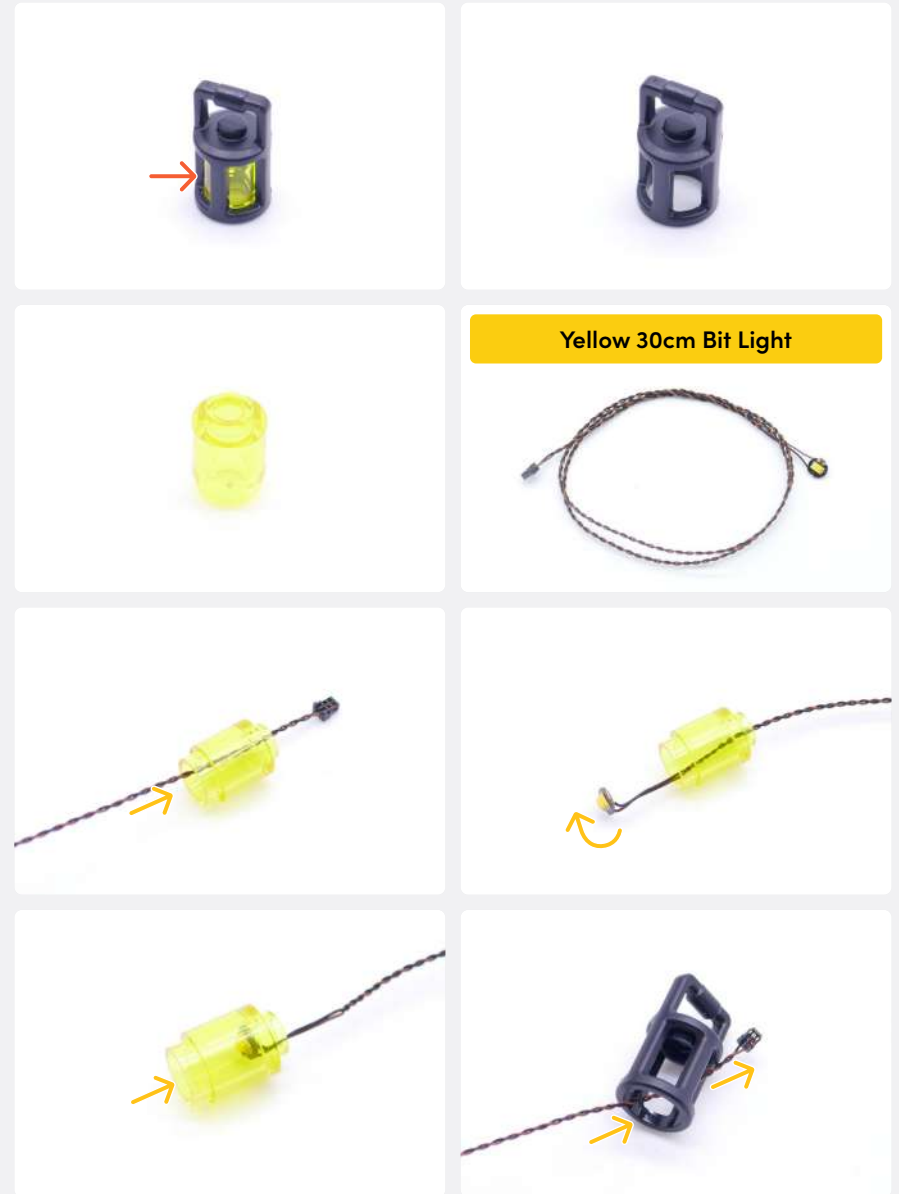

21



22

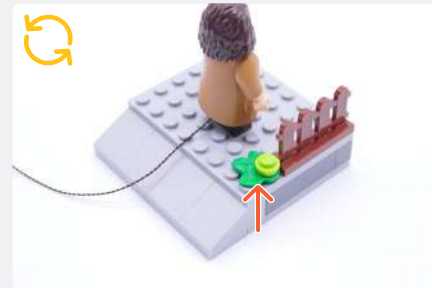

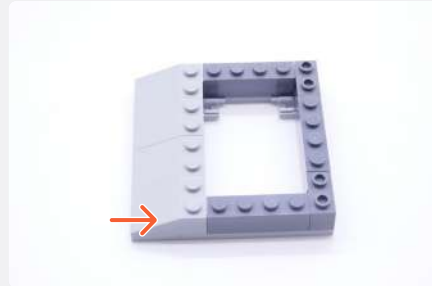
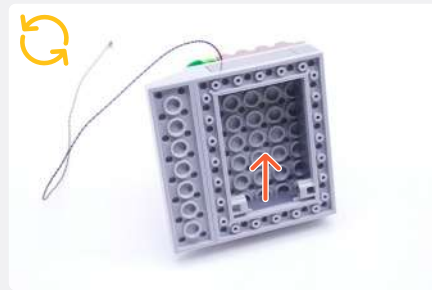
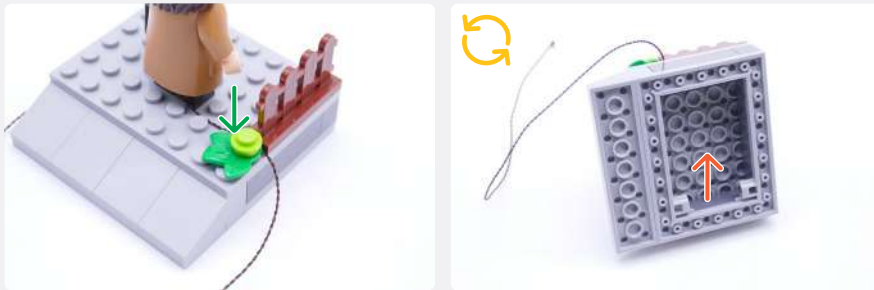

23

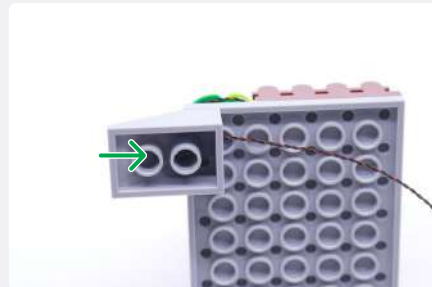

White 30cm Bit Light



24

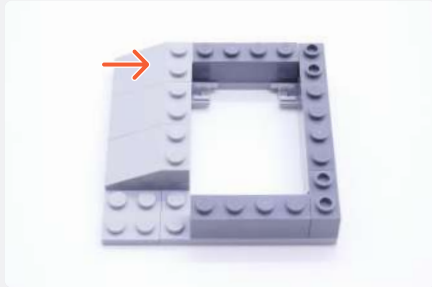

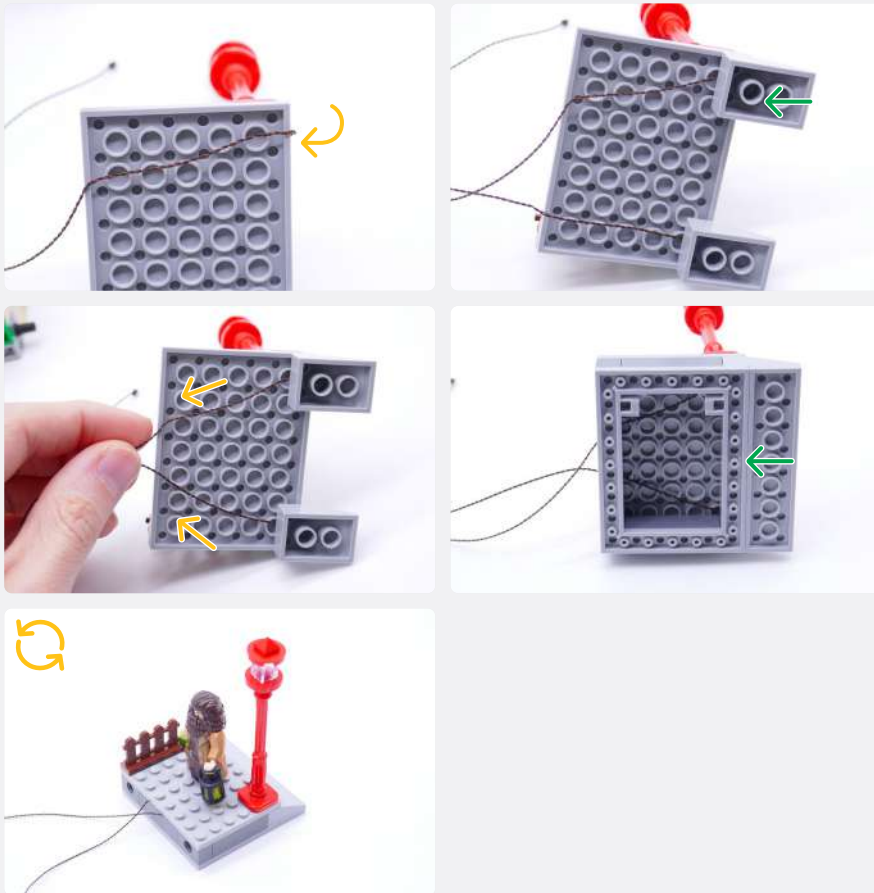

25

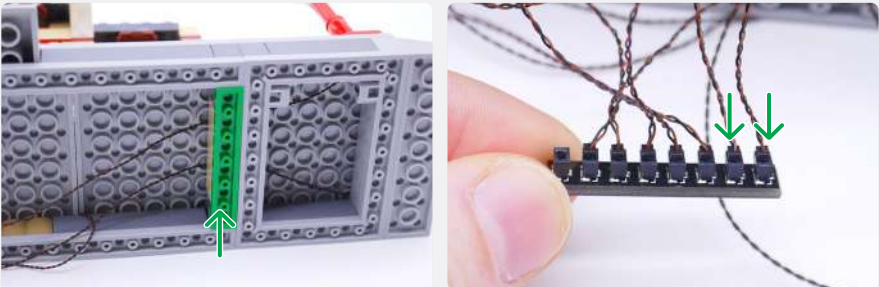
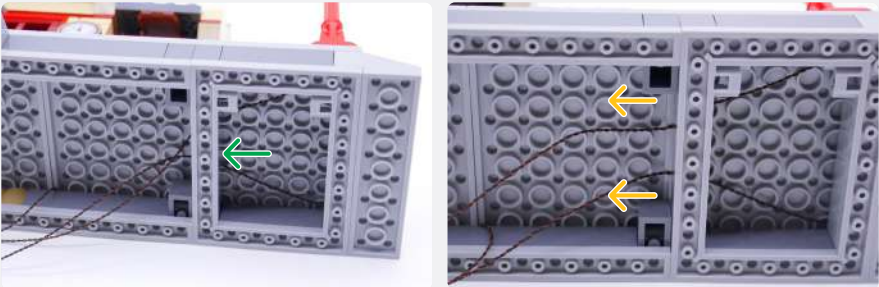
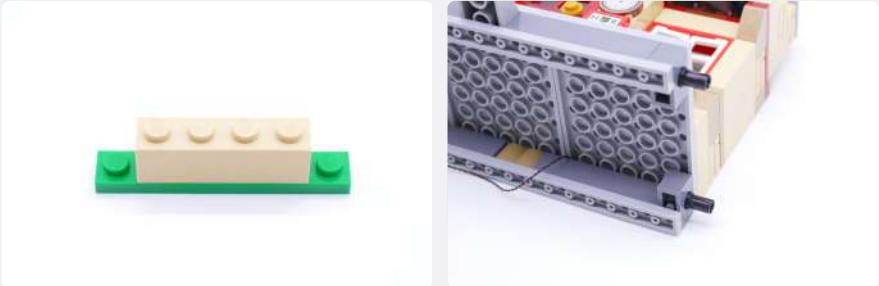
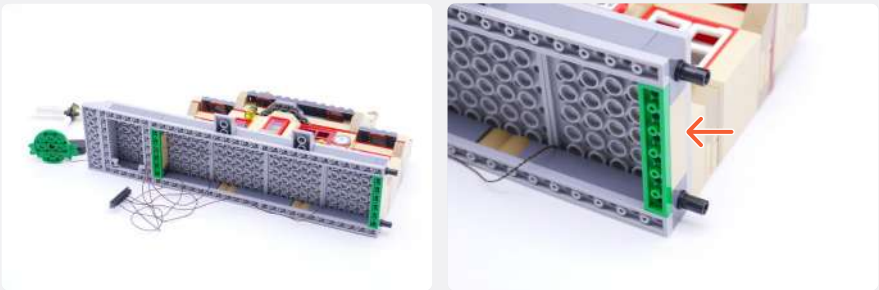

26

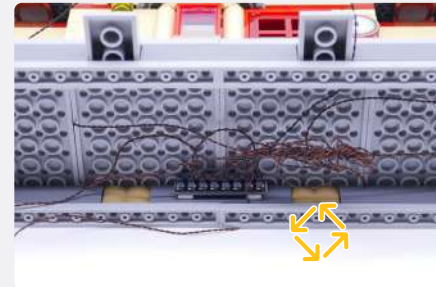
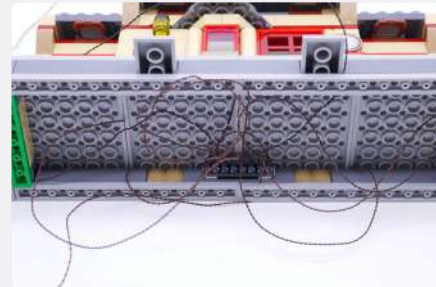
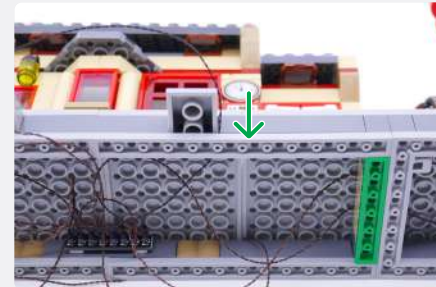
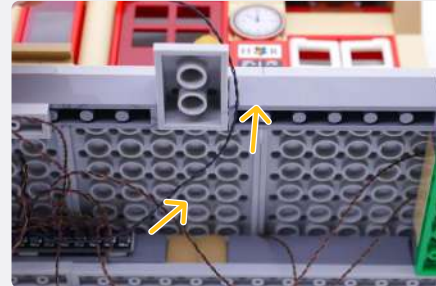
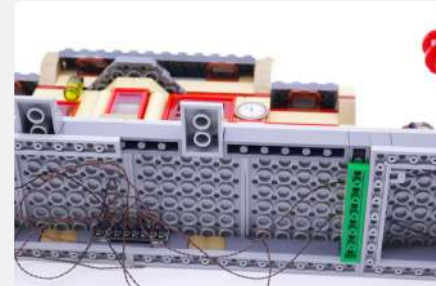
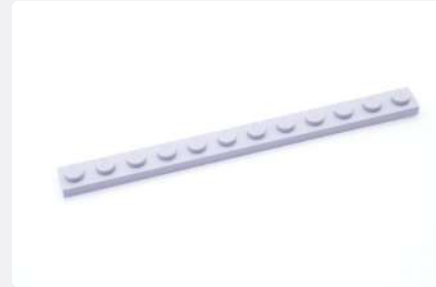
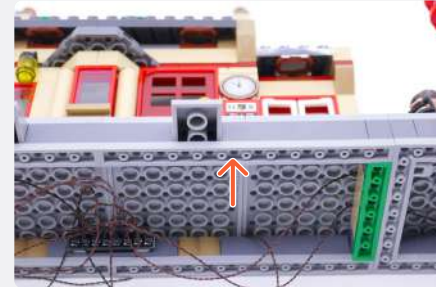
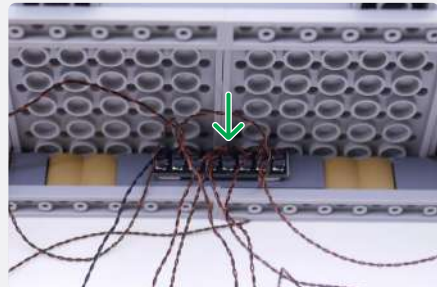
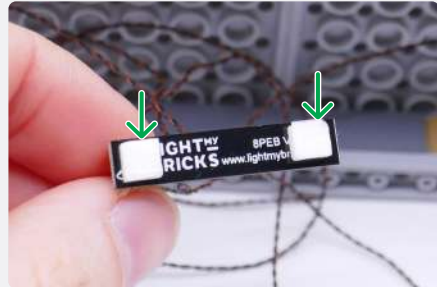
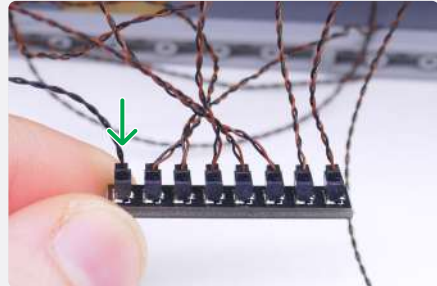
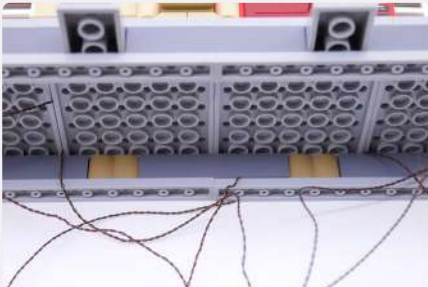



NOTE

Connect to a 5V USB Power Bank, 5V USB Wall Adaptor, or USB to AA Battery Pack (sold separately)



! If you experience any issues with the lights not working and suspect an issue with a component, please try a different port on the expansion board to verify where the fault lies (with the light or expansion board). To correct any issues with expansion board ports, please view the section addressing expansion board issues in our troubleshooting section. i



27

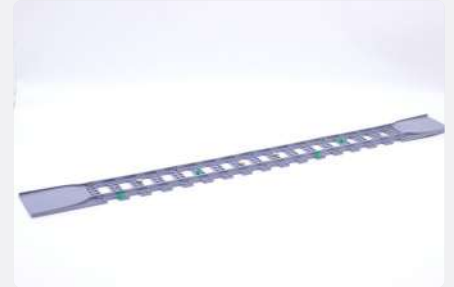

28



29



30

White 30cm Bit Light



Bracket 1x1 - 1x1 Inverted - Black



Plate, Round 1x1 - Trans-Yellow

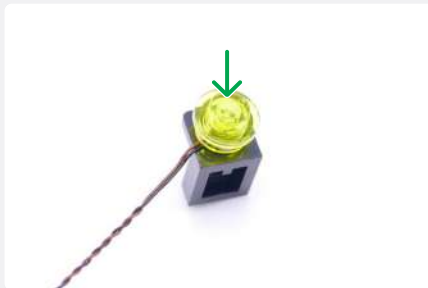

Plate, Modified 1x2 with 1 Stud with Groove and Bottom Stud Holder (Jumper) - Black

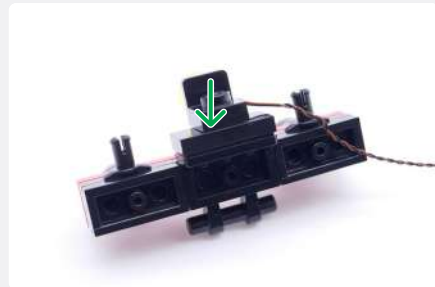

31

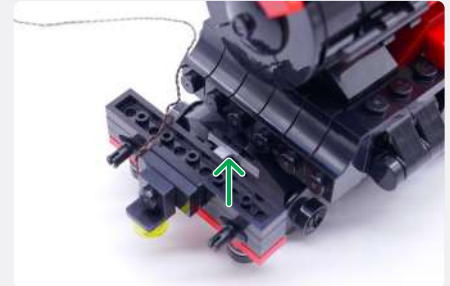
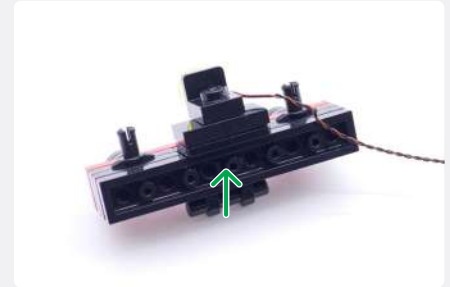

32

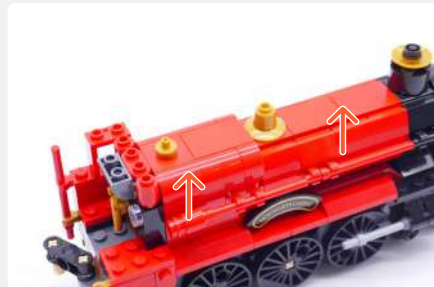
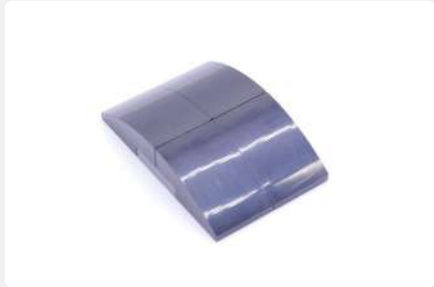
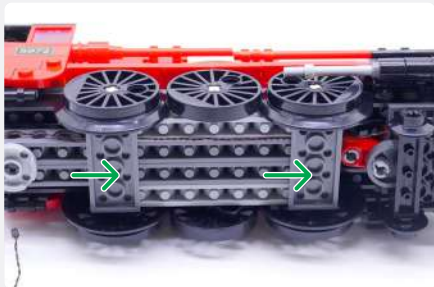
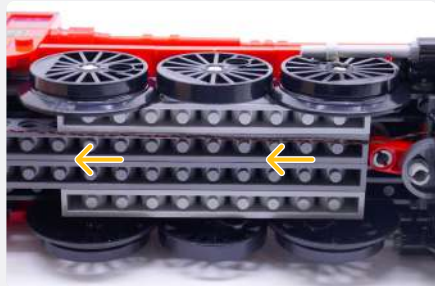
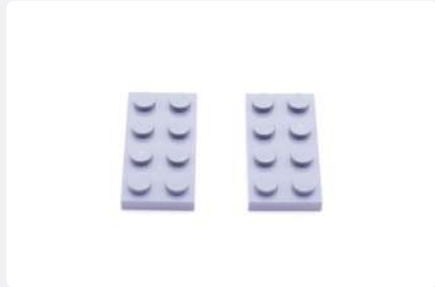
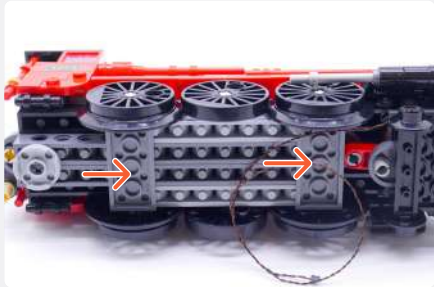

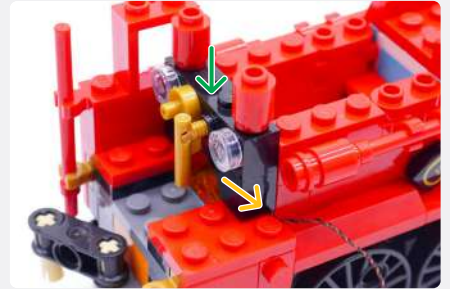
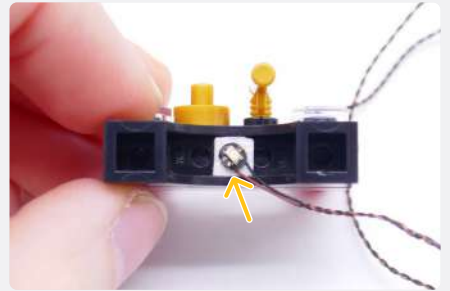
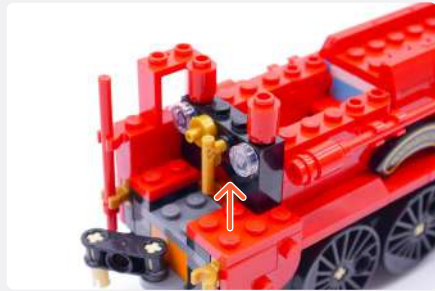
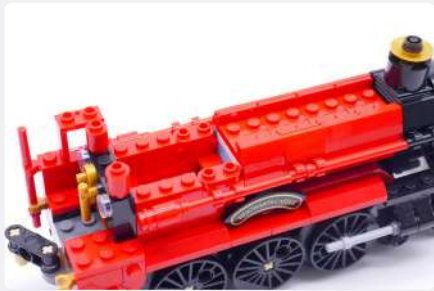

33

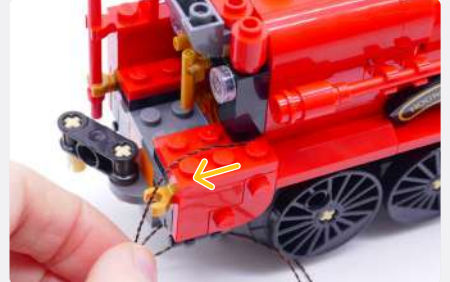
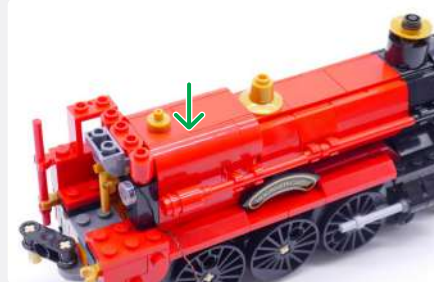
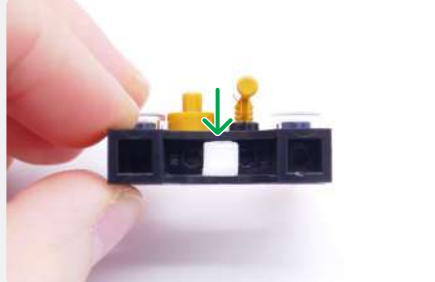

34

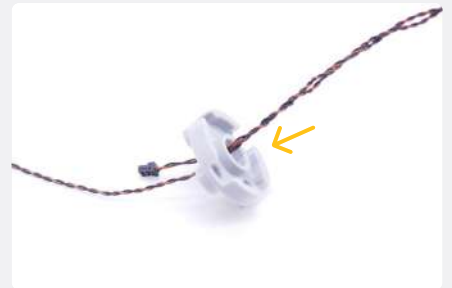
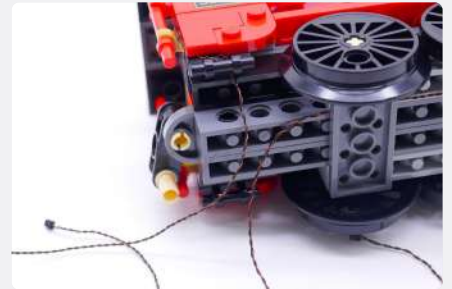
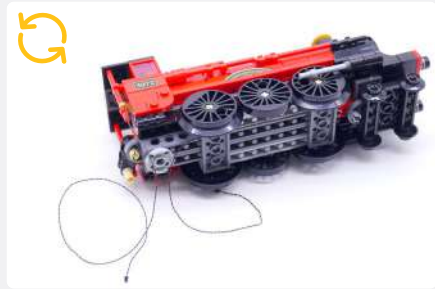

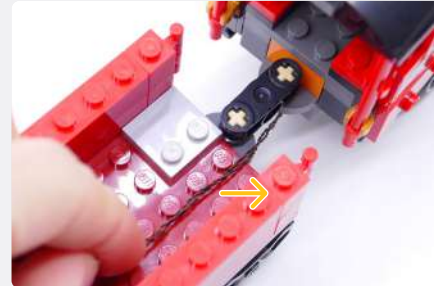
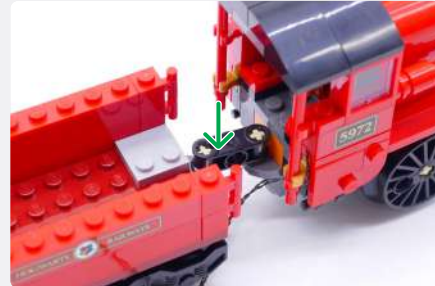
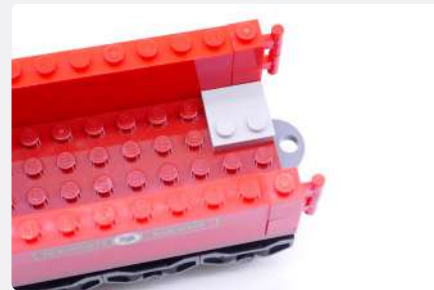
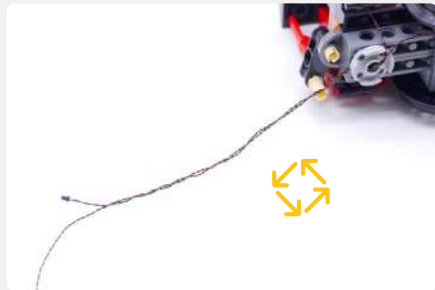
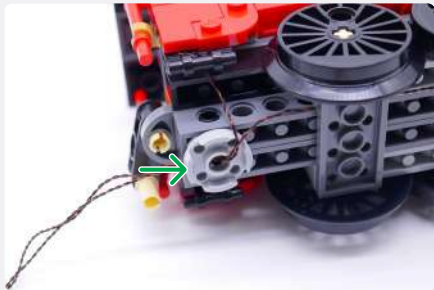

35

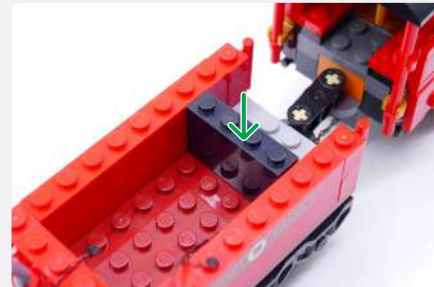
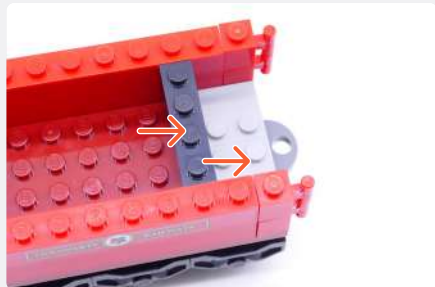
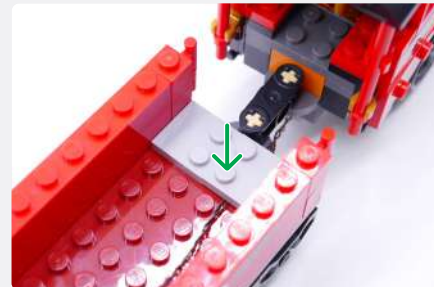



6-Port Expansion Board

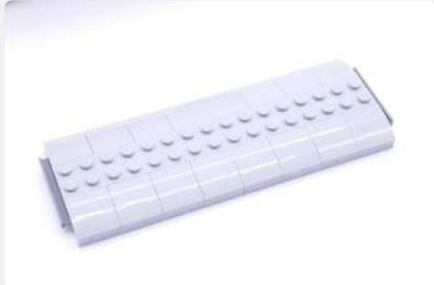
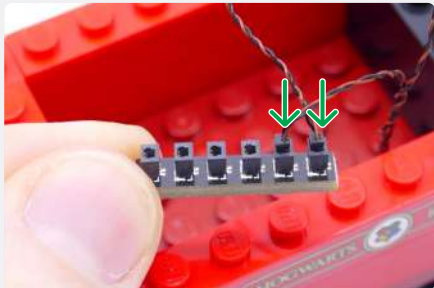

36

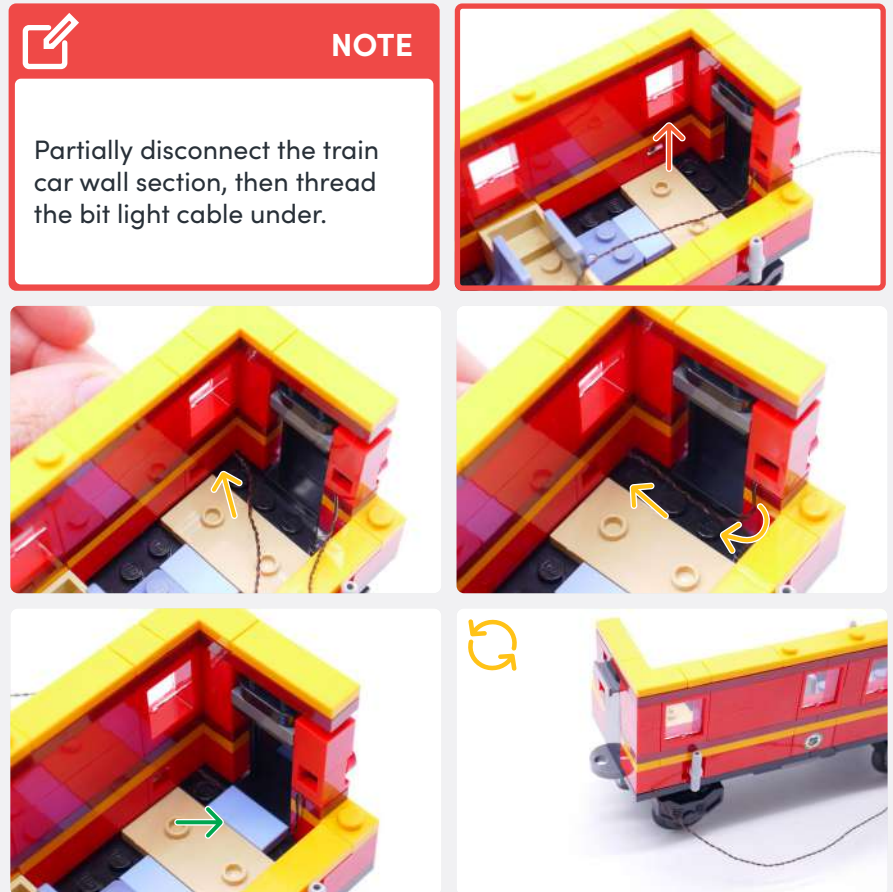
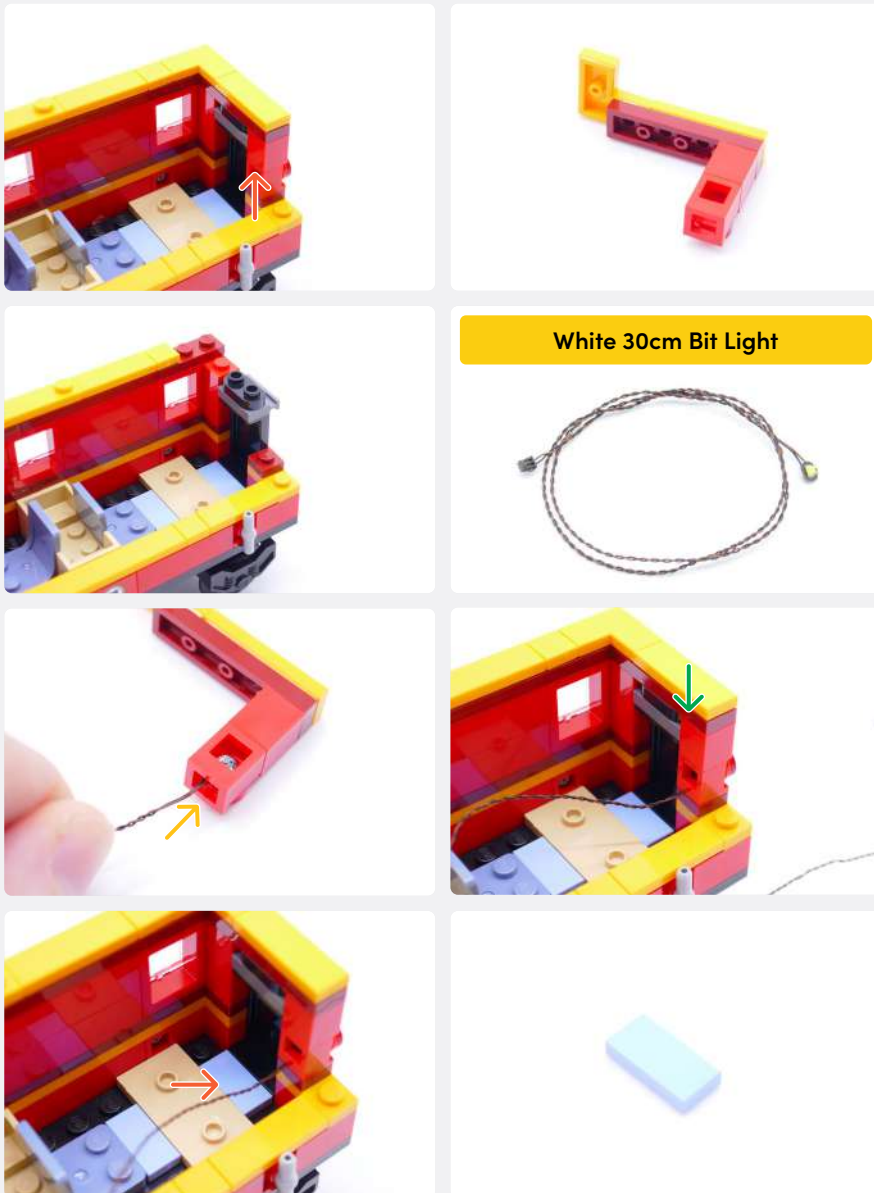

37

38

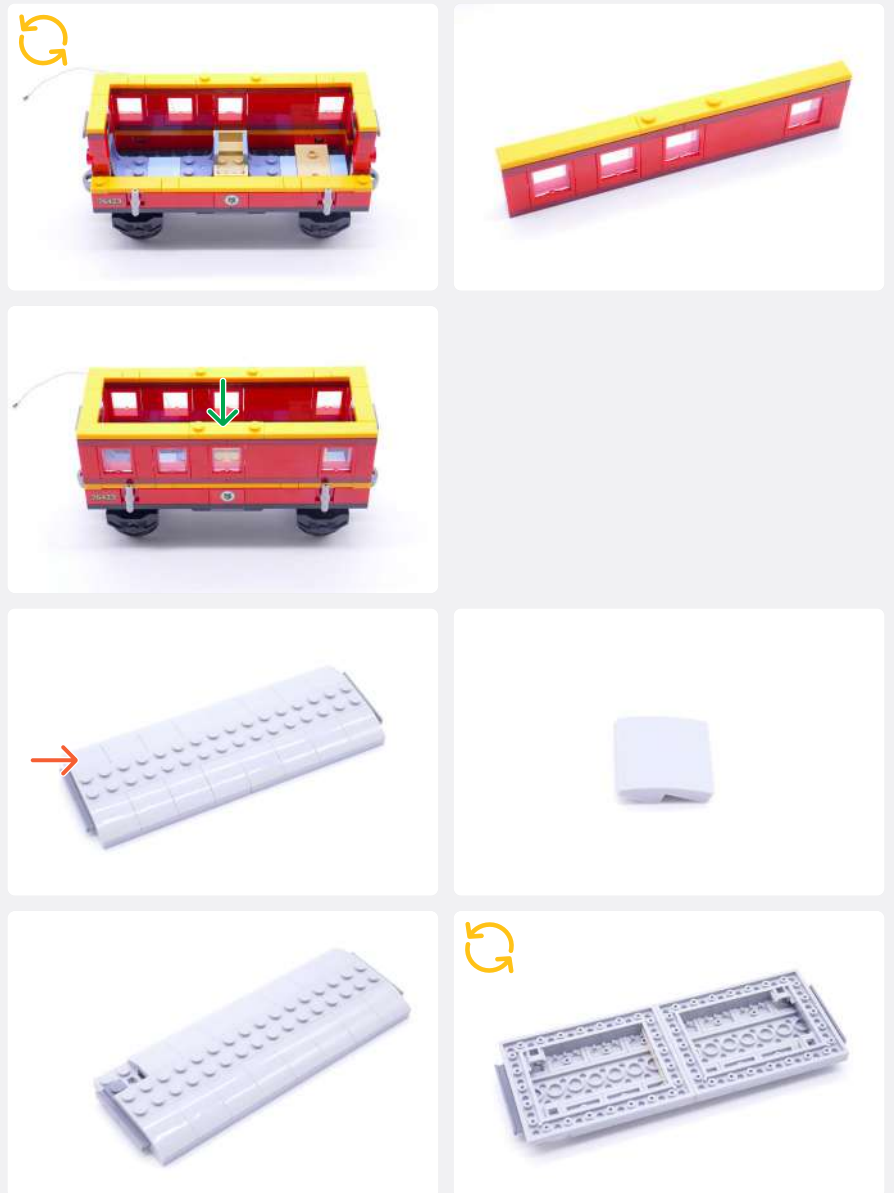

39

White 30cm Bit Light

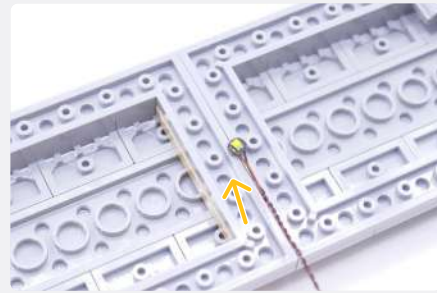

Plate, Round 2x2 with Rounded Bottom (Boat Stud) - Trans-Clear

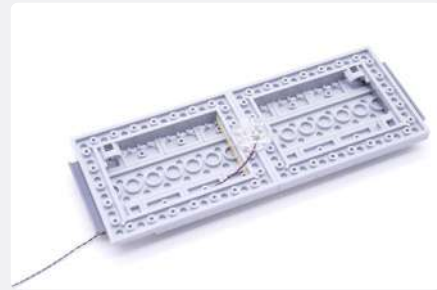
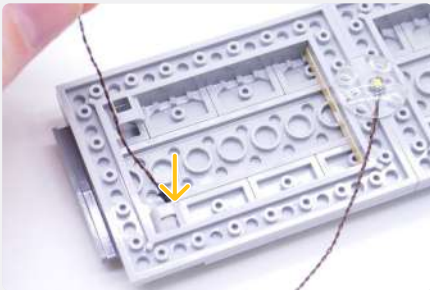
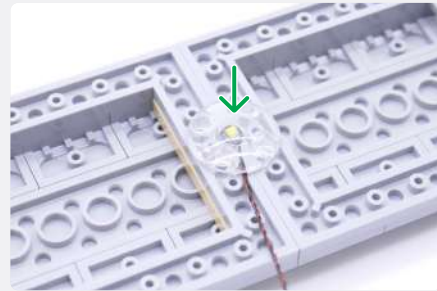

NOTE

Thread the cable through the small hole in the LEGO piece.

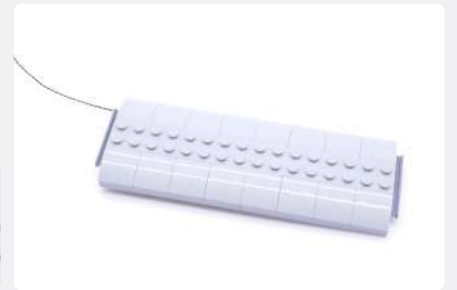
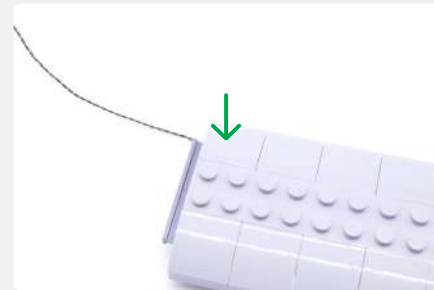
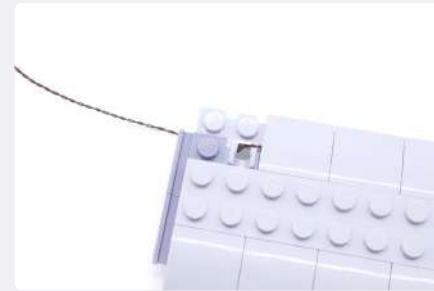
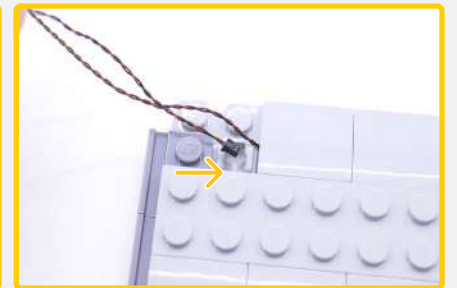

40



NOTE

Ensure there is no slack on the bit light cable when reconnecting the train car side and roof.

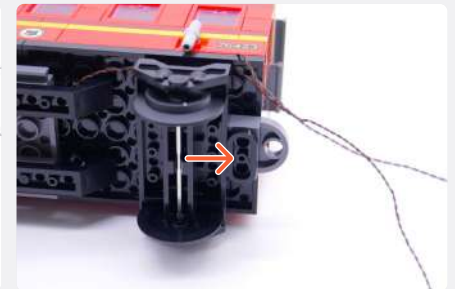

NOTE

To remove the roof to put minifigures inside, lightly disconnect it from the studs then rotate and lie to the side.

41

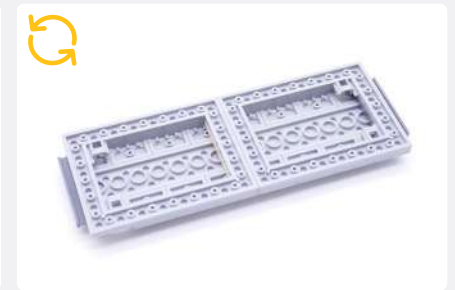
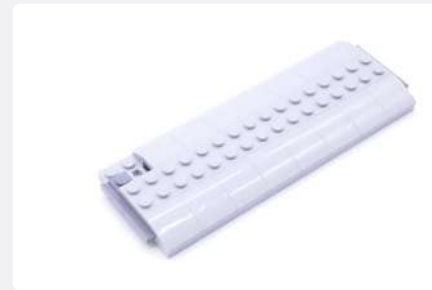
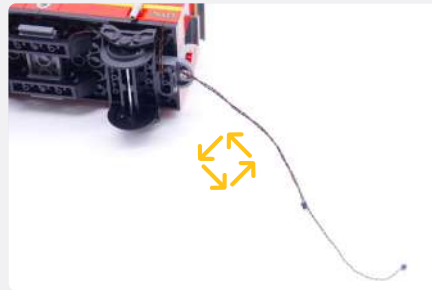
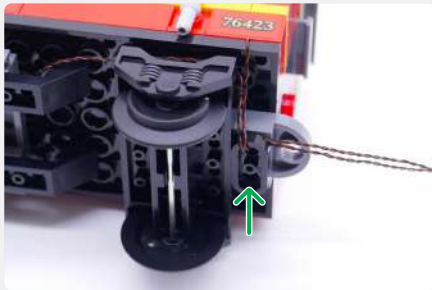

White 30cm Bit Light

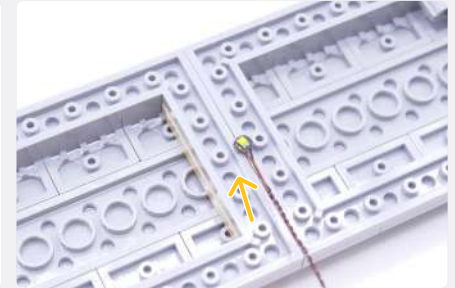

Plate, Round 2x2 with Rounded Bottom (Boat Stud) - Trans-Clear

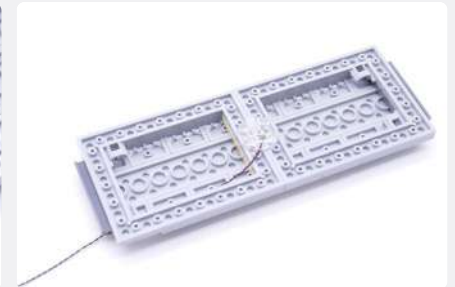
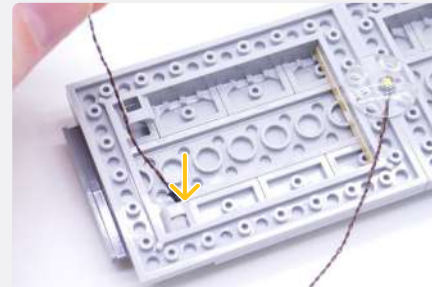
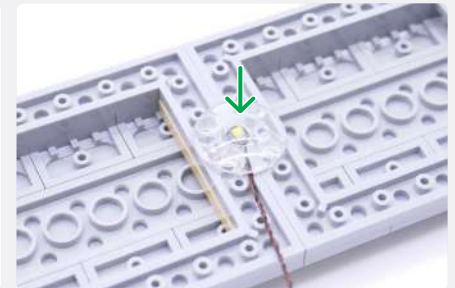

42

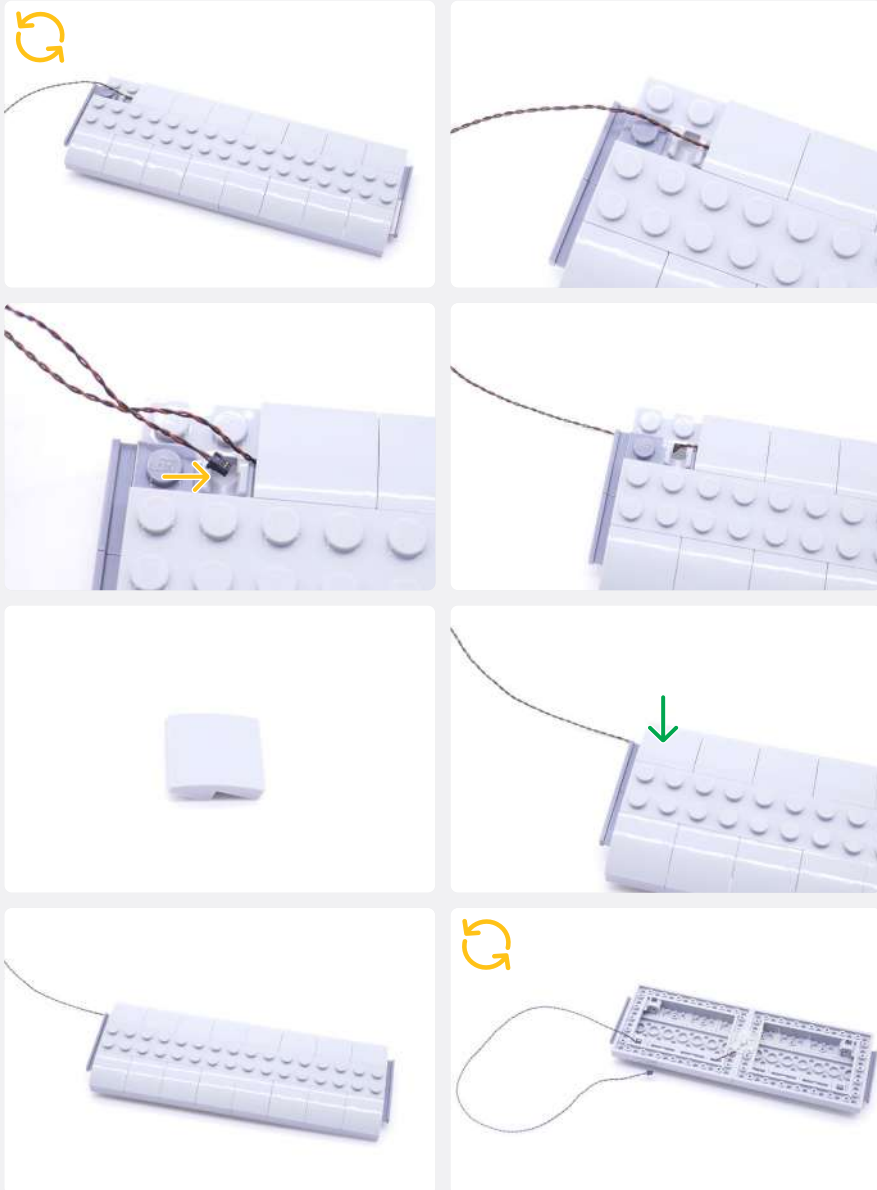

43



44

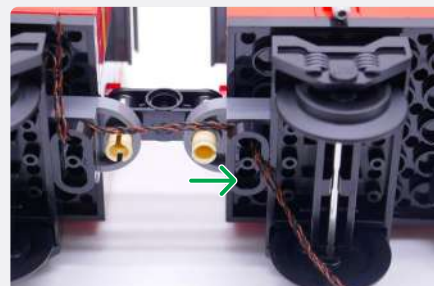
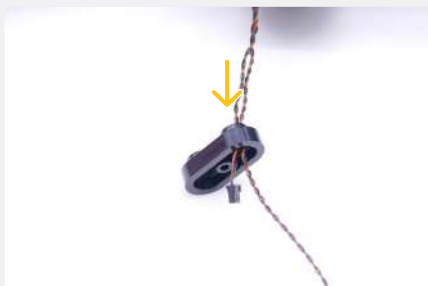
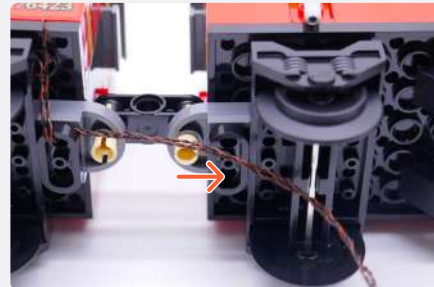
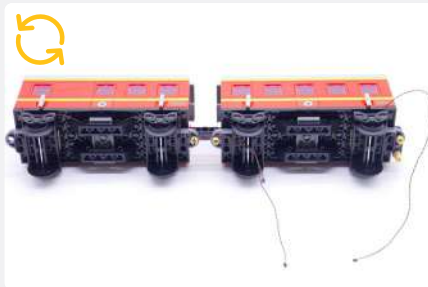
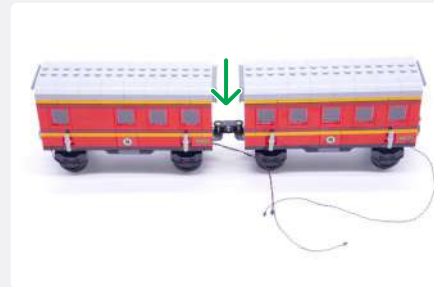

6-Port Expansion Board

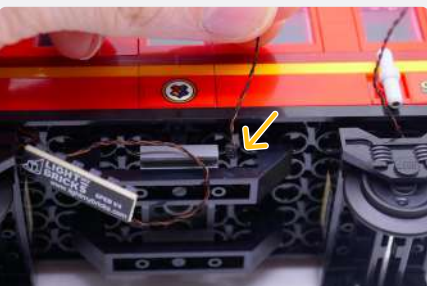
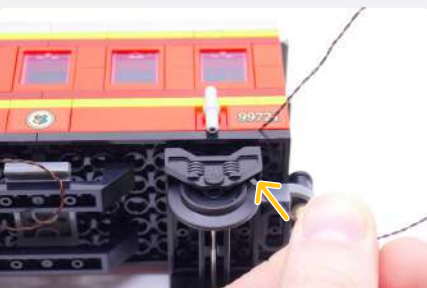
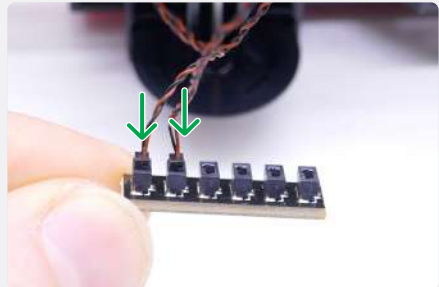

45

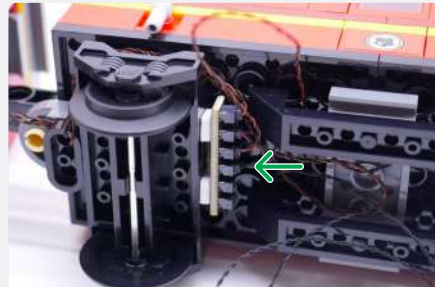
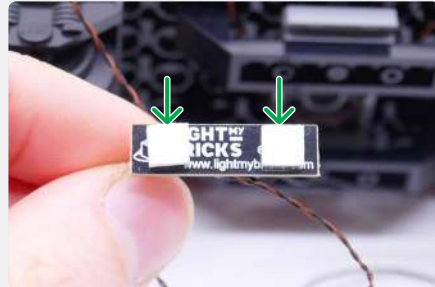
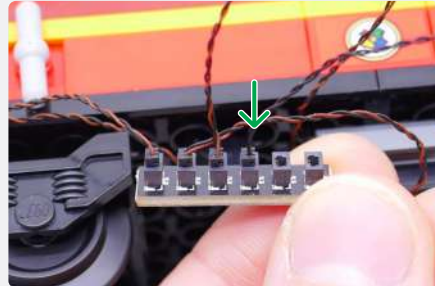
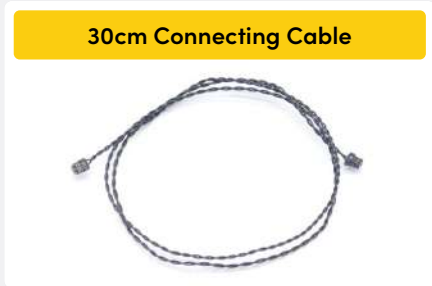
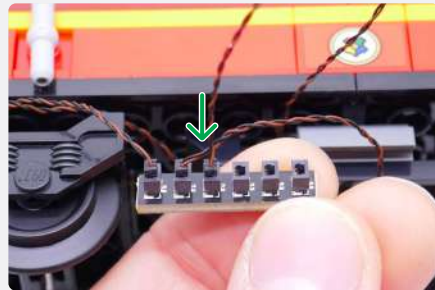
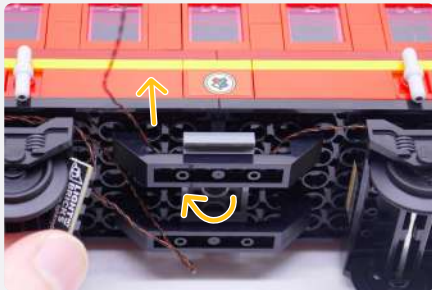

NOTE

If the cables from the back of the train don't reach, go over the wheels instead and stick the board down.

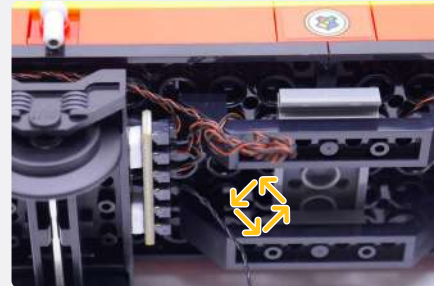
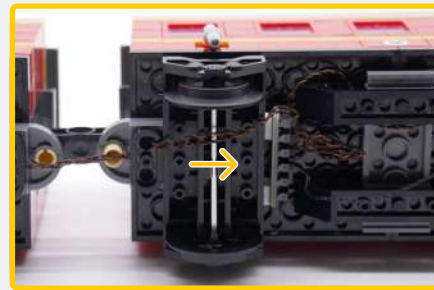

46

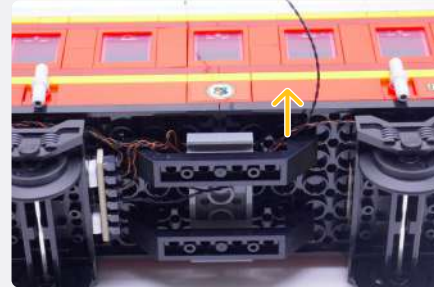

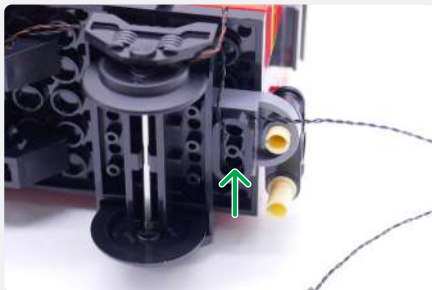

47

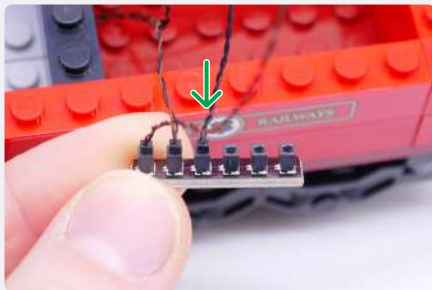
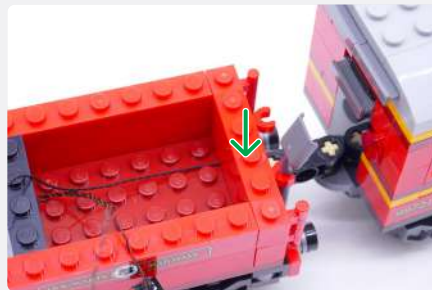
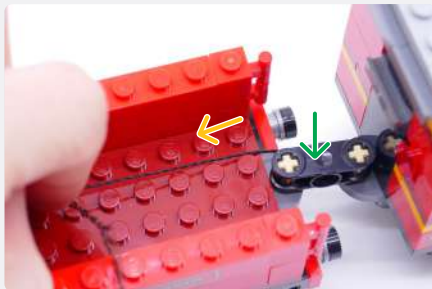
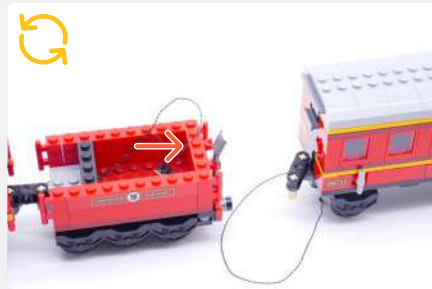

48

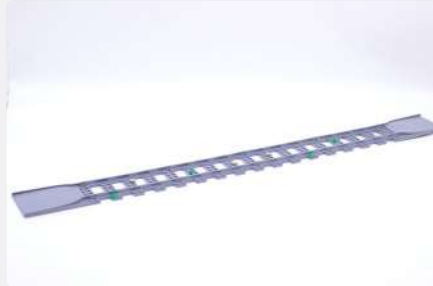
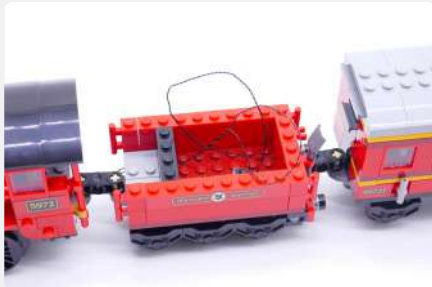

NOTE

If you are displaying this set, and do not plan to roll the train around on the tracks, use the following pieces to fix it down.



Brick, Round 1x1 Open Stud - Trans-Clear



Plate, Round 1x1 - Trans-Clear

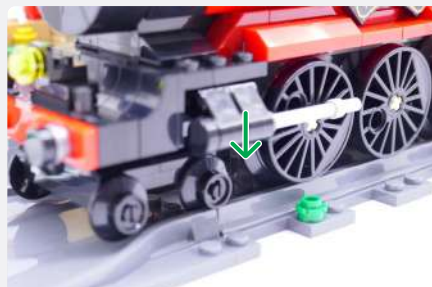
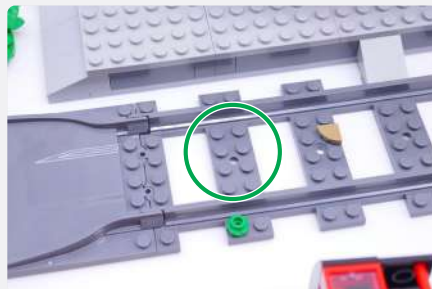
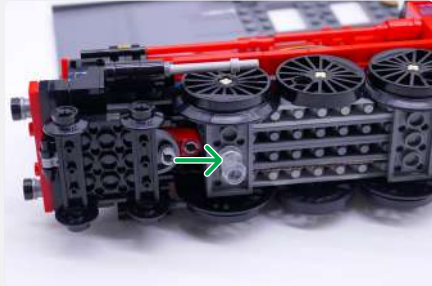

49

NOTE

If you are displaying the train, make the cable short. If you plan to move the train around, leave some length on it before reconnecting the wall.

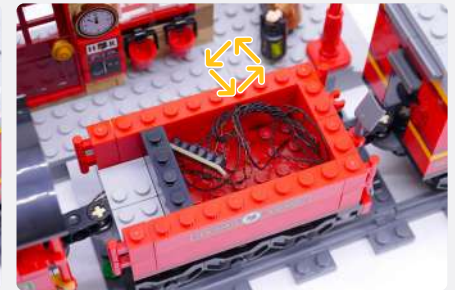
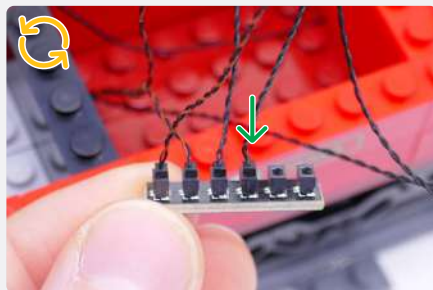
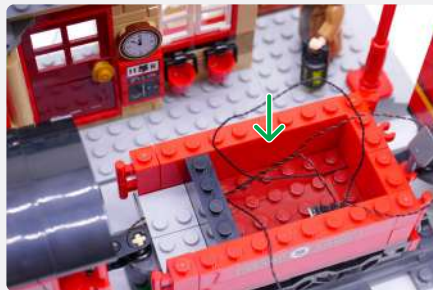
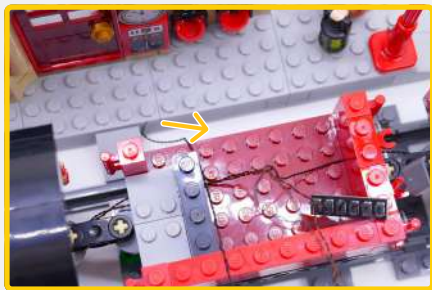
NOTE

Connect to a 5V USB Power Bank, 5V USB Wall Adaptor, or USB to AA Battery Pack (sold separately)



NOTE

You should have these parts left over that were removed from the LEGO set

Removed Pieces

! If you experience any issues with the lights not working and suspect an issue with a component, please try a different port on the expansion board to verify where the fault lies (with the light or expansion board). To correct any issues with expansion board ports, please view the section addressing expansion board issues in our troubleshooting section. i

NOTE

If you have purchased the optional accessory Power Brick continue with the instructions to install it. Install the batteries before connecting it to the set.

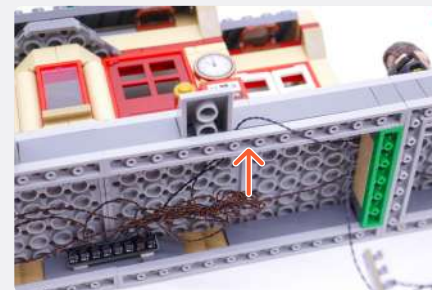
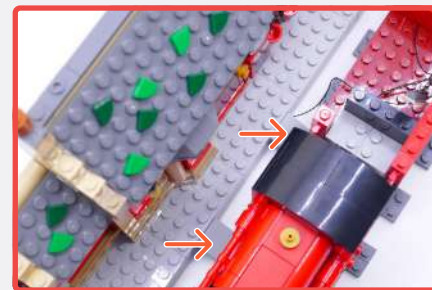
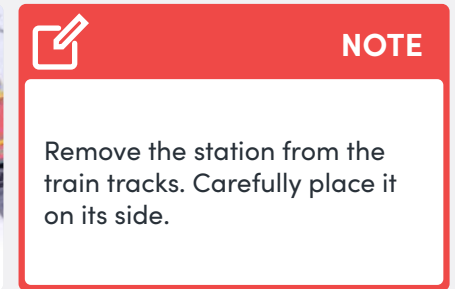

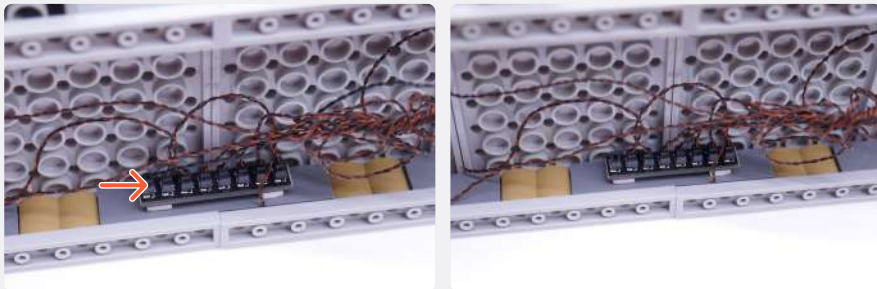
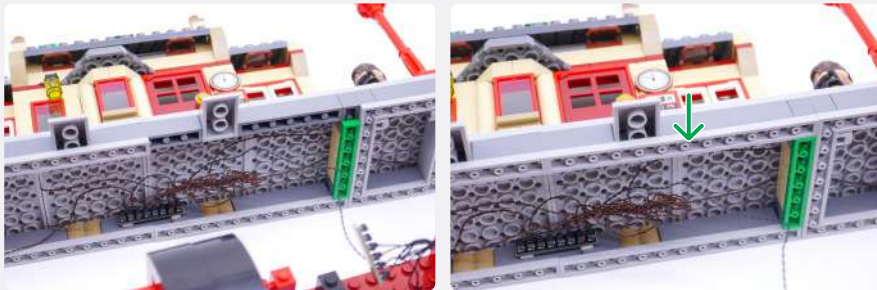

51

NOTE

Remove the 50cm Connecting Cable from the station and leave it by the train. Reconnect the train station to the tracks.

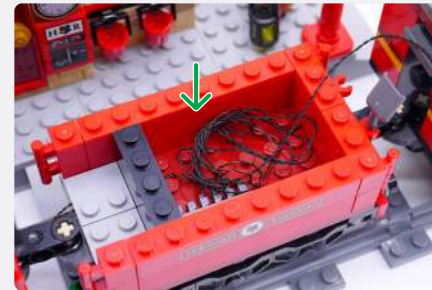



LMB Power Brick

NOTE

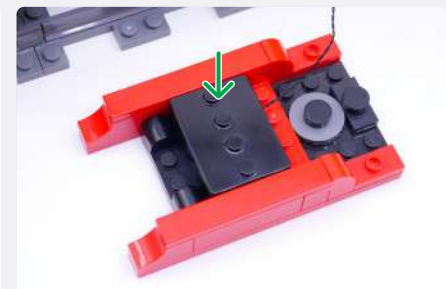
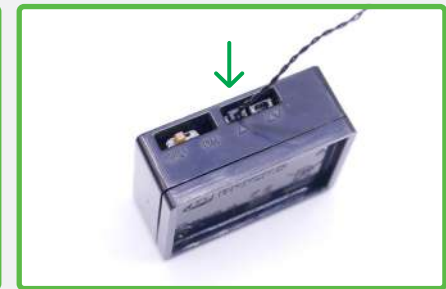
Connect the loose 50cm Connecting Cable from the train into any Power Brick port.

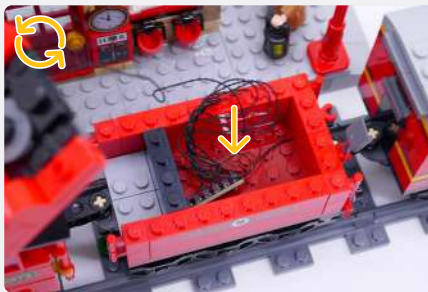
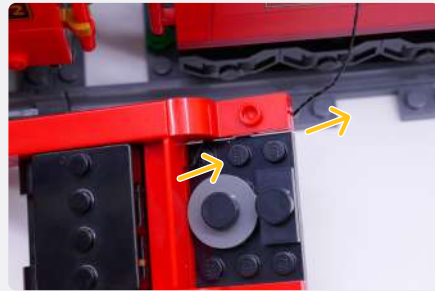
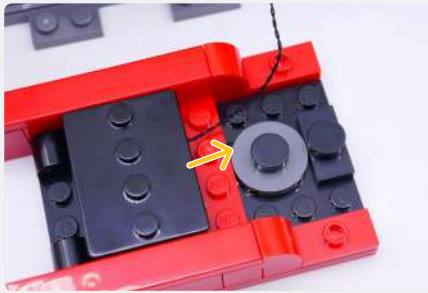



 **NOTE**

Turn on the Power Brick by flicking the switch next to the ports to ON. You will need to power the station separately to the train.



! If you experience any issues with the lights not working and suspect an issue with a component, please try a different port on the expansion board to verify where the fault lies (with the light or expansion board). To correct any issues with expansion board ports, please view the section addressing expansion board issues in our troubleshooting section. **i**

FINAL PRODUCT

This finally completes installation of the Light My Bricks

LEGO® Harry Potter Hogwarts Express & Hogsmeade Station 76423 Light Kit.





TROUBLESHOOTING

Light My Bricks lighting kits contain individual components that are very small and can be easily damaged if not handled correctly.

To prevent unnecessary damage to components, we highly recommend that the User Guide section, **“Important things to note”** is read carefully. Follow the handling procedures in the User Guide to help prevent faults and damages to your Light My Bricks components.

If you are experiencing issues with your Light My Bricks set, watch our troubleshooting video [here](#) or read on for a list of common causes to help you troubleshoot.

Troubleshooting

Firstly, ensure that the batteries have power using a battery charge gauge.

If the batteries have no power, replace the batteries.

If the batteries still have power, check to see if the batteries have been inserted correctly into the battery pack.

Check for AA batteries using the AA battery pack

Inside the battery pack are symbols indicating which direction the AA battery should be inserted. The flat side of the battery should be paired with the spring side of the battery pack.

If the batteries have been installed correctly and your kit still isn't operating correctly, the next step is to check the wiring.

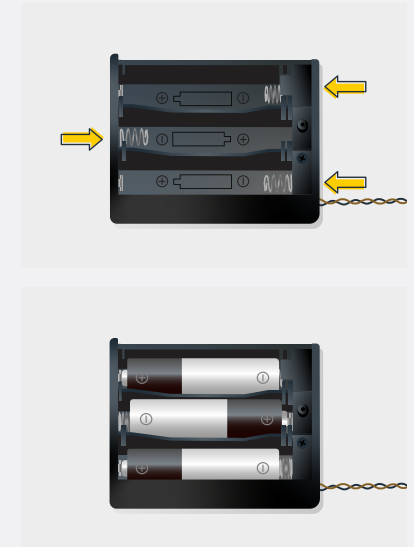

Troubleshooting

Check Your Wires

In order for Light My Bricks components to fit in between and underneath LEGO® bricks, the components need to be very small. Due to this nature, Light My Bricks components can be easily damaged when not handled correctly.

Be careful when removing unpacked components out of the packaging and ensure not to forcibly pull at the wires as this can damage the soldering that attach the wires to the LEDs.

If the wiring is detached from the LED itself, the light will not operate.

When connecting lights to your LEGO® set, check that there are no pinched wires underneath or in between bricks and plates.

When the wires are pinched and the exposed wires are touching each other, this can cause a crosswire and the lights to not function correctly.

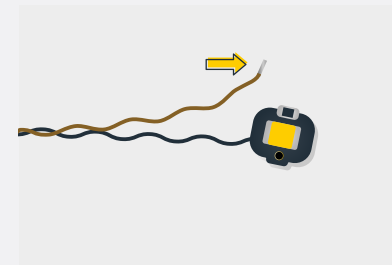
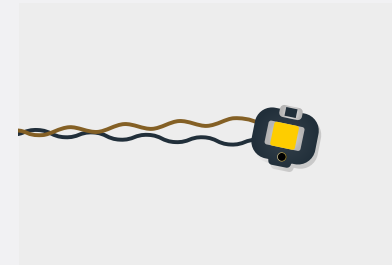

Troubleshooting

Check Your Expansion Board Ports/ Strip Light Ports / Effects Board Ports

It is important to note that connectors can only be inserted to the expansion board, strip light, or effects board ports in one direction.

Forcibly inserting connectors in the incorrect direction will result in damaging the pins inside each of the ports on your component board.

Not only will a light connected to the damaged port not work, but if the pins inside the port are bent to a point they are touching each other, this can result in all other lights in the system to stop working. This is a short circuit.

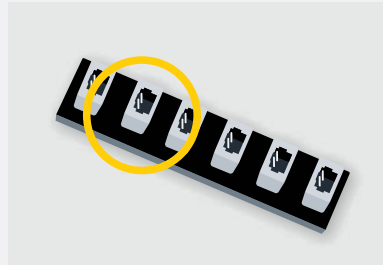

A short circuit can also result in overheating of the board, cable or batteries. If you suspect a short circuit, **DISCONNECT POWER IMMEDIATELY**. Batteries can fail, catch fire, or even explode if left connected to a short circuit for too long.

If you suspect you have a faulty component due to a bent pin, try the following steps:

If you look carefully inside each of the ports, each port contains 2 small pins that should be straight. You will be able to identify a faulty port if it has any bent pins.

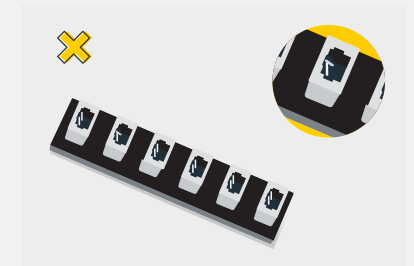
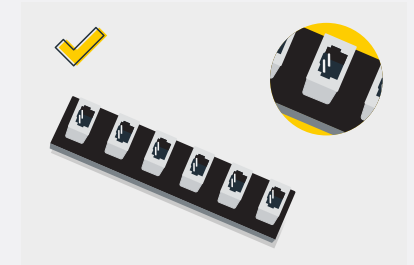
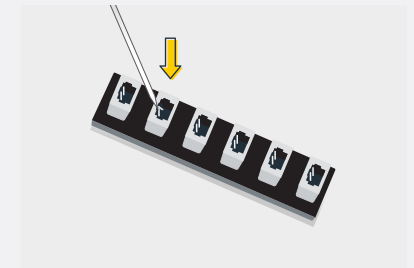



CONTACT US

If you have an enquiry regarding the online shop, our products or a general enquiry please refer to our Frequently Asked Questions webpage here.

Alternatively, you can contact our Customer Services team by visiting our online support portal here.

support.lightmybricks.com

We thank you for purchasing this product and hope you enjoy!



lightmybricks.com