



PROFILES  
FOR MODERN  
BUILDING

# PROTEKTOR UK

DRY LINING PROFILES



# PROTEKTOR

PLASTER PROFILES | DRY WALL PROFILES | EXPANDED METAL

[www.protektor.com](http://www.protektor.com)



## DRY LINING PROFILES



# PROTEKTOR ECO DRY WALL PARTITION PROFILES

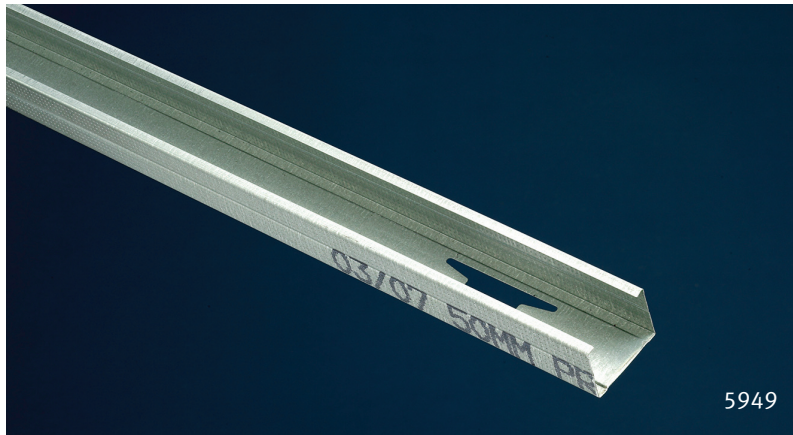

Protektor Eco Stud Partition profiles are a low cost, high quality metal friction fit construction used to form the support frame for non-load bearing plasterboard partitions.

Eco profiles are manufactured to the highest possible quality and fully conform with BS 7364: 1990. Specification for Galvanised steel stud work used in Partitions with screw fixed plasterboard.

Stud profiles can be supplied in four differing widths and a variety of standard lengths to give a wider choice in the variety of builds and applications where required.

## ECO C STUD PROFILES

| Ref          | Description                      | Length (Metres) |     |     |     |     | Qty/Bdl |
|--------------|----------------------------------|-----------------|-----|-----|-----|-----|---------|
|              |                                  | 2.4             | 2.7 | 3.0 | 3.6 | 4.2 |         |
| <b>5949</b>  | 50mm x 0.5mm ECO C Stud Profile  | •               | •   | •   | •   |     | 10      |
| <b>5960</b>  | 60mm x 0.5mm ECO C Stud Profile  |                 |     | •   | •   |     | 10      |
| <b>5971</b>  | 70mm x 0.5mm ECO C Stud Profile  | •               | •   | •   | •   | •   | 10      |
| <b>5991</b>  | 92mm x 0.5mm ECO C Stud Profile  |                 |     | •   | •   | •   | 10      |
| <b>59146</b> | 146mm x 0.6mm ECO C Stud Profile |                 |     | •   | •   | •   | 10      |

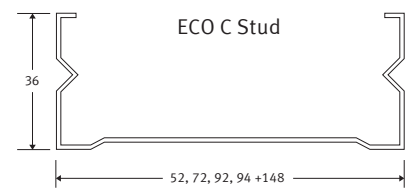

## ECO I STUD PROFILES

| Ref              | Description          | Length (Metres) |     |     |     | Qty/Bdl |
|------------------|----------------------|-----------------|-----|-----|-----|---------|
|                  |                      | 3.0             | 3.6 | 4.2 | 5.0 |         |
| <b>5949 - I</b>  | 50mm I Stud x 0.6mm  | •               | •   |     |     | 10      |
| <b>5960 - I</b>  | 60mm I Stud x 0.6mm  | •               | •   |     |     | 10      |
| <b>5971 - I</b>  | 70mm I Stud x 0.7mm  | •               | •   | •   |     | 10      |
| <b>5991 - I</b>  | 92mm I Stud x 0.9mm  |                 | •   | •   |     | 10      |
| <b>59146 - I</b> | 146mm I Stud x 0.9mm |                 | •   | •   | •   | 10      |

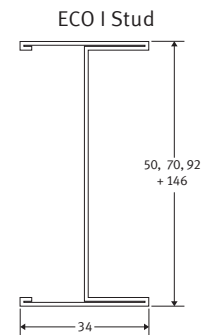

## ECO STANDARD TRACK PROFILES

| Ref               | Description                  | Length (Metres) | Qty/Bdl |
|-------------------|------------------------------|-----------------|---------|
| <b>5851 / 30</b>  | 52mm x 0.5mm Standard Track  | 3.0             | 10      |
| <b>5862 / 30</b>  | 62mm x 0.5mm Standard Track  | 3.0             | 10      |
| <b>5872 / 30</b>  | 72mm x 0.5mm Standard Track  | 3.0             | 10      |
| <b>5894 / 30</b>  | 94mm x 0.5mm Standard Track  | 3.0             | 10      |
| <b>58148 / 30</b> | 148mm x 0.5mm Standard Track | 3.0             | 10      |

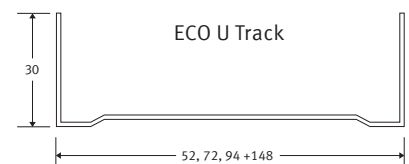

## ECO DEEP TRACK PROFILES

| Ref                  | Description                    | Length (Metres) | Qty/Bdl |
|----------------------|--------------------------------|-----------------|---------|
| <b>5851 / 30-D</b>   | 52mm x 0.5mm Deep Track        | 3.0             | 10      |
| <b>5862 / 30-D</b>   | 62mm x 0.5mm Deep Track        | 3.0             | 10      |
| <b>5872 / 30-D</b>   | 72mm x 0.5mm Deep Track        | 3.0             | 10      |
| <b>5894 / 30-D</b>   | 94mm x 0.5mm Deep Track        | 3.0             | 10      |
| <b>58148 / 30-D</b>  | 148mm x 0.5mm Deep Track       | 3.0             | 10      |
| <b>5851 / 30-ED</b>  | 52mm x 0.7mm Extra Deep Track  | 3.0             | 10      |
| <b>5862 / 30-ED</b>  | 62mm x 0.7mm Extra Deep Track  | 3.0             | 10      |
| <b>5872 / 30-ED</b>  | 72mm x 0.7mm Extra Deep Track  | 3.0             | 10      |
| <b>5894 / 30-ED</b>  | 94mm x 0.7mm Extra Deep Track  | 3.0             | 10      |
| <b>58148 / 30-ED</b> | 148mm x 0.7mm Extra Deep Track | 3.0             | 10      |

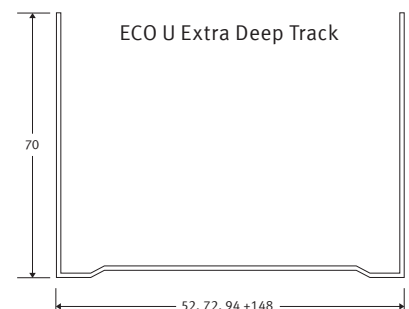
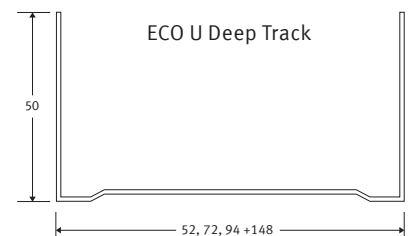

# PROTEKTOR MAXI-TEC DRY WALL PARTITION PROFILES

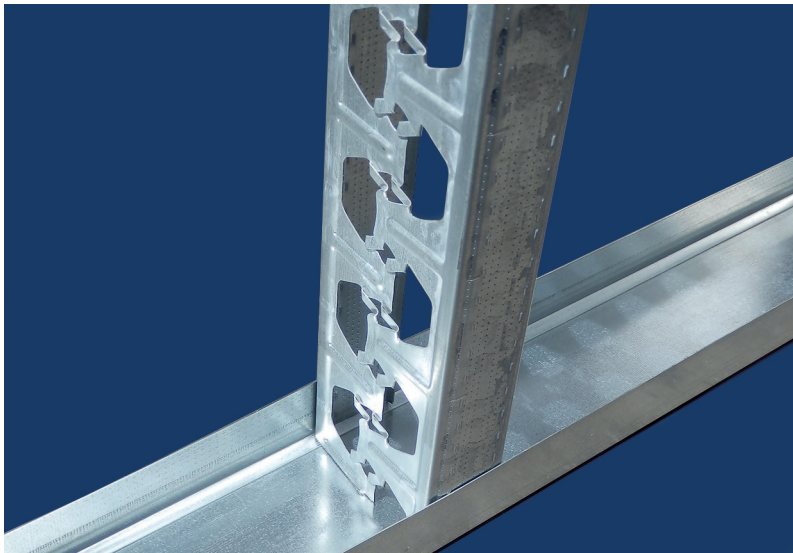

MAXI-TEC is an environmentally friendly steel partition profile range to actively contribute to ensure that sustainable guidelines can be reached and show how ecology, economy and ergonomics can be combined in drywall construction.

The design uses less raw material in the manufacturing process when compared to traditional drywall products, which in turn means reduced energy consumption and less CO2 emissions.

MAXI-TEC stud and track profiles are a low cost, sustainable, high quality metal friction fit construction used to form the support frame for non-load bearing gypsum and specialist board partitions.

## MAXI-TEC BS EN C STUD PROFILES

| Ref   | Description                       | Length (Metres) |     |     |     | Qty/Bdl |
|-------|-----------------------------------|-----------------|-----|-----|-----|---------|
|       |                                   | 2.4             | 3.0 | 3.6 | 4.2 |         |
| 57749 | BS EN C Stud Profile 50mm x 0.5mm | •               |     |     |     | 10      |
| 57775 | BS EN C Stud Profile 70mm x 0.5mm | •               | •   | •   | •   | 10      |
| 57790 | BS EN C Stud Profile 92mm x 0.5mm |                 | •   | •   | •   | 10      |

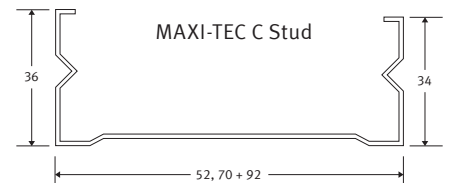

## STANDARD TRACK PROFILES

| Ref       | Description                 | Length (Metres) | Qty/Bdl |
|-----------|-----------------------------|-----------------|---------|
|           |                             | 3.0             |         |
| 5851 / 30 | 52mm x 0.5mm Standard Track | •               | 10      |
| 5872 / 30 | 72mm x 0.5mm Standard Track | •               | 10      |
| 5894 / 30 | 94mm x 0.5mm Standard Track | •               | 10      |

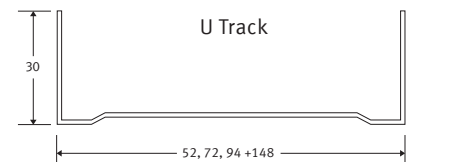

## DEEP TRACK PROFILES

| Ref          | Description                   | Length (Metres) | Qty/Bdl |
|--------------|-------------------------------|-----------------|---------|
|              |                               | 3.0             |         |
| 5851 / 30-D  | 52mm x 0.5mm Deep Track       | •               | 10      |
| 5872 / 30-D  | 72mm x 0.5mm Deep Track       | •               | 10      |
| 5894 / 30-D  | 94mm x 0.5mm Deep Track       | •               | 10      |
| 5851 / 30-ED | 52mm x 0.7mm Extra Deep Track | •               | 10      |
| 5872 / 30-ED | 72mm x 0.7mm Extra Deep Track | •               | 10      |
| 5894 / 30-ED | 94mm x 0.7mm Extra Deep Track | •               | 10      |

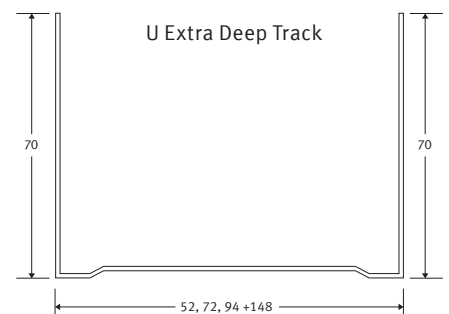
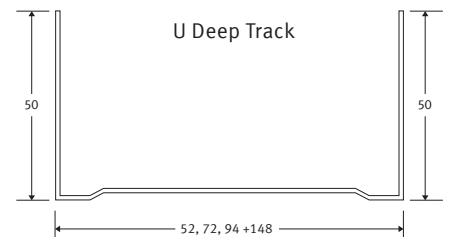

# PROTEKTOR UNIVERSAL LINING PROFILES

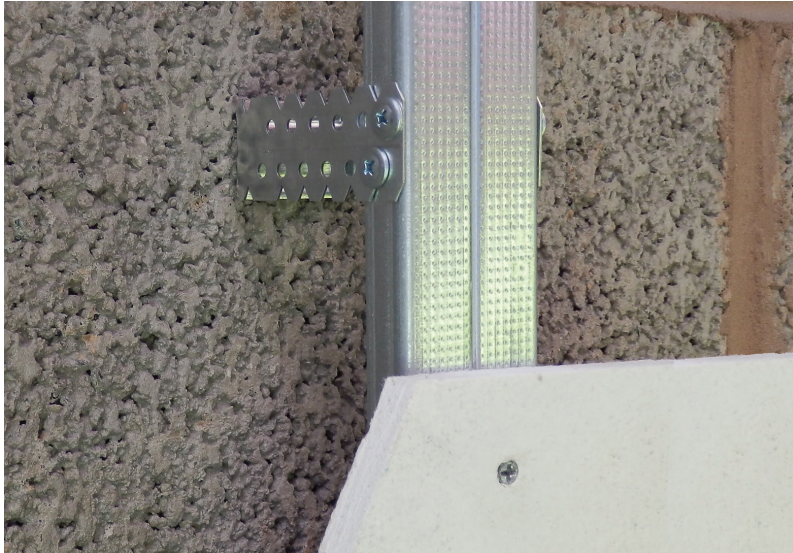

Protektor's Universal Lining system offers a fast, ideal solution for board applications to block/brick wall constructions. The board layer is held away from the supporting wall with our brackets and profiles. The resulting cavity enables the contractor to run services behind the board layer. For build heights and fire/acoustic ratings please contact our technical department. Features an adjustable bracket system.

## FIXING CHART

| Board      | Bracket Centres | Wall Profile Centres | Duty Rating |
|------------|-----------------|----------------------|-------------|
| 1 x 10mm   | 600mm           | 400mm                | Heavy       |
| 1 x 12.5mm | 600mm           | 400mm                | Severe      |
| 1 x 15mm   | 800mm           | 400mm                | Severe      |
| 2 x 10mm   | 800mm           | 400mm                | Severe      |
| 2 x 12.5mm | 800mm           | 600mm                | Severe      |
| 2 x 15mm   | 800mm           | 600mm                | Severe      |



## WALL LINING PROFILES

| Ref  | Description  | Length (Metres) |     |     | Qty/Pack |
|------|--|-----------------|-----|-----|----------|
|      |  | 2.4             | 3.0 | 3.6 |          |
| PP1  | CD Profile 47 x 17 x 0.5mm                             | •               | •   | •   | 10       |
| 5109 | CD Profile 47 x 17 x 0.6mm                             |                 | •   |     | 10       |
| PP20 | U Perimeter / Track Profile                            |                 |     | •   | 10       |
| 6168 | 75mm Direct Fix Hanger                                 |                 |     |     | 100      |
| 6166 | 125mm Direct Fix Hanger                                |                 |     |     | 100      |
| 6125 | CD Profile Connector                                   |                 |     |     | 100      |
| 6340 | 95mm Timber Hanger                                     |                 |     |     | 100      |
| 6341 | 190mm Timber Hanger                                    |                 |     |     | 100      |
| PP25 | Column Encasement clip for use with PP1 & 5109         |                 |     |     | 100      |
| 6248 | Hammer fix Impact dowels for track profiles 40mm x 6mm |                 |     |     | 100      |

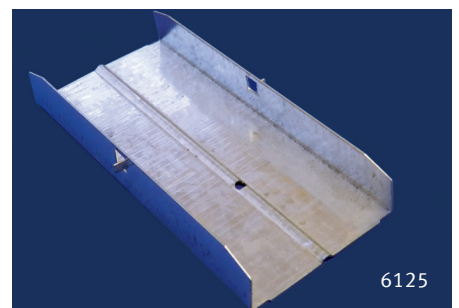
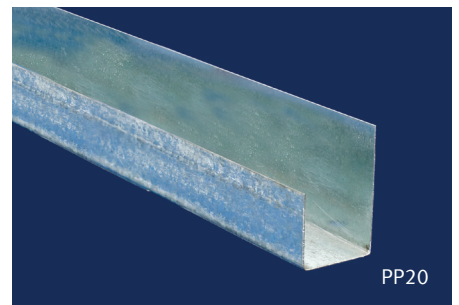

# PROTEKTOR ACOUSTIC STUD PROFILES

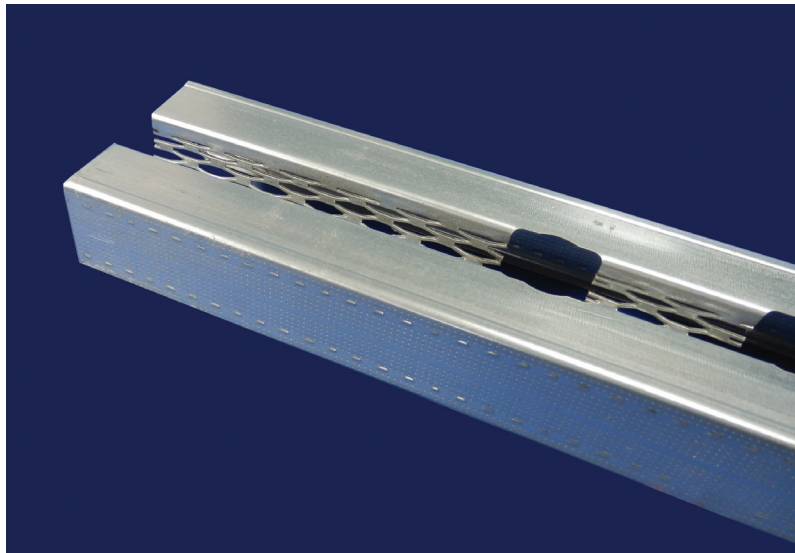

The Protektor Acoustic Stud profiles are manufactured for areas where a higher level of acoustic performance is required in a single non load bearing stud partition construction. Manufactured from 0.6mm Galvanised Steel the unique stud design allows the sound transmission to be interrupted between the stud wall. Available with a wider fixing face for ease of installation the profile.

## ACOUSTIC STUD

| Ref  | Description                              | Length (Metres) |     |     | Qty/Pack |
|------|--|-----------------|-----|-----|----------|
|      |  | 3.0             | 3.5 | 4.0 |          |
| 5660 | DIN Acoustic Stud Profile 70mm x 0.6mm   | •               | •   |     | 4        |
| 5615 | DIN Acoustic Stud Profile 73.8mm x 0.6mm | •               | •   |     | 4        |
| 5677 | DIN Acoustic Stud Profile 92mm x 0.6mm   | •               | •   | •   | 4        |
| 5616 | DIN Acoustic Stud Profile 100mm x 0.6mm  | •               | •   | •   | 4        |
| 6411 | PVC Grommits to suit Acoustic Stud       |                 |     |     | 16       |

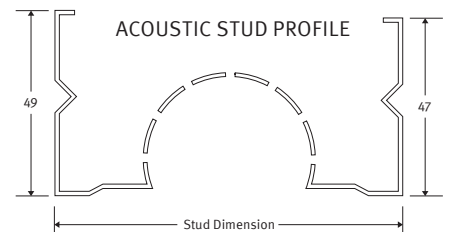

## STANDARD TRACK

| Ref       | Description                             | Length (Metres) | Qty/Pack |
|-----------|---|-----------------|----------|
|           |   | 4.0             |          |
| 5233      | DIN Track Profile 40 x 75 x 40 x 0.6mm  | •               | 8        |
| 5234      | DIN Track Profile 40 x 100 x 40 x 0.6mm | •               | 8        |
| 5872 / 30 | 72mm x 0.5mm Standard Track             | •               | 10       |
| 5894 / 30 | 94mm x 0.5mm Standard Track             | •               | 10       |

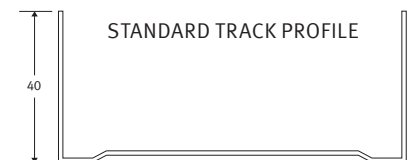

## DEEP TRACK

| Ref         | Description                             | Length (Metres) | Qty/Pack |
|-------------|---|-----------------|----------|
|             |   | 4.0             |          |
| 5237        | DIN Track Profile 60 x 75 x 60 x 0.6mm  | •               | 4        |
| 5238        | DIN Track Profile 60 x 100 x 60 x 0.6mm | •               | 4        |
| 5872 / 30-D | 72mm x 0.5mm Deep Track                 | •               | 10       |
| 5894 / 30-D | 94mm x 0.5mm Deep Track                 | •               | 10       |

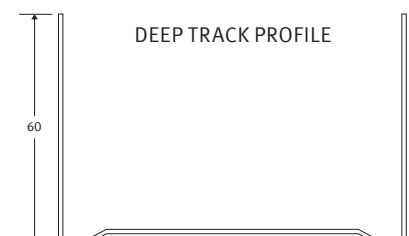

# PROTEKTOR DIN STANDARD STUD PROFILES

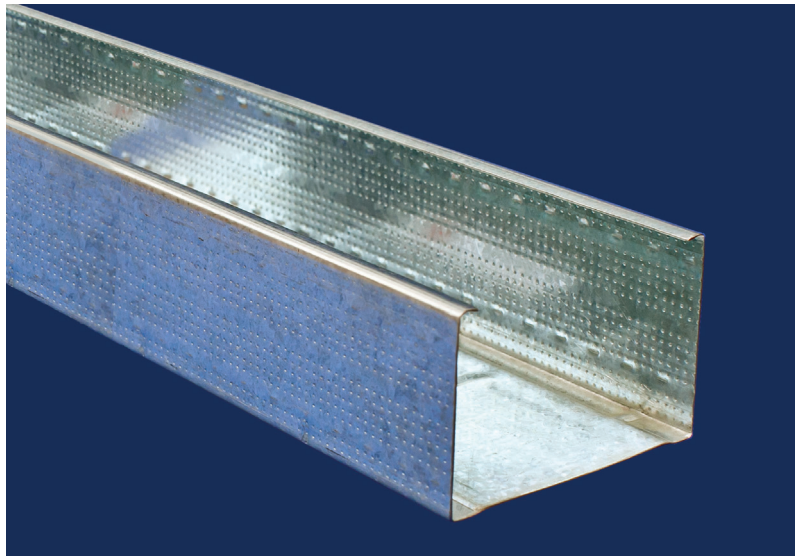

Protektor's unique range of DIN profiles for partitions are designed and manufactured to meet the most stringent of design requirements on site and provide the following benefits:

- 50mm fixing face
- Less margin for error when screw fixing
- Speedy installation
- Greater build heights whilst maintaining a narrow wall construction.

The 50mm fixing face of Protektor DIN profiles, manufactured in 0.6mm thick steel, ensures that plasterboard, fibre board or cement particle board are installed efficiently.

They ensure that the build provides both robust construction and assist in maintaining the original performance criteria planned at design stage.

## 0.6mm STUD PROFILES

| Ref  | Description                    | Length (Metres) |     |     |     |     |     | Qty/Pack |
|------|--------------------------------|-----------------|-----|-----|-----|-----|-----|----------|
|      |                                | 3.0             | 3.5 | 4.0 | 4.5 | 5.0 | 6.0 |          |
| 5211 | DIN Stud Profile 48.8 x 0.6mm  | •               | •   | •   |     |     |     | 8        |
| 5215 | DIN Stud Profile 73.8 x 0.6mm  | •               | •   | •   | •   | •   | •   | 8        |
| 5216 | DIN Stud Profile 98.8 x 0.6mm  | •               | •   | •   | •   | •   | •   | 8        |
| 5141 | DIN Stud Profile 123.8 x 0.6mm | •               | •   | •   | •   | •   | •   | 8        |
| 5224 | DIN Stud Profile 148.8 x 0.6mm | •               | •   | •   | •   | •   | •   | 4        |

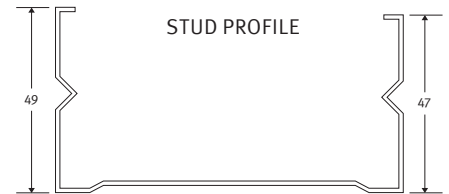

## STANDARD TRACK

| Ref  | Description                             | Length (Metres) |     | Qty/Pack |
|------|---|-----------------|-----|----------|
|      |   | 3.0             | 4.0 |          |
| 5230 | DIN Track Profile 40 x 50 x 40 x 0.6mm  |                 | •   | 8        |
| 5233 | DIN Track Profile 40 x 75 x 40 x 0.6mm  |                 | •   | 8        |
| 5234 | DIN Track Profile 40 x 100 x 40 x 0.6mm |                 | •   | 8        |
| 5248 | DIN Track Profile 40 x 125 x 40 x 0.6mm | •               |     | 8        |
| 5247 | DIN Track Profile 40 x 150 x 40 x 0.6mm | •               |     | 4        |

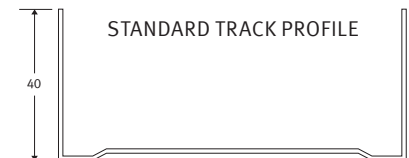

## DEEP TRACK

| Ref  | Description                             | Length (Metres) |     | Qty/Pack |
|------|---|-----------------|-----|----------|
|      |   | 3.0             | 4.0 |          |
| 5236 | DIN Track Profile 60 x 50 x 60 x 0.6mm  |                 | •   | 4        |
| 5237 | DIN Track Profile 60 x 75 x 60 x 0.6mm  |                 | •   | 4        |
| 5238 | DIN Track Profile 60 x 100 x 60 x 0.6mm |                 | •   | 4        |
| 5239 | DIN Track Profile 60 x 125 x 60 x 0.6mm | •               |     | 4        |
| 5240 | DIN Track Profile 60 x 150 x 60 x 0.6mm | •               |     | 4        |

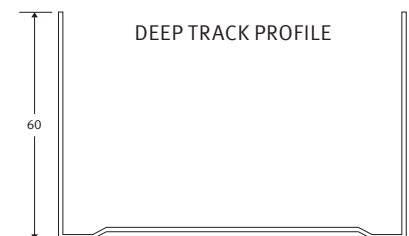

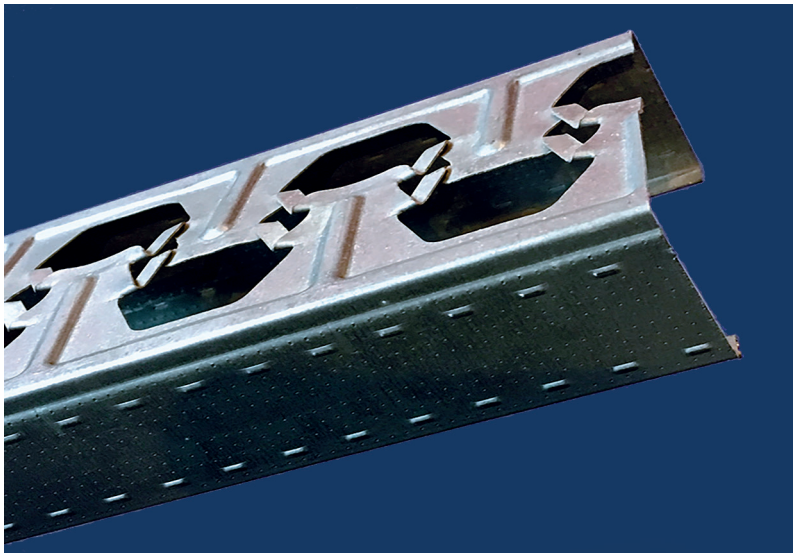

MAXI-TEC is an environmentally friendly steel partition profile range to actively contribute to ensure that sustainable guidelines can be reached and show how ecology, economy and ergonomics can be combined in drywall construction.

The design uses less raw material in the manufacturing process when compared to traditional drywall products, which in turn means reduced energy consumption and less CO2 emissions.

MAXI-TEC stud and track profiles are a low cost, sustainable, high quality metal friction fit construction used to form the support frame for non-load bearing gypsum and specialist board partitions.

## 0.6mm STUD PROFILES

| Ref  | Description                   | Length (Metres) |     |     |     |     | Qty/Pack |
|------|-------------------------------|-----------------|-----|-----|-----|-----|----------|
|      |                               | 2.5             | 3.0 | 3.5 | 4.0 | 4.5 |          |
| 5011 | DIN Stud Profile 48.8 x 0.6mm | •               | •   | •   | •   |     | 8        |
| 5015 | DIN Stud Profile 73.8 x 0.6mm | •               | •   | •   | •   | •   | 8        |
| 5016 | DIN Stud Profile 98.8 x 0.6mm | •               | •   | •   | •   | •   | 8        |

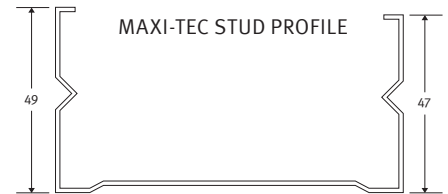

## STANDARD TRACK

| Ref  | Description                             | Length (Metres) | Qty/Pack |
|------|---|-----------------|----------|
|      |   | 4.0             |          |
| 5230 | DIN Track Profile 40 x 50 x 40 x 0.6mm  | •               | 8        |
| 5233 | DIN Track Profile 40 x 75 x 40 x 0.6mm  | •               | 8        |
| 5234 | DIN Track Profile 40 x 100 x 40 x 0.6mm | •               | 8        |

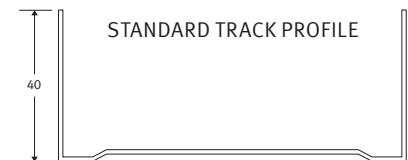

## DEEP TRACK

| Ref  | Description                             | Length (Metres) | Qty/Pack |
|------|---|-----------------|----------|
|      |   | 4.0             |          |
| 5236 | DIN Track Profile 60 x 50 x 60 x 0.6mm  | •               | 4        |
| 5237 | DIN Track Profile 60 x 75 x 60 x 0.6mm  | •               | 4        |
| 5238 | DIN Track Profile 60 x 100 x 60 x 0.6mm | •               | 4        |

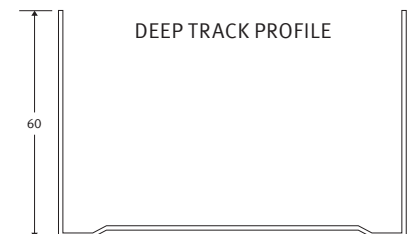





The reduction in flanking transmission is of primary importance when planning/designing a partition or ceiling construction. Flanking transmission is defined as sound from a source room but not via a common building element.

Protektor acoustic foam strip is designed to isolate the track or stud profiles from the substrate hence reducing the possibility of flanking transmission through the frame. Installed on the underside of the track when laying out and to the back of the stud profile when starting a frame from an existing wall or flat surface.

The foam strips are supplied in 30 metre rolls and are self adhesive on one side. They can be easily applied on site or, where requested at time of order, it can be pre-applied to the tracks ready for use on site.

## INTUMESCENT AND ACOUSTIC SEALANT

| Ref          | Description                     | Size   |
|--------------|---------------------------------|--------|
| <b>54410</b> | Fire Rated and Acoustic Sealant | 300 ml |
| <b>54411</b> | Fire Rated and Acoustic Sealant | 600 ml |

## ISOLATION FOAM STRIP

| Ref         | Description               | Length (metres) | Dim A (mm) |
|-------------|---------------------------|-----------------|------------|
| <b>6194</b> | 45mm Foam Isolation Strip | 30              | 45         |
| <b>6195</b> | 70mm Foam Isolation Strip | 30              | 70         |
| <b>6196</b> | 95mm Foam Isolation Strip | 30              | 95         |

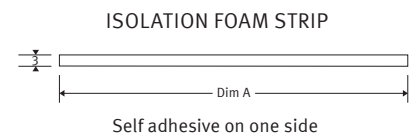

## ACOUSTIC FOAM OPEN CELL STRIP

| Ref          | Description                   | Length (metres) | Dim A (mm) |
|--------------|-------------------------------|-----------------|------------|
| <b>54448</b> | 45mm wide Acoustic Foam Strip | 10              | 45         |
| <b>54449</b> | 70mm wide Acoustic Foam Strip | 10              | 70         |
| <b>54450</b> | 95mm wide Acoustic Foam Strip | 10              | 95         |

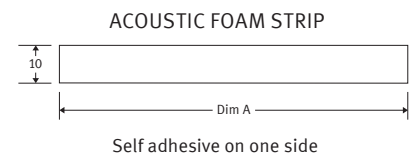

## FLANKING STRIP

| Ref          | Description   | Length (metres) | Dim A (mm) |
|--------------|---|-----------------|------------|
| <b>54437</b> | 100mm wide x 5mm Flanking strip                       | 50              | 100        |
| <b>54438</b> | 100mm wide x 5mm Flanking strip<br>c/ Polythene skirt | 50              | 100        |
| <b>54439</b> | 100mm wide x 10mm Flanking strip                      | 50              | 100        |

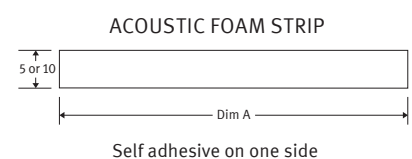

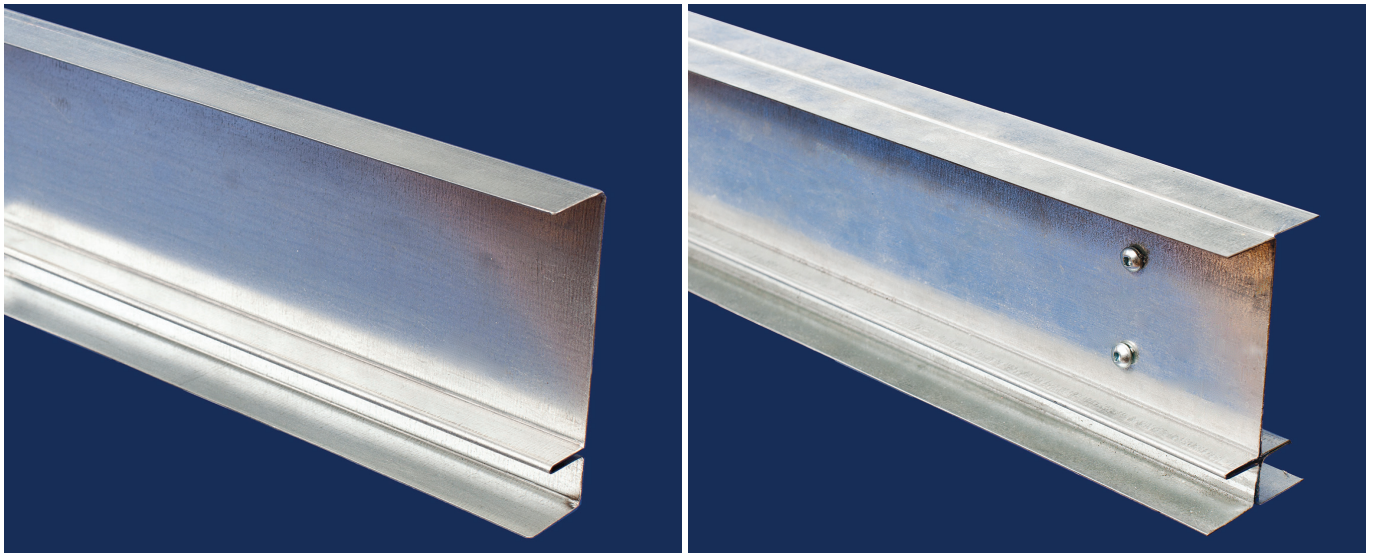

Protektor has developed a bespoke solution for shaftwall constructions, designed specifically for areas where a contractor cannot access both side of the partition. Our E profiles enable the contractor to construct the partition all from one side. The E profile holds the shaft side board in place without the need for screw fixings. The non shaft side boards are then attached with screws to the profile in the conventional manner.

This system has been tested for both fire, acoustics and build height by independent testing houses. For full details on this solution and the construction detailing required for either F60 or F120 Fire Ratings, please contact our technical department.

## SHAFTWALL PROFILES - to suit 15mm board

| Ref  | Description                                | Length (Metres) |     |     |     |     | Qty/Pack |
|------|--|-----------------|-----|-----|-----|-----|----------|
|      |  | 3.0             | 4.0 | 4.5 | 5.0 | 6.0 |          |
| 5910 | Shaftwall E Profile 98.8 x 0.7mm           |                 | •   |     | •   |     | 4        |
| 5980 | Shaftwall E Profile 98.8 x 1.0mm           |                 |     |     |     | •   | 4        |
| 5234 | Track Profile 40 x 100 x 40 x 0.6mm        |                 | •   |     |     |     | 8        |
| 5238 | Deep Track Profile 60 x 100 x 60 x 0.6mm   |                 | •   |     |     |     | 4        |
| 5161 | Angle Profile 25 x 25 x 0.60mm             | •               |     |     |     |     | 10       |
| 6239 | Steel Framing Screw 4.2 x 13mm             |                 |     |     |     |     | 1,000    |
| 6236 | Steel Framing Screw Drill Point 13 x 4.2mm |                 |     |     |     |     | 1,000    |
| 6196 | Foam Strip 95 x 30 metres                  |                 |     |     |     |     | 1        |

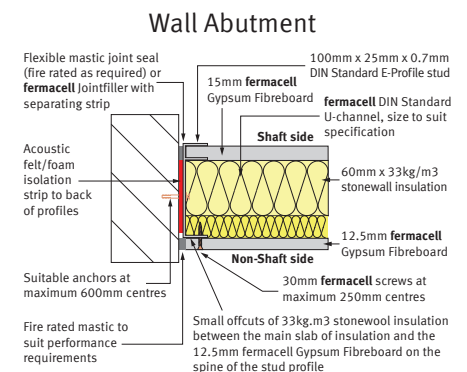
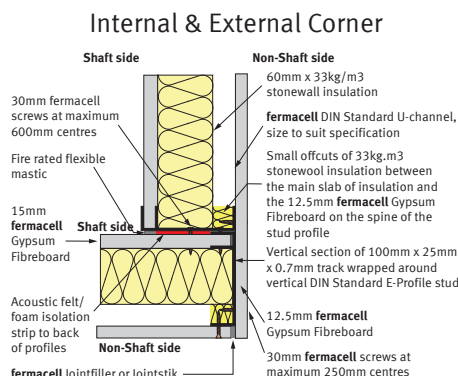
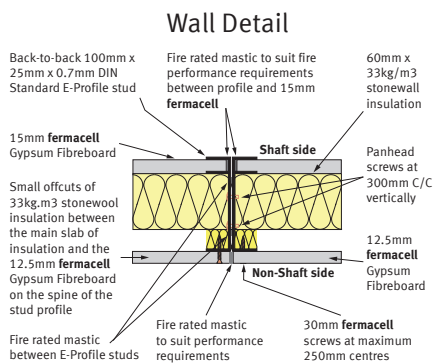
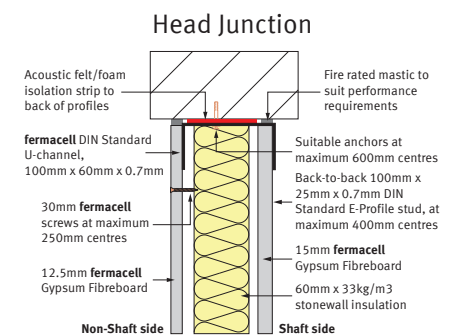
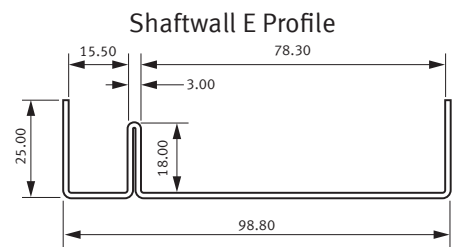

# PROTEKTOR HEAVY DUTY WALL LINING PROFILES



The VCD wall lining system offers a fast, simple to build, method of constructing a steel frame to support a board lining system to solid wall constructions when greater thermal and/or sound requirements are needed.

Protektor's VCD system can be built to a height of up to 20 metres. This heavy duty system can accommodate greater loads than a conventional wall lining system.

Brackets allow for adjustment of cavity size to allow for increased sound and thermal insulation.

5120 board rail has a 60mm fixing face, improving speed and accuracy of installation.

A central nip in the fixing face is designed for accurate board alignment.

## VCD LINING PROFILES

| Ref  | Description  | Length (Metres) | Qty/Pack |
|------|--|-----------------|----------|
|      |  | 3.0             |          |
| 5120 | CD Profile 60 x 27 x 0.6mm                             | •               | 12       |
| 5244 | U Perimeter / Track Profile                            | •               | 16       |
| 6156 | 30mm Direct Fix Hanger                                 |                 | 100      |
| 6158 | 60mm Direct Fix Hanger                                 |                 | 100      |
| 6157 | 125mm Direct Fix Hange                                 |                 | 100      |
| 6078 | Profile Connector                                      |                 | 100      |
| 6141 | Column Encasement clip for use with 5120               |                 | 100      |
| 6248 | Hammer fix impact dowels for track profiles 40mm x 6mm |                 | 100      |

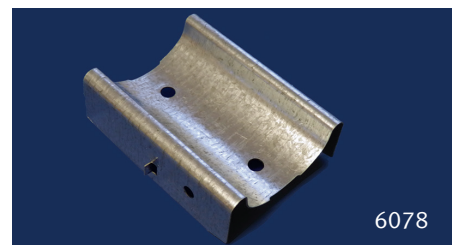
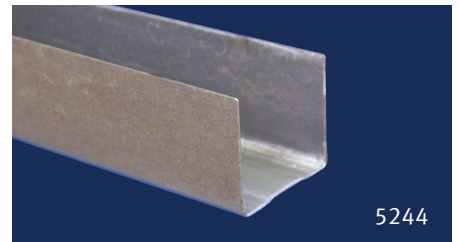
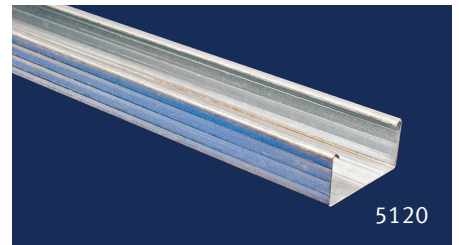



The Protektor Door Reinforcement system is designed to accommodate a range of door weights.

Our system can accept single or double doors weighing 25kg to over 60kg. The 2mm reinforced door profile has been manufactured with slots running down the web of the profile.

These slots are designed to ease the installation process, making brackets and head details fast and simple to construct, using our (nut and bolt) fixing sets.

Construction data sheets are available upon request from the Protektor technical team.

## DOOR REINFORCEMENT PROFILE

| Ref   | Description                                | Length (Metres) | Qty/Pack |
|-------|--|-----------------|----------|
|       |  | 4.0             |          |
| 5129  | Door reinforcement profile 48.8mm x 2.0mm  | *               | 4        |
| 54415 | Door reinforcement profile 70mm x 2.0mm    | *               |          |
| 5130  | Door reinforcement profile 73.8mm x 2.0mm  | *               | 4        |
| 54416 | Door reinforcement profile 92mm x 2.0mm    | *               |          |
| 5131  | Door reinforcement profile 98.8mm x 2.0mm  | *               | 4        |
| 5132  | Door reinforcement profile 123.8mm x 2.0mm | *               | 4        |
| 5140  | Door reinforcement profile 148.8mm x 2.0mm | *               | 4        |

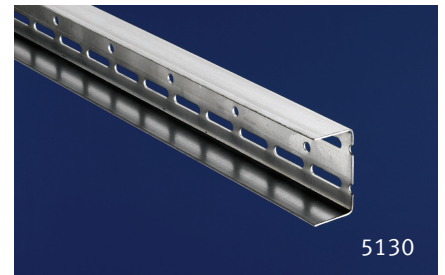

## DOOR REINFORCEMENT BRACKETS AND ACCESSORIES

| Ref  | Description  | Qty/Pack |
|------|--|----------|
| 6185 | 40mm x 2.0mm Fixing Angles to suit 5129                | 25       |
| 6183 | 68mm x 2.0mm Fixing Angles to suit 54415, 54416 & 5130 | 25       |
| 6182 | 93mm x 2.0mm Fixing Angles for 5131                    | 25       |
| 6190 | 119mm x 2.0mm Fixing Angles for 5132 & 5140            |          |
| 6203 | Fixing Set (nut, washer & bolt)- M8 x 20mm             | 100      |

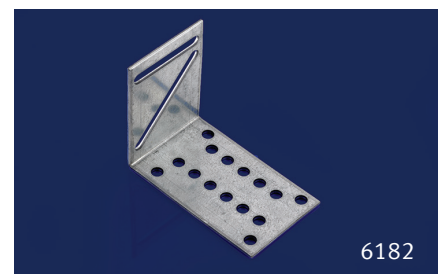



# PROTEKTOR UK

Protektor UK Limited,  
Protektor House,  
Frederick Road,  
Hoo Farm Industrial Estate,  
Kidderminster,  
Worcestershire,  
England, DY11 7RA

Tel: 01562 515200

Fax: 01562 515116

Sales Enquiries: [sales@protektor.co.uk](mailto:sales@protektor.co.uk)  
Technical Queries & Support: [technical@protektor.co.uk](mailto:technical@protektor.co.uk)  
Website: [www.protektor.com](http://www.protektor.com)