

# Package Includes

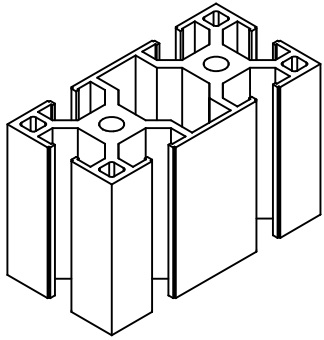

780mm x 2

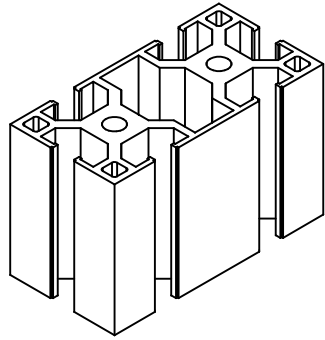

580mm x 2

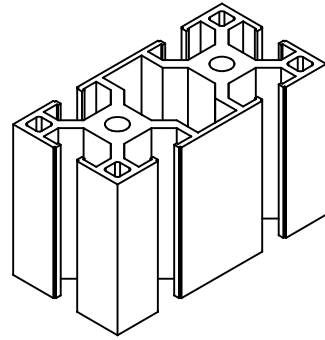

500mm x 2

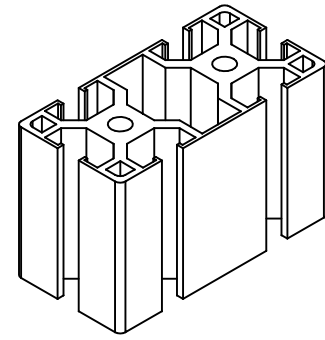

500mm x 2

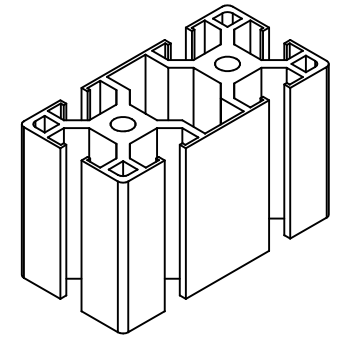

420mm x 1

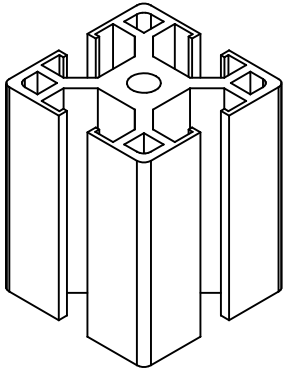

580mm x 2

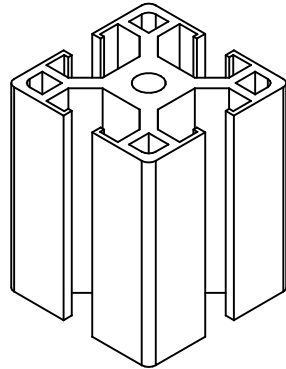

500mm x 2

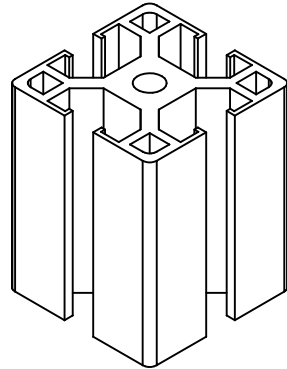

320mm x 3

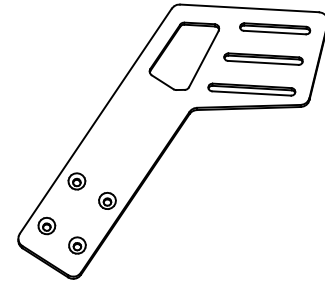

x 2

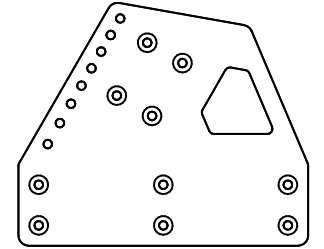

x 2

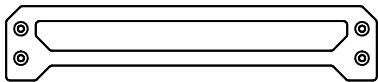

x 1

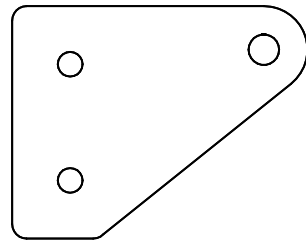

Optional Level Feet x 4

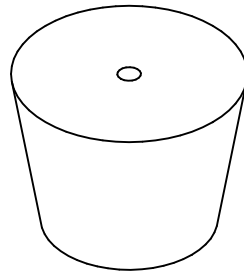

x 6

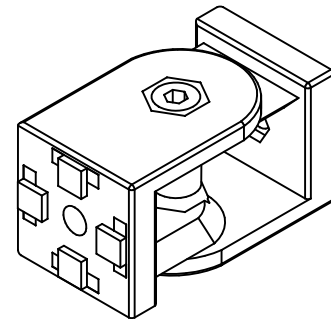

x 2

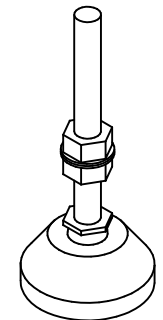

Optional Level Feet x 4

# Package Includes

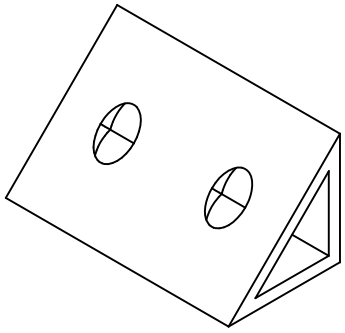

4080 x 10

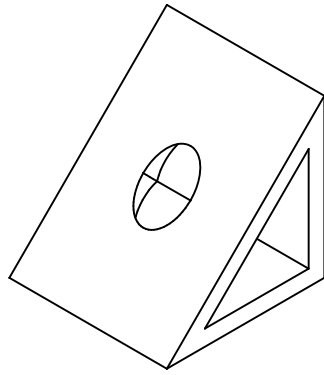

4040 x 10

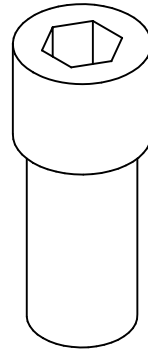

M8 x 25mm x 16

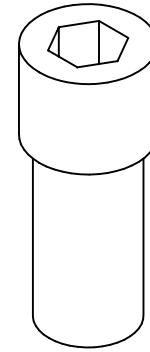

M8 x 16mm x 44

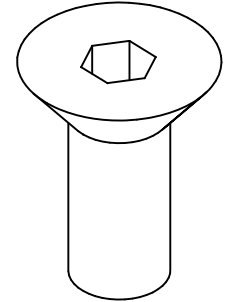

M8 x 20mm x 32

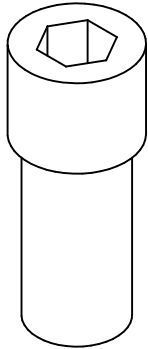

M6 x 16mm x 6

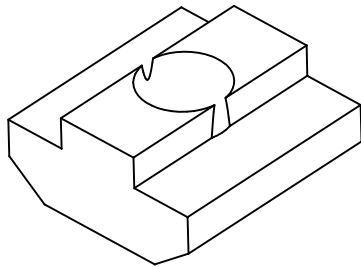

M8 x 60

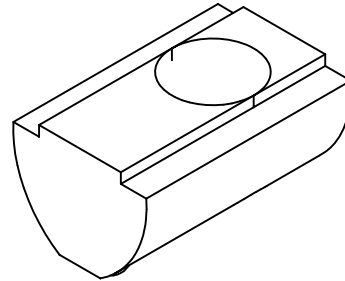

M8 x 12

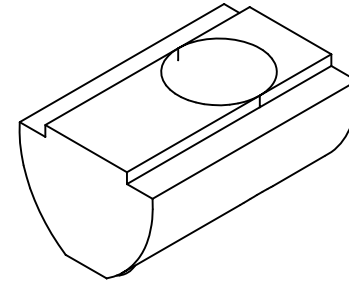

M6 x 6

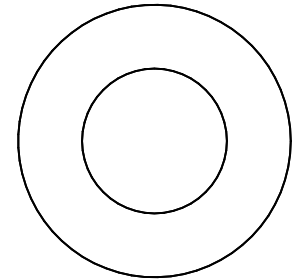

x 2

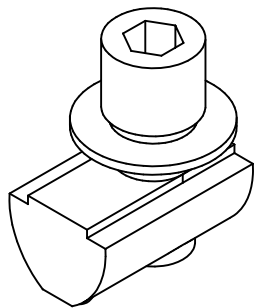

Optional Level Feet x 8



4080 x 6

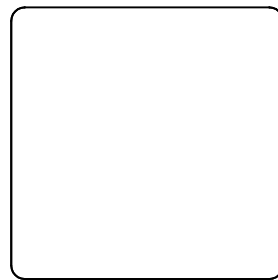

4040 x 6

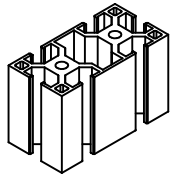

780mm x 2

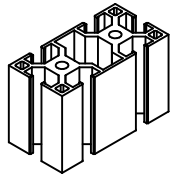

580mm x 2

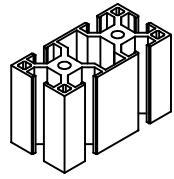

500mm x 2

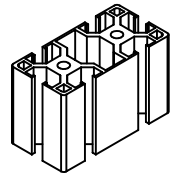

420mm x 1

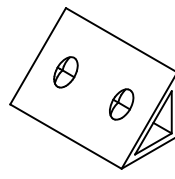

4080 x 10



M8 x 25mm x 16



M8 x 16mm x 24

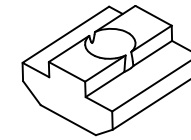

M8 x 24

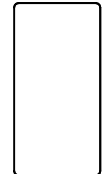

x 2

Follow the hex head bolt color code and position

# GT2 Structure Fasteners Pack

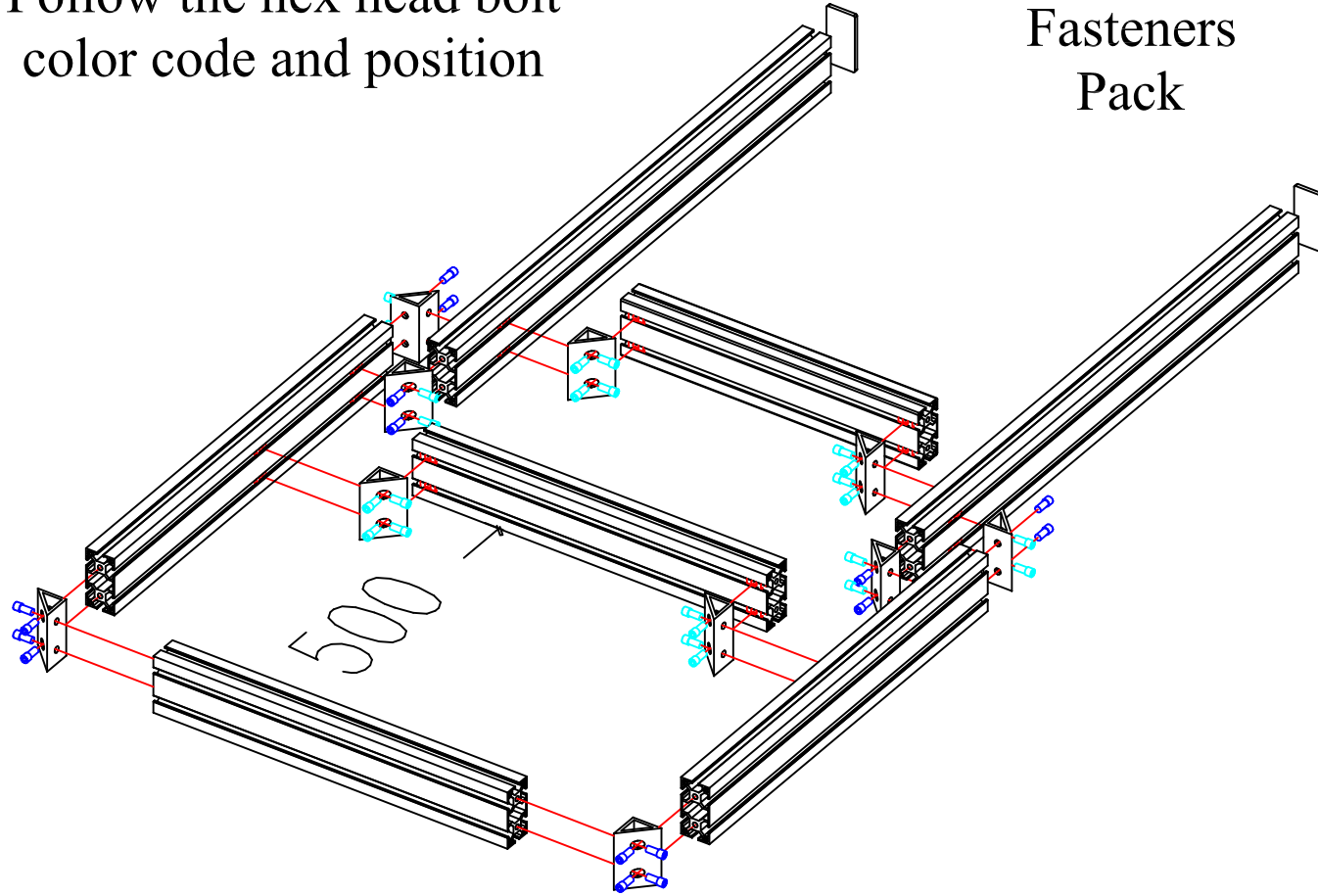
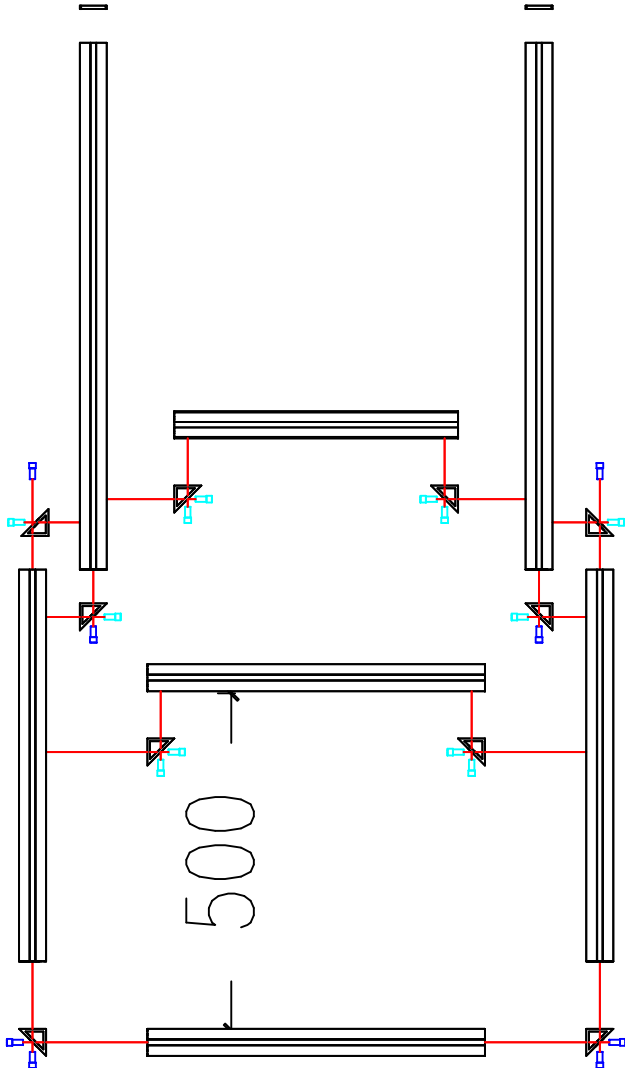

please install all the end cap after full structure installation, except the bottom end cap of the vertical profiles

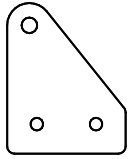

x 4

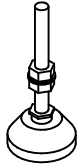

x 4

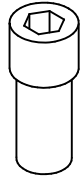

M8 x 25mm x 8

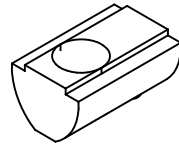

M8 x 8

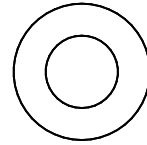

M8 x 8

# Level Feet Fasteners Pack Optional Version

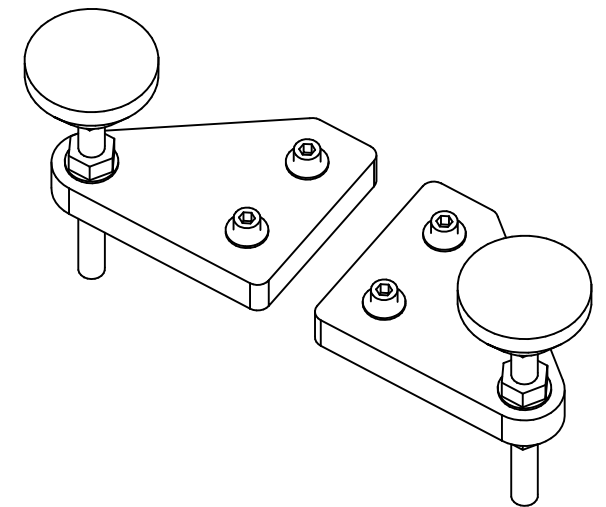
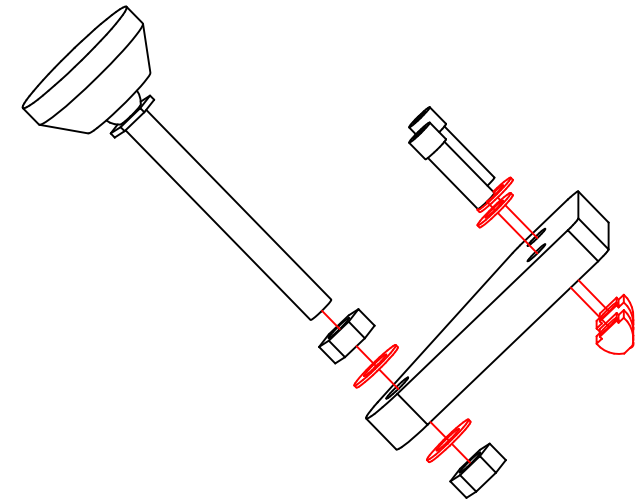
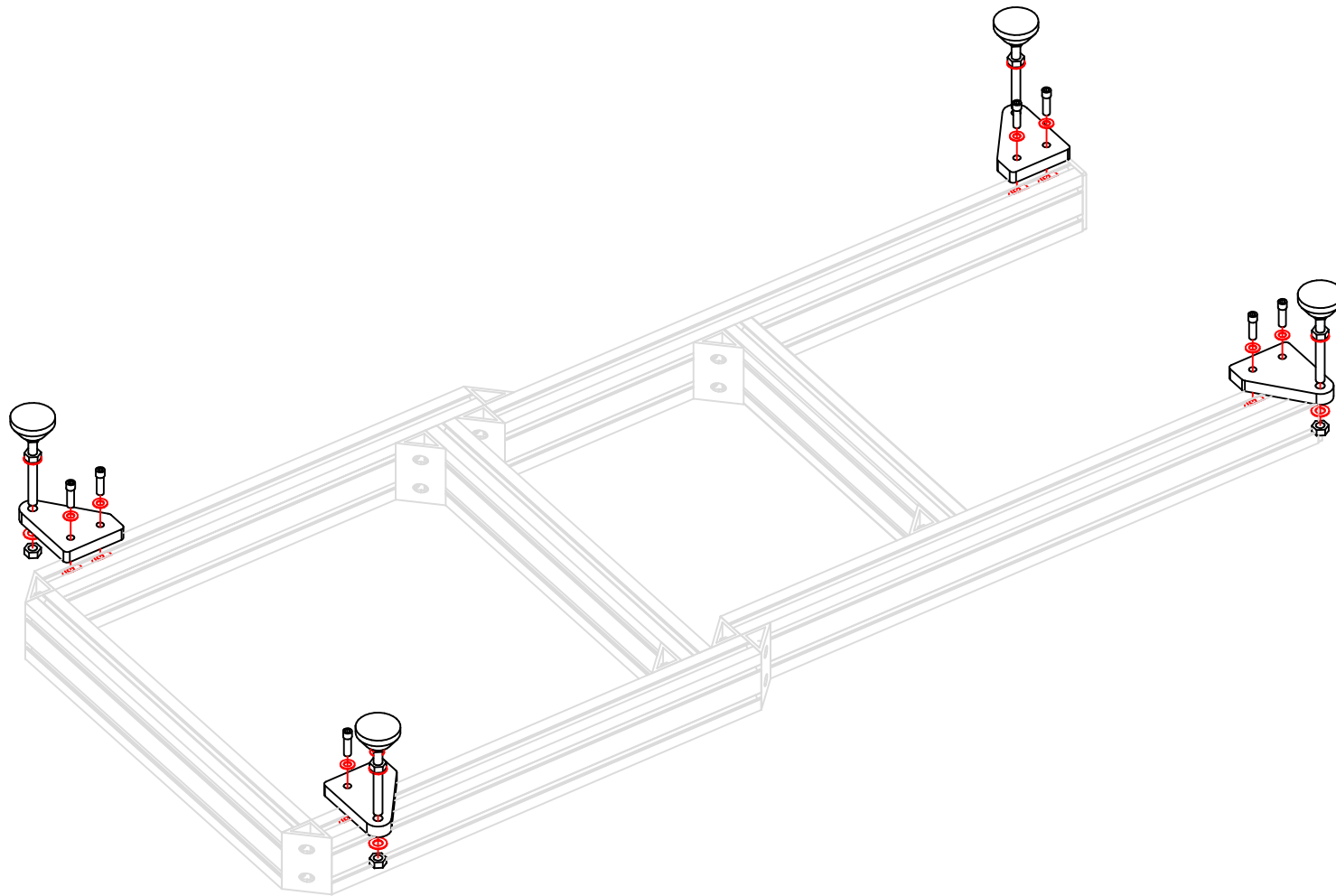

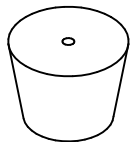

x 6

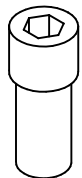

x 6

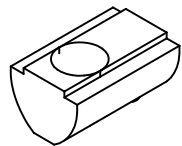

M6 x 6

# Rubber Feet Fasteners Pack Standard Version

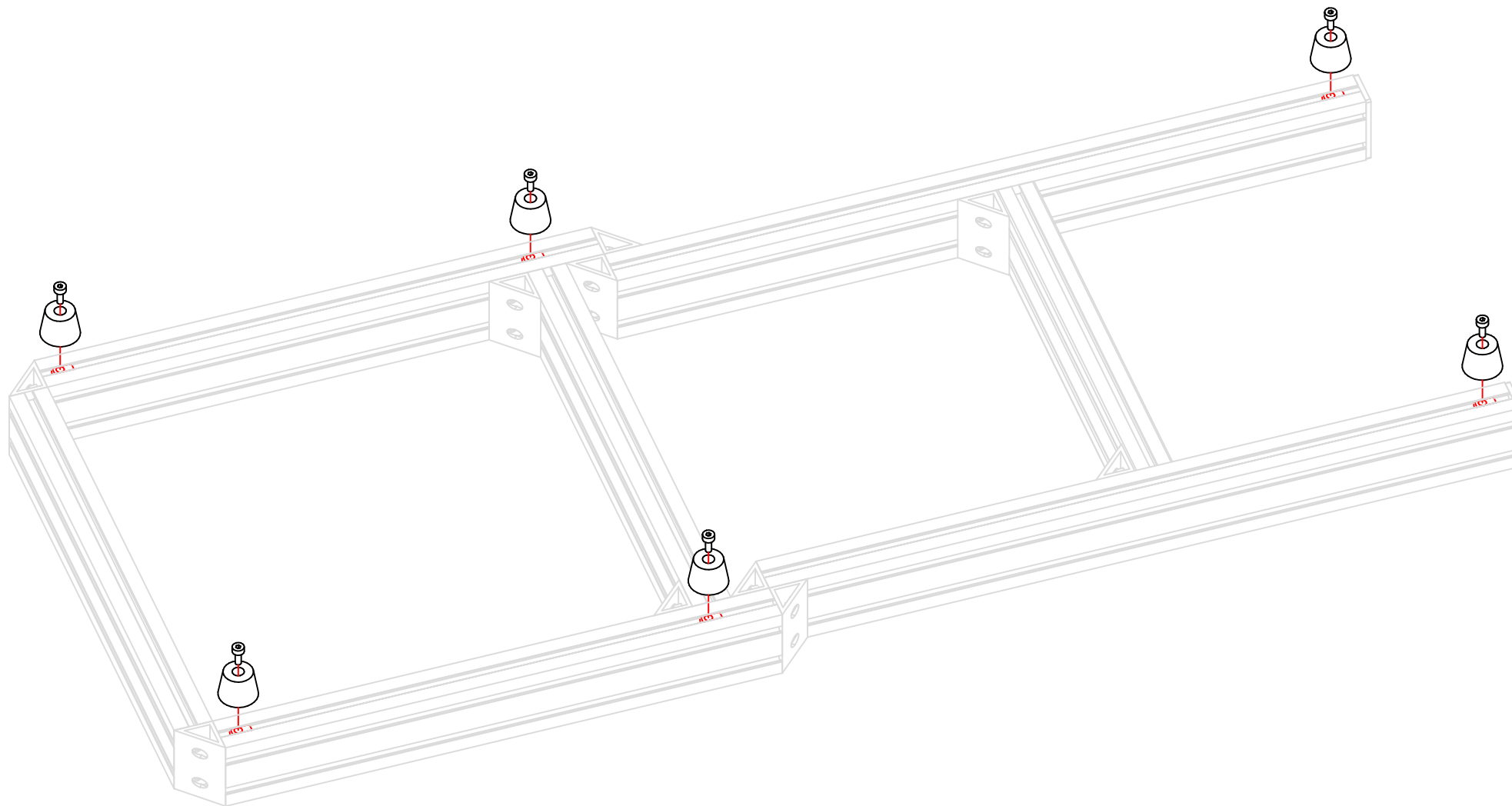

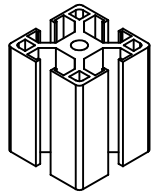

580mm x 2

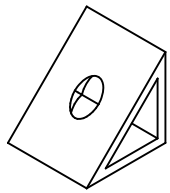

x 4

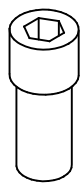

M8 x 16mm x 8

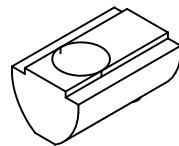

M8 x 8

# GT2 Structure Fasteners Pack

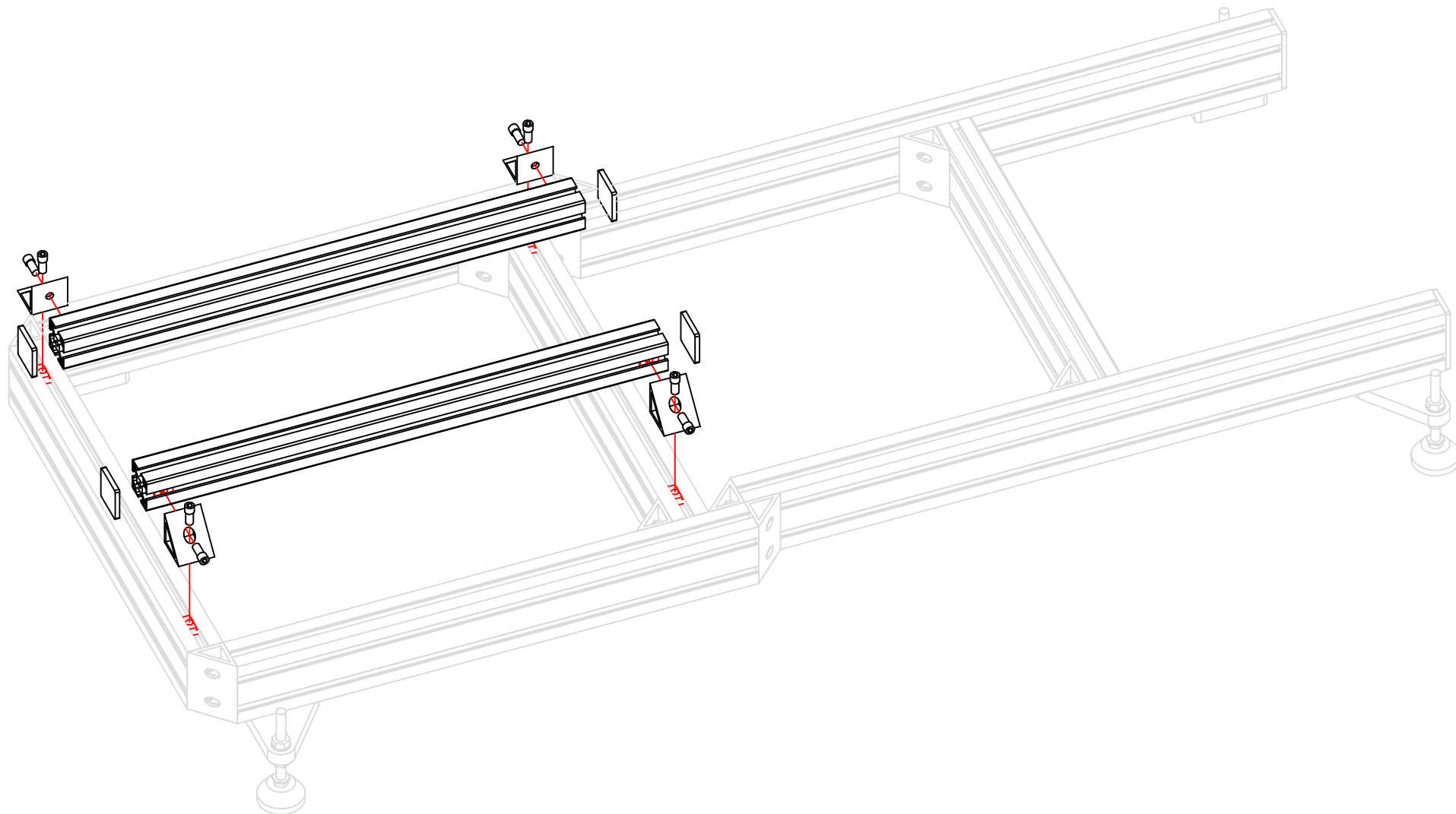

# GT2 Pedal Deck Triangle set ( left and right ) Fasteners Pack

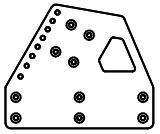

x 2

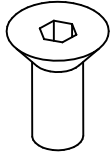

M8 x 20mm x  
20

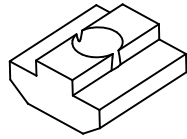

M8 x 20

keep the side nut loose to slide  
the vertical profile through

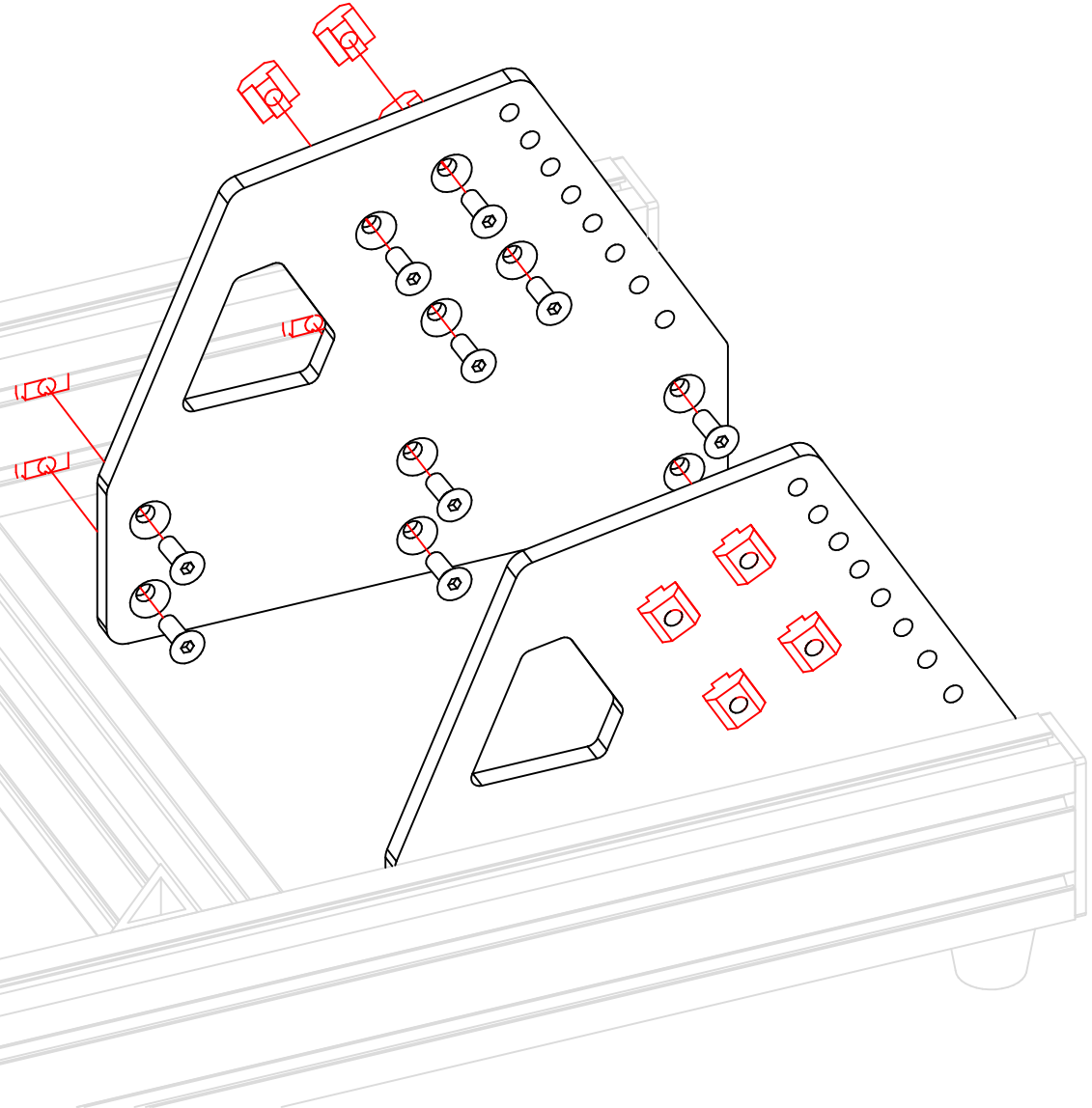



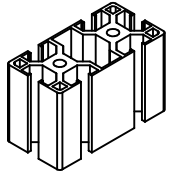

500mm x 2



x 4

don't forget to install the bottom end cap of the vertical profiles before you tight the bolts

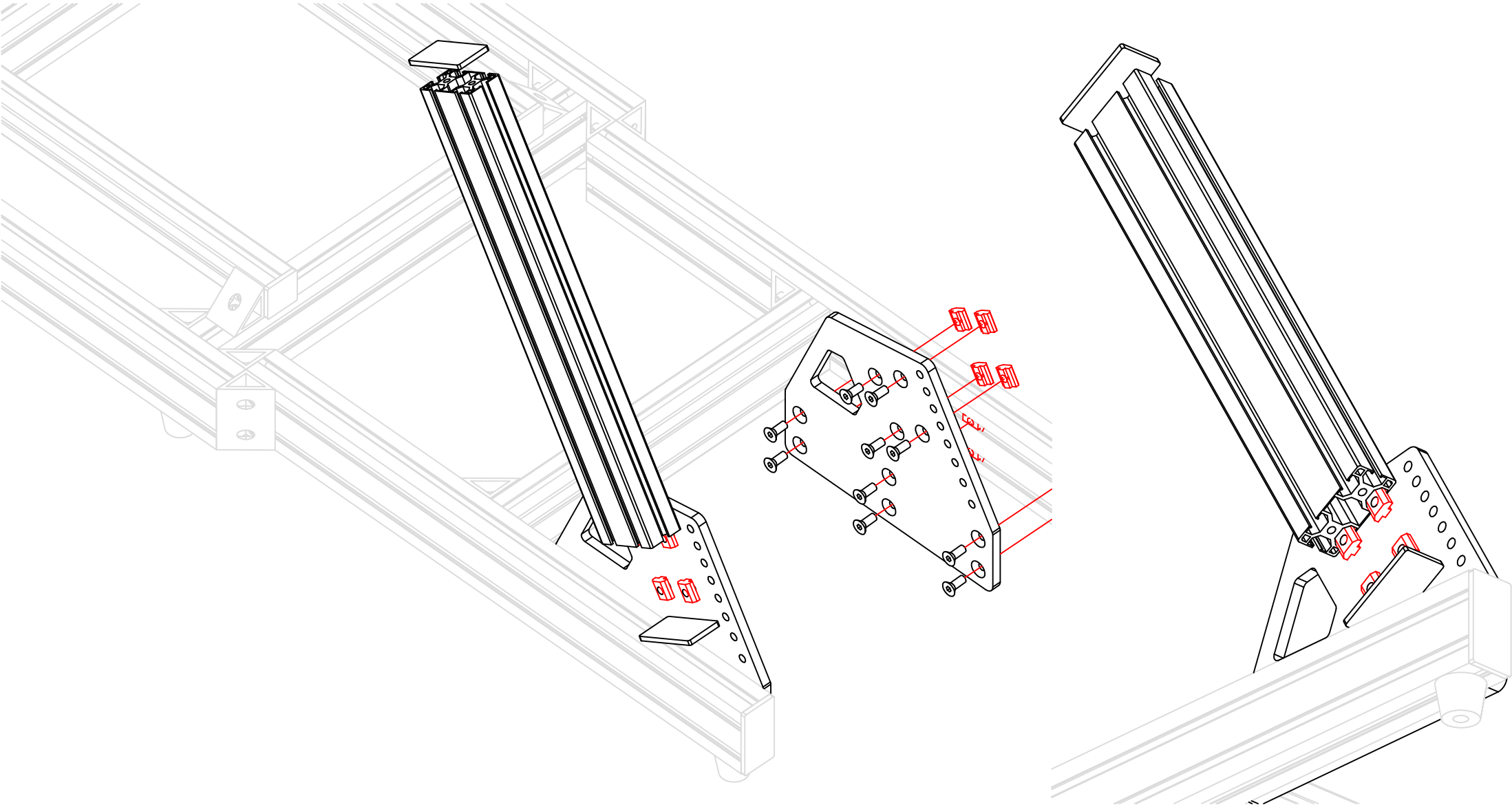

# GT2 Front Mount Bracket Plates and Front Brace Mount Fasteners Pack

attache the bolts and the nuts to the front mount bracket plates support and the front Brace mount then slide, adjust the parts and tight the bolts

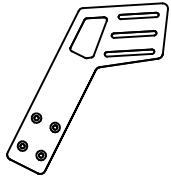

x 2

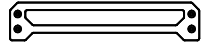

x 1

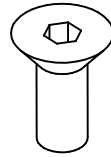

M8 x 20mm x  
12

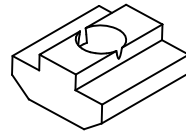

M8 x 12

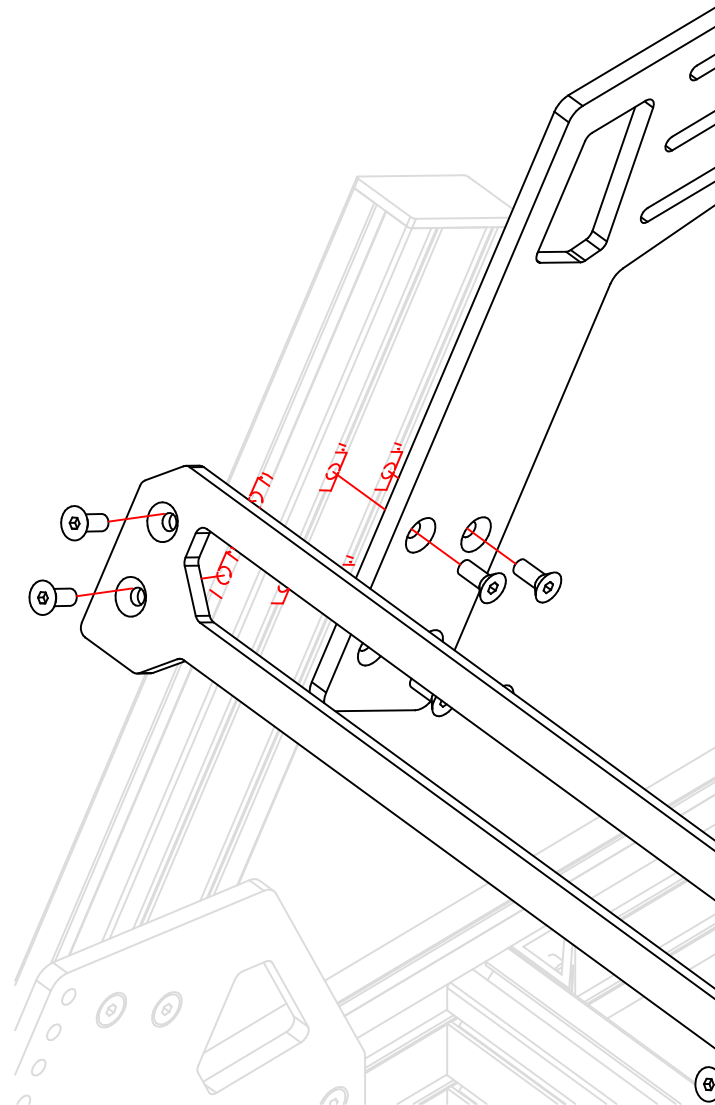
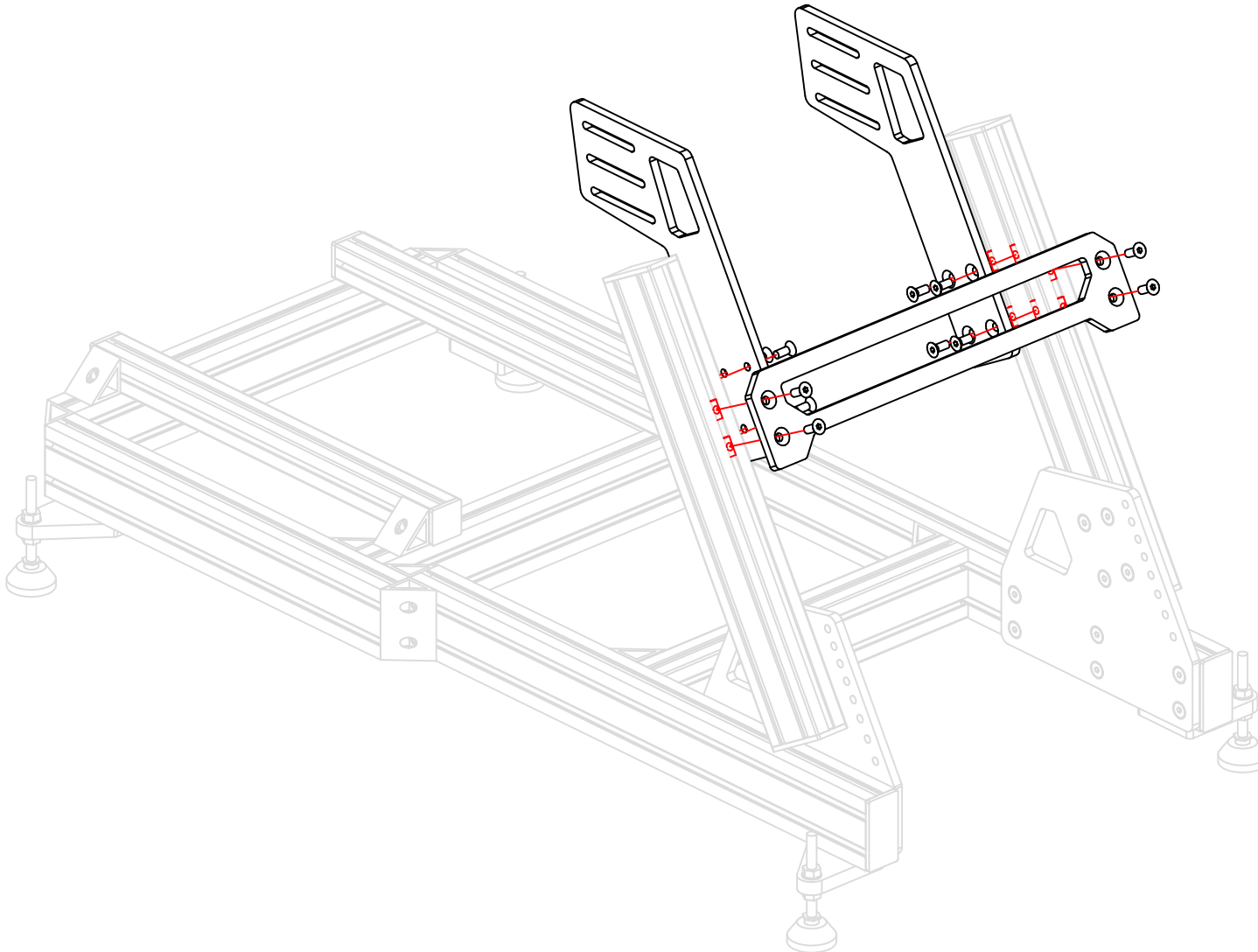

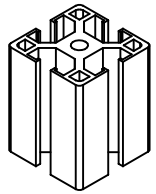

500mm x 2

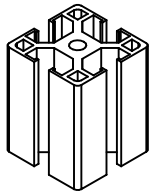

320mm x 1

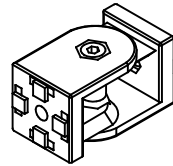

x 2

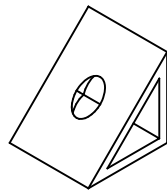

4040 x 6



M8 x 16mm x  
16

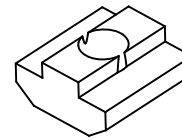

M8 x 12

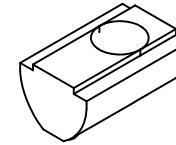

M8 x 2

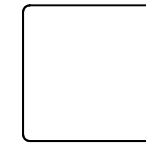

x 2

# GT2 Pedal Deck Fasteners Pack

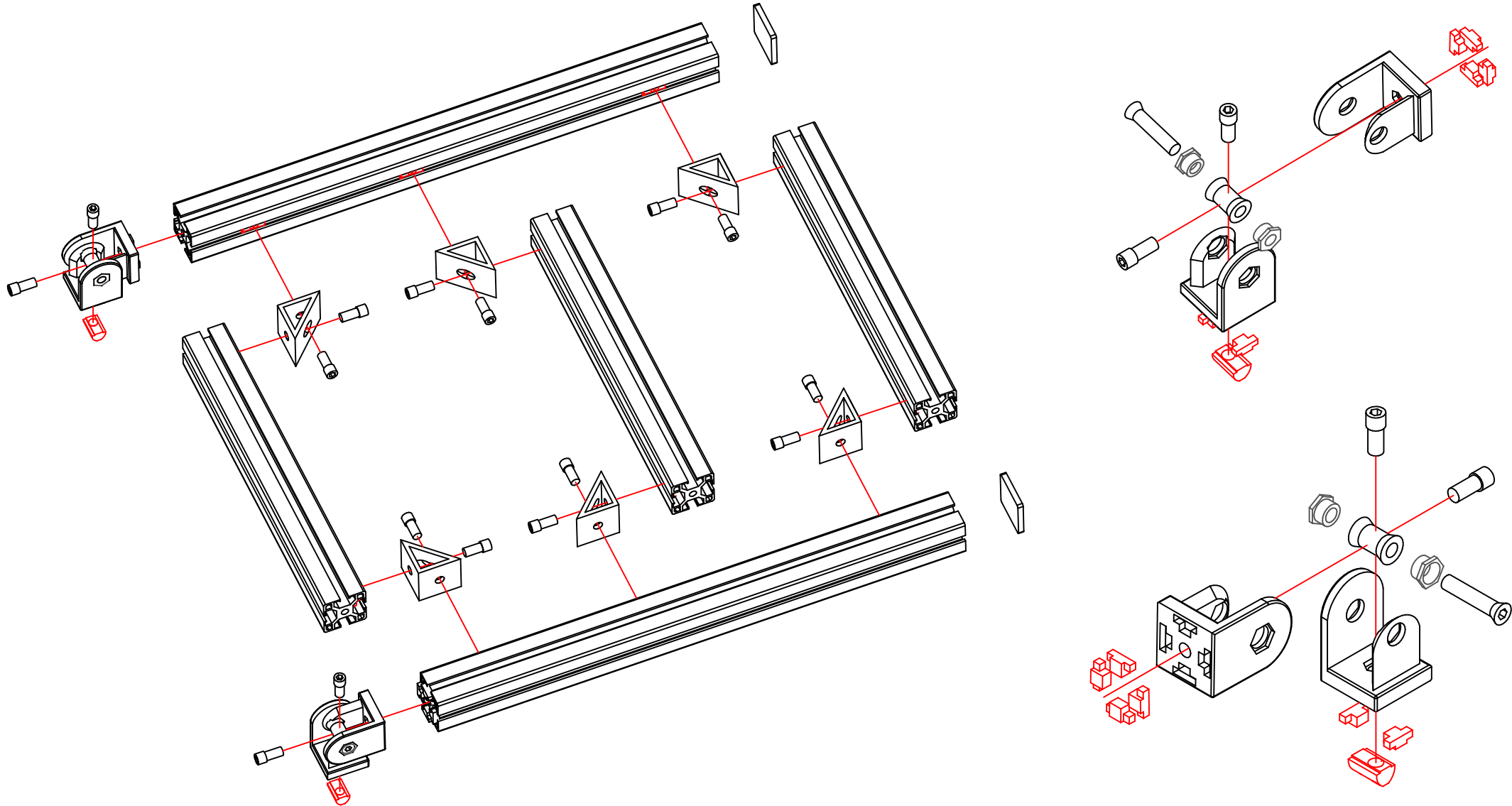

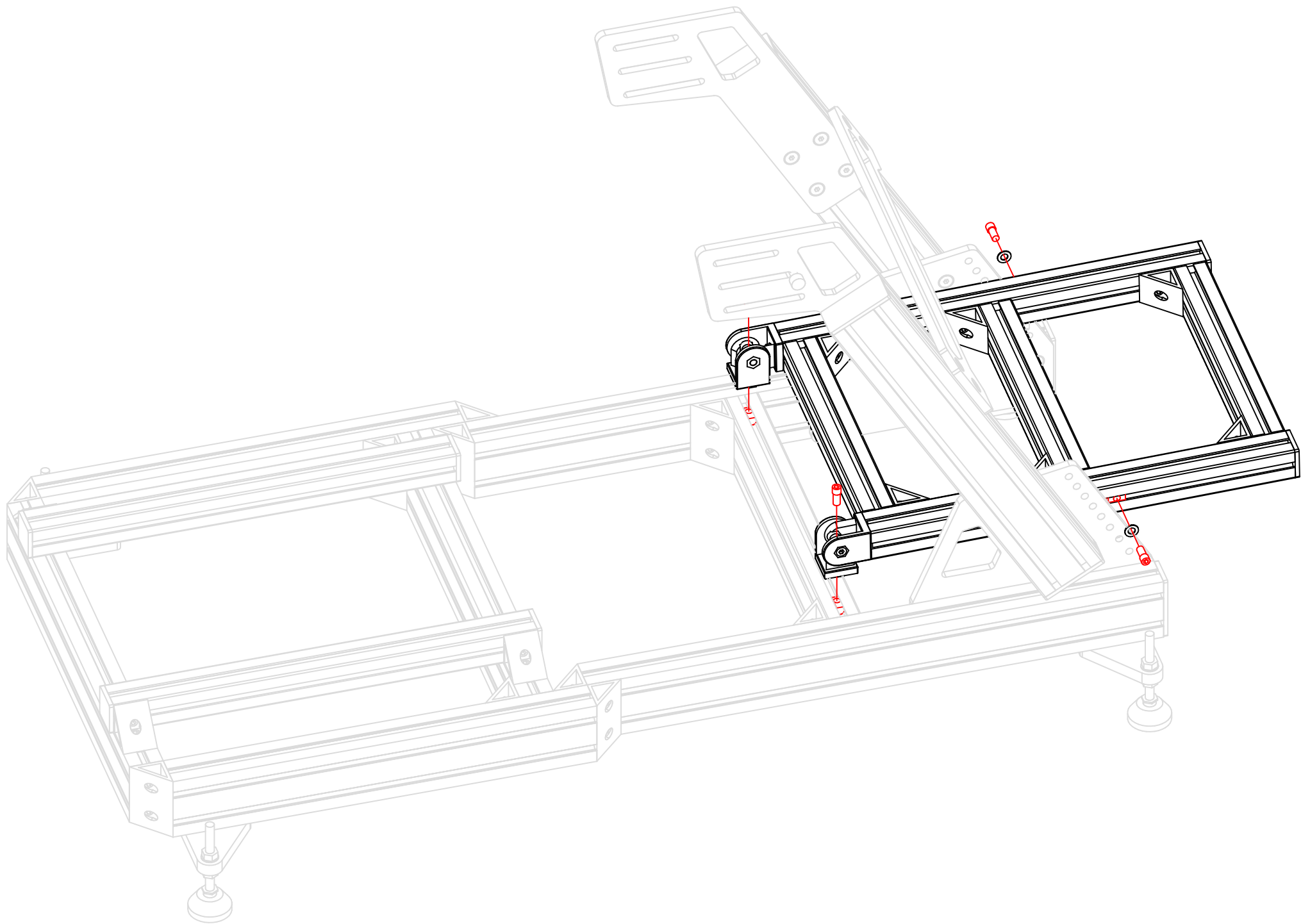

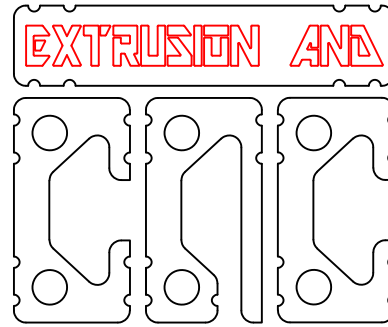

If you still have some questions regarding assembly of this product or about the manual itself, please refer to our support department. They can be reached at

[support@extrusionandcnc.com](mailto:support@extrusionandcnc.com)

whatsapp: +971506580398