

## INSTALLATION GUIDE

**5/6 INCH LED DISK LIGHT - 1CCT**

PLED-DISK5/615W2700K-DIM

PLED-DISK5/615W3000K-DIM

PLED-DISK5/615W4000K-DIM

PLED-DISK5/615W5000K-DIM

**IMPORTANT:** Please read carefully and save these instructions, as you may need them at a later date. When using electrical equipment, basic safety precautions should always be followed as below.

**READ AND FOLLOW BELOW SAFETY INSTRUCTIONS**

**GENERAL:** All electrical connections must be in accordance with local and National Electrical Code (N.E.C) standards. If you are unfamiliar with proper electrical wiring connections obtain the services of a qualified electrician.

1. Do not make or alter any open holes in an enclosure of wiring or electrical components during kit installation.
2. To prevent wiring damage or abrasion do not expose wiring to edges of sheet metal or other sharp objects.
3. Suitable for damp locations.
4. Suitable for Type IC or suitable for Type non-IC.
5. Use only in open luminaires.
6. This device is not intended for use with emergency exit.
7. This light is dimmable. Dimming range is 10%-100%.
8. This retrofit kit is accepted as a component of a luminaire where the suitability of the combination shall be determined by authorities having jurisdiction.
9. Please examine all parts that are not intended to be replaced by the retrofit kit for damage and replace any damaged parts prior to installation of the retrofit kit. Only install in operating environments between -4°F and 113°F (-20°C and +40°C).

**UNPACKING:** Thoroughly inspect the light for freight damage. Freight damage should be reported to the delivery carrier.

**INSTALLATION TYPES:** surface mount with junction box or retrofit recessed can.

**INCLUDED HARDWARE:** 2 long screws, 2 medium screws, 2 spring clips (for can installation), 3 wire nuts

**COMPATIBLE DIMMER LIST****DIMMING**

Dimming performance may depend on the dimmer, the dimmer range adjustment setting (for dimmers with brightness range adjustments), the wiring method, and/or the number of LED modules installed onto the dimmer circuit.

For dimmer selection, Dimming Control Manufacturers revise their product often; for the latest list of compatible dimmers please visit our website.

For best results, it is recommended to install a minimum of four LED modules onto one dimmer.

Before turning on the LED lights, set dimmer position at maximum before adjusting to a lower light level.

Please follow the Dimming Control Manufacturer's instructions for the installation of all dimming controls.

**LEVITON**

6602-IW  
6633-PLW  
6674-P0W  
6681-IW  
700-I  
705-X  
C20-6684-IW  
C40-6683-IW  
IPI06-1LZ  
IPI06-CLZ

**LUTRON**

CTCL-153P  
DV-600PR-WH  
DVLV-600P-WH  
DVSCCL-153P-SW  
GL-600H  
NTFTU-5A-WH  
S2-L-WH  
S-600PR-WH  
SLV600P-WH

**WARNING**

RISK OF FIRE OR ELECTRIC SHOCK

DISCONNECT MAIN POWER AT FUSE OR CIRCUIT BREAKER BEFORE INSTALLING OR SERVICING THE LIGHT

## I. SURFACE MOUNT WITH JUNCTION BOX

1. Make sure power is turned off at the source before installing the light and the J-box is securely mounted. (This light is compatible with 2.75", 3.5" or 4" J-box).
2. Remove lens by twisting counter-clockwise. Find the correct mounting point for your installation type.
3. Connect the supply wires to the wires on the light using the three included wire nuts. Attach the white wire to the neutral wire, the black wire to the live wire, and green wire to the ground wire. Arrange the wires in the back of the junction box.
4. Choose the light's mounting points marked with stickers for your J-box size. Align the light mounting points with the holes in the J-box. Use the included screws to secure the light. Medium screws can be used for shallow J-boxes and the long screws in deeper models. Do not over-tighten screws or light will not be tight to ceiling.
5. Complete the installation by placing the lens back into its original position by twisting it in clockwise direction.

STEP 1



STEP 2

MOUNTING POINTS

3.5" J-BOX  
2.75" J-BOX  
5/6" CAN  
4" J-BOX

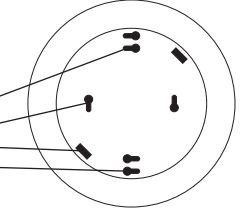

STEP 3

WIRING

WHITE: NEUTRAL  
BLACK: LIVE  
GREEN: GROUND

WIRE NUTS

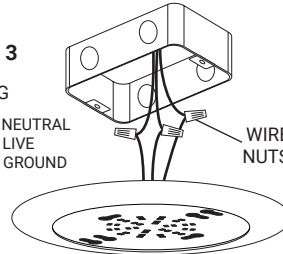

STEP 4

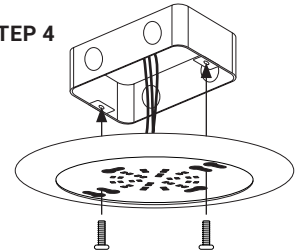

STEP 5

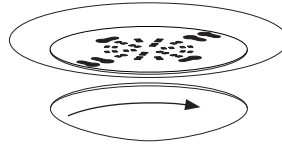

## II. LIGHT CAN RETROFIT WITH E26 ADAPTER

1. Make sure power is turned off at the source before installing the light.
2. Remove any existing trim prior to installation of this light.
3. Choose the light's mounting points marked with stickers for light can installation. Place the spring holds into these rectangular slots and twist them at right angle in a locked position.
4. Connect the power wires from the E26 Adapter to the wires on the light using the wire nuts included. Attach the white wire to the neutral wire and the black wire to the live wire.
5. Thread the E26 Adapter into the socket of the recessed can.
6. Squeeze both the holders arms together and insert into the spring slots of the can. Arrange all wires and carefully push the retrofit trim into the can.

STEP 1 & 2

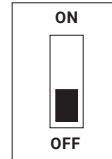

STEP 3

SPRING BRACKET

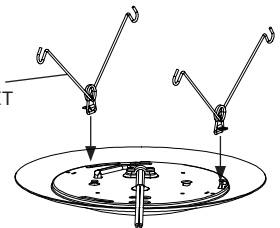

STEP 4

E26 ADAPTER  
WIRE NUTS

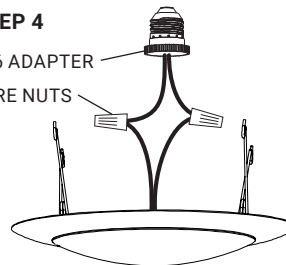

STEP 5

RECESSED CAN SOCKET

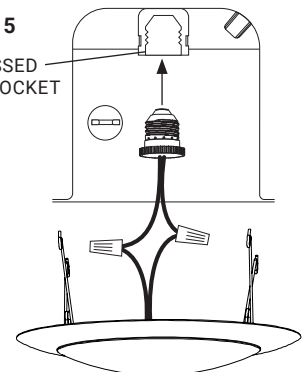

STEP 6

SPRING SLOTS

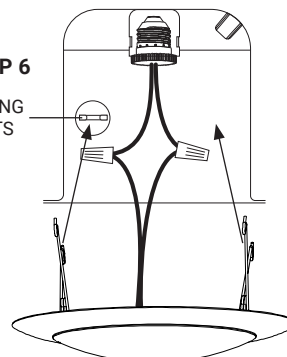

### WARNING

RISK OF FIRE OR ELECTRIC SHOCK

DISCONNECT MAIN POWER AT FUSE OR CIRCUIT BREAKER BEFORE INSTALLING OR SERVICING THE LIGHT