



**BENDTECH**<sup>®</sup>  
Stainless Steel Tubular Products

**RestEzy**

Backrest

BT-36

Ergonomically designed  
for strength and easy installation.  
Suitable to use with Rail Combo Kits.  
Made in Australia. Complies to AS1428.1

# RestEzy Backrest

BT-36

## GRAB RAIL COMBO KITS

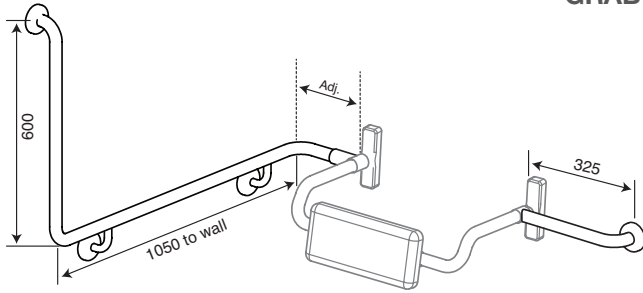

▲ **BT36 + RE05R + RE00/300**  
Available in RH + LH  
RH shown

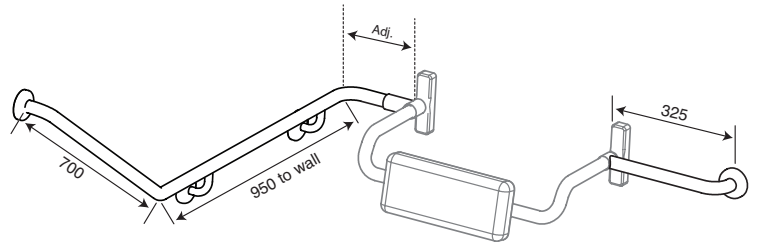

▲ **BT36 + RE06R + RE00/300**  
Available in RH + LH  
RH shown

ASSEMBLY DRAWING

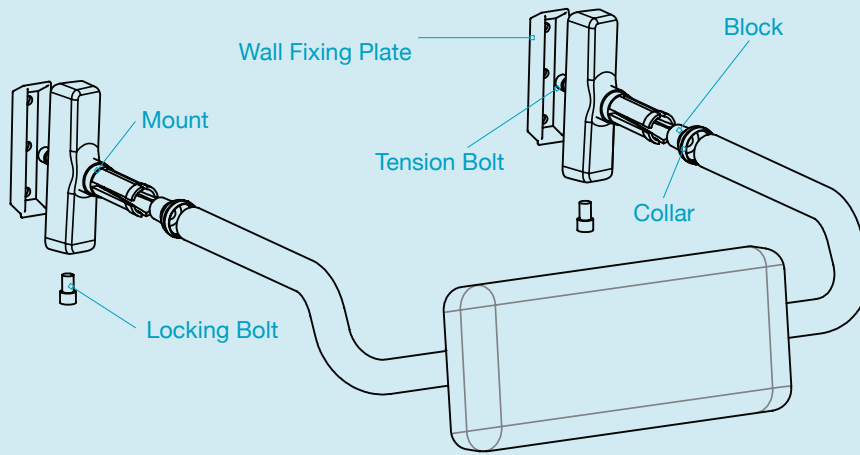

Optional  
**VANDAL PROOF (VP)**  
Stainless Steel Backrest  
also available.

INSTALLATION

### STEP ONE:

Mount Wall Fixing Plates.  
Refer Figure One.

### STEP TWO:

Establish Measurement "A".  
Refer Figure Two.

### STEP THREE:

Cut tube to match  
measurement "A".  
(Line marked on  
underside of tube)

### STEP FOUR:

Follow Assembly Drawing.

Note:

Bolt needs to be tensioned to a  
torque setting of 80Nm

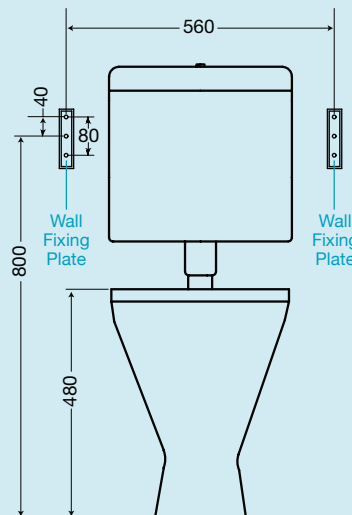

FIGURE ONE

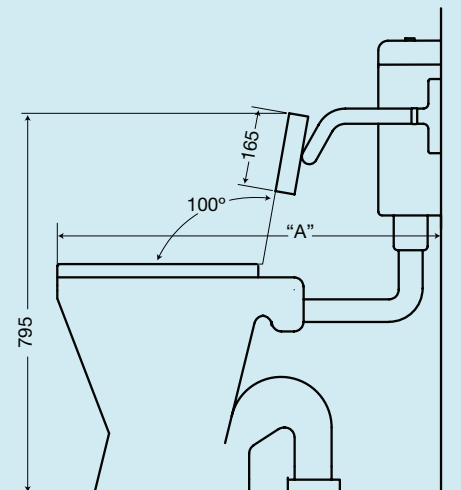

FIGURE TWO

**BENDTECH™**  
Stainless Steel Tubular Products

7 Barrinia Street, Slacks Creek. Qld 4127  
Phone: (07) 3290 4007  
Fax: (07) 3290 4001  
Email: info@bendtech.com.au  
Web: www.bendtech.com.au