

melodysusie

T45 USER MANUAL

TRUE WIRELESS STEREO EARBUDS

Dear Valued Customer

Thanks for choosing this product!
In order to make full use of this item and avoid maloperation, please read the manual carefully before using it.

What's in the Box

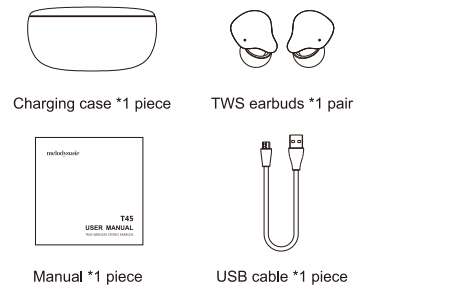

(The above pictures of accessories are for reference only)

Structure of T45

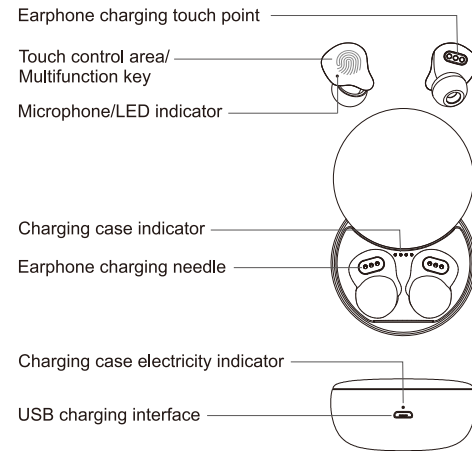

Instruction for wearing

Wearing earbuds and adjust the right angle as the picture shows. It's OK when we feel comfortable and stable.



According to the auricle size of users,users can choose the suitable ear cap,which will be more comfortable.

Power on

Method 1:Open the charging case,and both earbuds will turn on automatically. Left and right earbuds will connect to each other. Take out earbuds, and then orange and white light of main earbud (left earbud is tacitly approve as main earbud) flickers alternately.

Method 2:When neither of earbud is in the charging case or charging case is out of battery, and the earbuds are power off, please long press multifunction key of both earbuds for 2 seconds to turn on . And then the left and right earbuds finish auto paring. Orange and white light of main earbud (left earbud is tacitly approve as main earbud) will flicker alternately.(Master earbud will be switched according to the actual demand).

Connecting wireless of mobile phone

When using T45 at the first time, please turn on according to method 1 or 2.The orange and white light of master earbud willflicker alternately.Turn on the bluetooth function of mobile phone to search nearby bluetooth devices,and connect the devices " T45" ,When the device shows "connected" , it means the earbuds and mobile phone

connect successfully; after first time using,only turn on the earbuds according to method 1 or 2. When earbuds turn on, they will automatically attempt re-connect with the last connected mobile phone. If last connected mobile phone is not near to the earbuds or bluetooth function is not open , the earbuds will get into searching status.(The LED light of earbuds will flicker orange and white alternately).

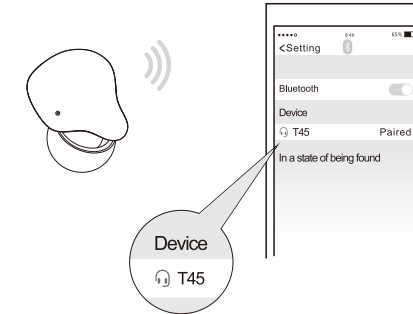

Notice

1. The paring mode will last about 10mins at most,if they can not be paired ,the earbuds will turn off automatically. If you need to be connect again,please operate as "Power on"or "Connecting bluetooth mobile phone"steps.
2. They will be disconnected if the distance between earbud and mobile phone is beyond transmission distance.It can be connected automatically if the earbuds go into phone's connection range within 10 minutes.

Power off

Method 1:Put the earbuds into the charging case, close the upper cover of charging case,the earbuds will turn off automatically.If the electricity of charging case is out of power, the earbuds will not turn off automatically.
Method 2:Long press (either one of earbuds) multi-functional key for 6 seconds,the orange light will be on for 1 second and then it is off. Earbuds turn off successfully.

Note: If the earbuds are disconnected and not connect again within 10 minutes,the earbuds will turn off automatically.

Answering the call

In the coming call state,double press multi-functional key of either of the earbud to answer.

Ending a call

In the conversation state, double press multi-functional key of either of the earbud to end the call.

Rejecting a call

In the coming call state, long press multi-functional key of either of the earbud for 2 seconds to reject the phone.

Call switching mode

In the conversation state, long press multi-functional key of either of the earbud for 2 seconds to switch from earbuds to phone, then long press 2 seconds to switch from phone to earbuds.

One-key Siri

When earbuds is/are in standby or music mode, treble press multi-functional key of either of earbuds to activate or close Siri (The feature is only available for IOS system).

Music playing:

- 1.On/Pause:When playing music,double press multi-functional key of either of earbuds to play or pause the music,and then double press multi-functional key of either of earbuds to play the music again.
- 2.Previous song:When playing music,long press the left earbud for 2 seconds to switch to previous song.
- 3.Next song:When playing music,long press the right earbud for 2 seconds to switch to next song (When using in Mono mode, long press either of earbud to switch to next song).
- 4.For mono mode,only supports next song.
- 5.Auto paly:Having phone conversation in music status ,it will switch music mode auto-matically when phone call ends.

Charging for the charging case

Remark: Charging case indicator has four lights, one light on means electricity capacity is 0-25%; Two lights on means electricity capacity is 25-50%; Thress lights on means electricity capacity is 50-75%; Four lights on means electricity capacity is 75-100%;

When the electricity of charging case is lower then 25%, you need to get it charged. When the charging case is in charged, the orange light of charging case will be always on. when the charging case is fully charged,the orange light will be off.

Charging earbuds

- 1.When the earbuds are in low battery mode, there will be voice prompt. Put the earbuds into the charging case and close the charging case to charge the earbuds(make sure the charging case is with electricity).
- 2.When the earbuds are fully charged, it will stop charging.

Master/slave mode

This product has the master/slave switch function:

- 1.Open the charging case,take out either earbud and earbud can work with mobile phone properly,and then take out another earbud,both earbuds will be connected to each other soon,and will be in TWS mode.
- 2.When the master earbud is out of battery or put the master earbud into charging case to be power off,the other earbud will switch to master earbud and work.

Product parameter

Model #:	T45
Net weight:	57g
Output power:	3mW
Wireless range:	10 meters
Play time(earbuds)	5H
Play time(with charging case):	20H
Charging voltage:	DC 5V/1A
Charging time:	2H
Battery capacity(earbuds):	3.7V/40mAh
Battery capacity(charging case)	3.7V/400mAh
Earbuds size:	23.69x21.5x22.29mm
Charging case size:	ø60x29.6mm

Safety criterion

- 1.Please follow the instruction of user manual and do not take any reason to disassemble or modify the device, otherwise it may make the earbuds broken or burnout.
- 2.Do not drop the product to any liquid or wash in water.
- 3.Do not charge the earbuds with adapter which is over rate current/voltage(5V/1A).Otherwise the battery of earbuds will be damaged.
- 4.Please use or store product in room-temperature environment. Do not put the product in an environment where the temperature is too high or too low (Below 0 Degree or aboce 45 degrees).
- 5.Please do not block any mouth of earbuds,such as charging interface,Led indicator or microphone.
- 6.Please do not sue the earphone overtime and over-volume,or it make you dizzy or damage your hearing.
- 7.Please do not use the devices under thunderstorm environment. Thunderstorm may cause abnormal operation of the devices,singal interruption ,etc.

Technical solution

If your earbuds can not be paired with your phone,try the following steps:
Please make sure the earbuds are with electricity;
Please make sure the earbuds are power on;
Please make sure the earbuds is not connected with other devices;
Please make sure the bluetooth function of mobile phone is normal,and turn on the bluetooth function;
Please make sure the distance between earbuds and mobile is connectable;
If the above operations can not help you solve the problem, Pls try to reset the earbuds:
Take out either of the eabud, double press multifunction-key to enter the orange and white light flickers alternately mode, and then treble press until the orange and white light flicker at the same time for 1s, and then the earbuds turn off.
Operate the other earbud in the same way. And then turn on the earbuds, after 2s, double press both of the multi-functional keys to pair two earbuds. After they pair successfully, the orange and white light of left earbud will flicker

alternately. After reset the earbuds, pls connect the Bluetooth device according to the last steps.
When the earbuds can not work, put them into the charging case and close the cover. And then take out again.

Thank you