

MELODY SUSIE

BRING YOUR NAIL SALON HOME

**S SERIES
SPI**

Instruction Manual



READ BEFORE USING



INDEX

- 1** Safety Instructions
- 4** Contents
- 5** Using the Nail Drill
- 7** Specifications
- 7** Warranty and Customer Service



01 Safety Instructions

READ ALL INSTRUCTIONS BEFORE USING.



To reduce the risk of burns, electrocution, fire or injury to persons.

Please read the following safety instructions carefully to avoid potential hazards that could lead to personal injury or device damage.

Note: Use an adapter of 5V 2A if the USB cable of the device connects to the adapter. Do not exceed 5V 2A, or the drill will burn out.

Check before Using

- 1 Check the cord and device before using. Do not use the damaged cord to charge the device. Do not use the device if it is not functioning correctly.
- 2 Only plug this device into a voltage system that matches the voltage system specified on the device. The use of improper voltage can cause damage to the device and will VOID the warranty.
- 3 Use the original power cord only.

Note for Battery

- 1 Fully charge the battery before the first use to ensure optimal performance.



- 2 Do not overcharge the device or use it when it is charging.
- 3 Charge the device in a well-ventilated area within the temperature range of 0 °C to 40 °C.
- 4 Do not charge the device near any flammable or explosive materials.
- 5 Do not cover the device with clothes or other materials while it's charging.
- 6 Charge and discharge the device once every three months if the device is not used for long periods. Please note that the battery performance may decline over several years under normal conditions.

Note for Using

- 1 Turn the power off after use.
- 2 Do not use crooked or damaged nail drill bits, and only replace the bit when the power is off.
- 3 Adjust the speed gradually, avoiding sudden changes. Immediately stop using the device if there are any unusual movements or noises.
- 4 Misuse, dropping or excessive force may cause device damage.
- 5 Individuals under the age of 18 require parental consent and supervision to use this device.
- 6 Do not operate in wet or moist conditions.
- 7 Do not touch any rotating part while the device is working.



Maintenance Work

- 1 Do not disassemble the device. It is dangerous and will VOID the warranty.
- 2 Do not place the device at approximately or more than 50 ° C (in a metal box, car, or other hot places). Keep the device dry and keep it away from oil and grease.
- 3 Store the device in a cool and dry place. Do not store it in a hot or humid environment.
- 4 Store the power cord properly and keep it away from heated surfaces.
- 5 Do not dispose of the device in heat or fire.
- 6 Do not clean the device with harmful chemicals or detergents. Only a dry cloth is allowed for cleaning.

Note for Injury

- 1 Frequent manicures can also cause damage to your nails.
- 2 If you need to remove the gel polish from natural nails, try to use nail polish remover pads to avoid damage to the nail bed with the improper operation.
- 3 Do not use the device if you have open wound on your nails or hands.
- 4 If you have skin diseases, heat sensitivity, allergic reactions, onychomycosis, or any other condition, consult your doctor and medical professional before using the device.



02 Contents

- 1 Rechargeable Nail Drill * 1
- 2 Power Supply * 1
- 3 Sanding Bands * 50
- 4 Base Drill Bits * 6
- 5 Ceramics Drill Bit * 1
- 6 User Manual * 1



Small Barrel

Surface work



Cone

Cuticle work,
polish sidewalls
and under nails



Needle Head

Polish nail
edge



Safety Bit

Cuticle work,
polish nail
side edge



Large Barrel

Surface work for
backfill cutting,
shorten, infill cuticle



**Mandrel+
Sanding Bands**

Surface work,
shortening, and
removal



03 Using the Nail Drill

- 1 Replace the desired drill bit. Please read and follow the steps for **Replacing the Drill Bit**.
- 2 Press the **F/R & ON/OFF Button** for 3 seconds to turn on the device.
- 3 Rotate the **Speed Control Knob** to accelerate or decelerate the rotation speed of the drill bit.
- 4 Short press the **F/R & ON/OFF Button** to change the rotation direction of the drill bit if needed.
- 5 Press the **F/R & ON/OFF Button** for 3 seconds to turn off the device after polishing. Then rotate the central barrel and take out the drill bit.

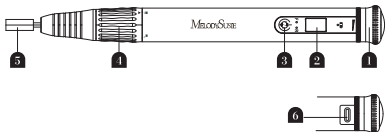

- | | |
|-------------------------------------|----------------------|
| 1 Speed Control Knob | 4 Central Barrel |
| 2 LCD Screen (It will show the RPM) | 5 Drill Bit |
| 3 F/R & ON/OFF Button | 6 Type-C Charge Jack |



Replacing the Drill Bit

Please make sure that the desired bit is suitable for the collet.

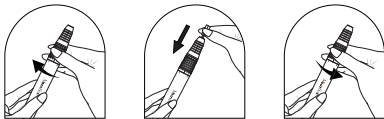

- Only change the drill bit when the power is off and the device completely stops.
 - Do not move central barrel during operation.
 - Insert the drill bit into the device correctly and rotate the central barrel to the correct position, otherwise high vibration, drill bit stuck, etc. may happen.
- 1 Turn the central barrel clockwise until hearing a 'click' sound, then release and remove the original bit and place the desired bit into the handpiece.
 - 2 Turn the central barrel counterclockwise until hearing a "click" sound to lock the drill bit in place.
 - 3 Please distinguish the rotation direction of the bit and collet. Take care of your fingers not to be hurt by the edge of bits.



Charging

- Only charge the device when the power is off.
 - Do not draw out the connecting wire during charging or touch it with wet hands to prevent electrical leakage, shock, or fire hazards.
- 1 Take out the cord and connect it to the Type-C Charge Jack of the nail drill.
 - 2 Charge the device when the indicator light shows red and flashes. And the device is fully charged when the indicator light stays blue without flashing.

04 Specifications

Input Voltage Range: 5V/2A

05 Warranty and Customer Service

- 6-month limited warranty (Apply for an extra 6-month warranty extension by registering on <https://www.melodysusie.com/pages/extend-warranty> if needed.
- If you require any technical support, please contact us.

Website: www.melodysusie.com
Email: service@melodysusie.com
Email: service.uk@melodysusie.com



SAVE THE INSTRUCTION MANUAL

For FAQs and more information, please visit:

<https://www.melodysusie.com/pages/faqs>



www.melodysusie.com



US Service: service@melodysusie.com



UK Service: service.uk@melodysusie.com



FR Service: service.fr@melodysusie.com



DE Service: service.de@melodysusie.com



Whipple Rd, Union City, CA 94578



AMZLAB GmbH
Laubenhof 23,45326 Essen,Germany



THEMIS AR support ltd.
85 Great Portland St, London, United Kingdom, W1W 7LT