

Electric Curtain Rail Assembly

Use the Track Connectors to connect the rails together. Tighten with the Allen Key provided

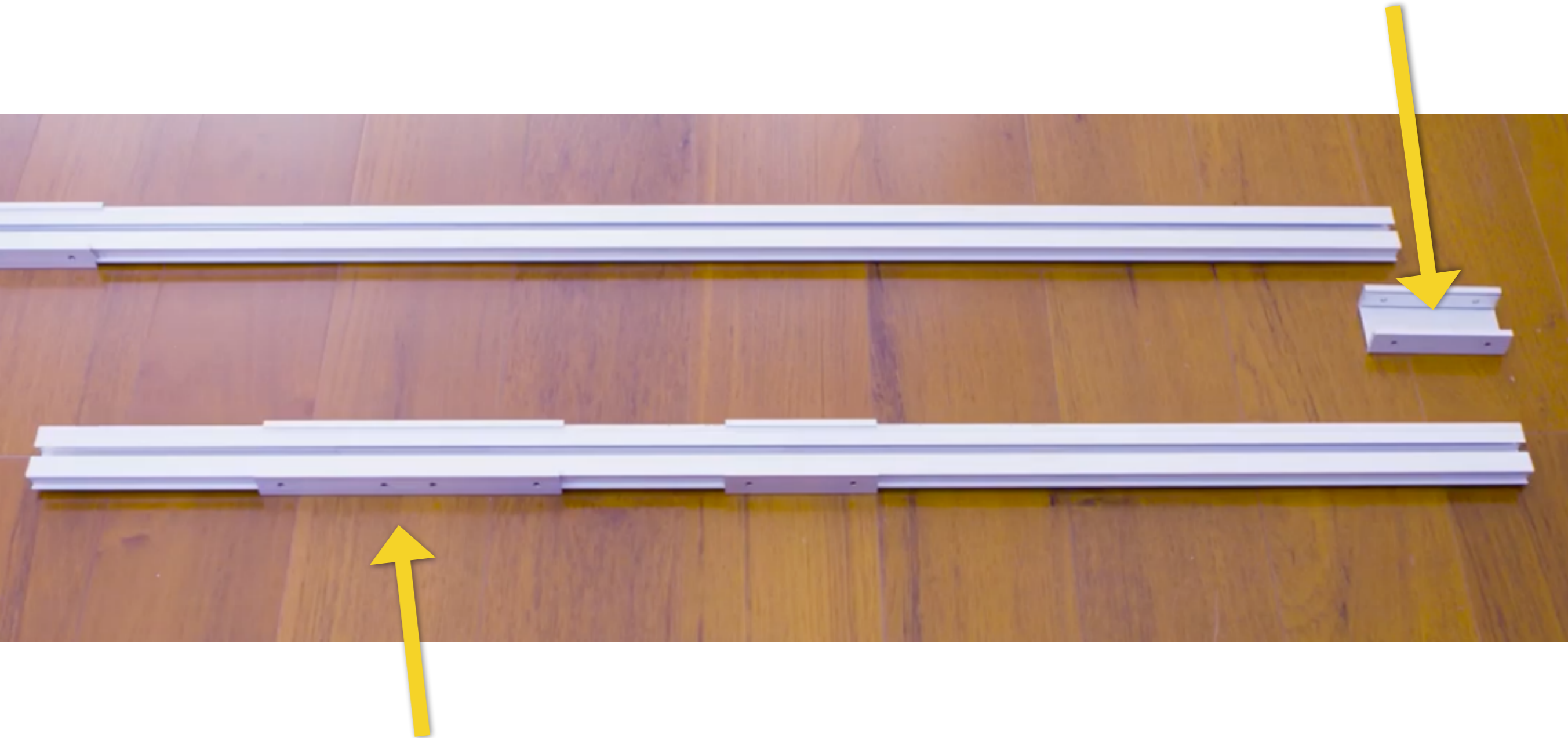

One Rail is already assembled with Track Connectors. This is made up of shorter pieces that you can remove and use to achieve a more precise length.

Track modification for custom length

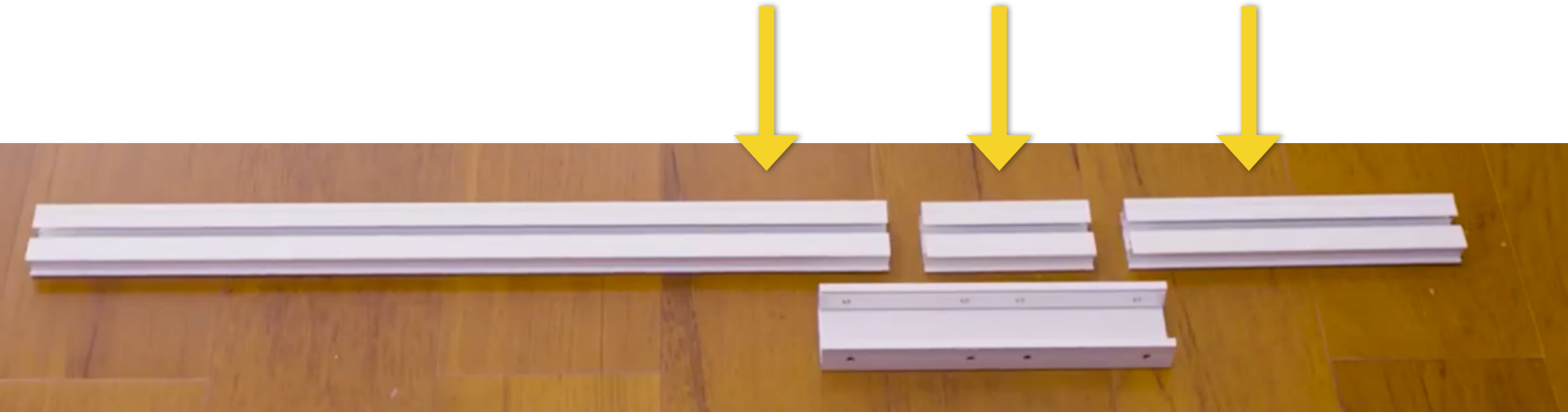

Make sure there are not large gaps between the joints

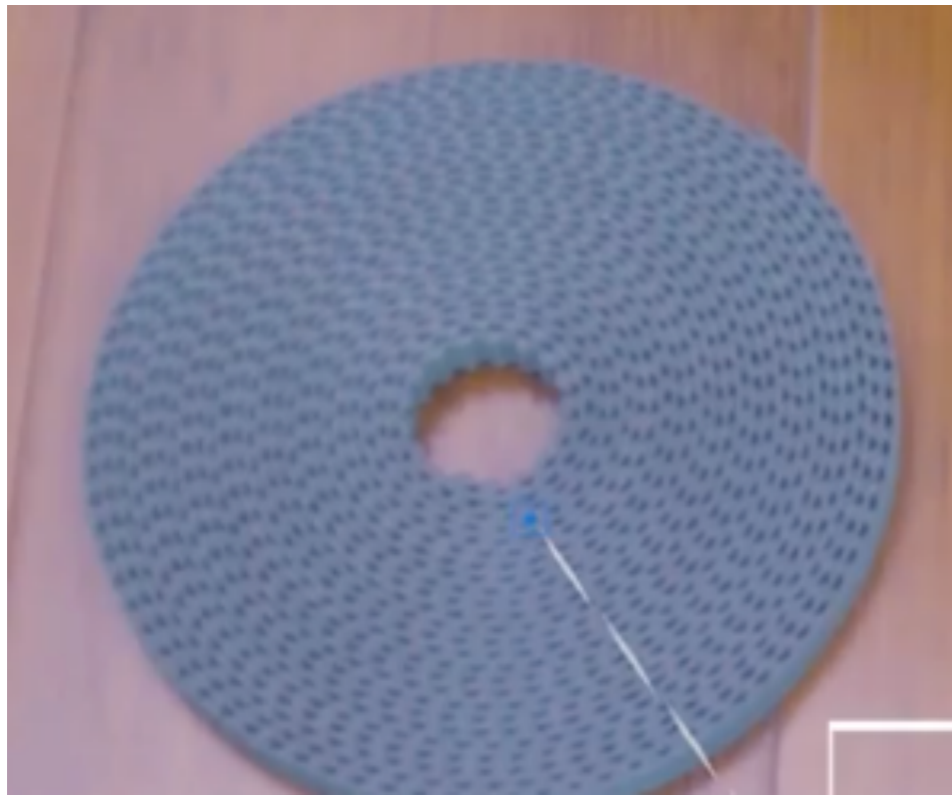

There is a ribbon and 2 measuring tools.

Do NOT cut the ribbon incorrectly !

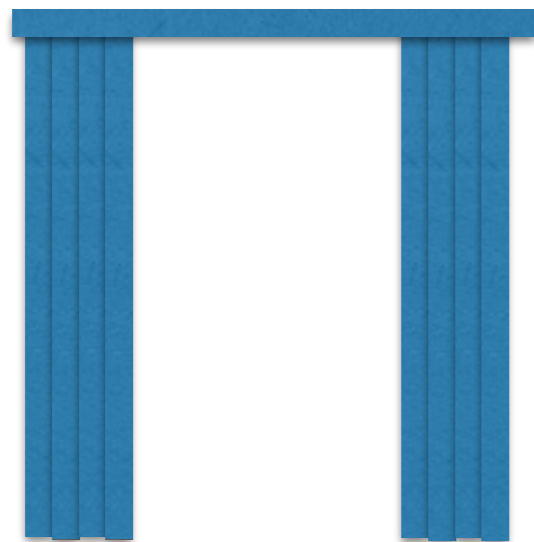
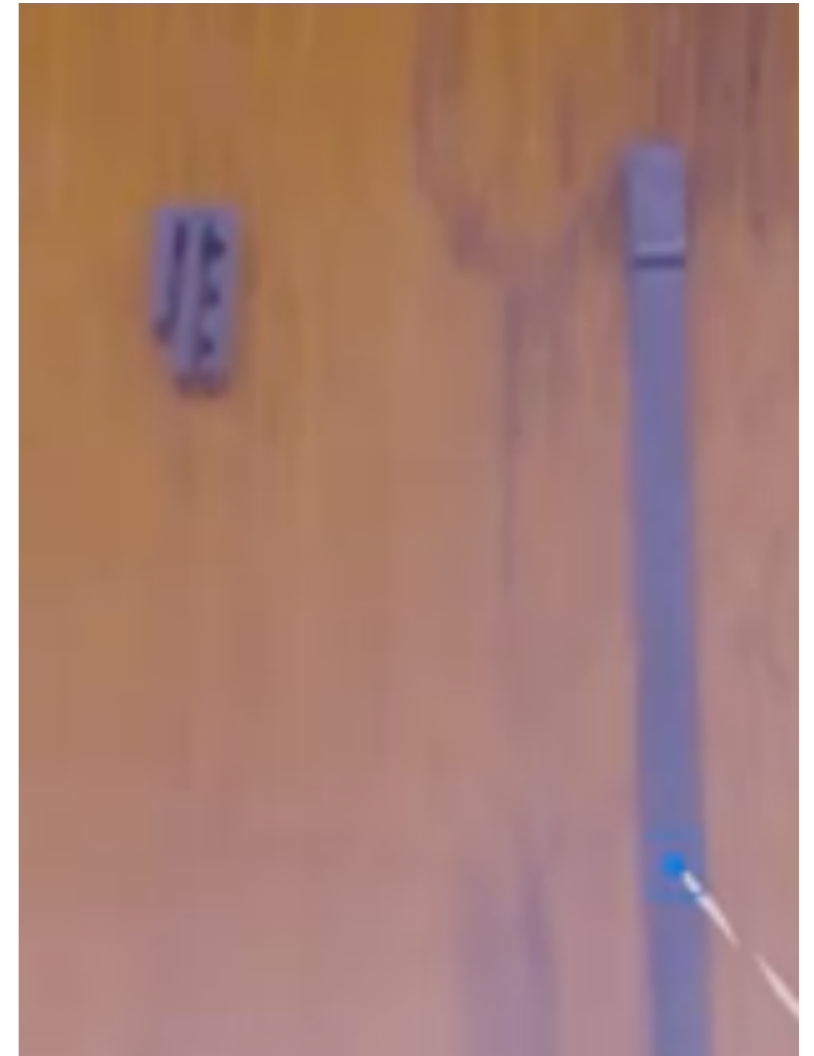

Curtains can open from the centre or all to one side but the instructions are different and you cannot change between these

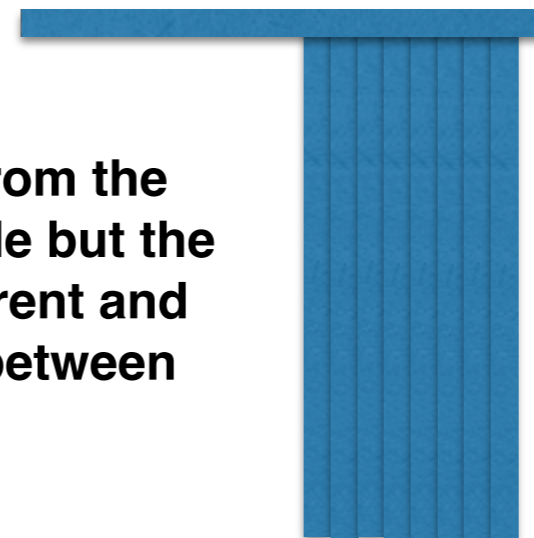

**Centre
Opening
Instructions
ONLY !**

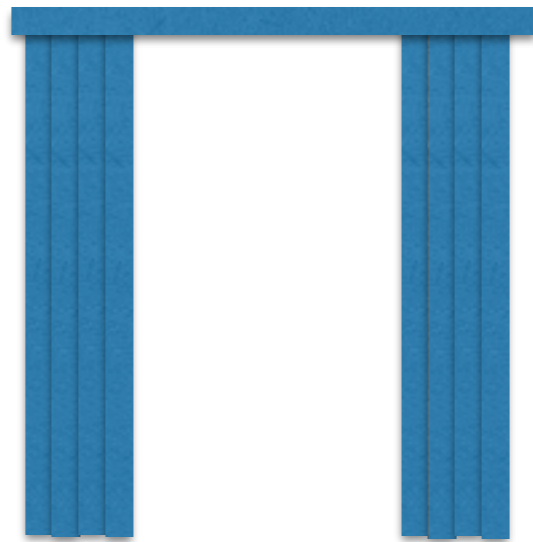

Centre Opening ONLY !

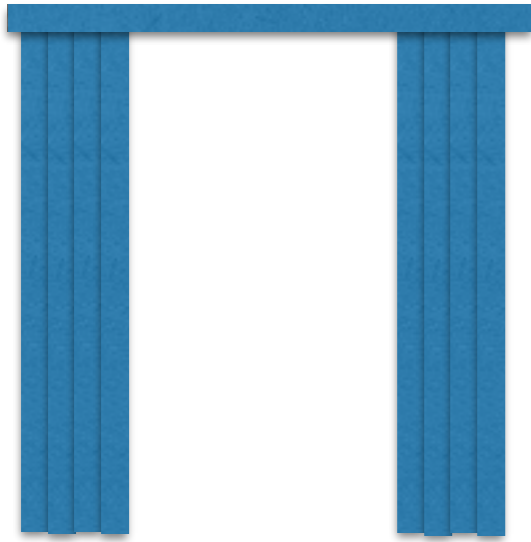

1. Attach the belt measure tool as shown



2. Pull the belt straight along the track and attach the Long measure tool



**Centre
Opening
Instructions
ONLY !**

3. Attach the Long measure tool to the track and cut at the end

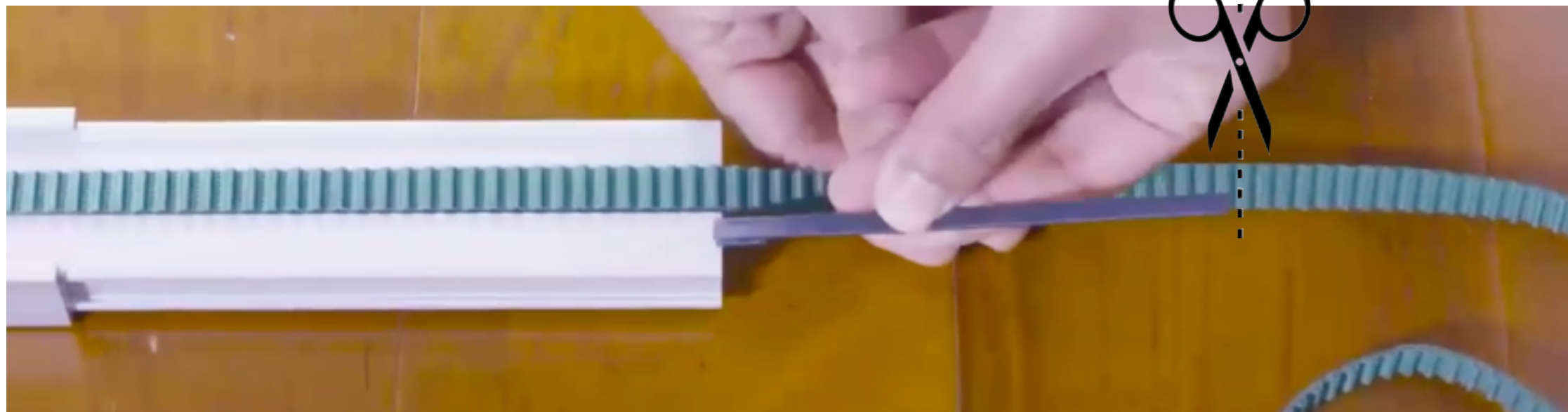

Centre Opening ONLY !

**4. Repeat the steps so you have
2 parts equal in length**



**5. Fix the buckles onto the ends
of the belts**



6. Press hard

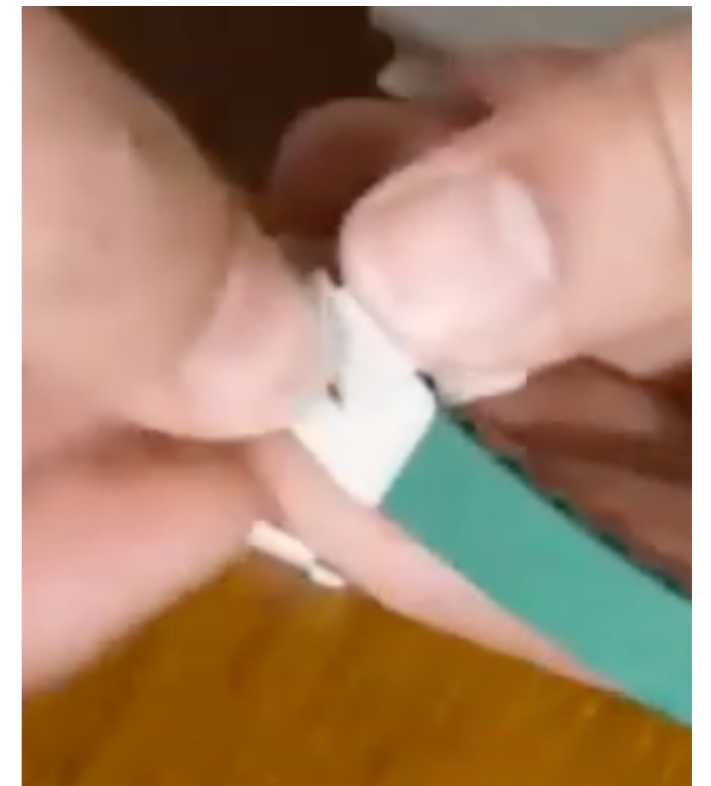

Centre Opening ONLY !

7. Attach the runner wheel in inserting the buckle into the gap on the runner wheels

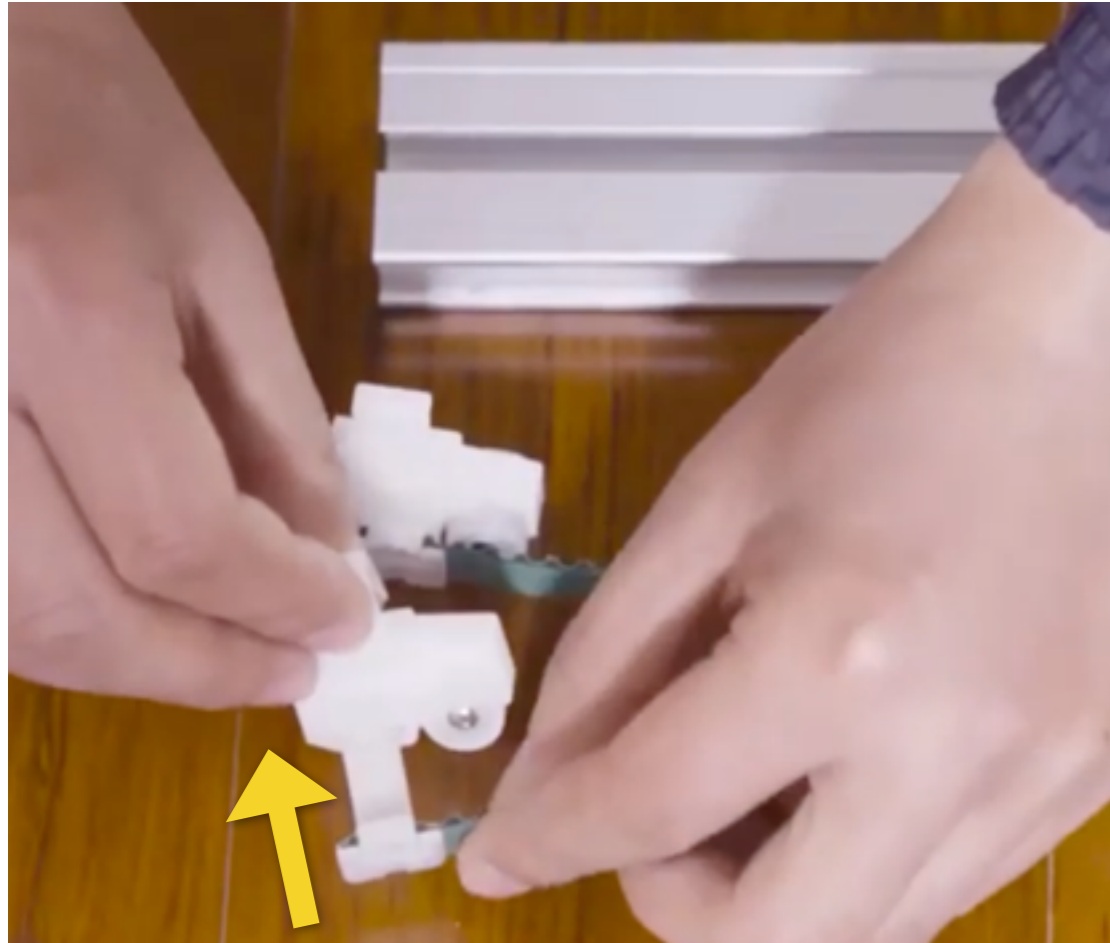

8. Take note of all the following

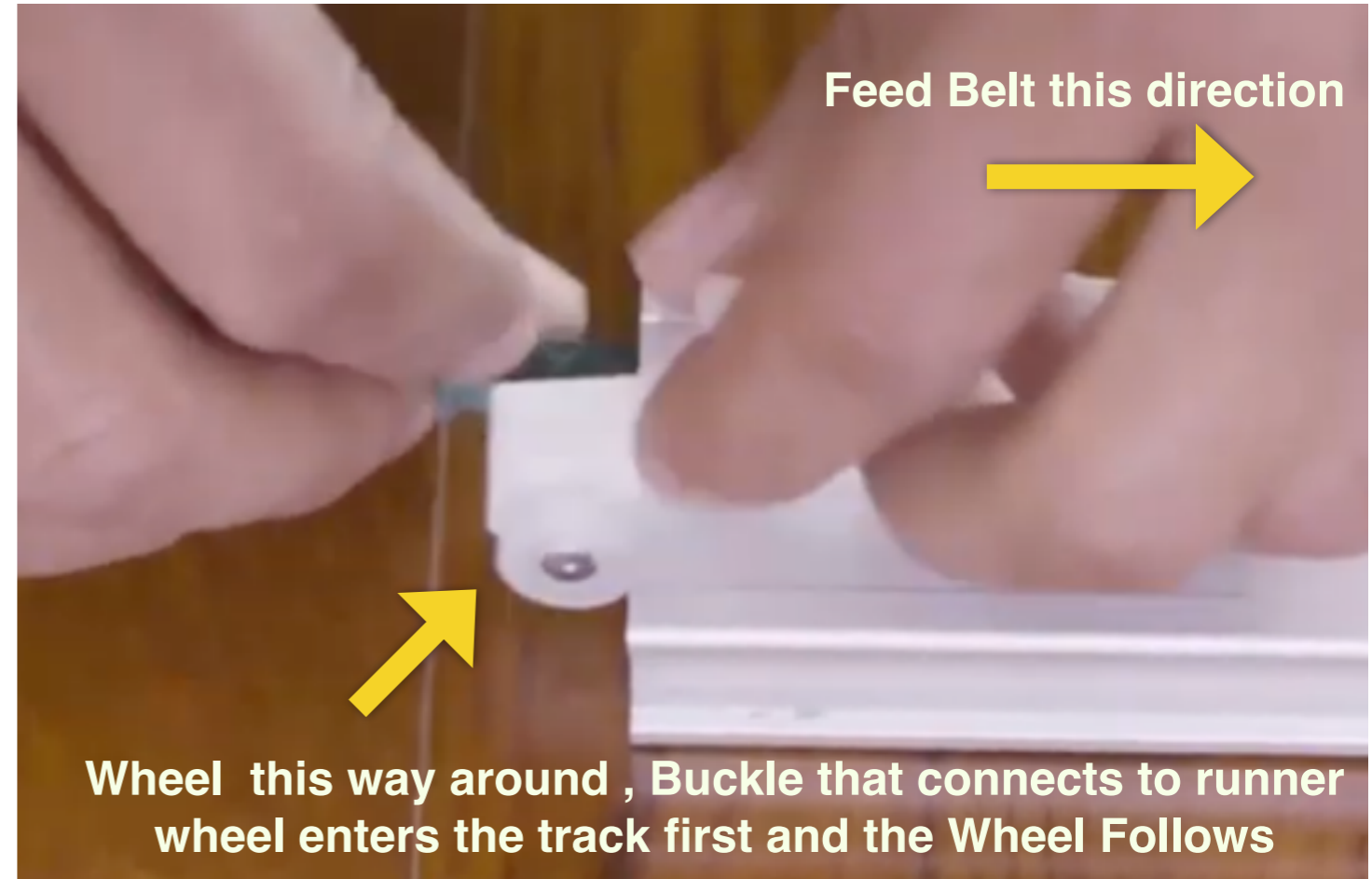

Centre Opening ONLY !

9. Feed all the way through the track

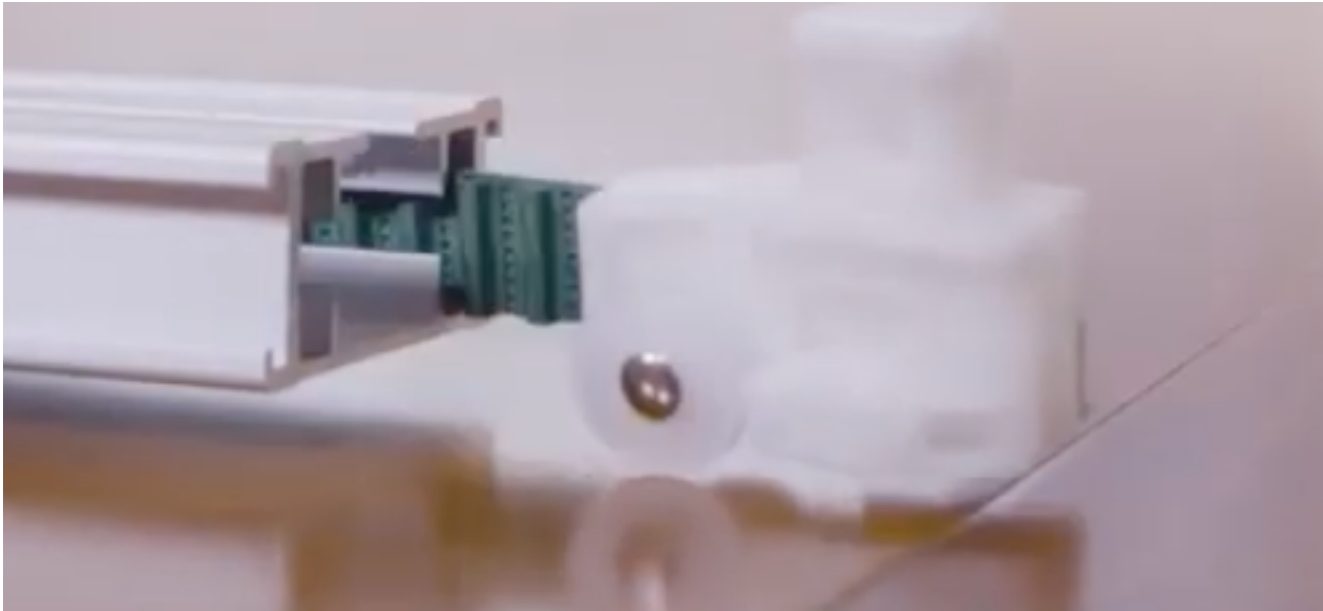

10. Feed the 2nd belt from the opposite side

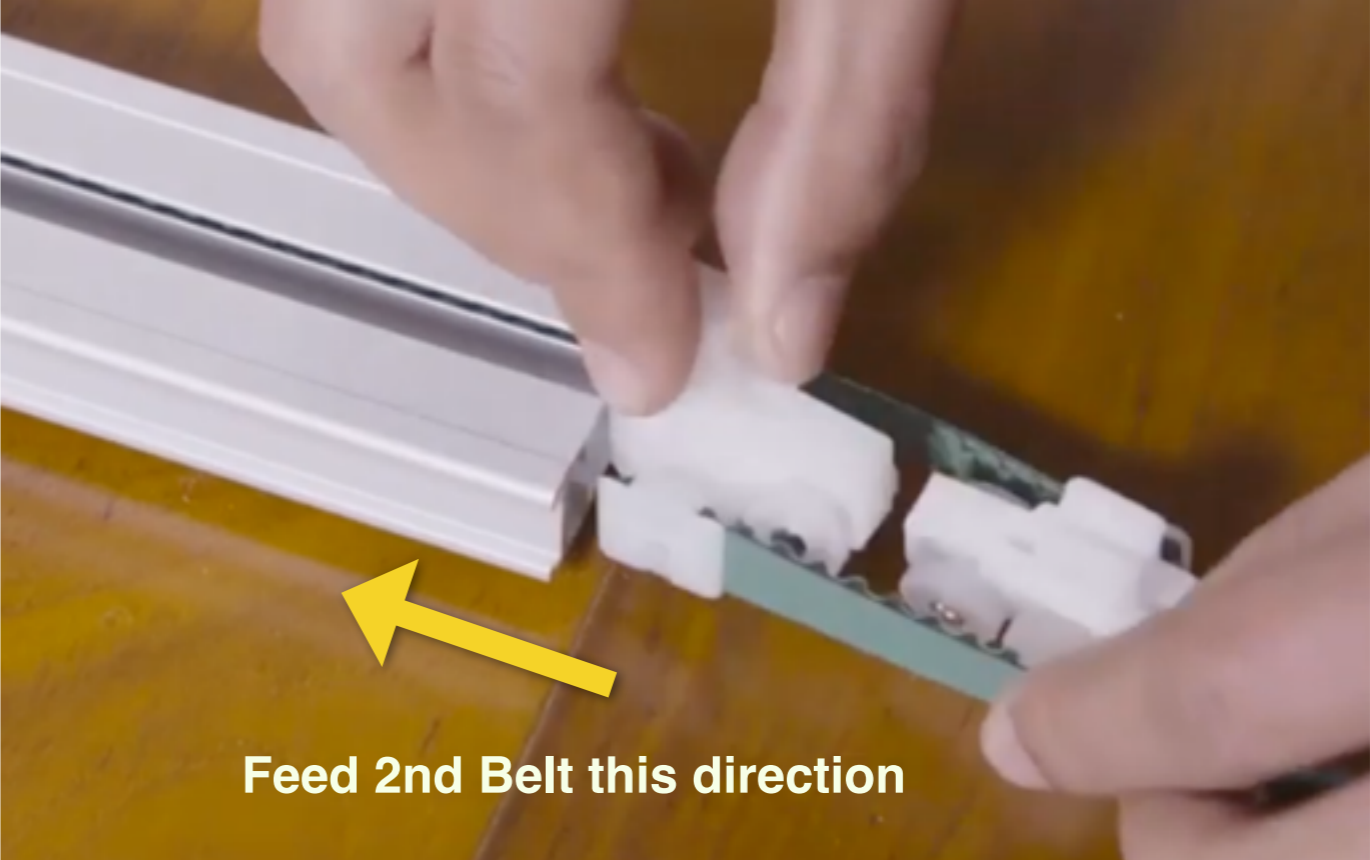

Centre Opening ONLY !

**11. Feed the belt through the track end,
make sure the wheel opening on the track
end cap faces up**

**Opening
faces up**

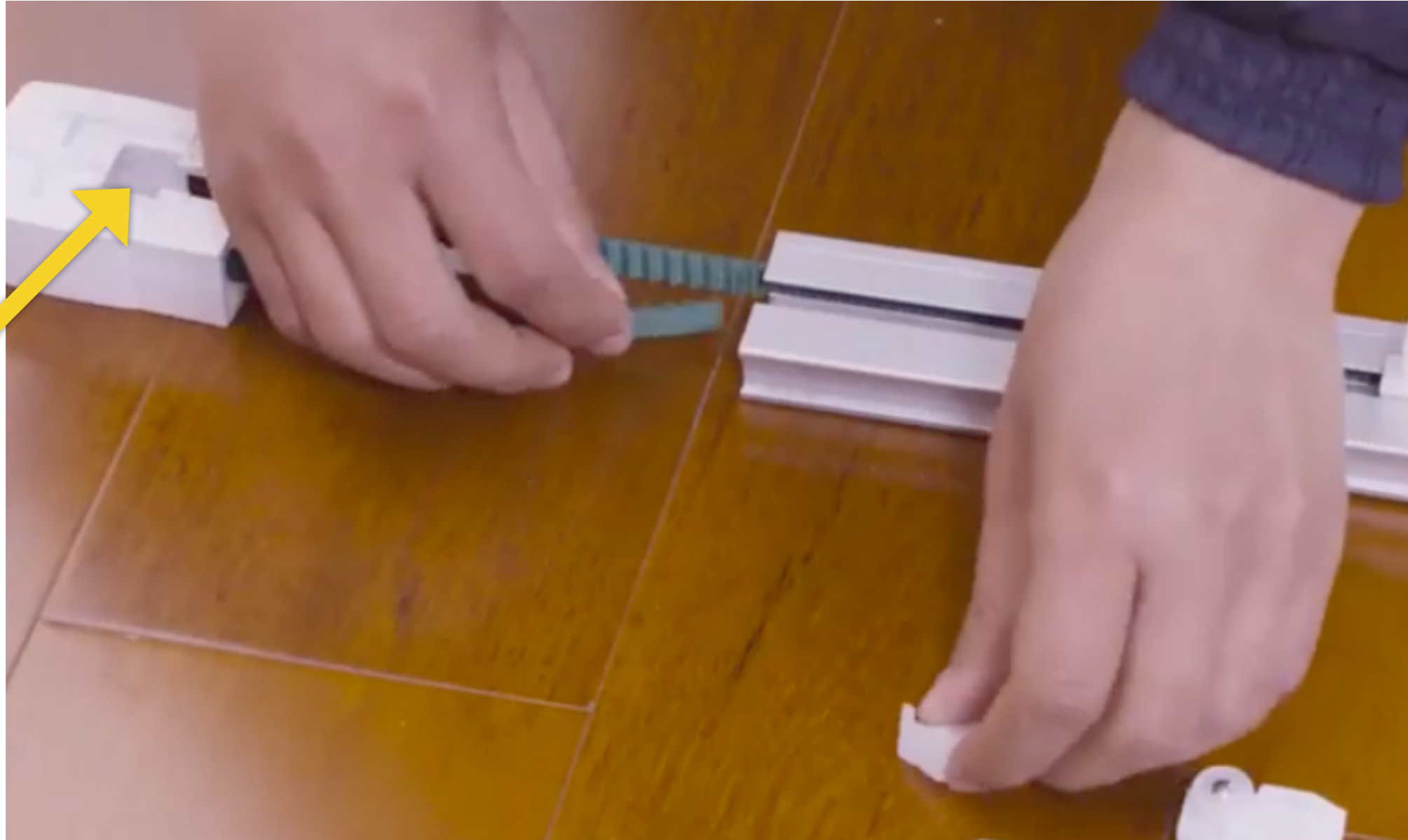

Centre Opening ONLY !

12. Attach the Belt buckle and runner wheel and insert into the track.



Don't put the runner wheel in the wrong way around, buckle first wheel nearest the endcap

13. Repeat on the other side

14. Assemble the two carriers

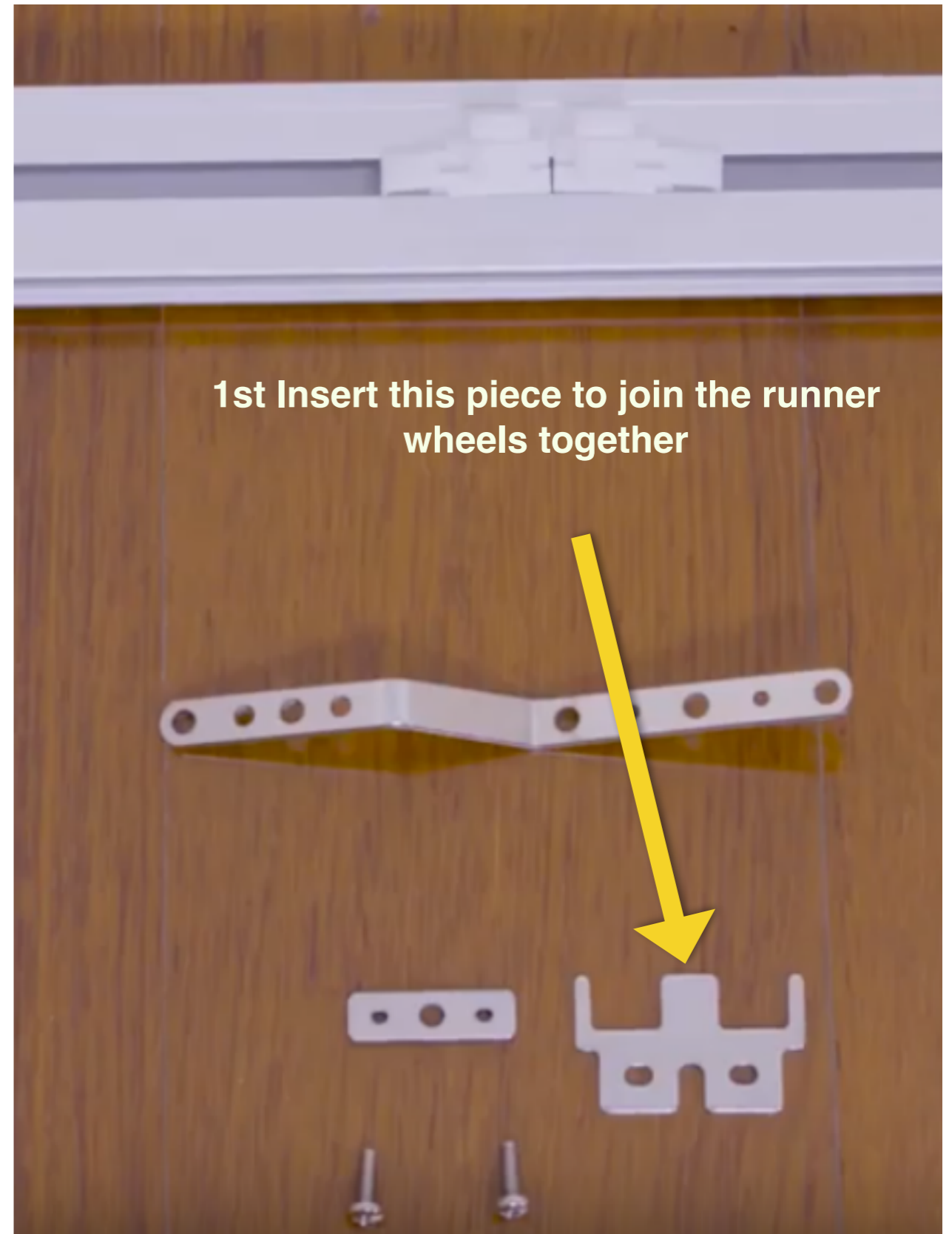

Centre Opening ONLY !

15. Completed Carrier Assembly, Test for smooth action then insert half of the wheels from each side, there are 8 wheels per meter of track.

16. When putting hooks on the curtains put 2 more hooks on each curtain than you have wheels on the rails

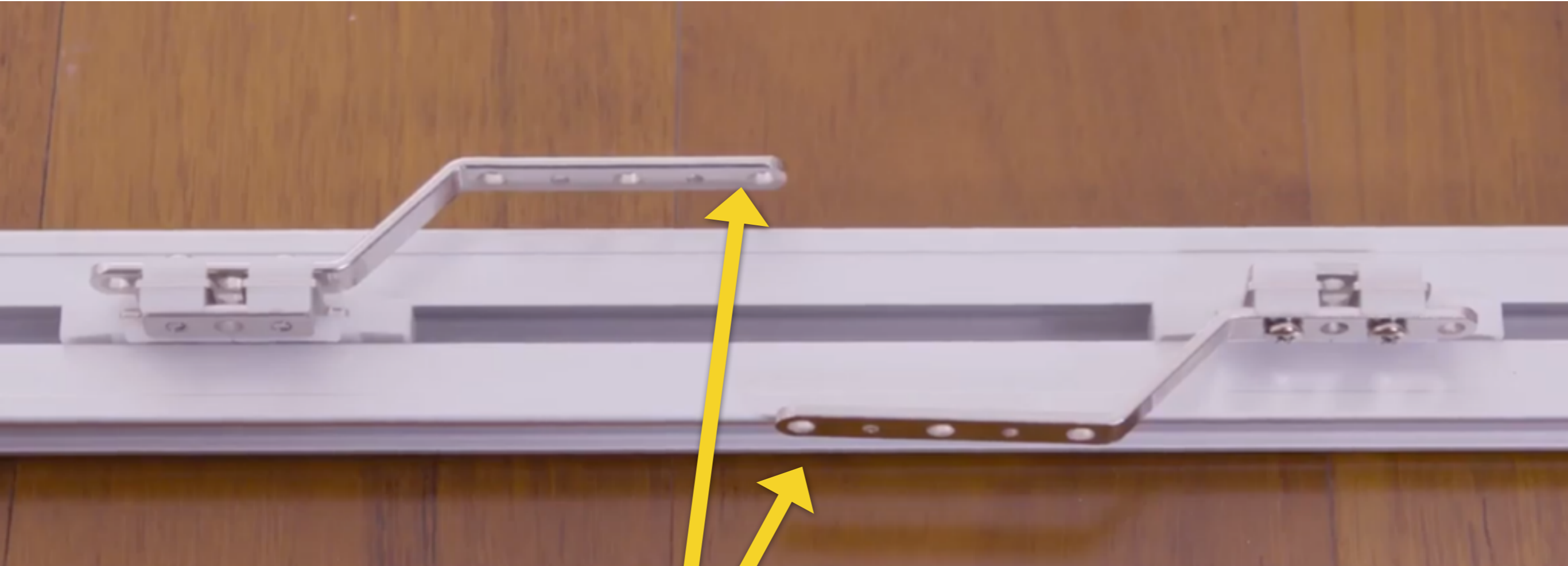

**17. First curtain hooks for each side will hook here
and the last on the rail tensioner**

Centre Opening ONLY !

17. Insert and tighten the rail tensioners



18. Use the Distance between the endcap and track to fine-tune the tension and easy movement of the assembly

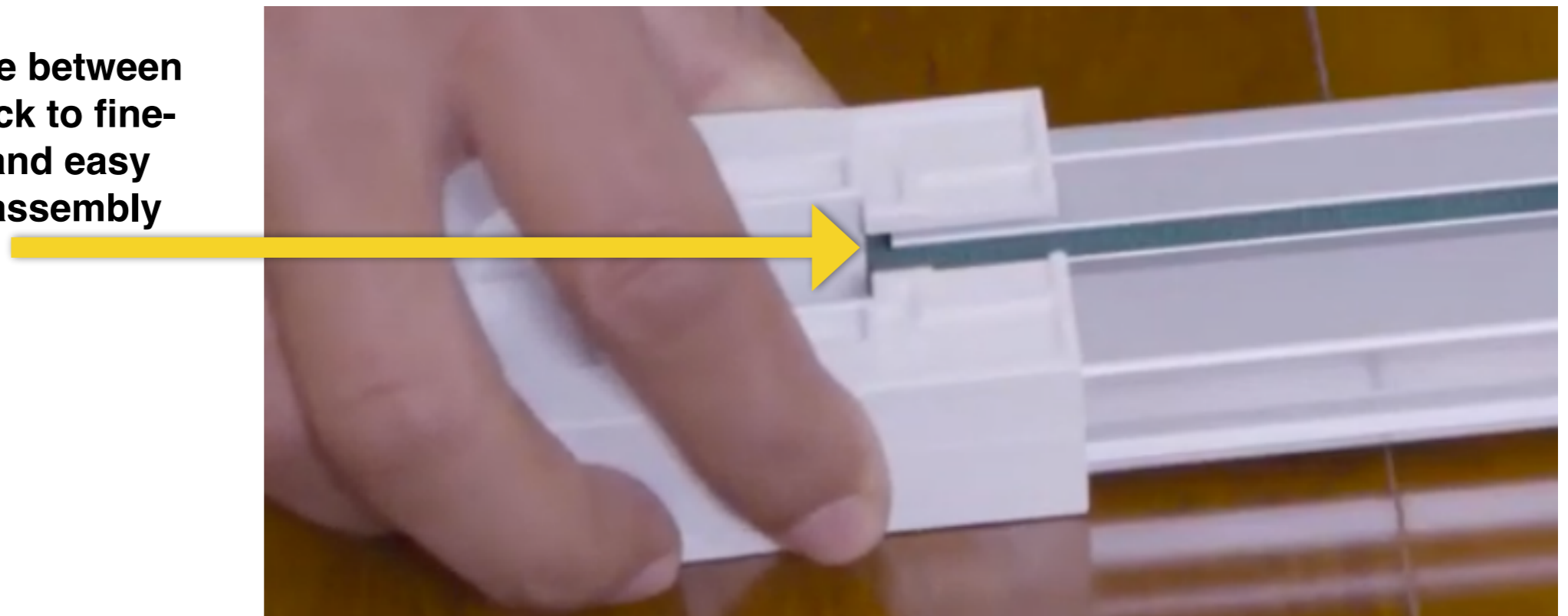

Centre Opening ONLY !

17. Insert and tighten the rail tensioners

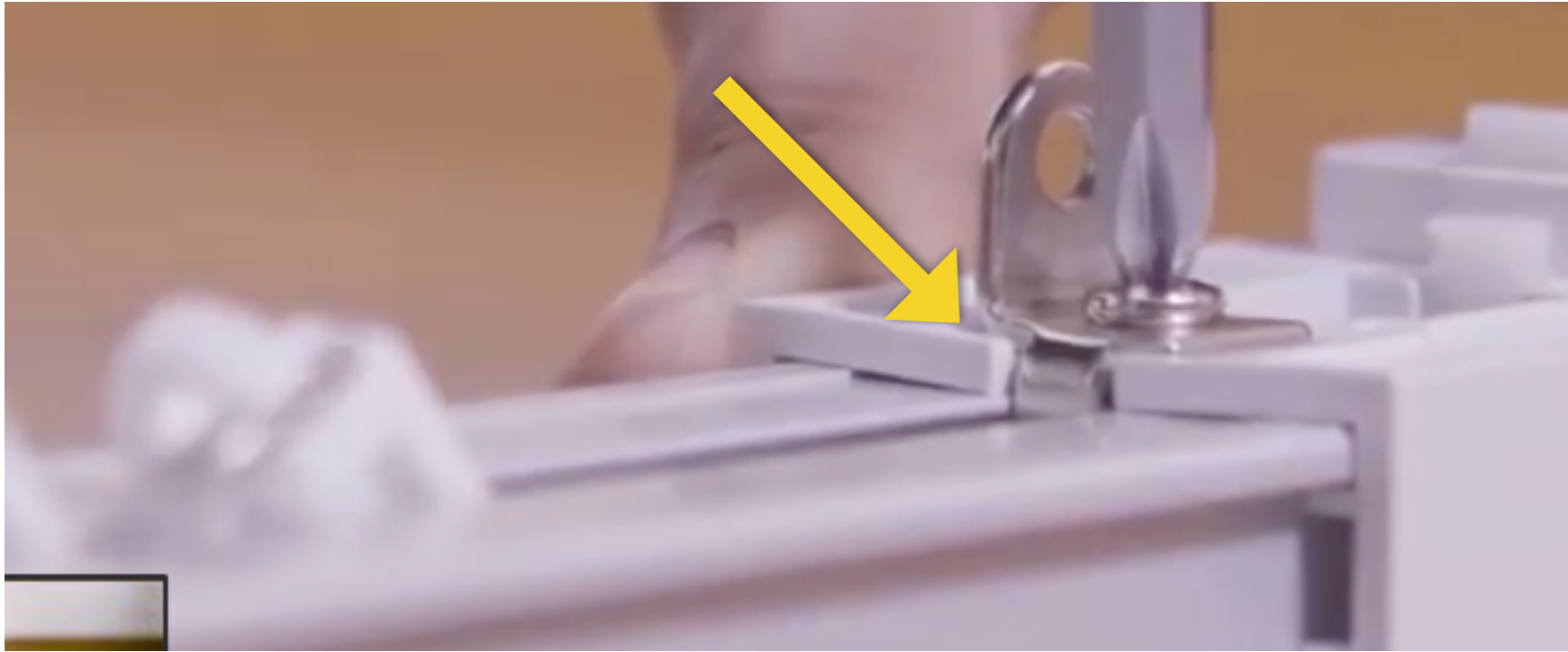

18. Use the Distance between the endcap and track to fine-tune the tension and easy movement of the assembly

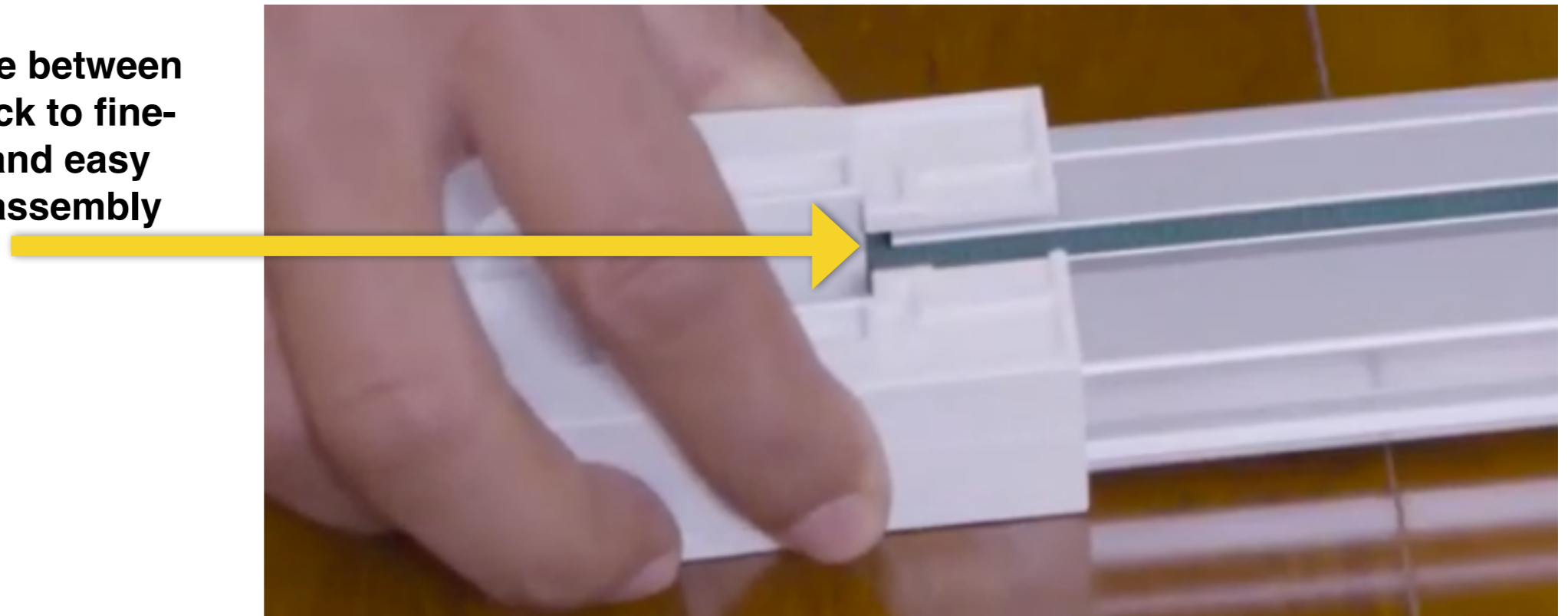

Side Opening Instructions ONLY !

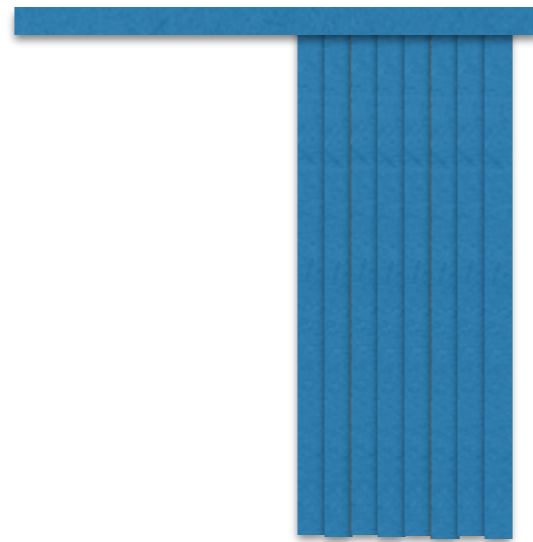

**Do not cut the Ribbon in to two pieces like
centre opening**



SIDE Opening ONLY !

Instructions

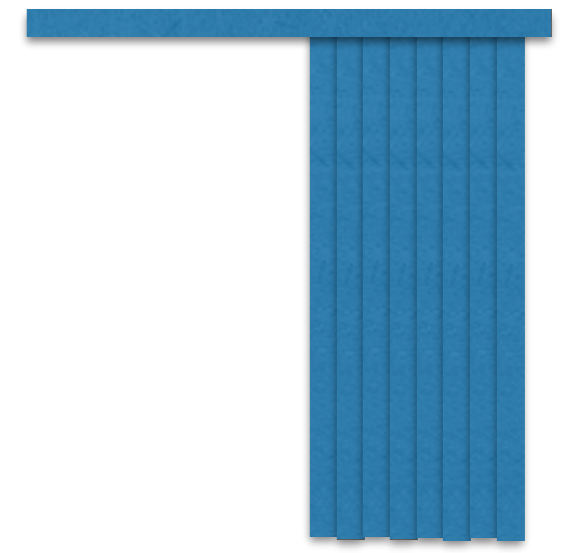

SIDE Opening ONLY !

1. Fix a buckle onto the one end of the belt



2. Press hard



3. Attach the runner wheel and feed through the track. Make sure the wheel of the runner wheel goes in after the buckle the wheel must not go into the track ahead of the buckle.



SIDE Opening ONLY !

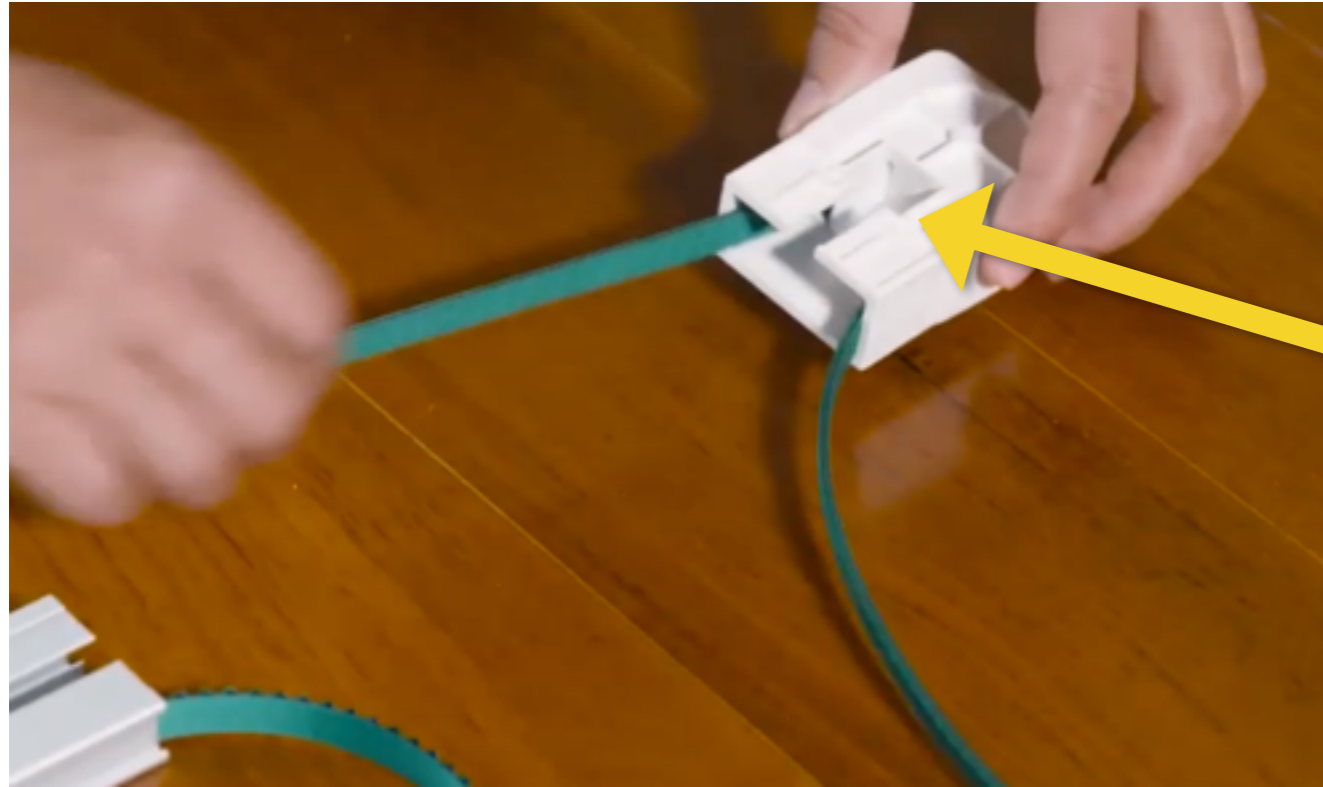

4. Feed the belt through the track end, make sure the wheel opening on the track end cap faces up

Opening faces up

5. Attach the endcap to the track and insert firmly but don't screw in place

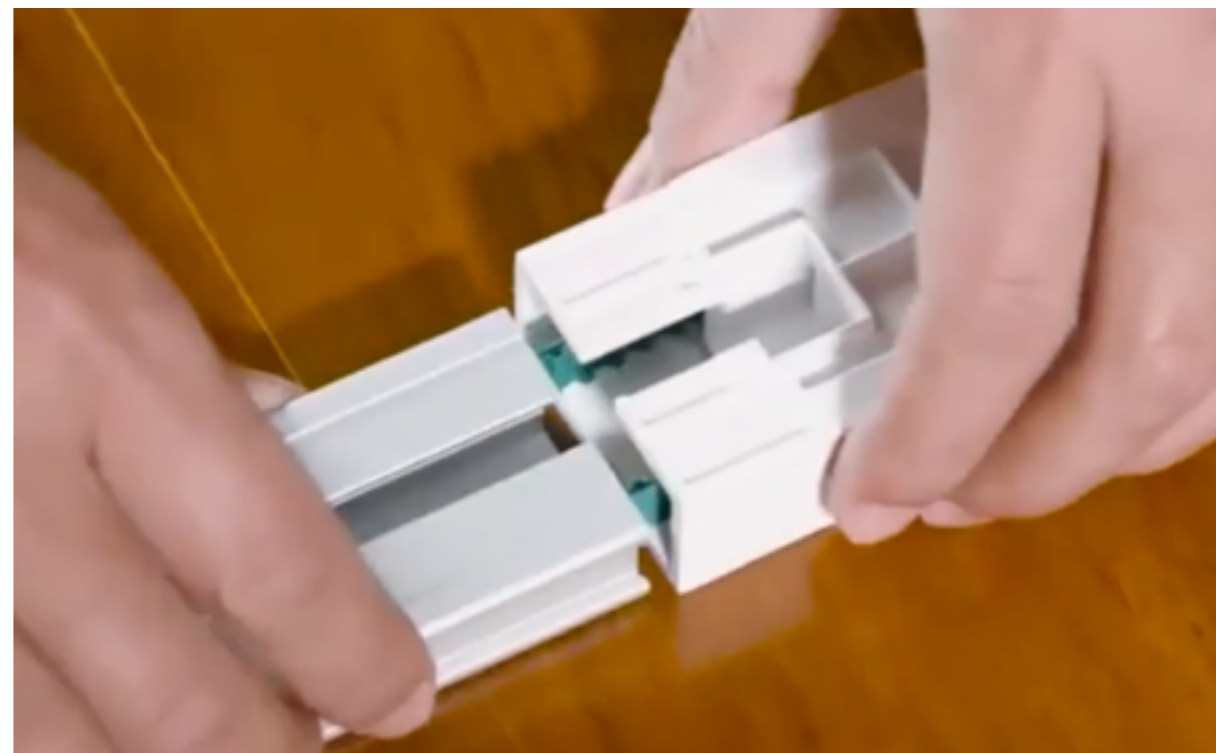

6. Feed the belt all the way through the track, through the Endcap and attach the 2nd runner wheel

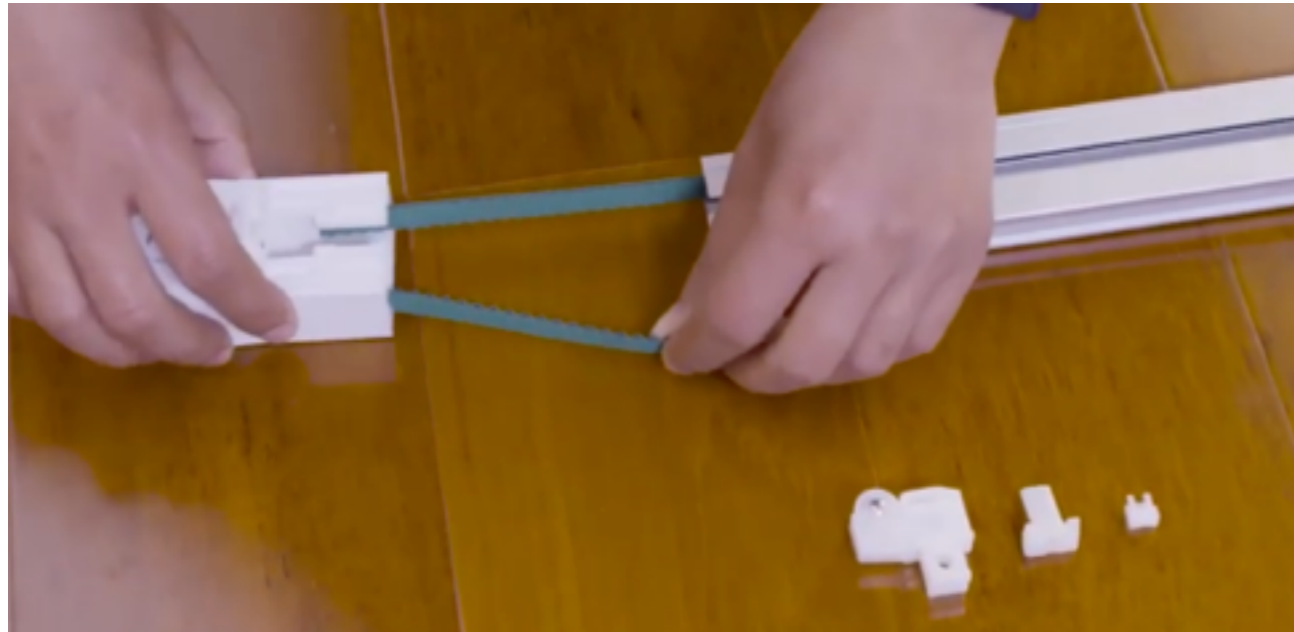

Make sure the wheel of the runner wheel goes in after the buckle the wheel must not go into the track ahead of the belt.

SIDE Opening ONLY !

7. Assemble the carrier

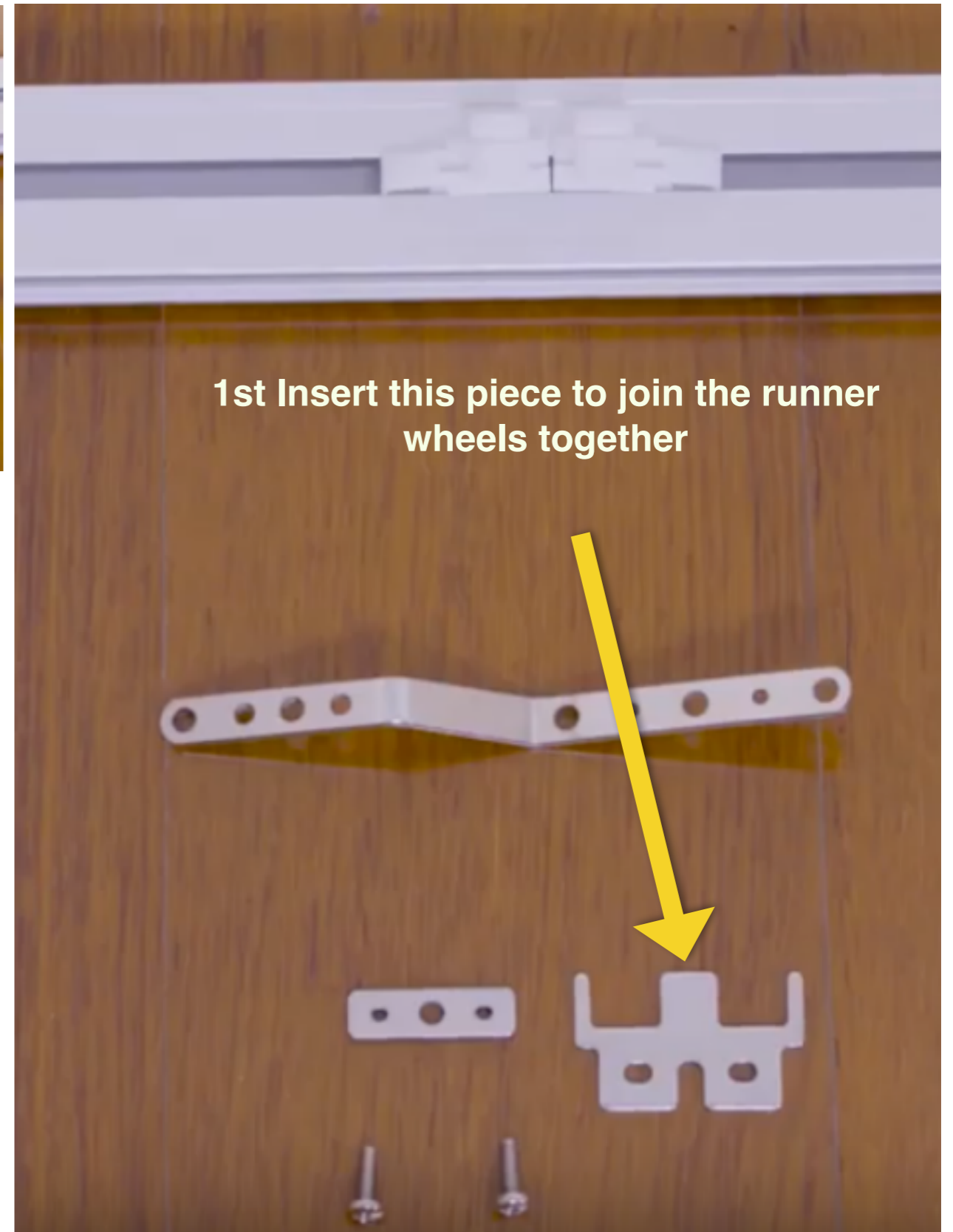

1st Insert this piece to join the runner wheels together

8. Insert the wheels and tighten the rail tensioners



9. Use the Distance between the endcap and track to fine-tune the tension and easy movement of the assembly

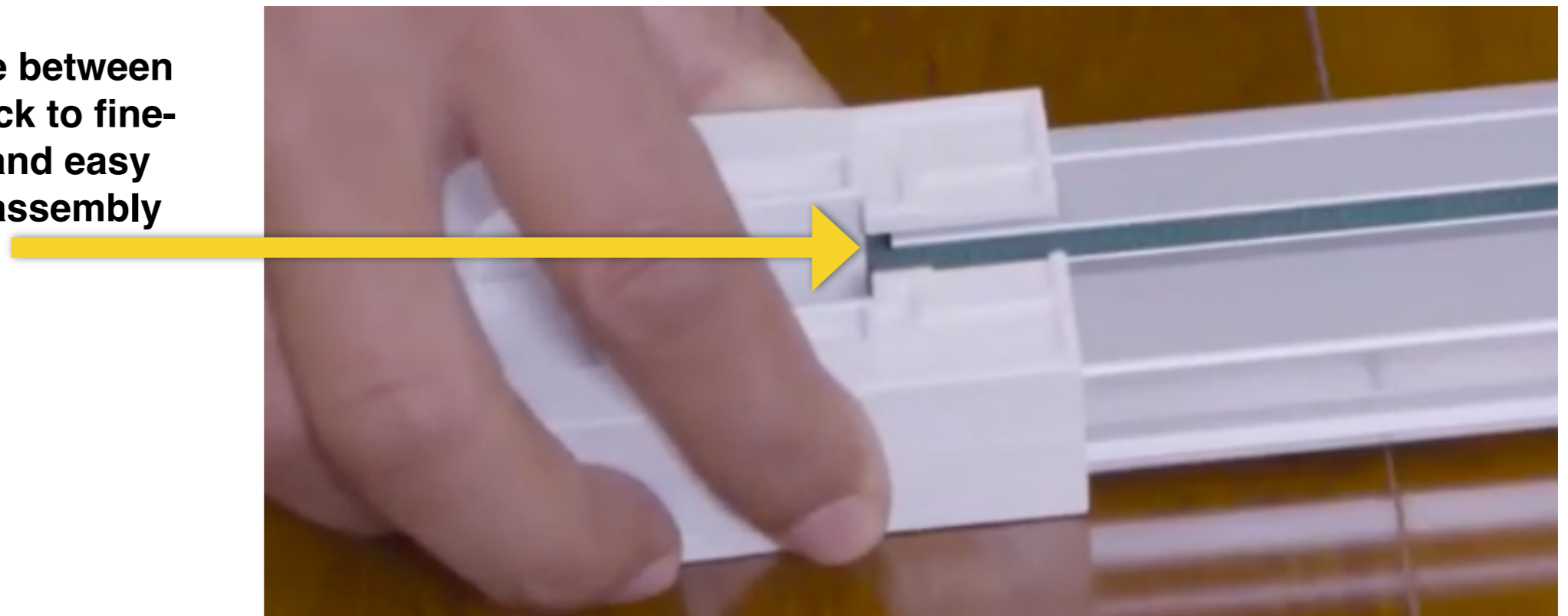

Fixing the Rails to the ceilings or wall brackets (Not Included)

1. **Attach the clip on brackets to the track. Then mark the appropriate height against the wall or ceiling for mounting the rail.**



**Fixing the Rails to the ceilings or wall brackets
(Not Included)**



2. Attach the Motor align the grooves and rotate Anti-Clockwise

3. Push the Clip upwards, before you rotate the motor if you need to remove the motor

SIDE
Opening
Reverse
Open and
Close
Direction

1. Fix a buckle onto the one end of the belt



**SIDE Opening Reverse Open
and Close Direction**
2. Press hard



3. Attach the runner wheel and feed through the track. Make sure the wheel of the runner wheel goes in after the buckle the wheel must not go into the track ahead of the belt.



SIDE Opening Reverse Open and Close Direction

Depending on whether the motor is on the left or right side of the curtain rail when mounted and if you want to open left or right; You might find that in the App you need to close the curtain to have it open, or use the open command to close the curtain. To change this you will need to do the following:

1. Dismantle the carrier.

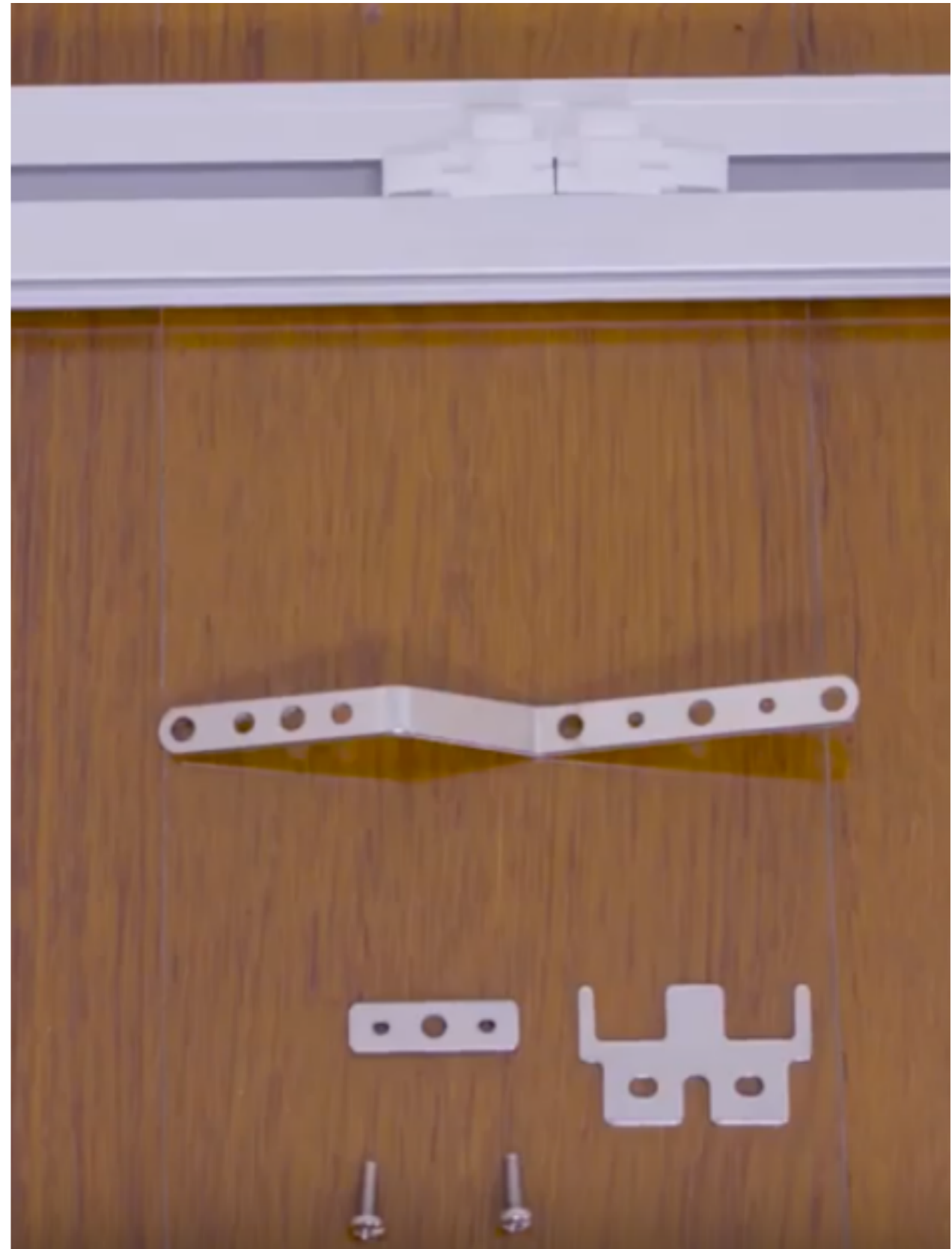

SIDE Opening Reverse Open and Close Direction

2. Remove the endcap.

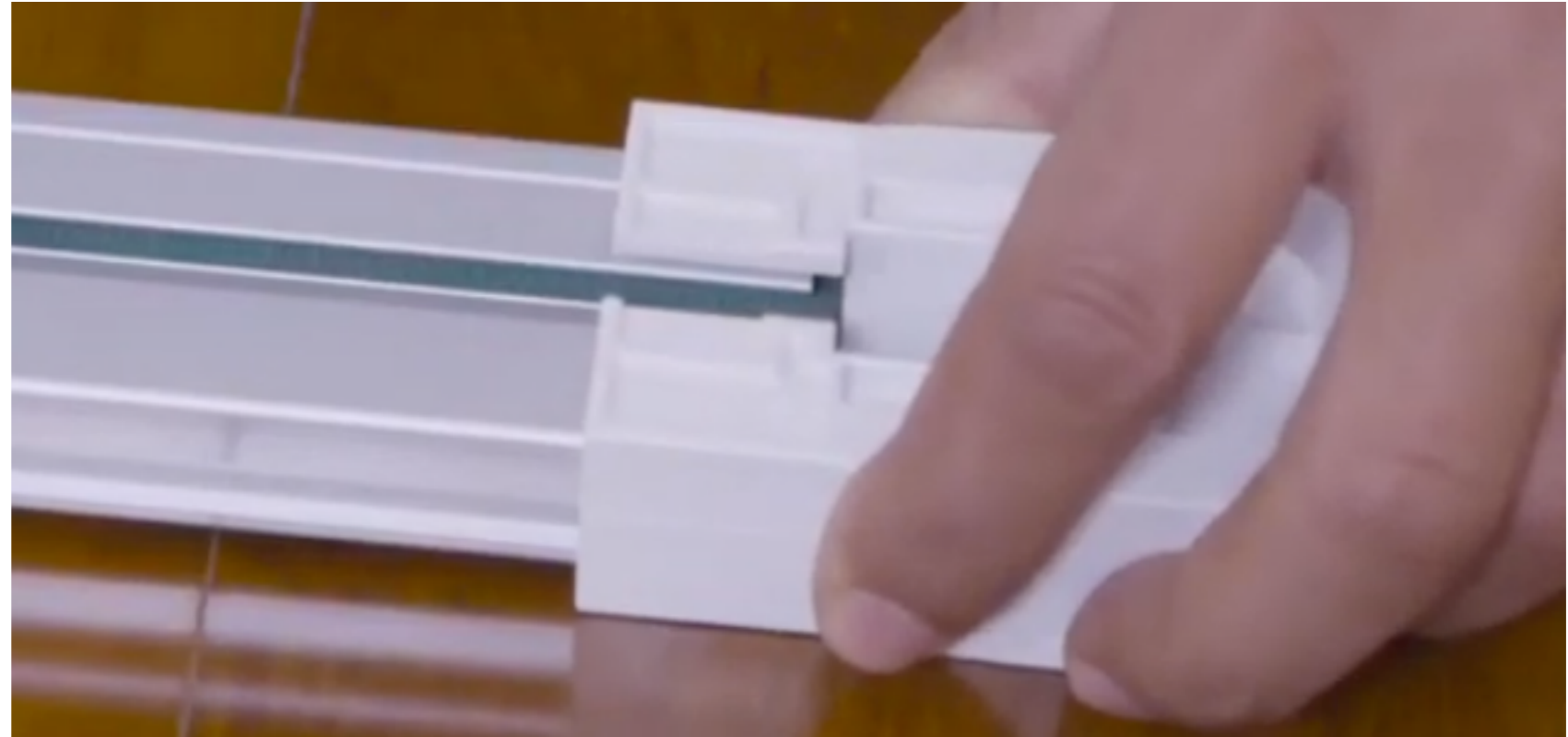

**3. As you slide the
Runner wheel out take
note of the direction of
the buckle !**



SIDE Opening Reverse Open and Close Direction

2. Remove the endcap.

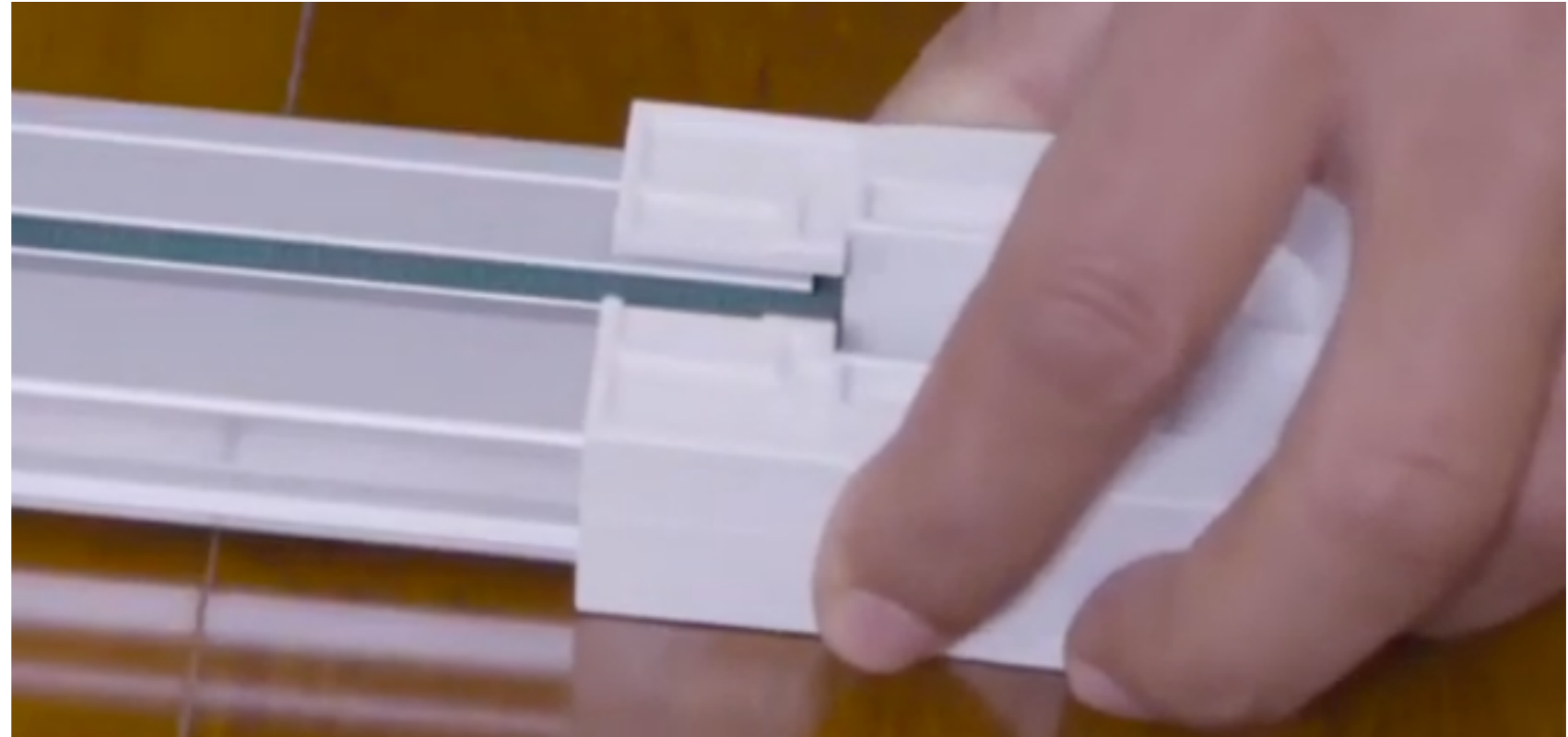

3. As you slide the Runner wheel out take note of the direction of the buckle !

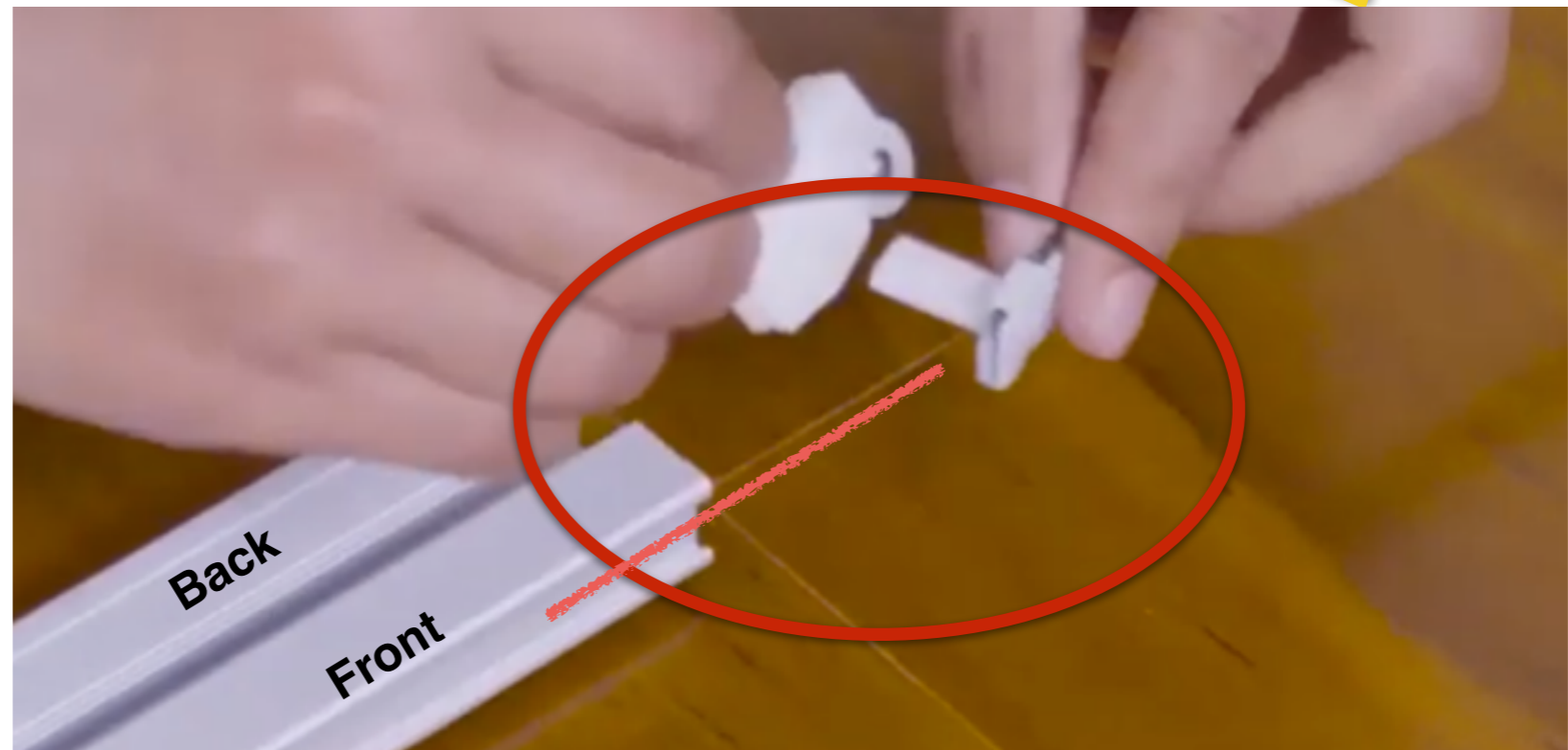

SIDE Opening Reverse Open and Close Direction

4. In this picture the buckle was inserted in the front of the rail, to reverse the open/close position the buckle must be inserted in the rear section of the rail

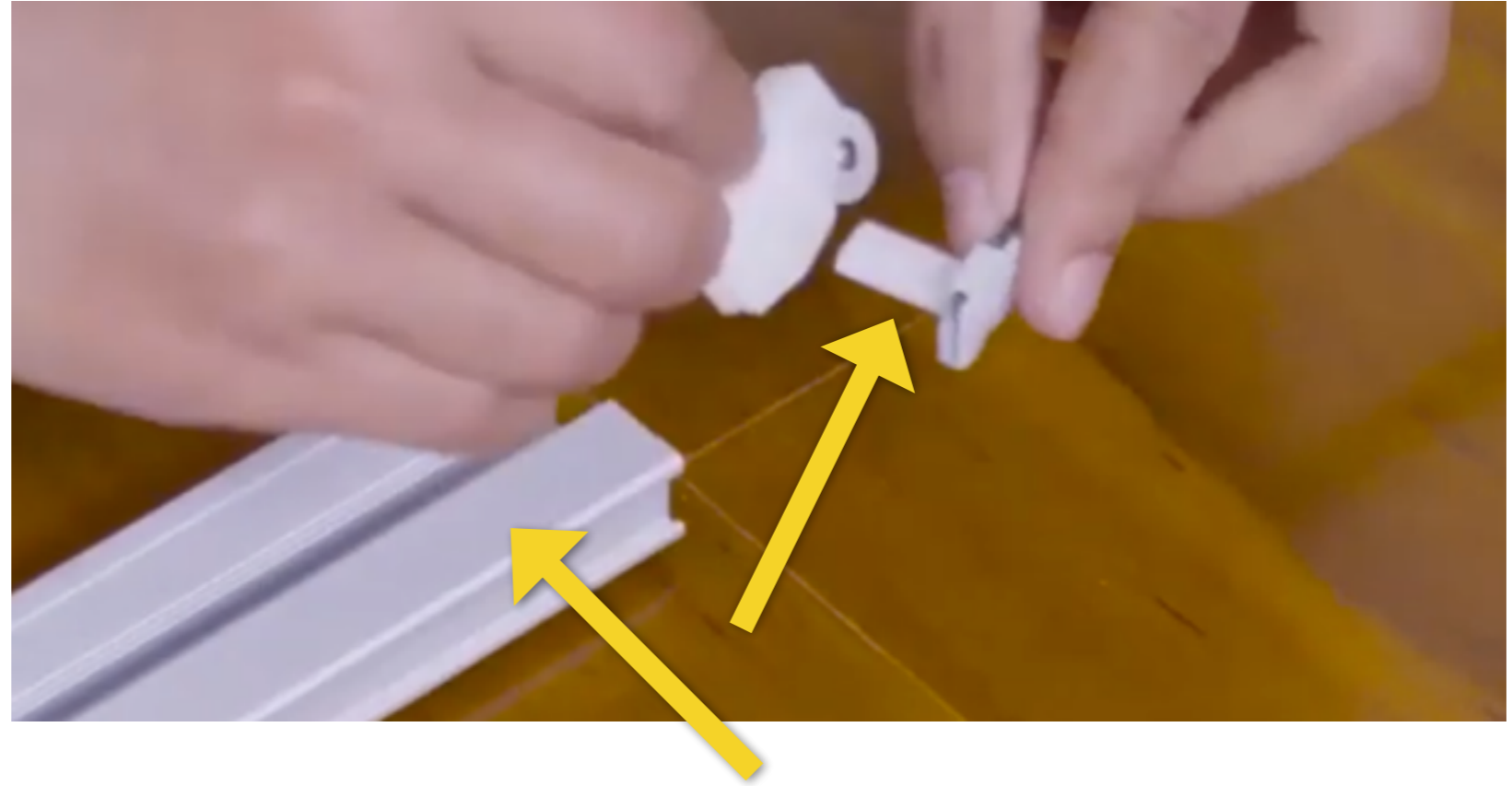

5. Remove the buckle from the ribbon and remove the 2nd runner wheel and buckle

SIDE Opening Reverse Open and Close Direction

6. Now feed the Ribbon through the endcap in the opposite Direction

7. The “join Side” of the Ribbon will now be on the opposite side of the track

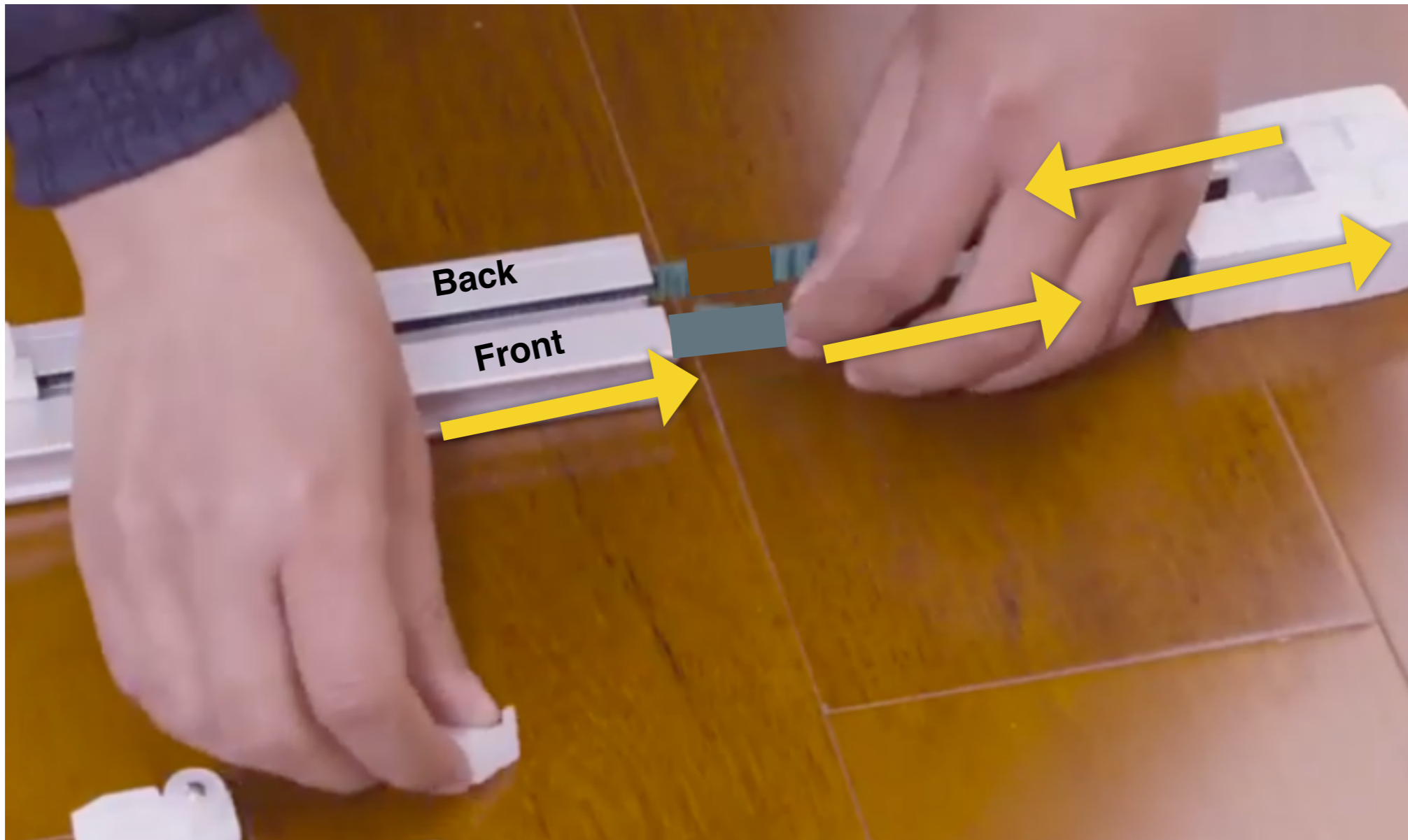

SIDE Opening Reverse Open and Close Direction

8. Where before the Buckle was in the front of the track, it will now be assembled and run the back of the track, thus reversing the direction of Open and Close

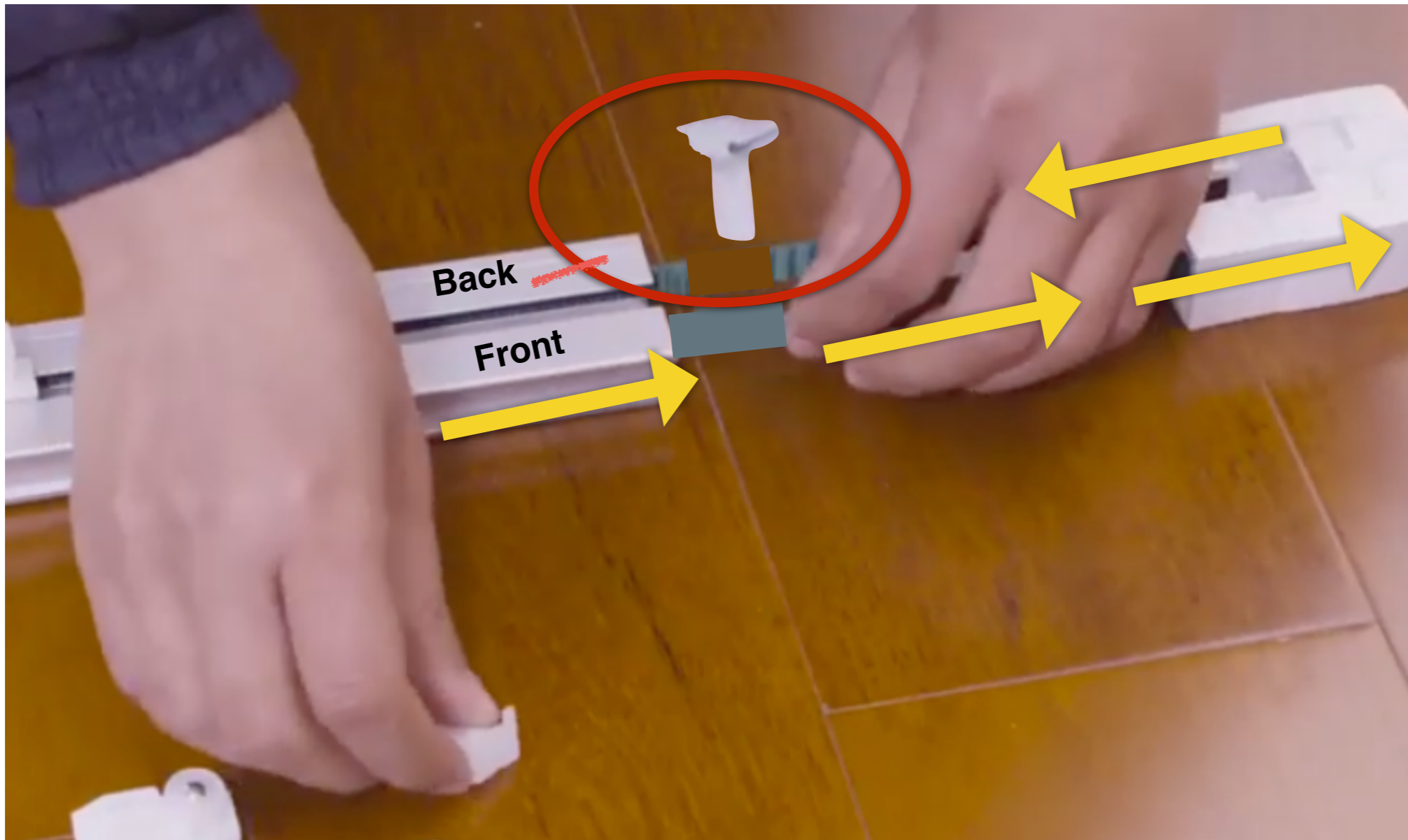

SIDE Opening Reverse Open and Close Direction

4. In this picture the buckle was inserted in the front of the rail, to reverse the open/close position the buckle must be inserted in the rear section of the rail



5. Remove the buckle from the ribbon and remove the 2nd runner wheel and buckle