

# MACHINE SPEC SHEET

## HP-1: High Pressure Cleaning System

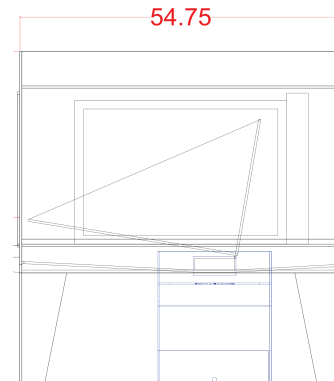
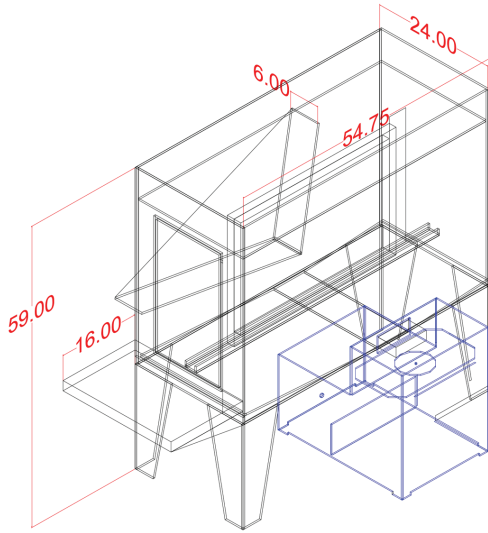

Customer Info	
Company Name	
Customer Name	
Email Address	
Phone Number	
Shipping Address	
Shipping Address	
City	
State	
Zip Code	

### Use:

Keep your screen cleaning mess contained with Bluewater's new HP-1 high pressure cleaning system. The HP-1 features a 2,500 psi pump, 2 running two-headed rotating spray wands that wash both sides of the mesh at the same time eliminating hand held pressure washers and unnecessary over spray.

### Manufacturers Notes:

- Filtration System Included
- Utility Pump Included (to eject water from filtration unit)
- Self Installation (services available if needed)
- Made and Manufactured in the USA

Machine Specs	
Air @ 6,9 (100PSI)	2cfm @ 100psi
Electrical	<input type="checkbox"/> 220 V, 1 ph, 31FLA, 50/60Hz <input type="checkbox"/> 208/230 V, 3 ph, 16FLA, 50/60Hz
Water	3/4" NPT Standard Fitting
Drain	3/4" or 1 1/4" NPT Utility Pump or Floor Drain
Max Frame Size	25" x 36"
Installation	<input type="checkbox"/> Self Install <input type="checkbox"/> Installation Services Needed
Crate Dimensions and Shipping Weight	
Body Length	54.75"
Standard Width	24.0"
Machine Height	59.0"
Machine Length	70.75"

### Instructions:

1. Clean off ink
2. Apply emulsion remover, dehaizer or degreaser chemical to the screen
3. Place frame inside the unit
4. Press the start button
5. Machine will run for 2 minutes
6. When the cycle is done, pull the frame out to dry