

Front Wheel WH-RS81-C35-TL-F

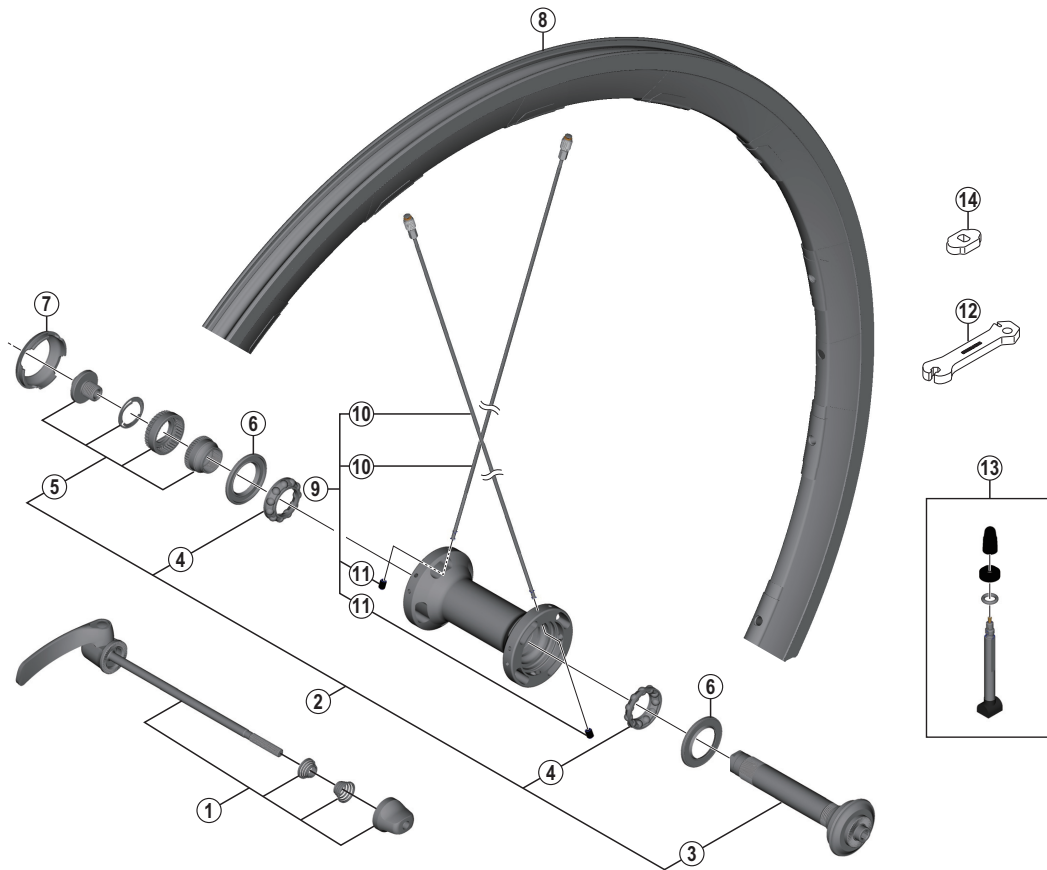

• Over Lock Nut Dimension: 100 mm (3-15/16")

ITEM NO.	SHIMANO CODE NO.	DESCRIPTION	INTERCHANGEABILITY		
1	Y49P98010	Complete Quick Release 133 mm (5-1/4")	A	B	A
2	Y49298020	Complete Hub Axle	A	A	A
3	Y49298030	Hub Axle Unit	A	A	A
4	Y26J98030	Ball Retainer (3/16")	A	A	A
5	Y49298040	Left Hand Lock Bolt Unit	A	A	A
6	Y28M07000	Seal Ring	A	A	A
7	Y49108000	Left Hand Dust Cover	A	A	A
8	EWHRIM2F4E	Rim {16H}			
9	EWHSPOKE272G	Spoke Unit {Spoke (276 mm x 16 pcs.) / Spoke Plug (16 pcs.) / Washer (16 pcs.)}			
10	Y47898010	Spoke (276 mm) w/Plug & Washer			
11	Y4G308100	Hub Nut	A	A	
12	Y4CK19000	Spoke Plug Wrench	A	A	
13	Y47898020	Valve Unit			
14	Y4RJ10000	Valve Tool			

A: Same parts.

B: Parts are usable, but differ in materials, appearance, finish, size, etc.

Absence of mark indicates non-interchangeability.

WH-RS81-C24-TL
WH-8800
WH-RS81-C35-CL

Jul.-2014-3709

© Shimano Inc. H

Specifications are subject to change without notice.

SHIMANO