

SLX Rapidfire Plus Lever

SL-M7000-11 (3/2x11-speed)

SL-M7000-10 (3/2x10-speed)

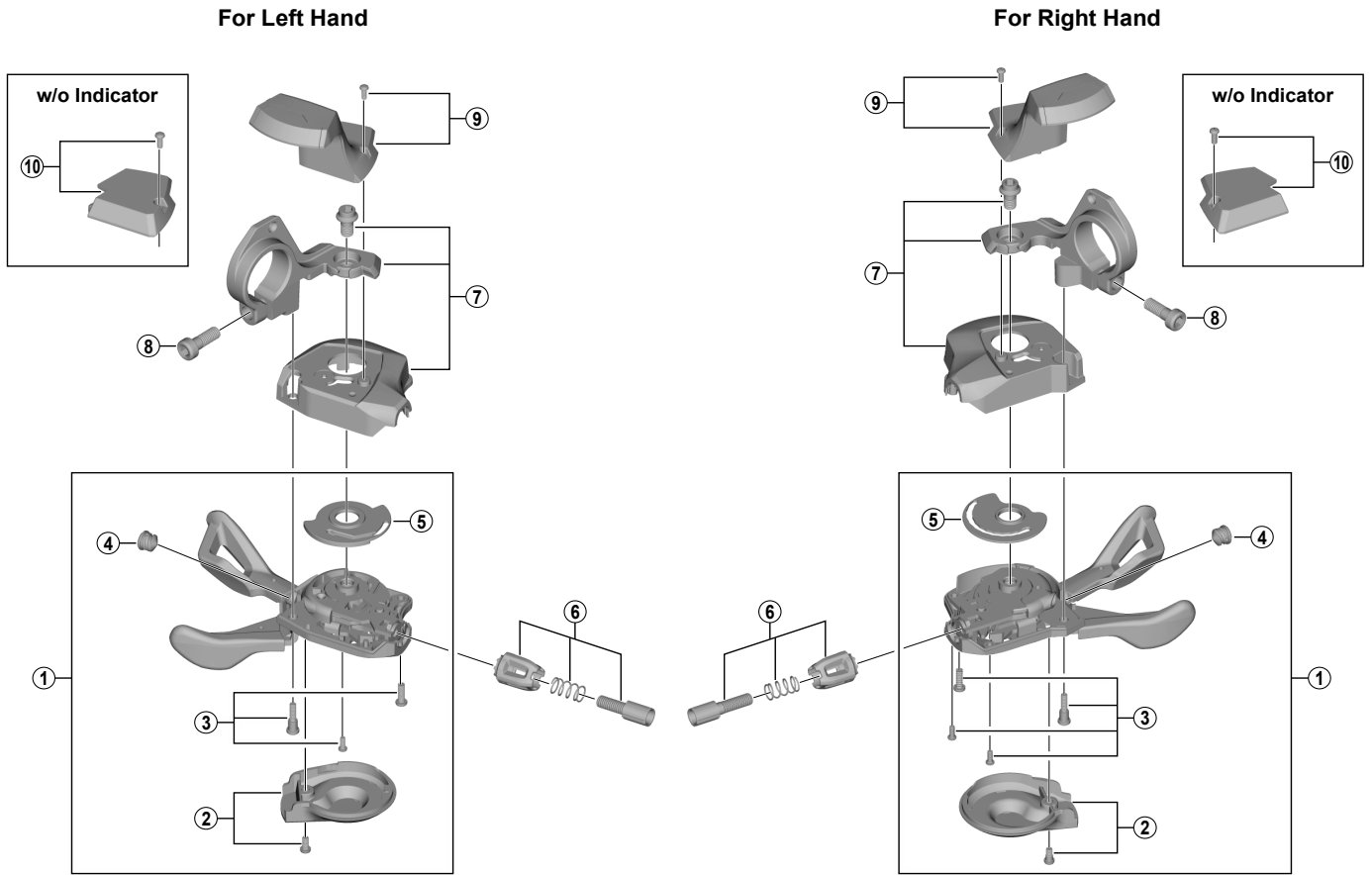

SL-M8000

ITEM NO.	SHIMANO CODE NO.	DESCRIPTION	INTERCHANGE-ABILITY
1	Y06M98010	R.H. Shifting Lever Unit for SL-M7000-11	
	Y06P98010	R.H. Shifting Lever Unit for SL-M7000-10	
2	Y06N98010	L.H. Shifting Lever Unit	
	Y06M98020	R.H. Main Lever Cover for SL-M7000-11 & Fixing Screw	
	Y06P98020	R.H. Main Lever Cover for SL-M7000-10 & Fixing Screw	
3	Y06N98020	L.H. Main Lever Cover & Fixing Screw	
	Y06M98030	R.H. Base Cover Fixing Screw Unit	
4	Y06N98030	L.H. Base Cover Fixing Screw Unit	
	Y6CD33000	Inner Hole Cap	A
5	Y06M05000	R.H. Cam Plate for SL-M7000-11	
	Y06P05000	R.H. Cam Plate for SL-M7000-10	
	Y06N55000	L.H. Cam Plate	
6	Y03K98030	R.H. Cable Adjusting Bolt Unit	
	Y06N98040	L.H. Cable Adjusting Bolt Unit	A
7	Y06M98040	R.H. Base Cover Unit for SL-M7000-11 w/Indicator Type	
	Y06P98030	R.H. Base Cover Unit for SL-M7000-10 w/Indicator Type	
	Y06N98050	L.H. Base Cover Unit for w/Indicator Type	
	Y06M98050	R.H. Base Cover Unit for SL-M7000-11 w/o Indicator Type	
8	Y06P98040	R.H. Base Cover Unit for SL-M7000-10 w/o Indicator Type	
	Y06N98060	L.H. Base Cover Unit for w/o Indicator Type	
9	Y6T842000	Clamp Bolt (M5 x 13.5)	A
	Y06M98060	R.H. Indicator Unit	B
10	Y06N98070	L.H. Indicator Unit	B
	Y06M98070	R.H. Base Cap & Fixing Screw	B
	Y06N98080	L.H. Base Cap & Fixing Screw	B

A: Same parts.

B: Parts are usable, but differ in materials, appearance, finish, size, etc.

Absence of mark indicates non-interchangeability.

Jul.-2016-4009A

© Shimano Inc. I

Specifications are subject to change without notice.

SHIMANO