

DURA-ACE SPD-SL Pedals
PD-R9100 (Standard / 4 mm Longer Axle)

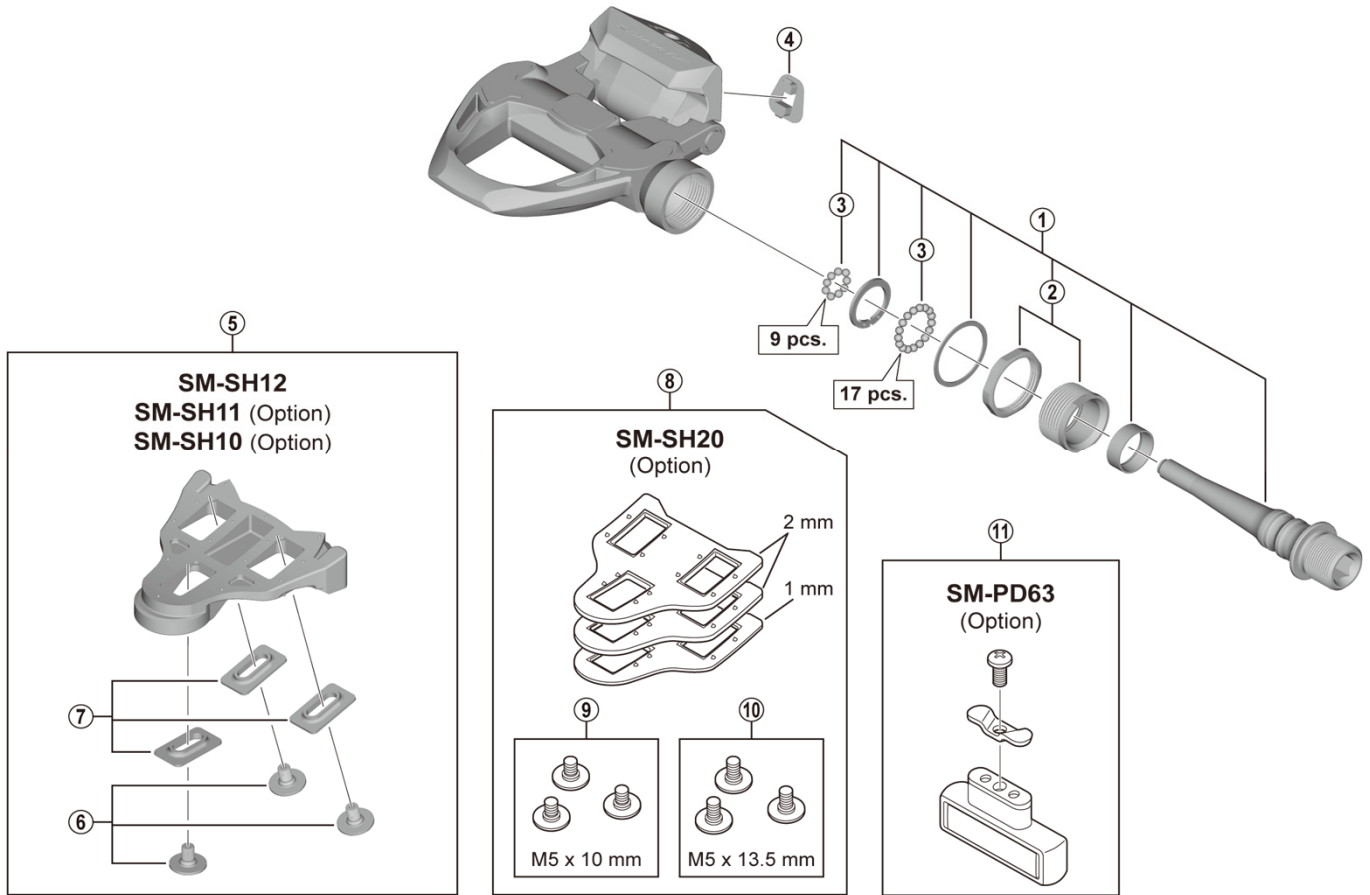

ITEM NO.	SHIMANO CODE NO.	DESCRIPTION	INTERCHANGEABILITY
1	YL8898010	Pedal axle assembly (right / B.C.9/16" x 20T.P.I.)	
	YL8898020	Pedal axle assembly (right / B.C.9/16" x 20T.P.I.) for 4 mm long type	
	YL8898030	Pedal axle assembly (left / B.C.9/16" x 20T.P.I.)	
	YL8898040	Pedal axle assembly (left / B.C.9/16" x 20T.P.I.) for 4 mm long type	
2	Y42X98060	Screw cup and lock nut (right)	A
	Y42X98070	Screw cup and lock nut (left)	A
3	Y41N98030	Steel ball (3/32") 62 pcs.	A
4	Y42U10800	Indicator	A
5	Y40B98140	SM-SH12 Cleat set (front center pivot / pair / standard type screw M5 x 8 mm)	A
	Y42U98010	SM-SH11 Cleat set (self-aligning mode / pair / option / standard type screw M5 x 8 mm)	A
	Y42U98020	SM-SH10 Cleat set (fixed mode / pair / option / standard type screw M5 x 8 mm)	A
6	YL8898050	Cleat fixing screw (lightweight type M5 x 8 mm / 6 pcs.)	B
7	YL8898060	Cleat washer (silver/6 pcs.)	A
8	Y40B98150	SM-SH20 Cleat spacer set (option)	A
9	Y42U98070	Cleat fixing screw (M5 x 10 mm) 6 pcs.	A
10	Y42U98060	Cleat fixing screw (M5 x 13.5 mm) 6 pcs.	A
11	Y46J98010	SM-PD63 Reflector unit (pair/option)	A
	Y46J98020	SM-PD63 Reflector unit (AS/pair/option)	A

A: Same parts.

B: Parts are usable, but differ in materials, appearance, finish, size, etc.

Absence of mark indicates non-interchangeability.

Specifications are subject to change without notice.

PD-9000

Apr.-2021-4056A

© Shimano Inc. I

SHIMANO