



# X SERIES LID

USER GUIDE

 **BREED**

# ASSEMBLY INSTRUCTIONS

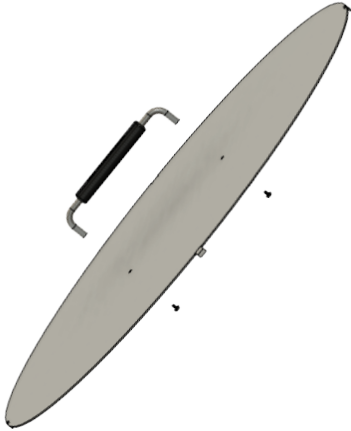

## STEP 1

Remove lid, handle, and screws from packaging.

## STEP 2

Gather a flathead screwdriver, and ideally have some sort of slot to hold the lid in place during assembly (between your legs works great).

## STEP 3

Using your fingers, begin threading the screws through the lid holes into the handle. (Lid tabs should be on bottom, handle on top).

## STEP 4

Using the flathead screwdriver, tighten the screws in place to firmly attach the handle to the lid.

# INSTRUCTIONS FOR USE



## STEP 1

Place the lid on your fire pit when the fire has burned down to ash only, or the fire is out completely.

## STEP 2

Never use your lid as a snuffer. Doing so can cause creosote buildup and dripping, as well as lid damage.

## STEP 3

The lid is designed to make the fire pit a perfect patio table when the fire pit is not in use.

## STEP 4

Using your lid to regularly cover your fire pit will prevent premature aging and damage to the metal.



## FOR YOUR SAFETY

Always wait until the fire has burned down to ash only, with no wood or large coals left in the fire pit. Putting the lid on your fire pit can damage the lid with the heat causing discoloration and warping, as well as causing creosote drips to form on your fire pit and the surface it is placed on. Creosote cools to a hard, tar-like substance that is very difficult to clean off of any surface, and can cause corrosion and discoloration.

Your lid is manufactured of heavy-duty, high-quality stainless steel, so care should be taken while handling it to ensure that it is not dropped or scraped against any body parts.

Lid edges may be sharp, so care should be taken at all times to ensure that it is handled in a safe manner by individual strong enough to keep it from damaging anyone or anything else in your backyard.

# HOW TO BUILD A BETTER FIRE

## STEP 1

**Prepare your fuel.** Paper, cardboard, pine needles, and dryer lint all make great starter materials. You'll also want a good supply of dry kindling and split hardwood.

## STEP 2

**Build a base** of starter material in the center of your fire pit. Add a layer of kindling and a match. No need for lighter fluid. Just like your grandad did it.

## STEP 3

**Take things one log at a time.** After the fire takes, slowly feed it more kindling. Once you've got that good and going, it's time for your split hardwood.

## STEP 4

**Don't add logs haphazardly.** Building tipi, lean-to, or log-cabin style means better airflow for your fire. Remember, the blaze needs to breathe.

## STEP 5

As your fire burns, keep it evenly spread throughout the fire pit.





Breeo, LLC warrants to the original purchaser that the Breeo Fire Pits and Accessories are free from workmanship and material defects during the lifetime of the original purchaser. In addition Breeo, LLC warrants no rust through or burn through for a period of five (5) years from purchase. If a product is covered by this limited warranty, Breeo, LLC, at its option, will repair or replace with a new product free of charge, excluding any applicable shipping and handling charges. If the product being warranted has been discontinued, the replacement product will be of equal or similar value. Altering any Breeo product, or using the product in any way other than the intended use, will void this Lifetime Warranty. Except as provided above, no warranty is offered on rust, paint or finishes due to being made with material with potential for corrosion. Steel products will develop a natural iron oxide patina over time.

Breeo, LLC's liability and obligation is limited to repair or replacement of the product, at their option. The purchaser must provide Breeo, LLC with photos of the product's defects for evaluation. Upon approval of warranty, Breeo, LLC will issue a return for repair, or return for exchange of the defective product.

This warranty does not cover damage or product failure caused by normal wear and tear, accident, misuse, negligence, tampering, modifications, act of war, overloading, improper attachment, improper maintenance, or failure to maintain. Breeo, LLC is held harmless for any injury or death caused by the misuse of this product. This warranty does not cover damage caused by proper or improper use of our products to any surrounding surfaces, structures, or furnishings. This includes, but is not limited to, discoloration or damage to a patio or deck surface, furniture, house, or any other structure.

This warranty gives you specific legal rights providing said product is put to its proper designated use.

THIS WARRANTY IS EXPRESSLY IN LIEU OF ALL OTHER WARRANTIES, EXPRESS OR IMPLIED, INCLUDING THE WARRANTY OF MERCHANTABILITY AND FITNESS FOR A PARTICULAR PURPOSE. NO ORAL AGREEMENT, GUARANTEE, PROMISE, REPRESENTATION OR WARRANTY SHALL BE BINDING. IN NO EVENT WILL BREEO, LLC BE LIABLE FOR ANY SPECIAL, INDIRECT, INCIDENTAL OR CONSEQUENTIAL DAMAGES EVEN IF BREEO, LLC HAS BEEN ADVISED OF THE POSSIBILITY OF SUCH DAMAGES AND EVEN IF BREEO, LLC HAS KNOWLEDGE THAT FAILURE TO PERFORM COULD CAUSE CONSEQUENTIAL ECONOMIC LOSSES. IN ANY EVENT, CUMULATIVE DAMAGES FOR BREACH OF THIS WARRANTY WILL BE LIMITED TO THE AMOUNT ACTUALLY PAID TO BREEO, LLC FOR THE PRODUCT. THIS PARAGRAPH SHALL APPLY TO ALL ACTIONS RELATED TO THE PRODUCT, WHETHER BASED ON TORT, CONTRACT OR OTHER THEORIES. THE PURCHASER ACKNOWLEDGES THAT THIS PARAGRAPH ALLOCATES THE RISK OF PRODUCT FAILURE BETWEEN BREEO, LLC AND THE PURCHASER, AND THAT THIS ALLOCATION IS REFLECTED IN THE PRICE PAID.

 **BREEO**

**WWW.BREEO.CO**

**(800) 413-9848**

**CONTACT@BREEOLLC.COM**

