

Maxi Twin

Transfer from chair

1

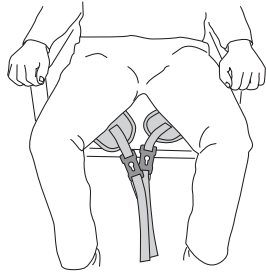

Place the sling around the patient so that it covers the lower back and the head support covers behind the head. Pull each leg piece and position it under each thigh.

2

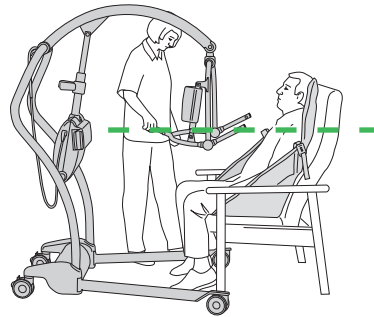

Position the lift in front of the patient. If needed, open the chassis legs. Adjust the spreader bar to shoulder height.

3

Loop sling

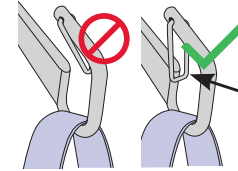

Clip sling

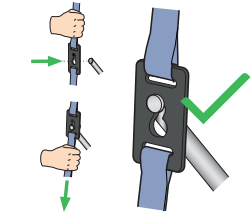

Attach the sling attachment clips or loops to the appropriate points on the spreader bar.

4

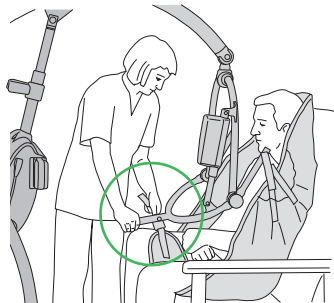

For lifts with DPS spreader bar: Press down on the positioning handle and attach the leg strap clips.

5



Risk of falling



Risk of entrapment

Make sure the brakes are not applied. Make sure sling is secured before lifting the patient.



Using the hand control raise the patient, adjust the positioning handle until the patient is reclined in the sling.

Continue with the steps on the next page

Transfer from chair (continued)

6

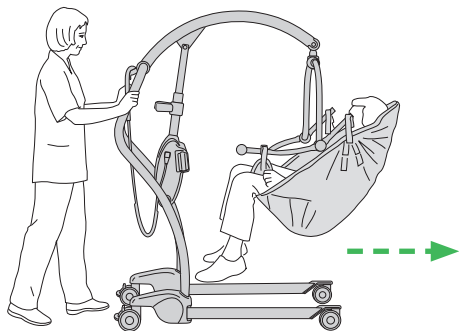

Close chassis legs and transport the patient.

7

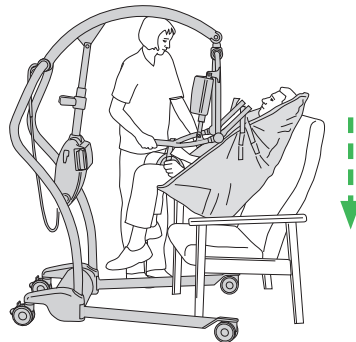

Lower the patient and adjust the positioning handle to bring them into a suitable position.

8

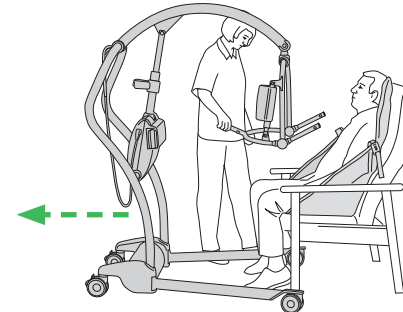

Detach the sling from the spreader bar.
Remove the lift, making sure patient's feet and body are clear of the lift.
Remove the sling from the patient.

Transfer from bed

1

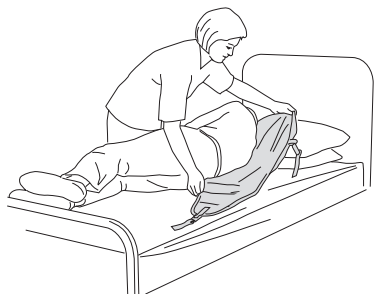

Roll the patient towards you. Fold the sling in half and place it behind the patient's back.

2



Position the sling so that the patient gets rolled back centrally on the sling.

3

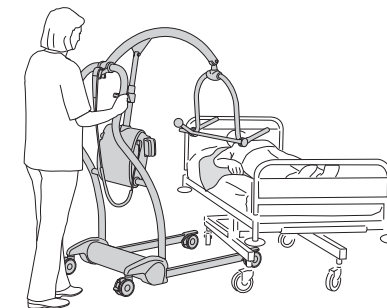

Approach the bed with the open side of the spreader bar towards the patient's chest.

Continue with the steps on the next page

Transfer from bed (continued)

4

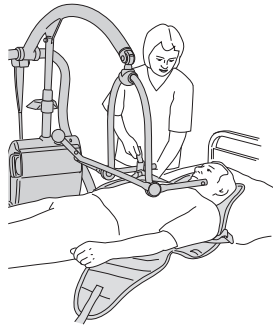

Position the spreader bar just above the patient. Tilt the spreader bar until the shoulder attachment lugs can be connected to the sling.

5

Loop sling

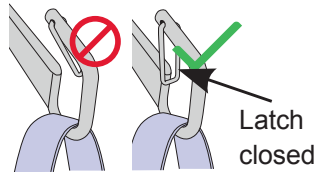

Clip sling

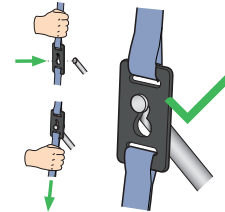

Attach the sling attachment clips or loops to the appropriate points on the spreader bar.

6

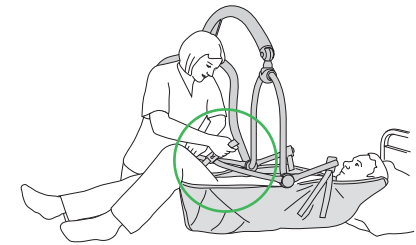

For lifts with DPS spreader bar: The leg pieces must be brought under the thigh. Press down on the positioning handle and attach the leg strap clips.

7



Risk of falling



Risk of entrapment

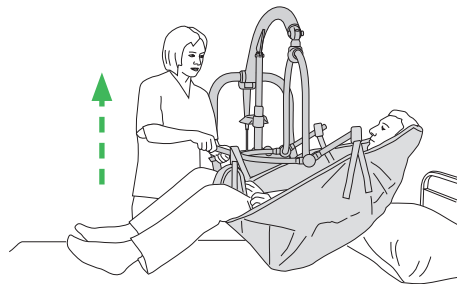

Make sure the brakes are not applied. Make sure sling is secured before lifting the patient.

Lift the patient using the hand control and adjust the patient to a comfortable position. Transfer the patient.

8

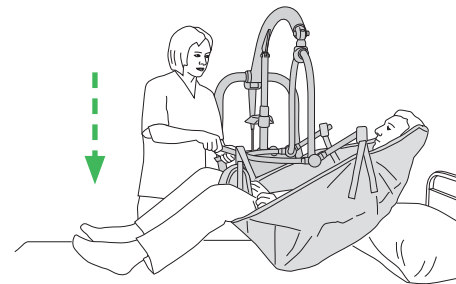

When returning to a bed: Use the sling lift handles to position the patient over the bed. Do not pull the sling. Use the hand control to lower the patient.

9

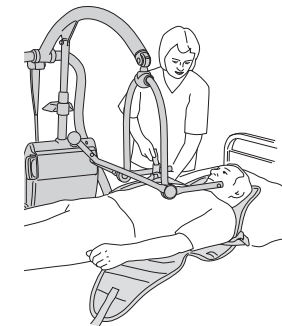

Detach the sling from the spreader bar. Remove the lift, making sure patient's feet and body are clear of the lift. Remove the sling from the patient.

