



# INSTALLATION MANUAL

Manual Brel Bi-directional Wifi Curtain Rail Motor

## BGLE-980

Read the manual before you begin the installation. If these instructions are not followed, this may lead to defects and injury in which warranty can't be claimed.



BREL HOME

[www.brel-home.com](http://www.brel-home.com)

Visit our website for more manuals and information



BGLE-980

Scan the QR code here for the manual to download & view instructional videos

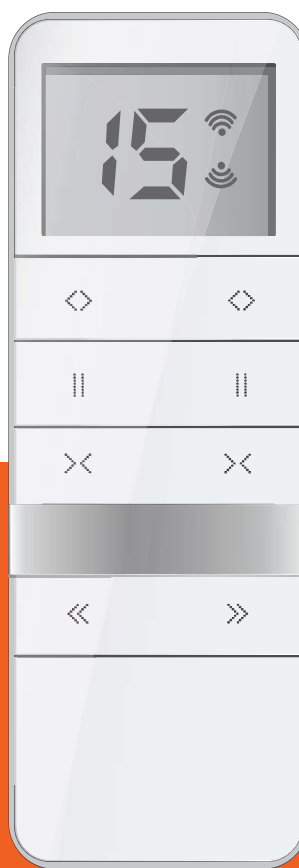

## Table of Content

Warning	2
Switching installation of the curtain motor	3
Works with all BREL transmitters	3
Technical data of the motor	3
Functions remote control/Function/ Installation of the Motor	4
Settings	5

### Warning

It is important to follow this instruction for your own safety.



Do not operate the motor in humid surroundings.



BREL-Motors declares that this motor has been manufactured according to the guidelines of the CE standard 1999/5/EC



The motor must be protected from direct moisture influences.



Keep the antenna in a good condition and do not shorten. The antenna should not come into contact with other metal parts otherwise it will reduce the effect.



The motor must be installed correctly.



This product must not be disposed of with household waste. Take the remote control and battery to the designated collection points"



Children cannot recognize the dangers of electrical equipment and may therefore not work with it.

## Switching installation of the curtain motor

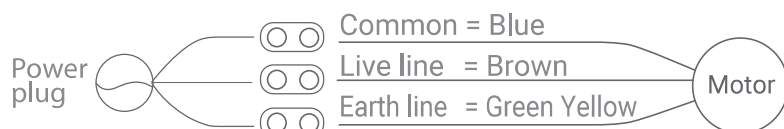
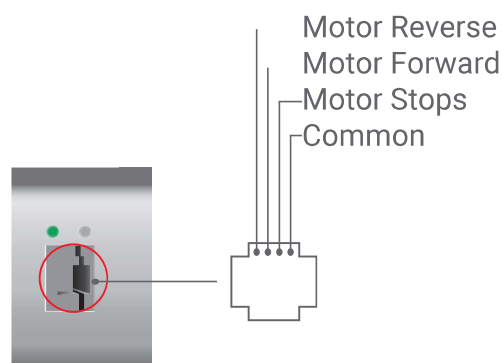
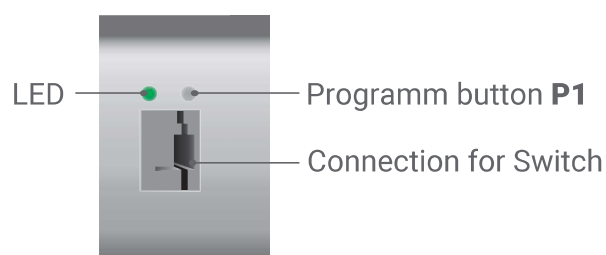

## Works with the BREL HOME app

You just need to download our BREL HOME app to operate the motor with your mobile/cell phone.

As it is a wifi motor it can be connected to BREL HOME app without using a hub.

You connect the motor via the app on your home Wifi network and you can install the motor as described in the app.

If you want to install the motor by emitter, you have to follow the steps in this manual.

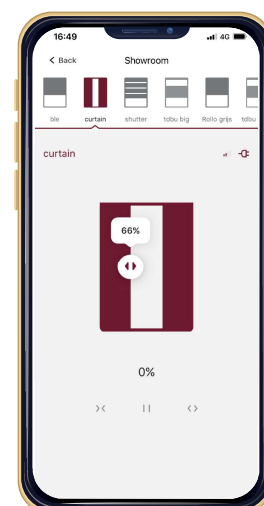

## Technical data of the motor

**BG-980**

Torque	1.2 nm
Open/Close Speed	14 cm per sec.
Voltage Motor	AC 100-240V
Max. Curtain Weight	40 kg
Radiofrequency	433.925MHz
Moisture and Dust Protection	IP20
Storage Capacity Transmitters	Up to 20 Channels
Temperature range of the motor	Normal Use : -5°C to +55°C
Frequency	 433Mhz 2.4Ghz (wifi)

## Functions Remote control

DD-1852

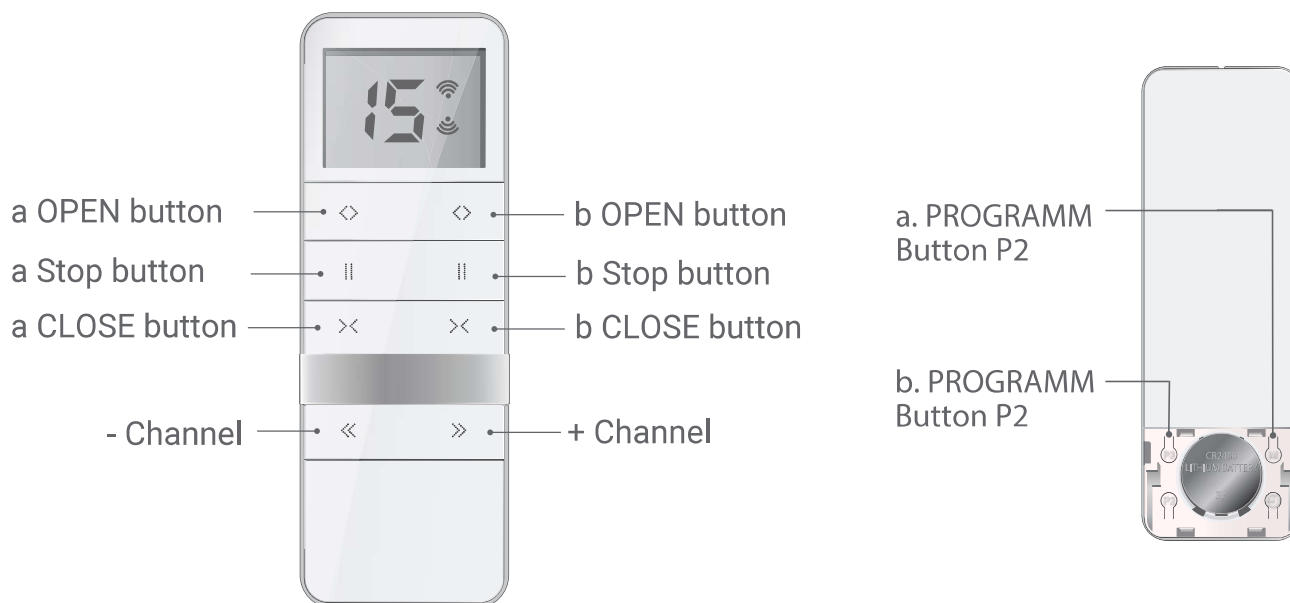

Scan the QR code to view the manual and instructional videos

BG980



## Reach

L1 = 100 meter

L2 = 20 meter





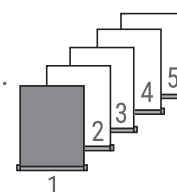

### Step 1 Setting up the first remote/channel

-  The remote control can transmit 15 channels and therefore control multiple blinds. First, select a channel for operating the relevant roller blind. Make sure that you select a free channel (we recommend only 1 product per channel).
-  This remote has also channel 0. All blinds programmed in channel 1~15 are automatically programmed in this channel 0 and can be operated all at once.
-  In case you have selected the wrong channel, go to **Resetting factory settings**.



► **Select the desired channel.**

## Step 2 Establishing connection

-  In the procedures described here is a maximum interval of 10 seconds to complete each subsequent action: if you wait any longer, the system will leave the edit mode.
-  Normally a button only needs to be pressed shortly. If you need to press and hold a button for several seconds this will be state clearly.
-  The system will confirm each completed step with moving the blind up and down (↕).
-  If a procedure does not play out as described, wait for 20 seconds and start again from the beginning of that step/procedure.

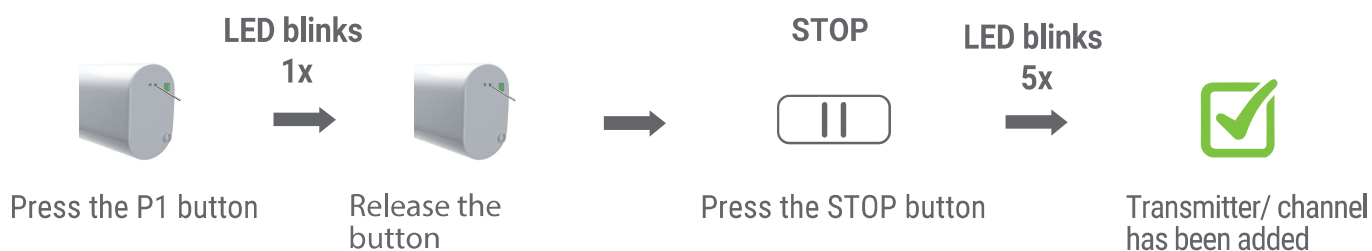

-  If NO end positions are set, the product will move in the pulse / step operation. Go then to STEP 3. If end positions are set, the product will continue to its end position. Go then to STEP 5.
- WARNING:** It is possible that the correct end positions have not been set. Go then to OPTION A.

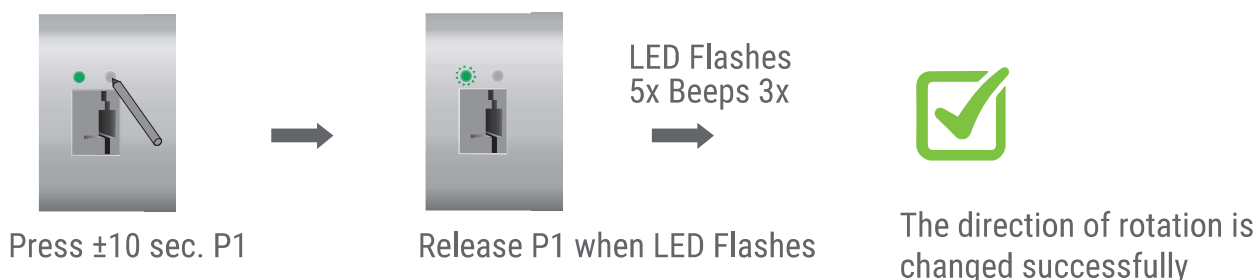

## Step 3 Adjusting the direction of rotation *(Only if the direction of rotation is not correct)*

Only possible if no end positions are set.

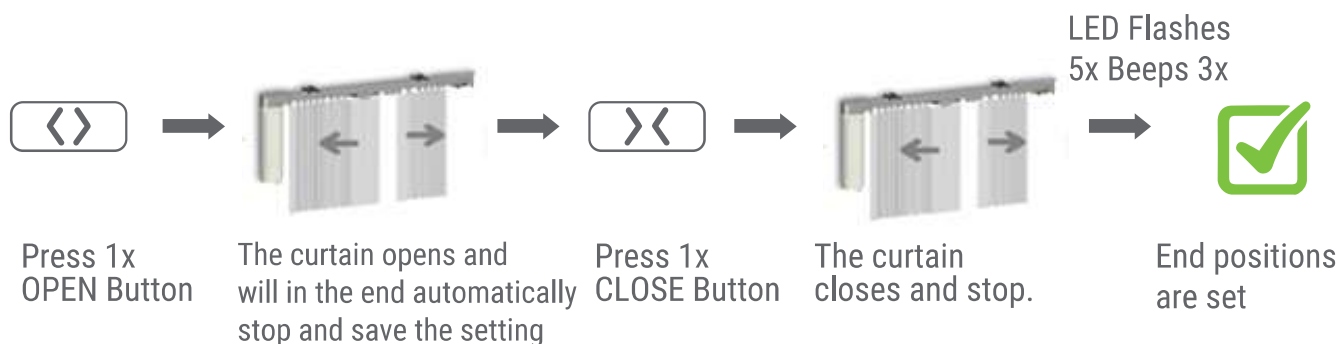

## Step 4 Setting the End Limits



-  **The curtains are now ready for use.**
-  If you are not satisfied with the result of setting the end positions, go to Option A - adjusting positions or **Resetting factory settings.**

## Step 5 Setting the favorite position (If desired)

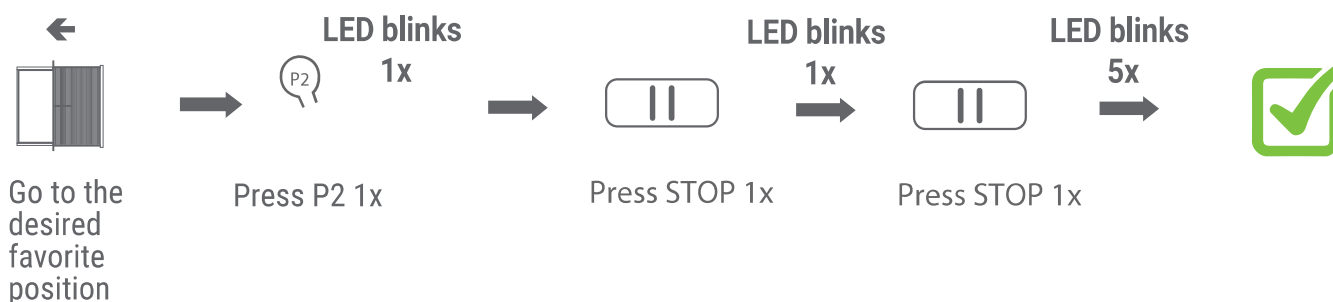

**i** Press and hold STOP for 3 seconds to move to the favorite position.

**i** Since the procedure is identical, to remove it repeat the steps.

## Additional settings

### Option A Adjusting the open position

**i** If adjustment is not possible, go to **Resetting factory settings**.

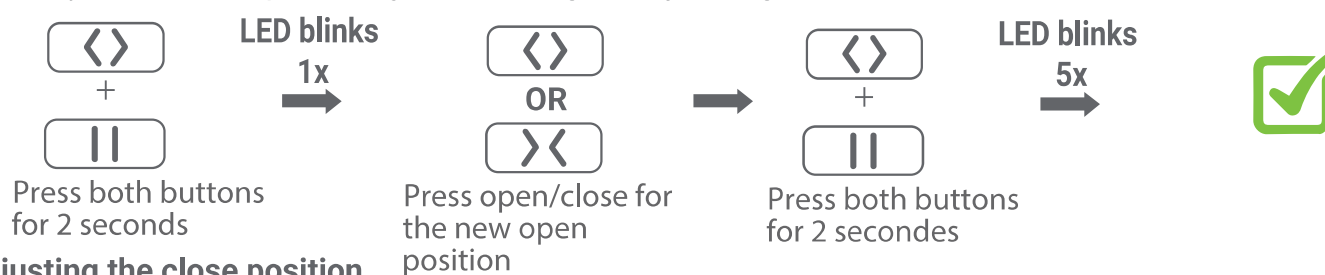

### Adjusting the close position

**i** If adjustment is not possible, go to **Resetting factory settings**.

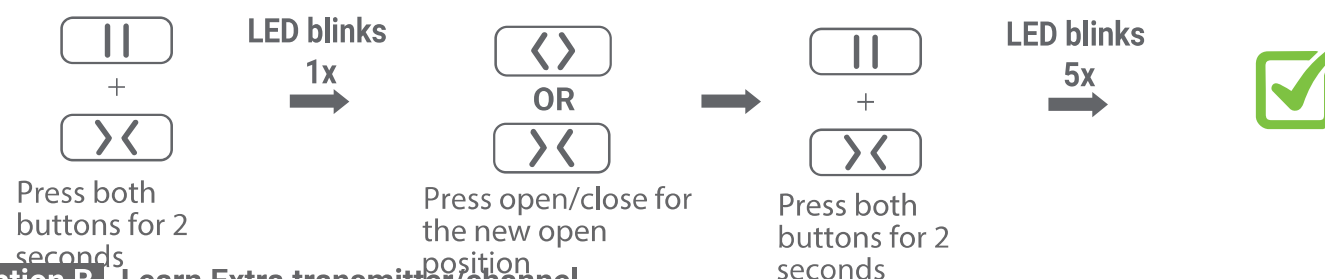

### Option B Learn Extra transmitter/channel

**i** Make sure the new transmitter is in the desired channel.

**a** = Already existing transmitter/channel

**b** = New transmitter/channel

**NOTE** To delete the transmitter / channel repeat the procedure.

#### Method 1

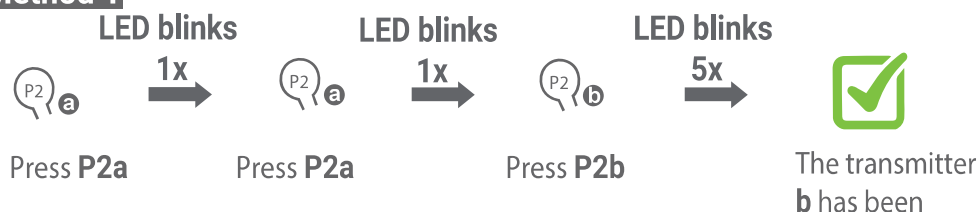

#### Method 2 (In case the old transmitter is lost or broken)

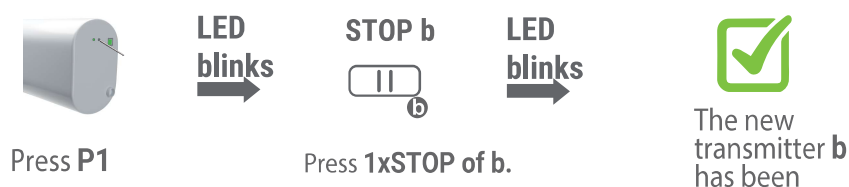

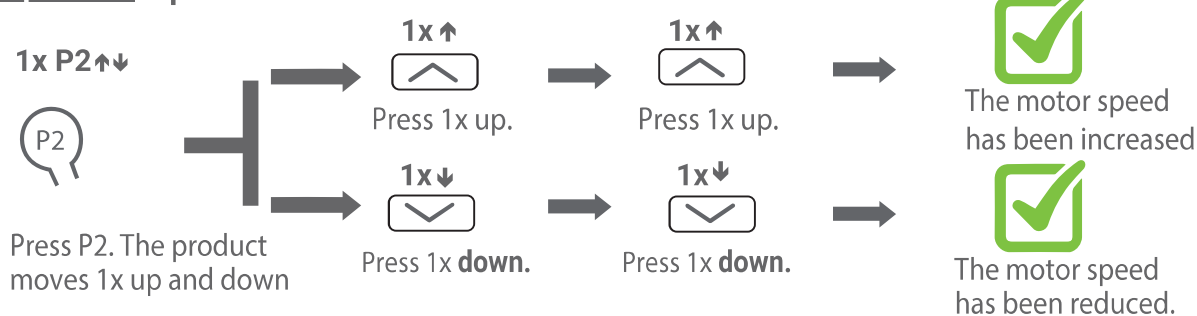
**Option C Speed Control**

**!** If the motor does NOT react after this action, it is already at the highest or lowest speed.

**!** There are 3 different speeds.

**!** If the speed has been changed the slow stop is activated. To deactivate the slow stop you have to reset the motor.

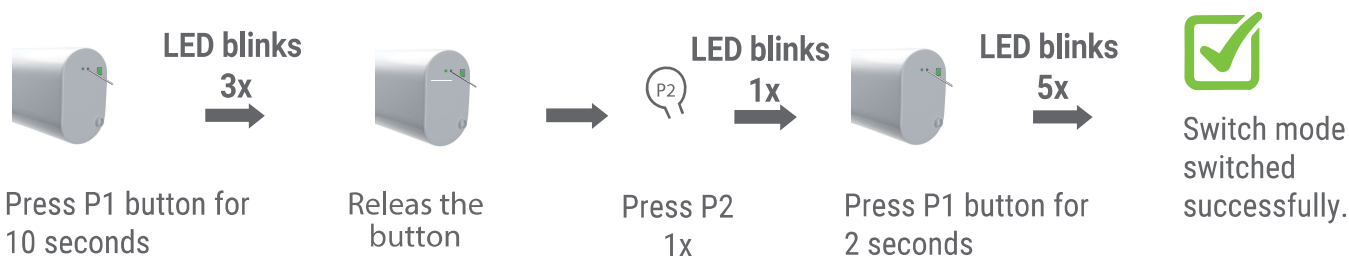
**External Switch Mode Pushbutton switch mode (Factory default)****Mechanical switch mode**

Check both upper and lower limits are set, the motor is power-on (1 jog),

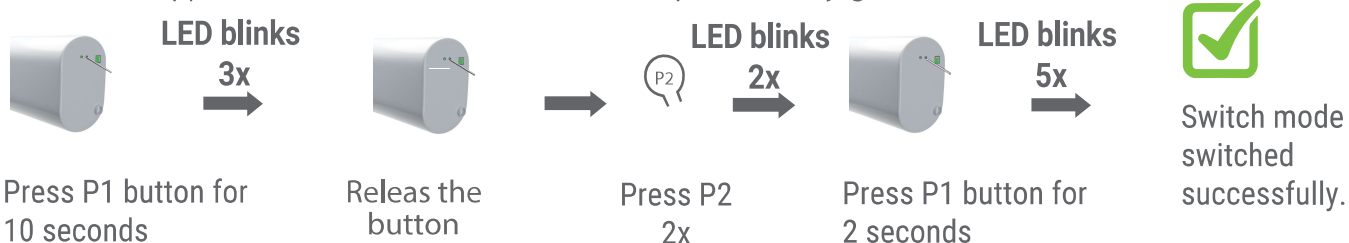
**Electronic switch mode**

Check both upper and lower limits are set, the motor is power-on (1 jog), within 10S.

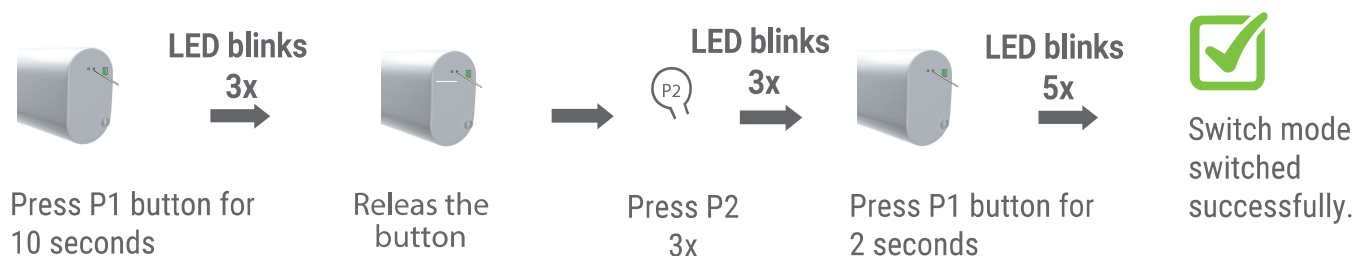
**Single button pushbutton switch mode**

Check both upper and lower limits are set, the motor is power-on (1 jog), within 10S.

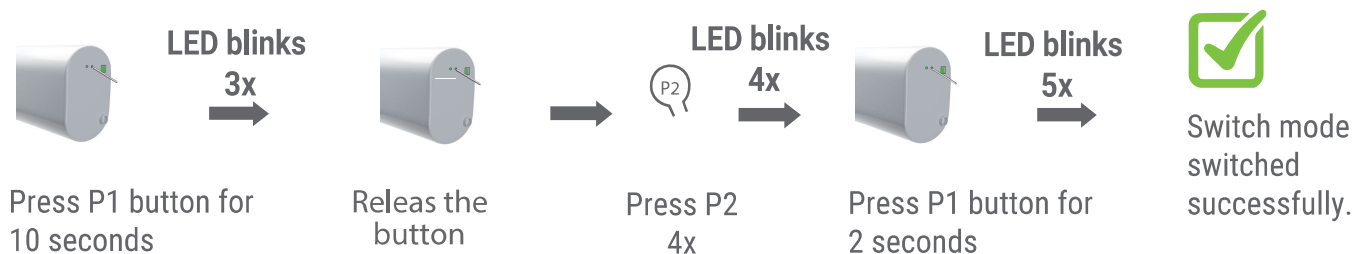

**Additional settings P1 button**

Can be used without a transmitter as an operating button.



The LED light blinks when pressed P1

**Manual contro**



LED blinks  
3x



STOP



LED blinks  
5x



Press the P1 button for 10s

Release the button

Press the STOP button

Manual cotrol has been (de) activated.

**Switching off the receiver**



until



Press and hold P1 until the LED light blinks 2x.

The Receiver switched off.

To reactivate the receiver, briefly press P1 once.

**Changing the direction of rotation**

**Method 1 (with end limits)**



LED blinks  
3x



LED blinks  
5x



Press and hold P1 for 10s

Loosen button

Press 1 second

The direction of rotation has

**Method 2 (without end limits)**

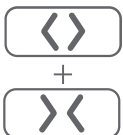

LED blinks  
5x



The direction of rotation has

Press both buttons for 2 sec

**Resetting to factory settings**



LED blinks 8x



Press the P1 button for 14 seconds

Releas the P1 button

Resets to factory

To apply new settings: go to step 1

**Changing Batteries**

