

VF3N	Nut	1
SWM8x20GRUBA4	M8x20mm Nut locking Screw	2
VF3PP	Pivot Pin	3
SWM8x20SKHDCPA4	M8x20 SktHd/Cap Screw	4
VF3AH	Anode Holder	5
SWM5x10SKHDCPA4	M5x10 SktHd/Cap Screw	6
VF3AN(1)	Anode	7
	Shaft	8
	Shaft Key	9

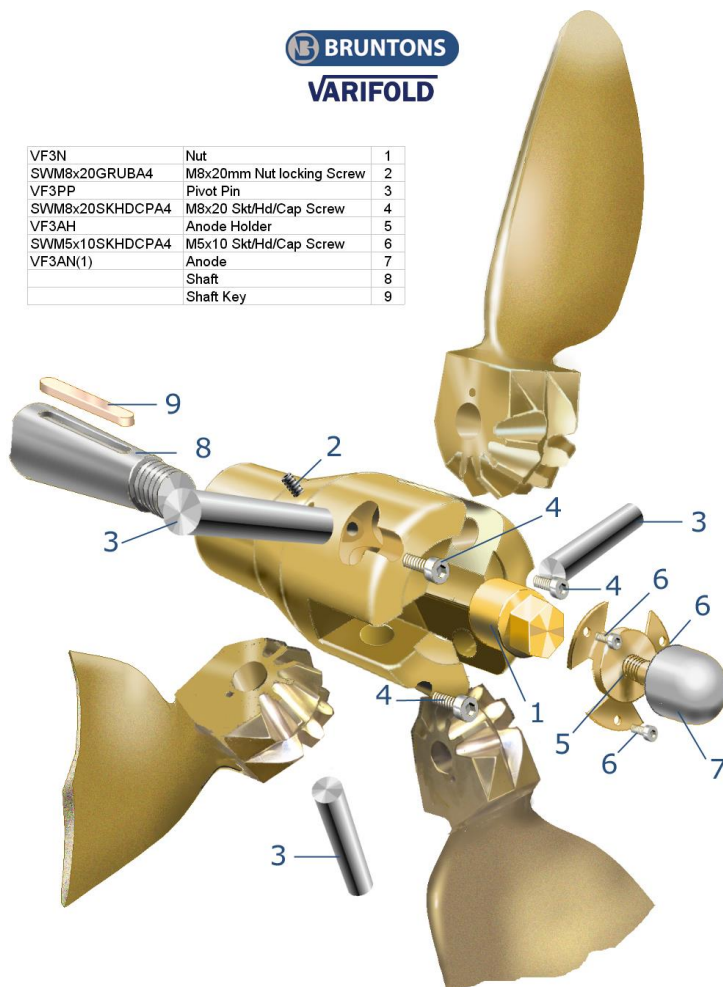

INSTALLATION INSTRUCTIONS 3 blade

STANDARD SHAFT

- Mount the propeller hub on the shaft (8). Make sure the prop cone and keyway mate properly with shaft and key.
- Ensure the top of key (9) does not touch the hub! File key if necessary.
- Apply a small drop of loctite to the threads of the nut (1) and tighten. (80 Nm maximum).
- Apply a small drop of loctite to the threads of the setscrew (2) and tighten (15 Nm)
- Grease the bearing parts of the hub, blade gears and pivot pins (3). Use water-resistant grease.
- Align the blades with the boring and push the pivot pins (3) into the hub. Repeat for all 3 blades ensuring that all 3 blades are correctly aligned.
- Mount the socket cap screw (4) using a small drop of loctite and tighten (15 Nm).
- Mount the anode retainer (5) using the socket screws (6) again use a small drop of loctite.
- Screw the anode (7) on the retainer (5)
- Check the function and see that the blade movement is free.
- Make sure you have a shaft anode with good contact to the shaft.

Engage forward/reverse at idling RPM's only. Stop the engine immediately if any strange sounds or vibrations are noticed coming from the propeller. Check that the propeller works in both forward and reverse before starting each voyage. Do not turn the propeller shaft over until the boat is in the water. Keep away from moving parts whilst handling the propeller, the blades are like knives, and can cause considerable damage. Make sure that the propeller blades do not suddenly open or close and trap your fingers for example. Do not attempt to come close to the propeller unless the engine is stopped.

Thank you for choosing Varifold