

Minn Kota 2017 to 2023 Terrova Advanced GPS Upgrade Kit

Installation Instructions

Always wear safety glasses and gloves. Disconnect all power to the trolling motor before beginning any work or maintenance. Lakeside Marine and Service is not responsible for any damage due to improper rigging or installation. If you do not have the skills, experience and tools to perform the following maintenance and repairs, we recommend you either drop off your trolling motor or ship your trolling motor to Lakeside Marine and Service to complete the installation. Or contact our Technical Service Department by email at support@lakesidemarineandservice.com or, by calling/texting 815 246 2535.

Head and Control Head Replacement

1. Remove current iPilot/iPilot Link head from current control head base by removing the 4 screws on the underside of the control head base. (save screws for new control box head and Advanced GPS Head)
2. Disconnect all wiring quick connects in the control head base.
3. Remove insert plug and coil cord from control head base.
4. Advanced GPS Cable thru the hole at the rear of the control box base. Install insert plug into control box.
5. Plug in new Advanced GPS head into the coil cord quick connect and install new Advanced GPS head on the new control head base. Secure with screws from step 1.

Testing

1. Hook up to power, turn on the trolling motor and deploy the trolling motor.
2. Pair head to "One Boat Network App" and to any remotes you purchased. See instructions on next page.
3. Test out the remote to ensure it is working as it should.
4. Install and pair heading sensor if you already have one or purchased a new one. This part is optional



Pairing to the app:

1

- a. Enable Bluetooth on the Device.

For Apple iOS - Open the "Settings" menu. Select "Bluetooth", then select "On". Keep the Bluetooth menu open and continue to the next procedure.

For Google Android - Open the "Settings" menu. Select "Bluetooth", then select "On". Keep the Bluetooth menu open and continue to the next procedure.

- b. To pair the Device to the Trolling Motor, enable Pairing Mode on the trolling motor. Press and hold the Pair  button on the trolling motor Control Head. The trolling motor will emit a continuous tone while in Pairing Mode.
- c. Locate the trolling motor under the Bluetooth Device List "Minn Kota Controller 4.0". It may take a moment for the trolling motor to appear in the menu. Continue to hold the Pair  button during this process.

NOTICE: Android devices must press Scan to locate the device in the Bluetooth list.

- d. Once "Minn Kota Controller 4.0" is listed, select it. The trolling motor will emit 3 beeps when the pairing is successfully completed and you may release the Pair  button.
- e. If 30 seconds pass while in Pairing Mode and they do not successfully pair, an error tone will sound from the trolling motor Control Head, signaling that the pairing has timed out. If unsuccessful, repeat the process.

NOTICE: In order for the device and your trolling motor to stay connected, Bluetooth needs to remain "on". When the trolling motor is paired to the device and communicating with it, the One-Boat Network app will automatically recognize that the trolling motor is paired.

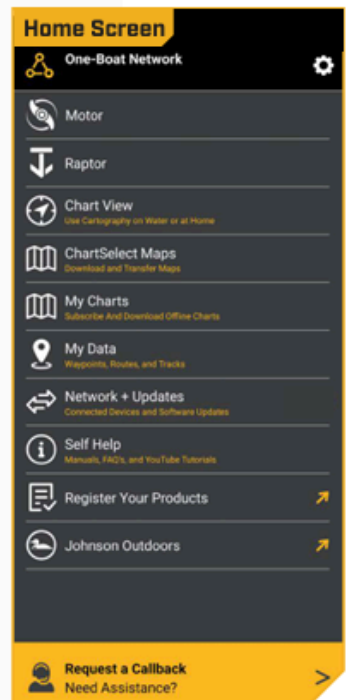
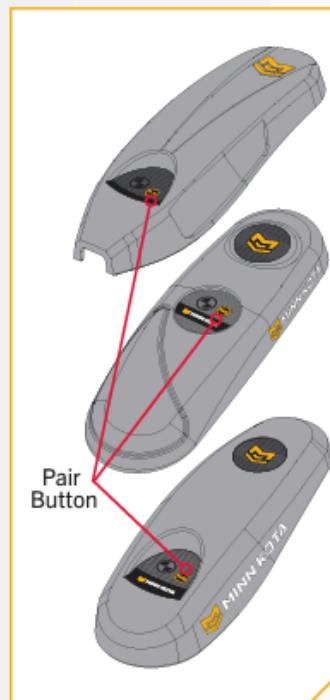
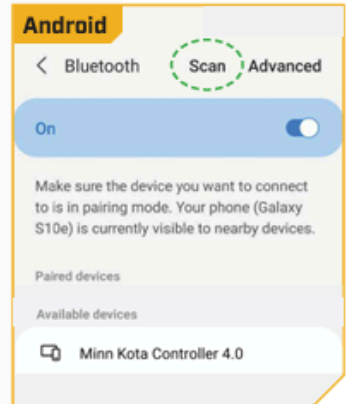

Pairing to a Micro Remote:

› Pairing the Micro Remote to your Controller

The controller is located in the Control Head on your Minn Kota trolling motor with Advanced GPS Navigation and may pair up to 5 remotes. These five remotes can be a combination of standard remotes and micro remotes. Any additional remotes can be paired using the following steps. Once the maximum number of remotes have been paired, the controller will start replacing the oldest paired remote in memory with the new remote.

1. Power up the trolling motor.
2. Locate the Pair button at the top of the Control Head.
3. Push and hold the Pair button down. A consistent tone will be emitted from the Control Head.

NOTICE: Make sure the remote stays within range of the Control Head during the pairing process.

4. While holding the Pair button on the Control Head, push and hold the Max Speed button and AutoPilot button on the remote simultaneously.

NOTICE: When the remote is being paired to the Controller, the Max Speed button and the AutoPilot button need to be held down simultaneously. Make sure to also hold the Pair button on the Control Head to successfully pair the remote to the controller.

5. Once successfully paired, 3 longer beeps will be emitted from the Control Head and the remote will be paired.

NOTICE: A remote can be paired to one controller at a time. A controller can have multiple remotes paired to it.



Scan to view the complete Micro Remote Owner's Manual online. The Owner's Manual is available at minnkota.johnsonoutdoors.com and includes information on compatibility, safety considerations, compliance, maintenance, parts and more.

Pairing to Wireless Remote

1

- a. Press the Menu button.
- b. Use the Speed Up or Speed Down button to find Bluetooth. Use the Steer Right button to select Bluetooth.
- c. In the Bluetooth Menu, use the Speed Up or Speed Down button to find Pair Remote. Press the Steer Right button to select Pair Remote.

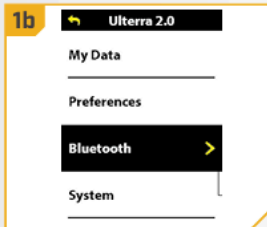

NOTICE: Make sure the remote stays within range of the Control Head during the pairing process.

2

- d. To pair the Wireless Remote to the trolling motor, enable Pairing Mode on the trolling motor. Press and hold the Pair button on the trolling motor's control head. The trolling motor will emit a continuous tone while in Pairing Mode.
- e. On the remote, use the Steer Right button to select Pair to Motor. The remote will scan for the motor. Continue to hold the Pair button on the trolling motor during this process.
- f. If successfully paired, the trolling motor will emit three beeps and the remote will be paired. The Pair button may be released.
- g. If 30 seconds pass while in Pairing Mode and the pair is not successful, an error tone will sound from the trolling motor, signaling that the pairing has timed out. If unsuccessful, repeat the process.
- h. When complete, press and hold the Menu button to return to the Dashboard.

